

STATE OF ILLINOIS
DEPARTMENT OF TRANSPORTATION

Note: Tilt hook of #9 bars for min. 3/2" cl. Use 1-4" Min. Lap for #4 bars.
Use 1-8" Min. Lap for #5 bars.

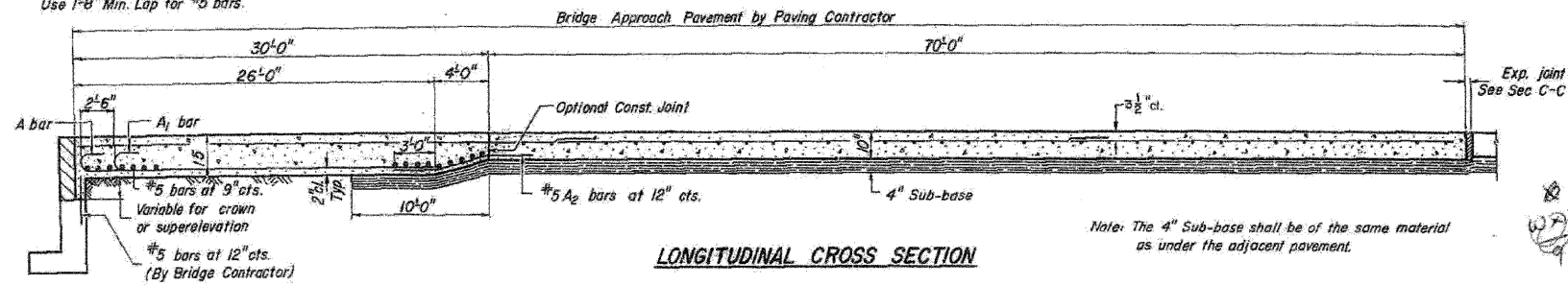

#5 steel tie bars at 2'-6" cts. Keyed long const. jt. in accordance with details shown on Standard 2323

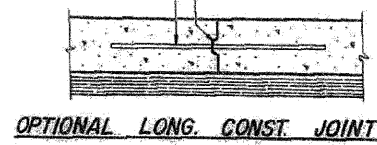

As approved by the Engineer, the contractor may elect to reduce the widths by use of the Optional Longitudinal Construction Joint shown. Joint shall be located at the edge of Traffic Lane.

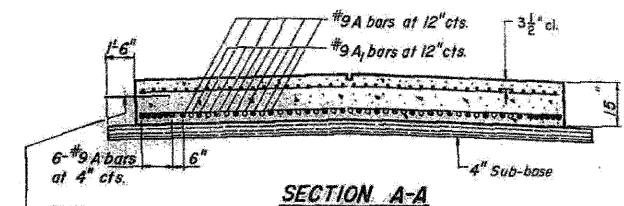
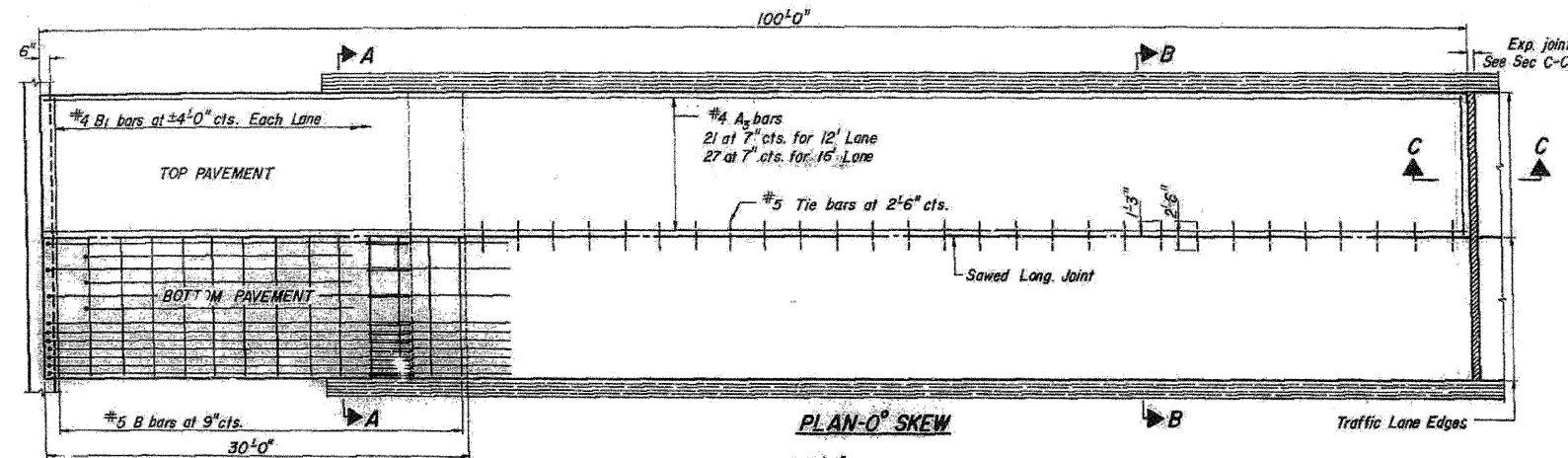

Note: When the road plans show curb and gutter, gutter or bridge approach shoulder pavement adjacent to approach slabs, place 1/2" steel tie bars at 2'-6" centers in accordance with the details for Bulkhead Longitudinal Construction Joint shown on Standard 2323. Cost of the tie bars will be included in the contract unit price for the adjacent item. Transitions for curb and gutter shall be as shown on the plans.

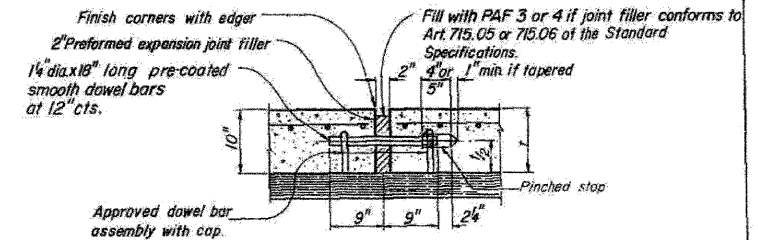
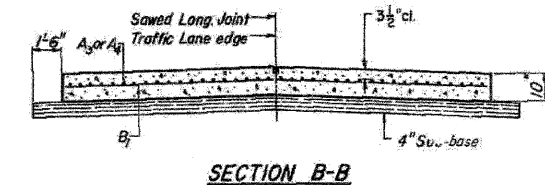
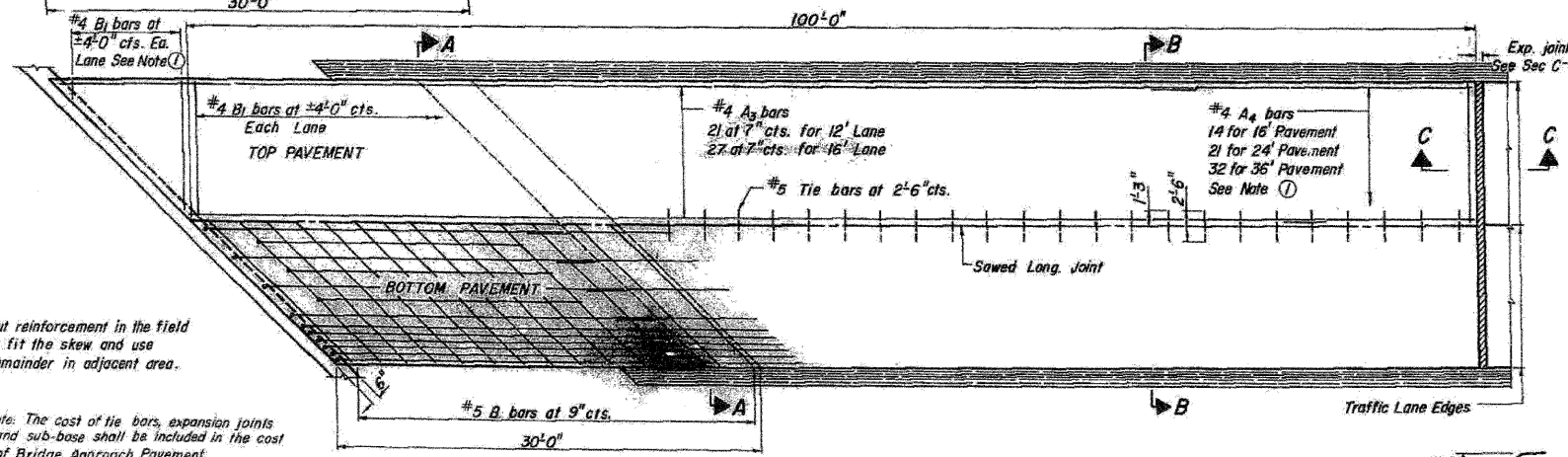

Note: The cost of tie bars, expansion joints and sub-base shall be included in the cost of Bridge Approach Pavement.

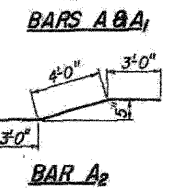
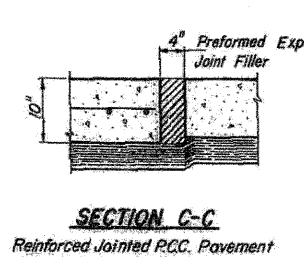
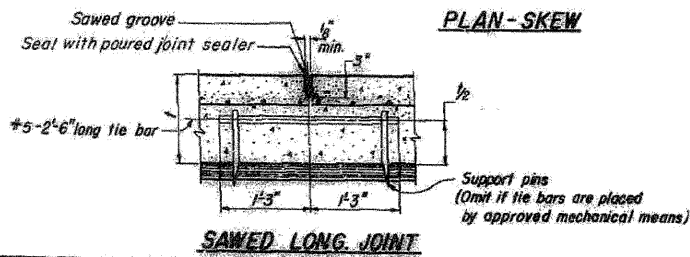

BRIDGE APPROACH PAVEMENT

(Sheet 1 of 2)
STANDARD 2353-5

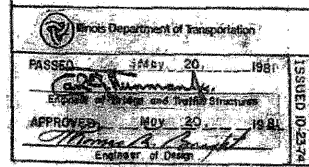

FOR INFORMATION ONLY

benesch

alfred benesch & company
Engineers - Surveyors - Planners
205 North Michigan Avenue, Suite 2400
Chicago, Illinois 60601
312-565-0450 Job No. 10050

SHEET NO. 14 18 SHEETS	F.A.I. RTE. 290-355	SECTION 22(1, 1-1, 2&3)RS-7	COUNTY DUPAGE	TOTAL SHEETS 546	SHEET NO. 276
	CONTRACT NO. 60G51				
FED. ROAD DIST. NO.		ILLINOIS	FED. AID PROJECT		

EXISTING PLAN INFORMATION 2 OF 6
STRUCTURE NO. 022-0099