

STATE OF ILLINOIS
DEPARTMENT OF TRANSPORTATION

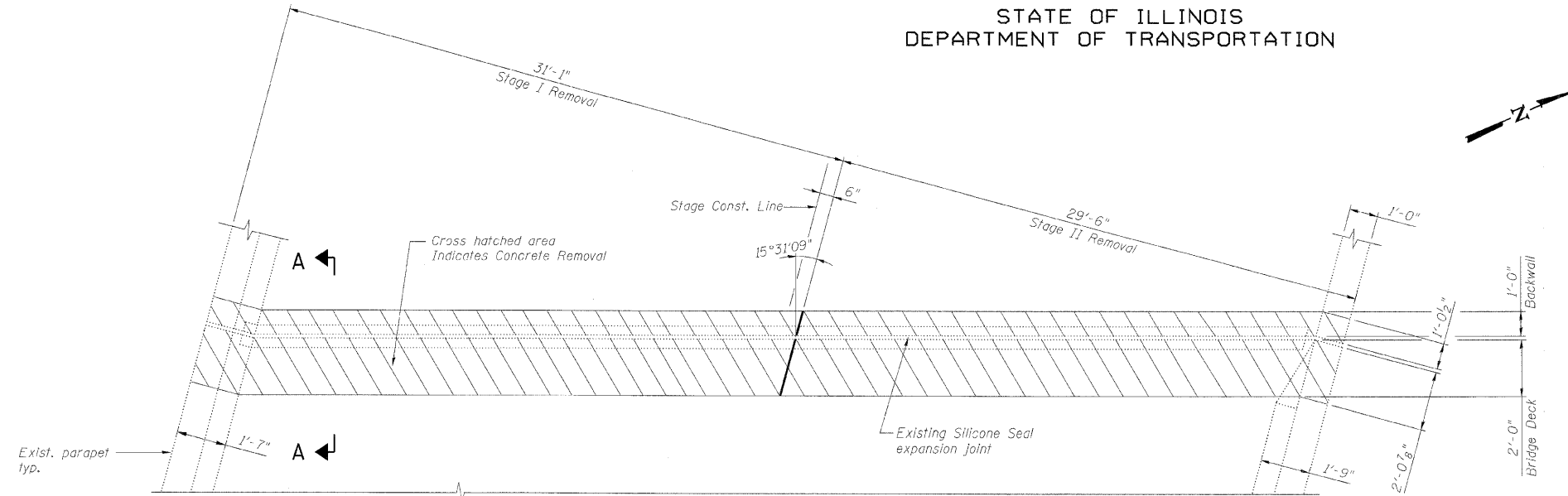

EXISTING PARTIAL PLAN AT WEST ABUTMENT
(Opposite for East Abutment)

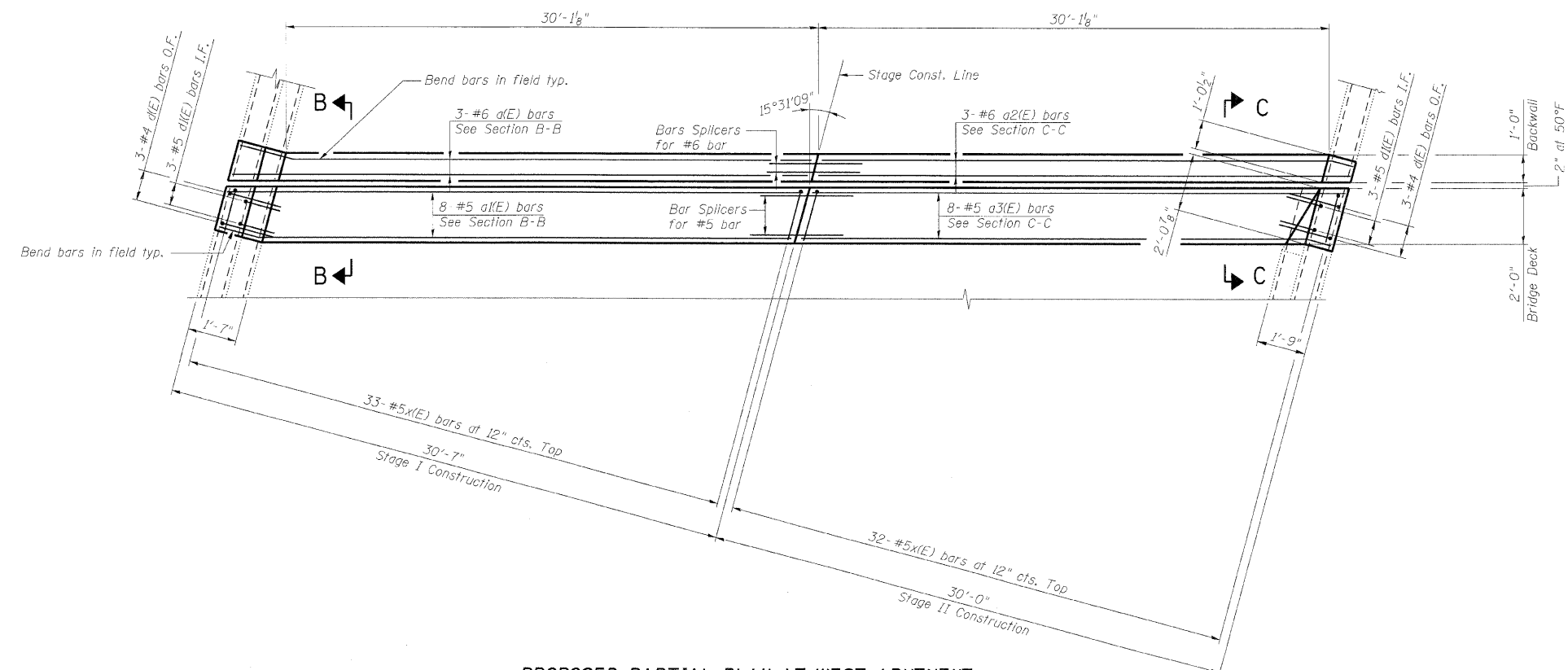

PROPOSED PARTIAL PLAN AT WEST ABUTMENT
(Opposite for East Abutment)

DESIGNED	JLS
CHECKED	AAV
DRAWN	VH
CHECKED	AAV

benesch
alfred benesch & company
Engineers • Surveyors • Planners
205 North Michigan Avenue, Suite 2400
Chicago, Illinois 60601
312-565-0450 Job No. 10050

BILL OF MATERIAL

Bar	No.	Size	Length	Shape
a(E)	6	#6	31'-5"	—
a1(E)	16	#5	31'-5"	—
a2(E)	6	#6	30'-10"	—
a3(E)	16	#5	30'-10"	—
d(E)	12	#4	5'-1"	┌
d1(E)	12	#5	4'-3"	└
x(E)	130	#5	2'-3"	┌

Item	Unit	Total
Concrete Removal	Cu. Yd.	17.2
Concrete Superstructure	Cu. Yd.	17.2
Reinforcement Bars, Epoxy Coated	Pound	2,000

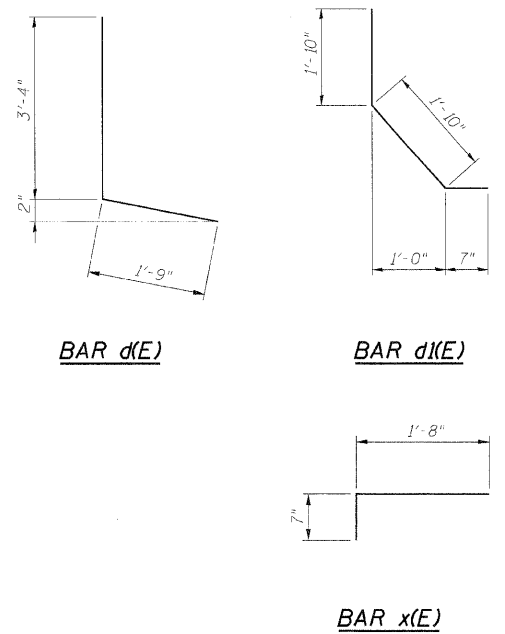

- Notes:**
- I.F. denotes Inside Face.
O.F. denotes Outside Face.
 - Work this sheet with Expansion Joint Details sheet and Bar Splicer Assembly Details sheet.
 - x(E) bar spacing measured along skew.

**EXPANSION JOINT REPAIRS
STRUCTURE NO. 022-0105**

SHEET NO. 5 12 SHEETS	F.A.I. RTE. 290-355	SECTION 22(1, 1-1, 2&3)RS-7	COUNTY DUPAGE	TOTAL SHEETS 546	SHEET NO. 334
	CONTRACT NO. 60G51			FED. ROAD DIST. NO. ILLINOIS FED. AID PROJECT	

x:\100006\100050\eng\neer\ng-documents\contract\1\SN_022_0105_0105.Wooddale_Rd\0105-60G51-005_ExpJrepair.dgn 18:05:44 11/12/2009