

STATE OF ILLINOIS
DEPARTMENT OF TRANSPORTATION

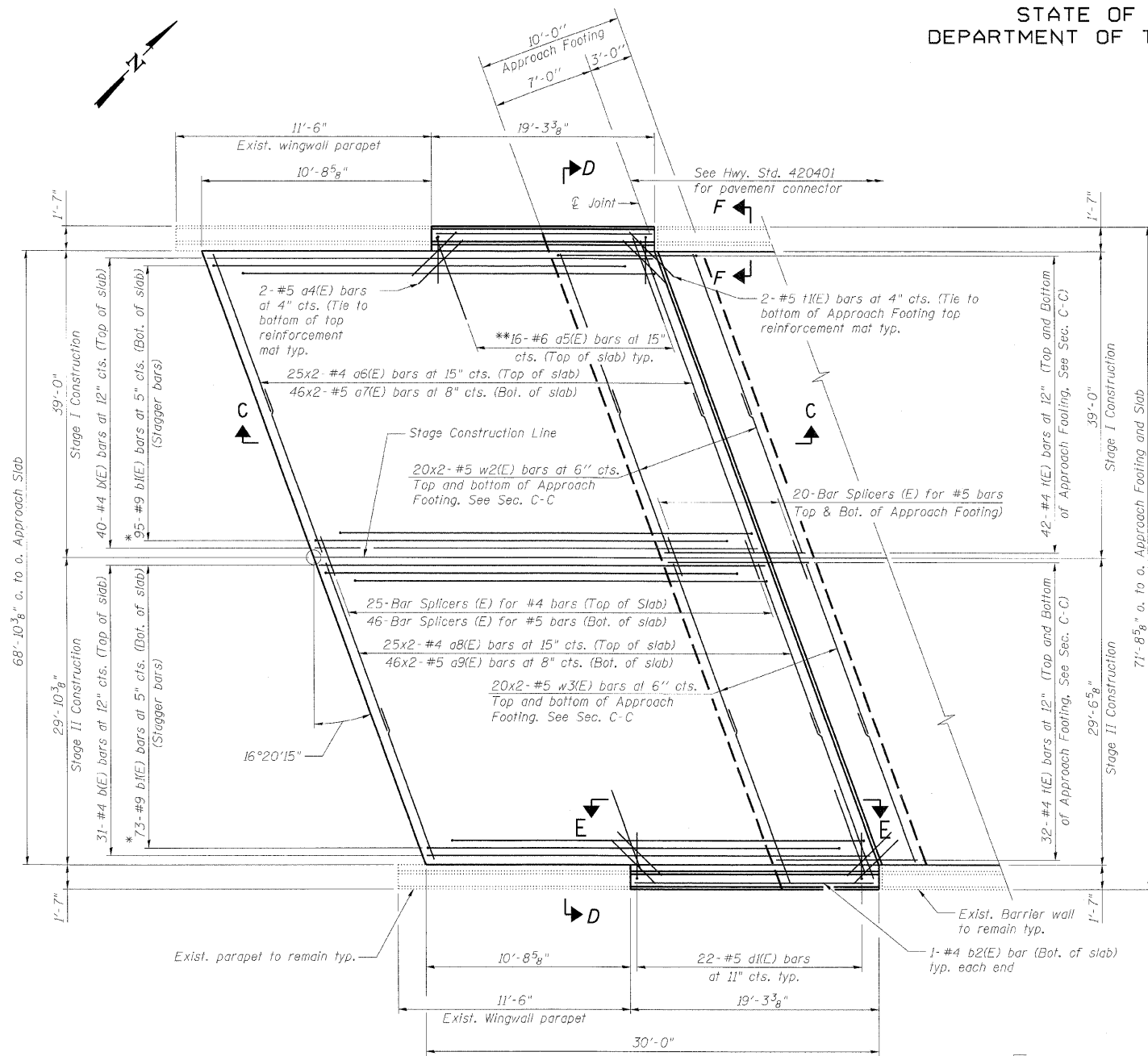

PLAN

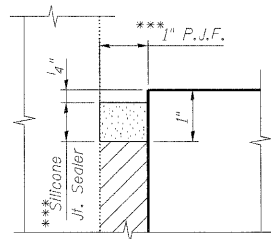

DETAIL 1

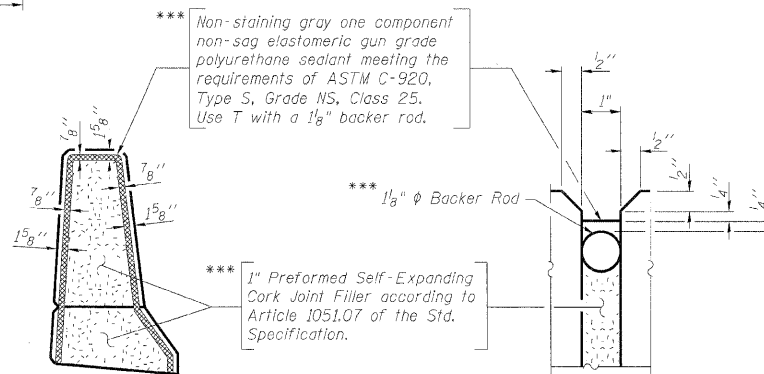

DETAIL 2

- * Tilt bars as required to maintain clearance.
- ** Lap with alternate a6(E) or a8(E) bars.
- *** Cost included with Concrete Superstructure.

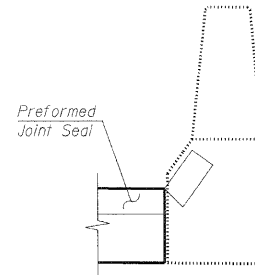

SECTION F-F

Angle Preformed Joint Seal at 45° at curbs when req'd for drainage.

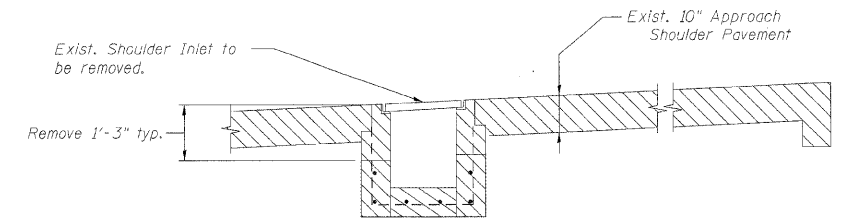

APPROACH SLAB REMOVAL DETAIL AT INLET

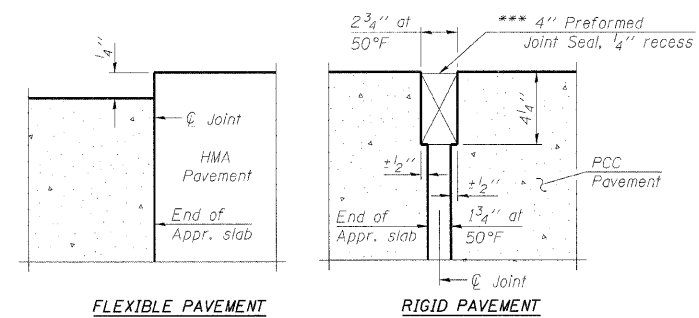

FLEXIBLE PAVEMENT

RIGID PAVEMENT

DETAIL 3

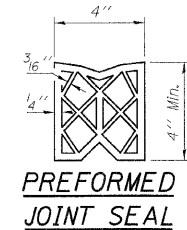

Note:

Work this sheet with North Bridge Approach Slab Details (2 of 2) sheet.

NORTH BRIDGE APPROACH SLAB DETAILS
(1 OF 2)
STRUCTURE NO. 022-0112

DESIGNED -	JLS/MFB
CHECKED -	KWS
DRAWN -	RMG
CHECKED -	KWS

benesch

alfred benesch & company
Engineers - Surveyors - Planners
205 North Michigan Avenue, Suite 2400
Chicago, Illinois 60601
312-565-0450 Job No. 10050

SHEET NO. 8 28 SHEETS	F.A.I. RTE. 290 355	SECTION 221, 1-1, 2&3RS-7	COUNTY DUPAGE	TOTAL SHEETS 546	SHEET NO. 481
	CONTRACT NO. 60G51			FED. ROAD DIST. NO. ILLINOIS FED. AID PROJECT	