

STATE OF ILLINOIS  
DEPARTMENT OF TRANSPORTATION

ROUTE NO.	SECTION	COUNTY	TOTAL SHEETS	SHEET NO.
FAP 431	22-5HB	DUPAGE	151	56
FED. ROAD DIST. NO. 7		ILLINOIS PROJECT		SHEET 11 OF 39

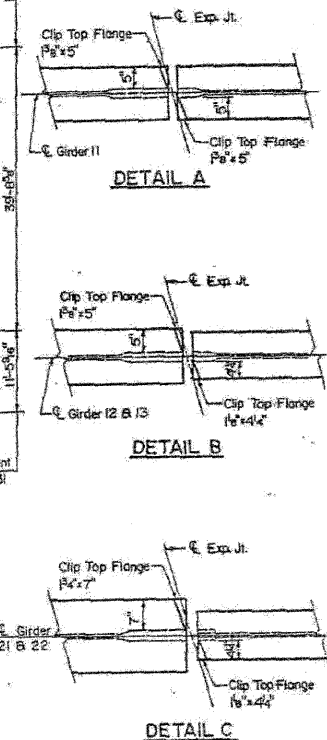
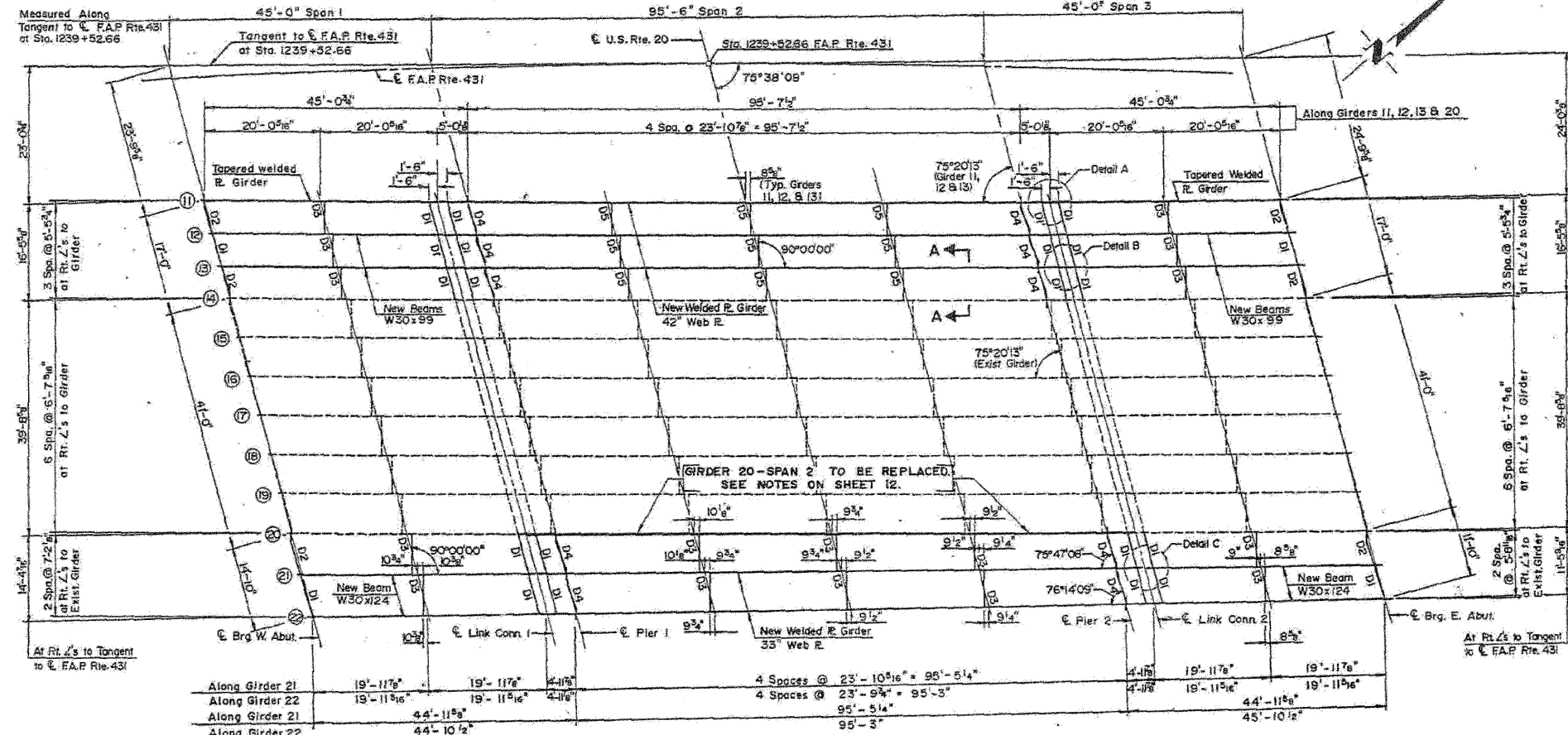

FRAMING PLAN  
(Showing Existing and New Girders)

**MOMENT TABLE**  
Composite in Positive Moment Areas of Span 2 only

	MOMENT TABLE For Girders 11, 12 & 13		MOMENT TABLE For Girders 21 & 22	
	0.5 Span 1 or 3	0.5 Span 2	0.5 Span 1 or 3	0.5 Span 2
I <sub>s</sub> (in <sup>4</sup> )	3,990	16,244	5,360	17,043
S <sub>TS</sub> (in <sup>3</sup> )	289	574	355	781
S <sub>BS</sub> (in <sup>3</sup> )	289	996	355	1,182
I <sub>c</sub> (in <sup>4</sup> )	—	43,079	—	38,751
S <sub>TC</sub> (in <sup>3</sup> )	—	3,573	—	3,922
S <sub>BC</sub> (in <sup>3</sup> )	—	1,318	—	1,469
I <sub>c</sub> (in <sup>4</sup> )	0.63	0.71	0.78	0.86
M <sub>g</sub> (k)	126	738	166	896
I <sub>s</sub> NON-COMP (ksi)	3.62	15.43	5.27	9.10
S <sub>g</sub> (k/in)	0.21	0.21	0.24	0.23
M <sub>SE</sub> (k)	42	216	48	236
M <sub>UL</sub> (k)	225	721	287	846
M <sub>IMP</sub> (k)	67	164	86	192
TOTAL (k)	334	1,101	421	1,274
I <sub>s</sub> COMP (ksi)	14.90	3.70	14.23	10.40
I <sub>s</sub> TOTAL (ksi)	20.52	19.13	19.50	19.50
VR (k)	—	41.6	—	48.8

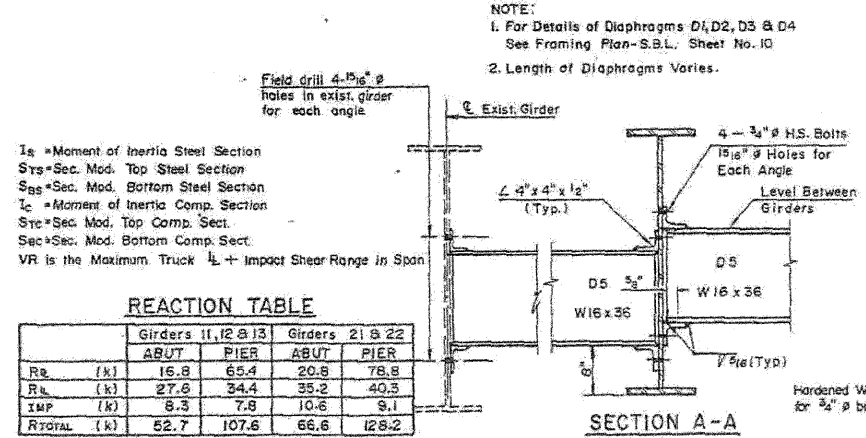

**GIRDER ELEVATIONS**

LOCATION	GIRDER					Replacement 20
	11	12	13	21	22	
Brig. W. Abut.	765.10	765.89	765.57	762.60	762.19	—
Link Conn 1	765.91	765.59	765.26	762.31	761.92	762.83
Pier 1	765.96	765.64	765.33	762.37	761.96	762.85
Pier 2	765.64	765.33	765.02	762.09	761.75	762.53
Link Conn 2	765.56	765.27	764.96	762.02	761.68	762.48
Brig. E. Abut.	765.50	765.28	764.96	762.05	761.72	—

Elevations are given to Top of Flange of Beams and to Top of Web of Girders.  
Elevations at Link Connection have been adjusted for Camber.  
Elevations for Fabrication only.  
For Top of Flange Elevation at Link Connection add 0.06 to Top of Web Elevation given in table.  
For Camber diaphragm see Sheet No. 13.

**FRAMING PLAN-N.B.L.**  
FAP ROUTE 431  
SECTION 22-5HB  
DU PAGE COUNTY  
STATION 1239+52.66  
STRUCTURE NO. 022-0112

**MYA, INCORPORATED**  
DESIGNED BY MJS  
CHECKED BY PBL  
DATE: 10/11/00

FOR INFORMATION ONLY

**benesch**  
alfred benesch & company  
Engineers • Surveyors • Planners  
205 North Michigan Avenue, Suite 2400  
Chicago, Illinois 60601  
312-666-0460 Job No. 10050

SHEET NO. 19 28 SHEETS	F.A.I. RTE. 290	SECTION 22(1, 1-1, 2&3)RS-7	COUNTY DUPAGE	TOTAL SHEETS 546	SHEET NO. 492
	CONTRACT NO. 60G51			FED. ROAD DIST. NO. ILLINOIS FED. AID PROJECT	

EXISTING PLAN INFORMATION 4 OF 13  
STRUCTURE NO. 022-0112

x:\10000s\10050\engineering\documents\contract\1\SN.022.0111.0112.Lake.St.0112-60G51-019-Exisplan.04.dgn 18:20:00 11/12/2009