

SUMMARY OF QUANTITIES (THIS SHEET)		
DESCRIPTION	UNIT	QUANTITY
ELECTRIC CABLE IN CONDUIT, LEAD-IN, NO. 18 4/C, TWISTED, SHIELDED	LF	185
INDUCTION LOOP	LF	88

NOTE:
 IDOT RECORD PLANS PROVIDED FOR INFORMATIONAL PURPOSES ONLY. THE CONTRACTOR IS RESPONSIBLE FOR VERIFYING THE LOCATION AND EXTENT OF WORK ASSOCIATED WITH REPLACEMENT OF INDUCTION LOOPS, LEAD-IN CABLE AND RELATED WORK.

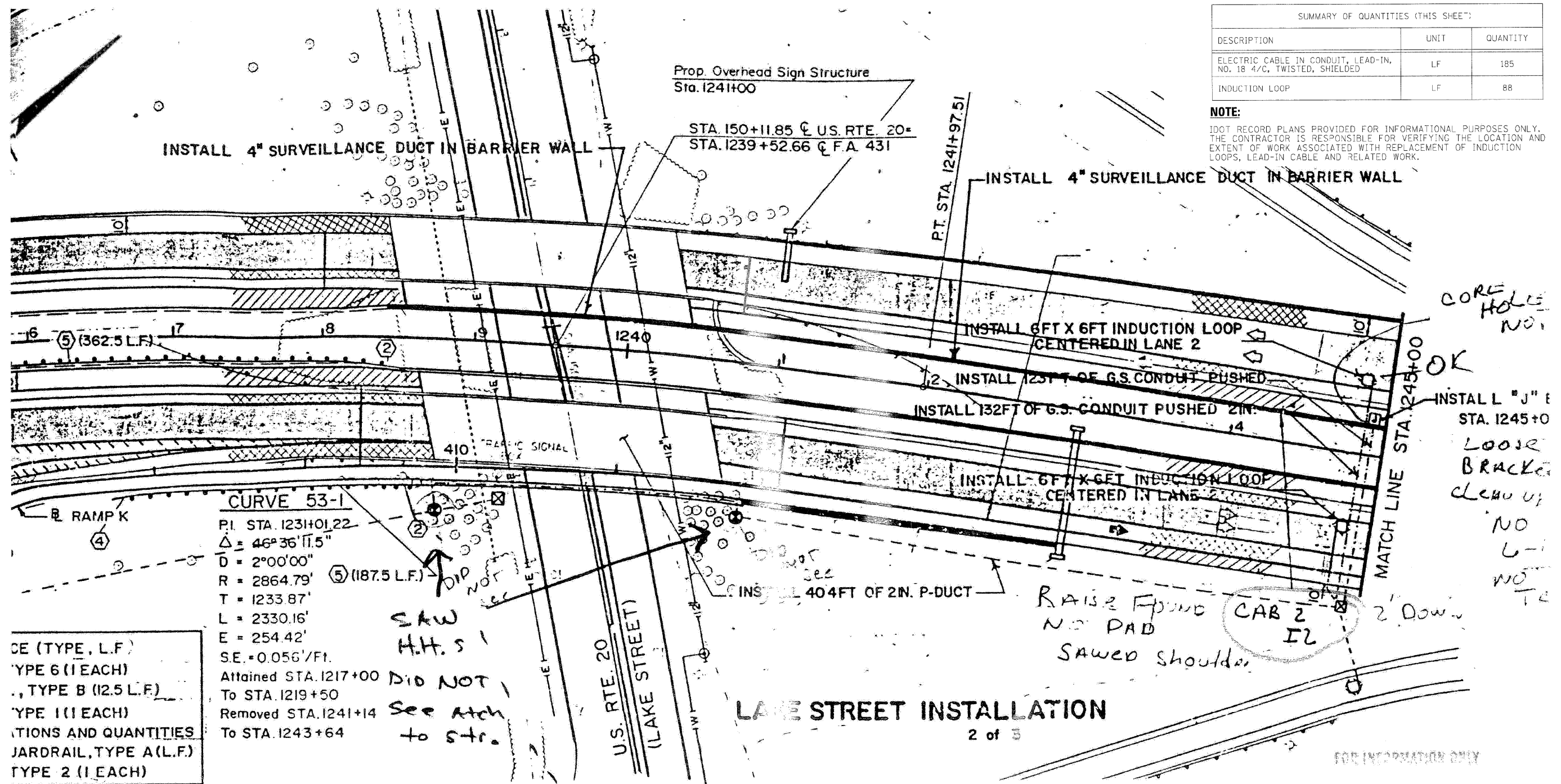

CURVE 53-1
 P.I. STA. 1231+01.22
 $\Delta = 46^{\circ}36'11.5''$
 $D = 2^{\circ}00'00''$
 $R = 2864.79'$ (5) (1187.5 L.F.)
 $T = 1233.87'$
 $L = 2330.16'$
 $E = 254.42'$
 $S.E. = 0.056\%/ft.$
 Attained STA. 1217+00
 To STA. 1219+50
 Removed STA. 1241+14
 To STA. 1243+64

DESCRIPTION	TYPE	L.F.
TYPE 6	(1 EACH)	
TYPE B	(12.5 L.F.)	
TYPE 1	(1 EACH)	
TRAFFIC SIGNAL		
RAILRAIL	TYPE A	(L.F.)
TYPE 2	(1 EACH)	

LAKE STREET INSTALLATION
 2 of 3

DESCRIPTION	TYPE	L.F.	STATION	REMARKS
Transition From Normal Bituminous Overlay to Bridge Approach Pavement (See Butt Joint Details Sheet 1/7)				See U.S. Rt. 20 Bridge Plans SBL Bridge Elevations
Bridge Approach Pavement (See Sheet 1/7 for Details)				
			237+41.74	
			238+01.74	
			238+45.14	
			239+05.14	
			240+51.79	
			241+35.32	
			242+00.00	
			243+00.00	
			244+00.00	
			245+00.00	

LEGEND

[Pattern]	EXISTING PAVEMENT
[Pattern]	EXISTING SHOULDER TO BE REMOVED
[Pattern]	EXISTING SHOULDER TO BE OVERLAYED
[Pattern]	PROPOSED SHOULDER