

**GUIDE SIGN SEQUENCE
NUMBERING CODE**

EXAMPLE
 EB-TR-03
 DIRECTION OF TRAFFIC: EB - EASTBOUND
 SIGN PANEL NUMBER: 03
 MOUNTING TYPE: TR - TRUSS

NB - NORTHBOUND FAI 355
 SB - SOUTHBOUND FAI 355
 EB - EASTBOUND FAI 290
 WB - WESTBOUND FAI 290
 LS - LAKE STREET
 AT - ARMY TRAIL RD
 83 - IL 83 (KINGERY HWY)
 64 - IL 64 (NORTH AVE)

□ REMOVE AND REPLACE SIGN PANEL
 ✕ EXISTING LUMINAIRE TO BE REMOVED

TR - TRUSS
 CL - CANTILEVER
 BM - BRIDGE MOUNTED
 WP - WOOD POST
 BS - BREAKAWAY STEEL
 LP - LIGHT POLE
 GM - GROUND MOUNTED

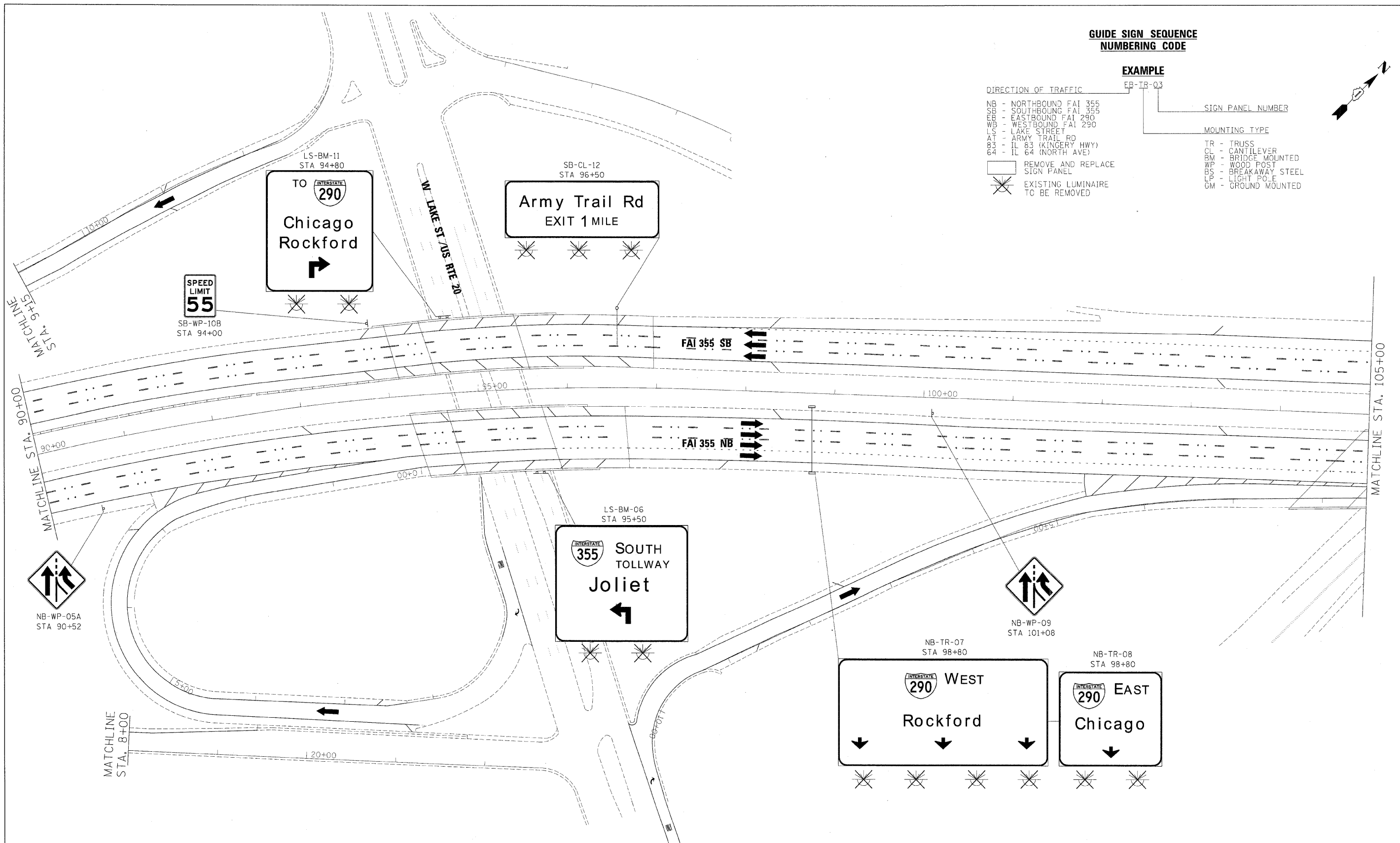
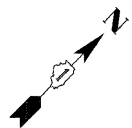

| | | |
|--------------------------------------|-----------------|-----------|
| FILE NAME = | DESIGNED - AJP | REVISED - |
| ...NppIn_ABC_60J23_355_pvtmkg_08.dgn | DRAWN - TMB | REVISED - |
| USER NAME = jmajevski | CHECKED - JMM | REVISED - |
| PLDT DATE = 12/16/2009 | DATE - 10/16/09 | REVISED - |

benesch

**STATE OF ILLINOIS
DEPARTMENT OF TRANSPORTATION**

SIGNING PLAN
I-355 STA 90+00 TO STA 105+00

SCALE: 1"=50' SHEET NO. 5 OF 32 SHEETS STA. TO STA.

| F.A.I. RTE. | SECTION | COUNTY | TOTAL SHEETS | SHEET NO. |
|---------------------|--------------------|---------------------------|--------------|-----------|
| *290,355 | 22(1, 1-1, 2&3RS-7 | DUPAGE | 661 | 555 |
| FED. ROAD DIST. NO. | | ILLINOIS FED. AID PROJECT | | |

CONTRACT NO. 60G51