

- CONSTRUCTION NOTES:
- RELOCATE EXISTING EMERGENCY VEHICLE PRIORITY SYSTEM AND CONFIRMATION BEACON DETECTOR UNIT TO NEW MAST ARM OR POST.
 - RELOCATE EXISTING EMERGENCY VEHICLE PRIORITY SYSTEM, PHASING UNIT, TO NEW TRAFFIC SIGNAL CONTROLLER.
 - THE EXISTING INTERCONNECT CABLES SHALL BE REPLACED WITH NEW INTERCONNECT CABLES AND SHALL BE ROUTED THROUGH THE NEW CONDUITS TO THE NEW CONTROLLER AND ATTACHED TO THE NEW CONTROLLER.

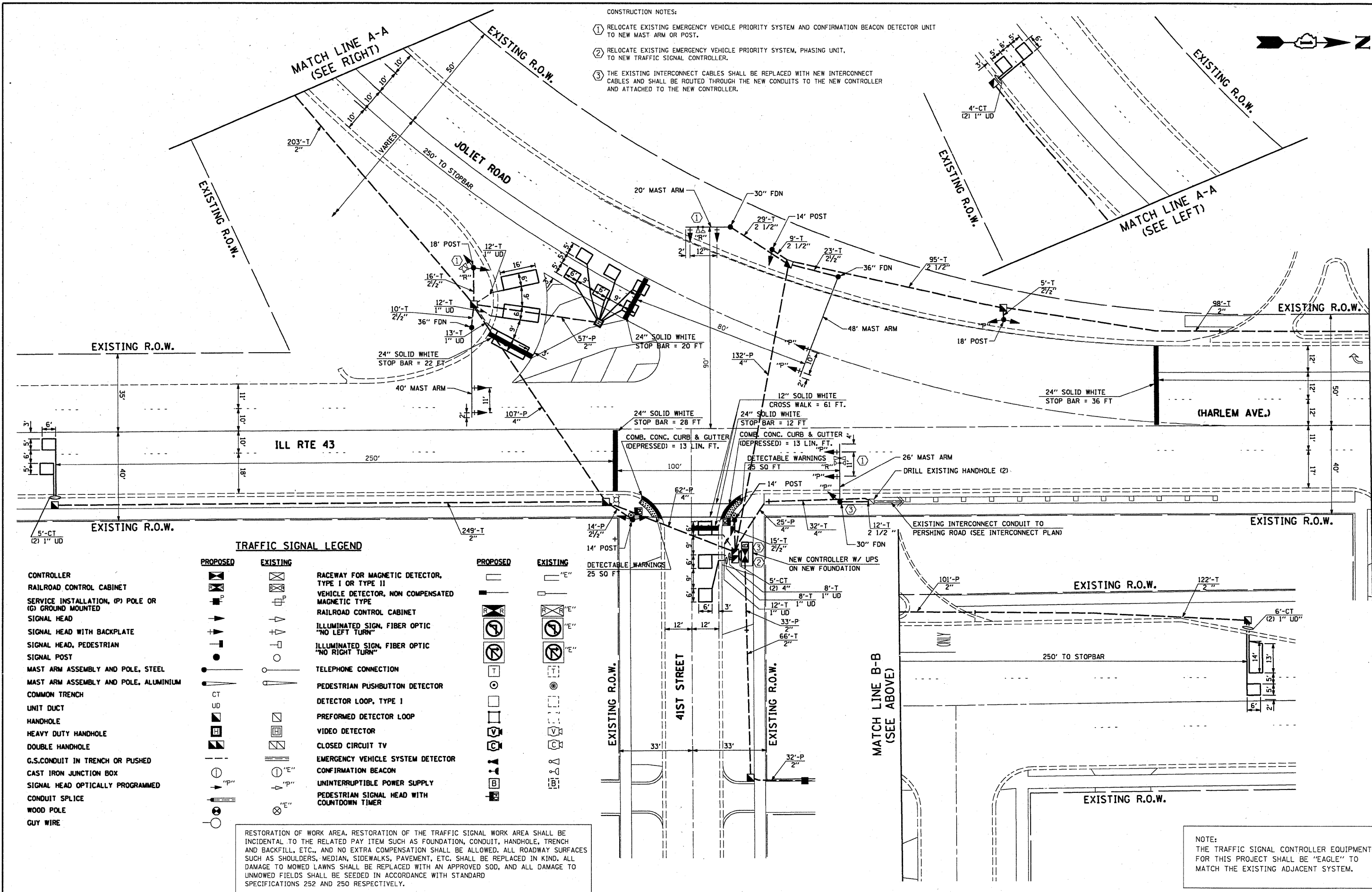

TRAFFIC SIGNAL LEGEND

PROPOSED	EXISTING	PROPOSED	EXISTING
CONTROLLER	[Symbol]	RACEWAY FOR MAGNETIC DETECTOR, TYPE I OR TYPE II	[Symbol]
RAILROAD CONTROL CABINET	[Symbol]	VEHICLE DETECTOR, NON COMPENSATED MAGNETIC TYPE	[Symbol]
SERVICE INSTALLATION, (P) POLE OR (G) GROUND MOUNTED	[Symbol]	RAILROAD CONTROL CABINET	[Symbol]
SIGNAL HEAD	[Symbol]	ILLUMINATED SIGN, FIBER OPTIC "NO LEFT TURN"	[Symbol]
SIGNAL HEAD WITH BACKPLATE	[Symbol]	ILLUMINATED SIGN, FIBER OPTIC "NO RIGHT TURN"	[Symbol]
SIGNAL HEAD, PEDESTRIAN	[Symbol]	TELEPHONE CONNECTION	[Symbol]
SIGNAL POST	[Symbol]	PEDESTRIAN PUSHBUTTON DETECTOR	[Symbol]
MAST ARM ASSEMBLY AND POLE, STEEL	[Symbol]	DETECTOR LOOP, TYPE I	[Symbol]
MAST ARM ASSEMBLY AND POLE, ALUMINIUM	[Symbol]	PREFORMED DETECTOR LOOP	[Symbol]
COMMON TRENCH	[Symbol]	VIDEO DETECTOR	[Symbol]
UNIT DUCT	[Symbol]	CLOSED CIRCUIT TV	[Symbol]
HANDHOLE	[Symbol]	EMERGENCY VEHICLE SYSTEM DETECTOR	[Symbol]
HEAVY DUTY HANDHOLE	[Symbol]	CONFIRMATION BEACON	[Symbol]
DOUBLE HANDHOLE	[Symbol]	UNINTERRUPTIBLE POWER SUPPLY	[Symbol]
G.S.CONDUIT IN TRENCH OR PUSHED	[Symbol]	PEDESTRIAN SIGNAL HEAD WITH COUNTDOWN TIMER	[Symbol]
CAST IRON JUNCTION BOX	[Symbol]		
SIGNAL HEAD OPTICALLY PROGRAMMED	[Symbol]		
CONDUIT SPLICE	[Symbol]		
WOOD POLE	[Symbol]		
GUY WIRE	[Symbol]		

RESTORATION OF WORK AREA. RESTORATION OF THE TRAFFIC SIGNAL WORK AREA SHALL BE INCIDENTAL TO THE RELATED PAY ITEM SUCH AS FOUNDATION, CONDUIT, HANDHOLE, TRENCH AND BACKFILL, ETC., AND NO EXTRA COMPENSATION SHALL BE ALLOWED. ALL ROADWAY SURFACES SUCH AS SHOULDERS, MEDIAN, SIDEWALKS, PAVEMENT, ETC. SHALL BE REPLACED IN KIND. ALL DAMAGE TO MOWED LAWNS SHALL BE REPLACED WITH AN APPROVED SOD, AND ALL DAMAGE TO UNMOWED FIELDS SHALL BE SEEDED IN ACCORDANCE WITH STANDARD SPECIFICATIONS 252 AND 250 RESPECTIVELY.

NOTE:
THE TRAFFIC SIGNAL CONTROLLER EQUIPMENT FOR THIS PROJECT SHALL BE "EAGLE" TO MATCH THE EXISTING ADJACENT SYSTEM.