

FOR INDEX OF SHEETS, SEE SHEET NO. 2.

TRAFFIC DATA

ADT = 149,000 VEHICLES
POSTED SPEED LIMIT = 55 MPH

PROJECT LOCATED IN THE
VILLAGE OF HILLSIDE,
VILLAGE OF BERKELEY,
CITY OF ELMHURST
AND CITY OF NORTHLAKE

STRUCTURE LOCATIONS

I-290 OVER YORK RD
SN 022-0005 (EB)
SN 022-0006 (WB)

I-290 OVER IL 64 (NORTH AVE)
SN 022-0007 (EB)
SN 022-0008 (WB)

I-290 OVER UPRR (NORTH)
SN 016-1130 (EB)
SN 016-1131 (WB)

I-290 OVER UPRR (SOUTH)
SN 016-1133 (EB)
SN 016-1132 (WB)

I-290 OVER ELECTRIC AVE & PRAIRIE PATH
SN 016-1134 (EB)
SN 016-1135 (WB)

I-290 OVER IL 56 (BUTTERFIELD RD)
SN 016-0084 (EB)
SN 016-0083 (WB)

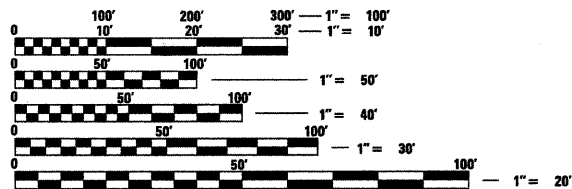

FULL SIZE PLANS HAVE BEEN PREPARED USING STANDARD ENGINEERING SCALES. REDUCED SIZED PLANS WILL NOT CONFORM TO STANDARD SCALES. IN MAKING MEASUREMENTS ON REDUCED PLANS, THE ABOVE SCALES MAY BE USED.

J.U.L.I.E.
JOINT UTILITY LOCATION INFORMATION FOR EXCAVATION
1-800-892-0123
OR 811

PROJECT ENGINEER: CRAIG BAUER (847) 705-4265
PROJECT MANAGER: LONG TRAN (847) 705-4232

CONTRACT NO. 60157

STATE OF ILLINOIS
DEPARTMENT OF TRANSPORTATION
DIVISION OF HIGHWAYS
**PROPOSED
HIGHWAY PLANS**
FAI-290 (EISENHOWER EXPRESSWAY)
SECTION 2009-099BR
PROJECT: ACIM-290-3(063)083
EAST OF CHURCH RD. TO I-88
ROADWAY AND STRUCTURE REPAIRS
COOK AND DUPAGE COUNTIES
C-91-080-10

NOTE: WHEREVER IN THESE PLANS REFERENCE IS MADE TO "TOTAL SHEETS - 309" IT SHALL MEAN "394".

F.A.I. RTE.	SECTION	COUNTY	TOTAL SHEETS	SHEET NO.
290	2009-099BR	COOK/DUPAGE	394	1
FED. ROAD DIST. NO.	ILLINOIS	CONTRACT NO. 60157		

*394 + 7-4d

D-91-341-09

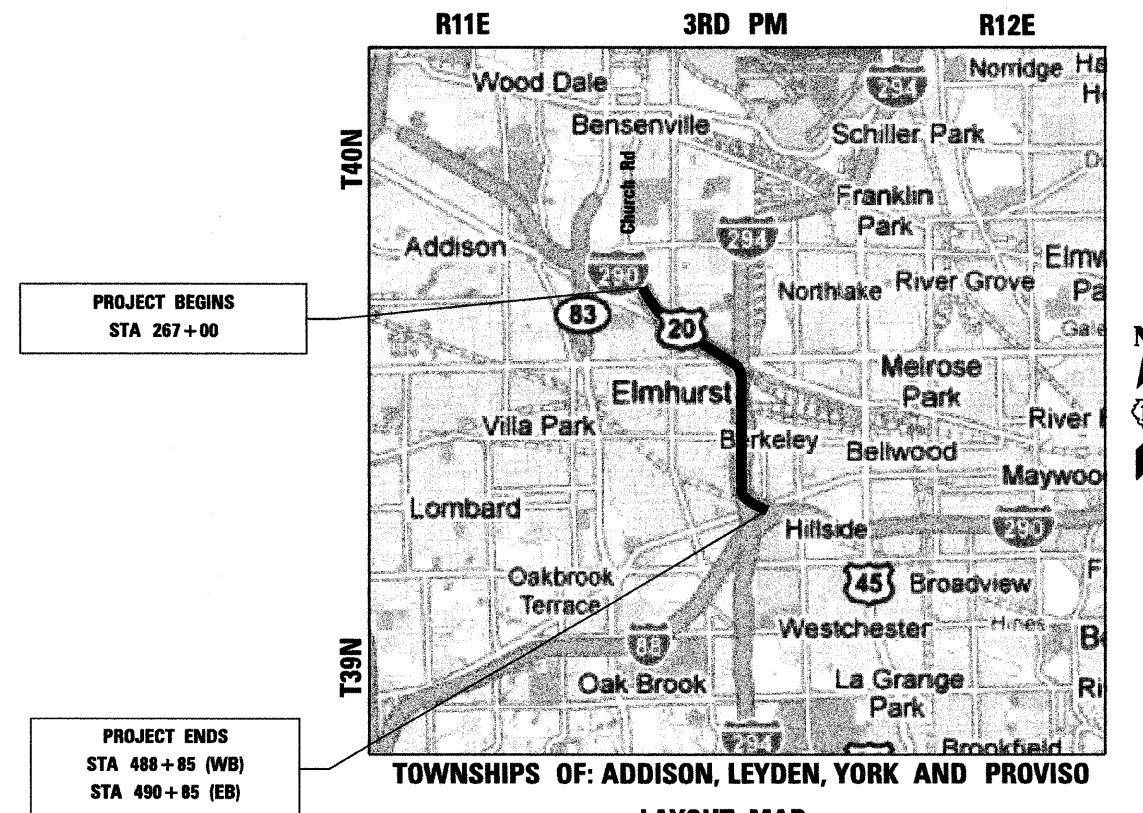
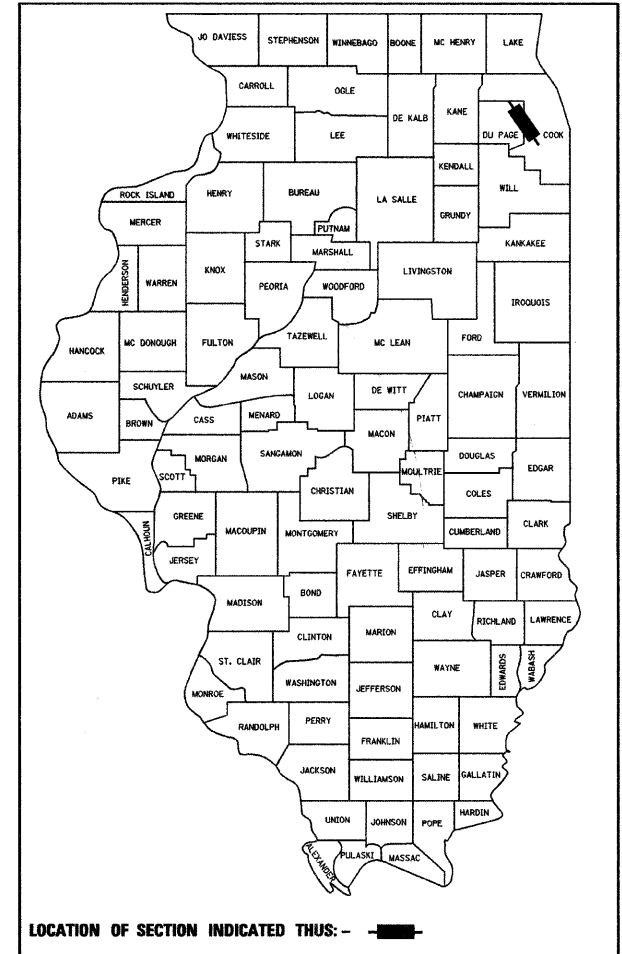

LAYOUT MAP
SCALE: 1 IN = 1.5 MI

GROSS LENGTH OF PROJECT = 22,385 LIN FT = 4.24 MILES
NET LENGTH OF PROJECT = 22,385 LIN FT = 4.24 MILES

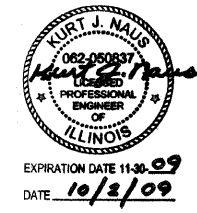

STATE OF ILLINOIS
DEPARTMENT OF TRANSPORTATION
DIVISION OF HIGHWAYS

SUBMITTED OCTOBER 7, 2009
Diane M. O'Keefe
DEPUTY DIRECTOR OF HIGHWAYS, REGION ENGINEER

December 4, 2009
Charles G. Ingersoll
ENGINEER OF DESIGN AND ENVIRONMENT

December 4, 2009
Christine M. Reed
DIRECTOR OF HIGHWAYS, CHIEF ENGINEER

PRINTED BY THE AUTHORITY
OF THE STATE OF ILLINOIS

alfred benesch & company
Engineers • Surveyors • Planners
205 North Michigan Avenue, Suite 2400
Chicago, Illinois 60601
312-565-0450

REV.