

Bench Mark: Chiseled square on northeast wingwall of East Bound Structure.  
Elev. 682.06

Existing Structures: No. 045-0026 (EB) & No. 045-0027 (WB),  
built as FA Rte. 131, Sec. 61 B in 1958.  
The Superstructures consist of a R.C. deck  
91'-0" long by 35'-8" wide supported on two  
simply supported wide flange beam spans.  
Decks to be removed and replaced using  
stage construction.

No Salvage.

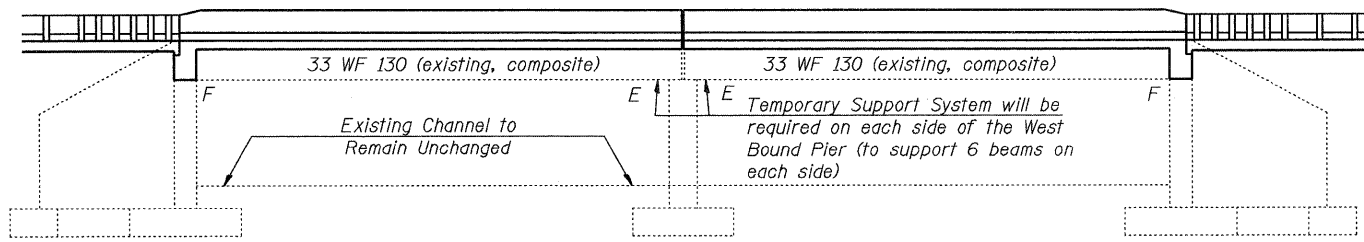

**ELEVATION**

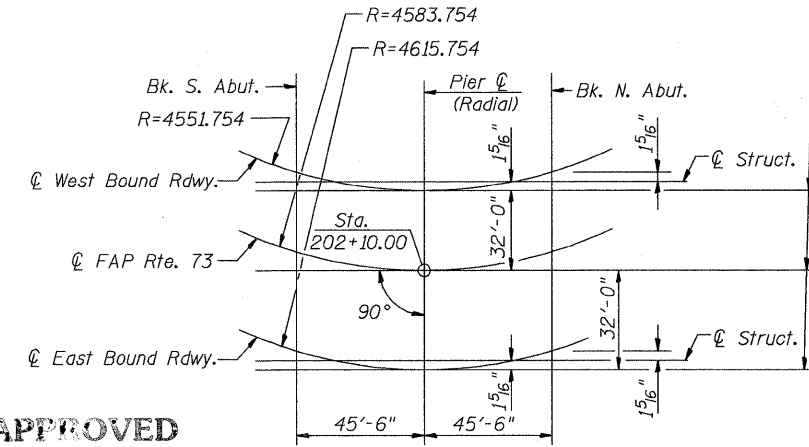

**OFFSET SKETCH**

Local Tangent  
Sta. 202+10.00

**CURVE DATA**

$\Delta = 74^\circ-46'-20''$   
 $D = 1^\circ-15'-0''$   
 $T = 3502.784'$   
 $L = 5981.778'$   
 $E = 1185.154'$   
 $R = 4583.754'$   
 P.C. Sta. 143+51.33  
 P.I. Sta. 178+54.11  
 P.T. Sta. 203+33.11  
 S.E. = 2.0 %  
 S.E. Removed  
 from Sta. 202+73.99  
 to Sta. 203+92.22

**APPROVED**  
FOR STRUCTURAL ADEQUACY ONLY

Ralph E. Anderson  
ENGINEER OF BRIDGES AND STRUCTURES

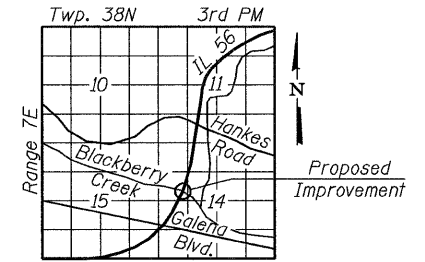

**LOCATION SKETCH**

STATION 202+10  
REBUILT 2008 BY  
STATE OF ILLINOIS  
F.A.P. RT. 573 SEC. 61B-BR-1  
LOADING HS20  
STR. NO. 045-0026

**NAME PLATE 1**  
See Std. 515001

STATION 202+10  
REBUILT 2008 BY  
STATE OF ILLINOIS  
F.A.P. RT. 573 SEC. 61B-BR-1  
LOADING HS20  
STR. NO. 045-0027

**NAME PLATE 2**  
See Std. 515001

Note: The existing name plate shall be  
cleaned and relocated adjacent to the  
new name plate. Cost included with  
Name Plates.

**LOADING HS20-44**  
Allow 50#/sq. ft. for future wearing surface.  
**DESIGN SPECIFICATIONS**  
2002 AASHTO

**DESIGN STRESSES**

FIELD UNITS

$f_c = 3,500$  psi  
 $f_y = 60,000$  psi (reinforcement)  
 $f_y = 33,000$  psi (Existing)

**SEISMIC DATA**

Seismic Performance Category (SPC) = A  
 Bedrock Acceleration Coefficient (A) = .04g  
 Site Coefficient (S) = 1.0

**WATERWAY INFORMATION**

Drainage Area = 31 sq. mi. Low Grade Elev. 676.0' @ Sta. 229+00

Flood	Freq. Yr.	Q C.F.S.	Opening Sq. Ft.		Nat. H.W.E.		Head - Ft.		Headwater El.	
			Exist.	Prop.	Exist.	Prop.	Exist.	Prop.	Exist.	Prop.
Design	10	1560	668.3	668.3	677.70	0.26	0.26	677.96	677.96	
Base	50	2496	657.4	657.4	678.94	0.36	0.36	679.30	679.30	
Overtopping	100	3120	657.4	657.4	679.50	0.40	0.40	679.90	679.90	
Max. Calc.	1.15	380	379.5	379.5	676.03	0.03	0.03	676.06	676.06	
	500	4305	657.4	657.4	680.71	0.18	0.18	680.89	680.89	

Max. Recorded H.W.E. = +679

Traffic Barrier Terminal, Type 5  
Std. 631026-02

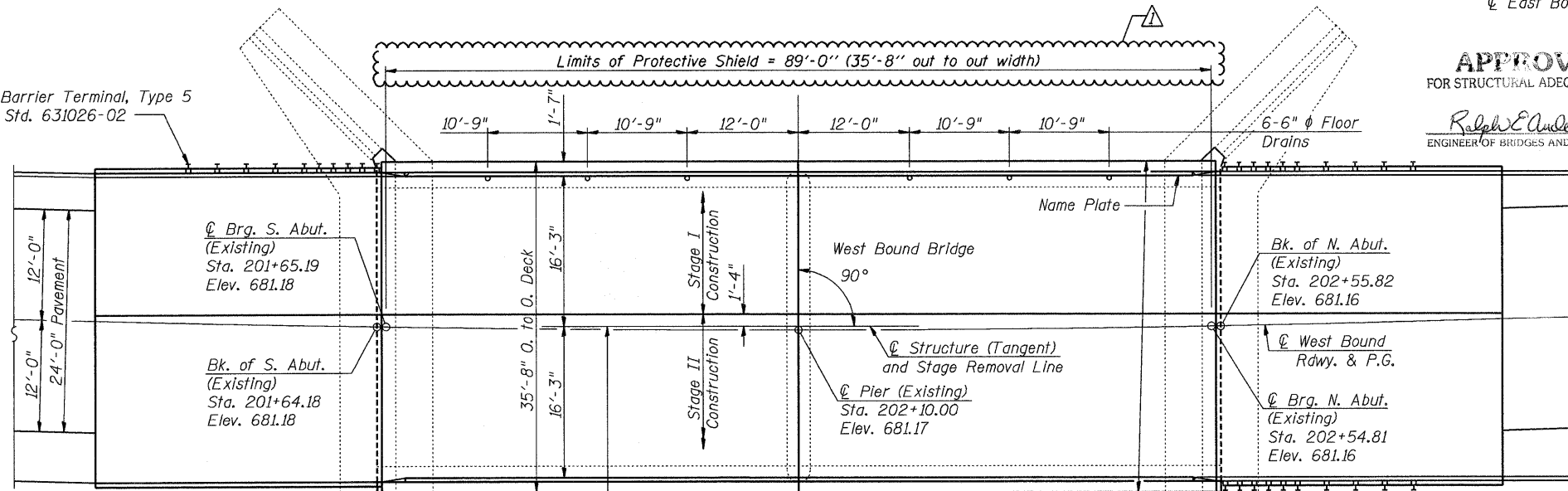

Traffic Barrier Terminal, Type 6  
Std. 631031-05  
Approach Entrances Only, Typ.

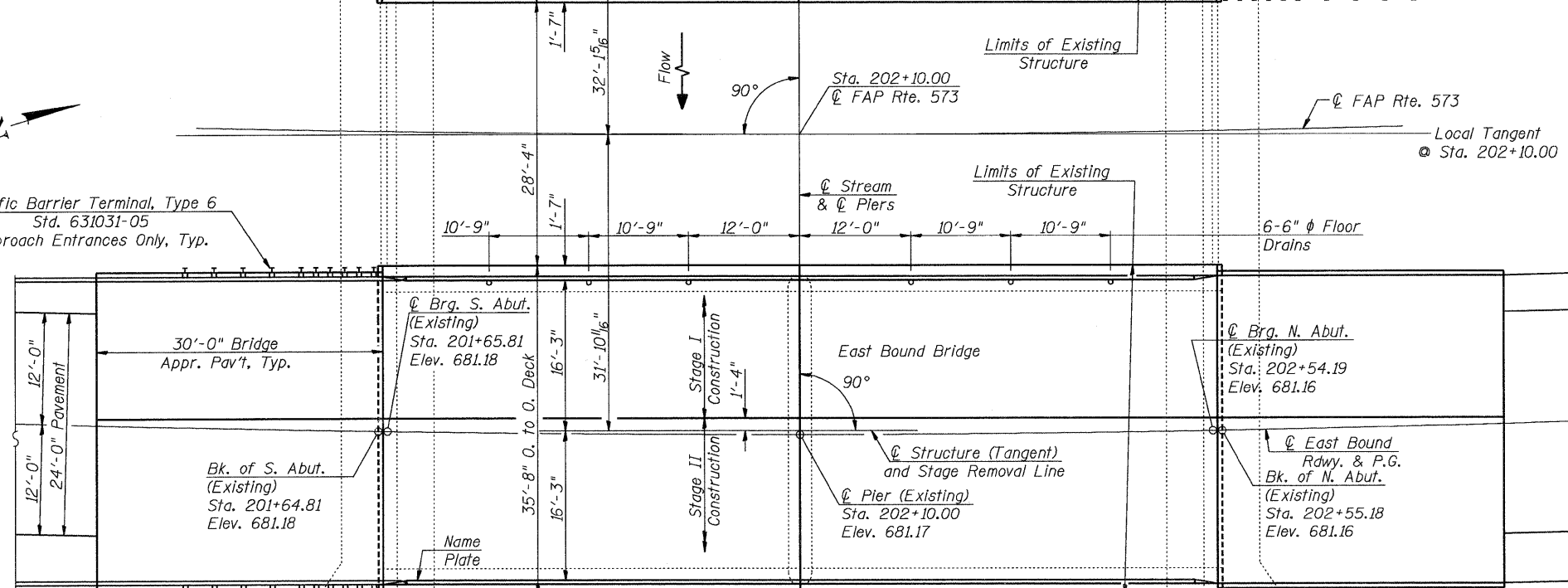

**PLAN**

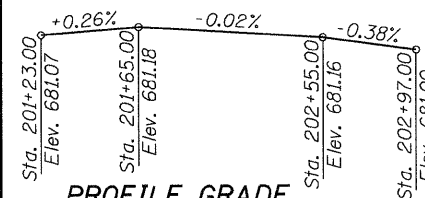

**PROFILE GRADE**  
(along  $\phi$  FAP Rte. 573)



Revised 7/20/09-BLB

**rjngroup**  
Excellence through Ownership

200 West Front Street  
Wheaton, IL 60187

DESIGNED: WJV  
CHECKED: BLB  
DATE: 04/02/09

SHEET NO. 1 17 SHEETS	F.A.P. RTE.	SECTION	COUNTY	TOTAL SHEETS	SHEET NO.
	573	61B-BR-1	KANE	37	13
CONTRACT NO. 62817					
FED. ROAD DIST. NO. 1 ILLINOIS FED. AID PROJECT					

**GENERAL PLAN AND ELEVATION**  
IL RTE. 56 OVER BLACKBERRY CREEK  
STATION 202+10.00  
STRUCTURE NO. 045-0026 (E.B.)  
STRUCTURE NO. 045-0027 (W.B.)