

- LEGEND**
- ① WET REFLECTIVE TEMPORARY TAPE TYPE III, 4" WHITE EDGE LINE
 - ② WET REFLECTIVE TEMPORARY TAPE TYPE III, 4" YELLOW EDGE LINE
 - ③ NOT USED
 - ④ DRUMS WITH STEADY BURNING MONODIRECTIONAL LIGHT
 - ⑤ NOT USED
 - ⑥ NOT USED
 - ⑦ VERTICAL PANELS (BACK TO BACK)
 - ⑧ TEMPORARY CONCRETE BARRIER
 - ⑨ WET REFLECTIVE TEMPORARY TAPE TYPE III, 4" WHITE (10' LINE, 30' SPACE) LINE
- TEMPORARY CONCRETE BARRIER
 TEMPORARY CONCRETE BARRIER WITH MODULAR GLARE SCREEN

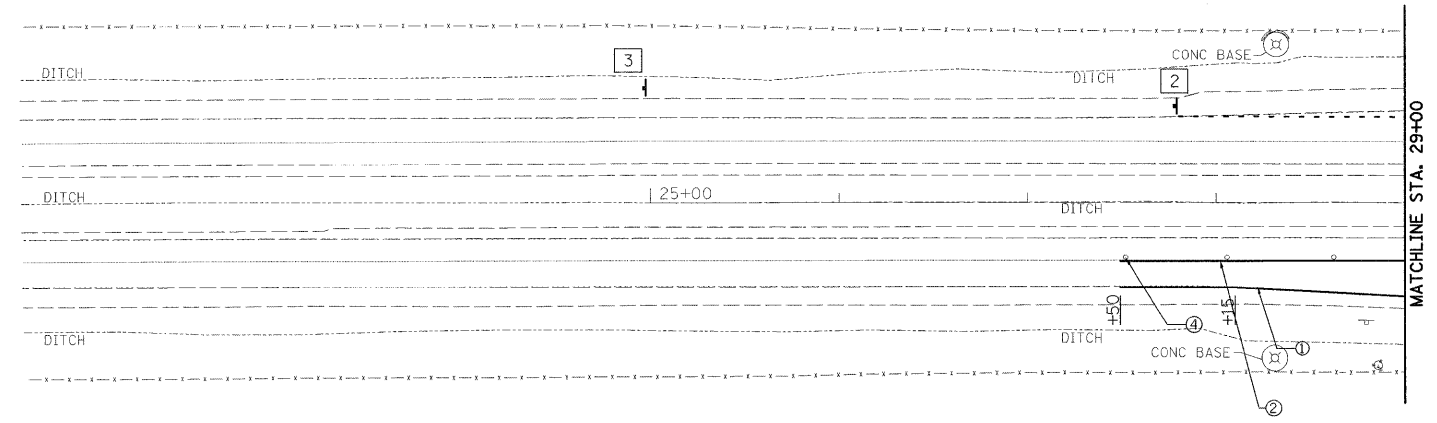

← ADVANCED LANE CLOSURE SIGNING TO BE IN ACCORDANCE WITH STANDARD 701400-03 → → LANE CLOSURE TRAFFIC CONTROL (INCLUDING SIGNING) TO BE IN ACCORDANCE WITH STANDARD 701416-06 →

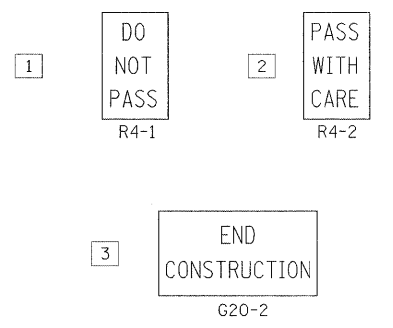
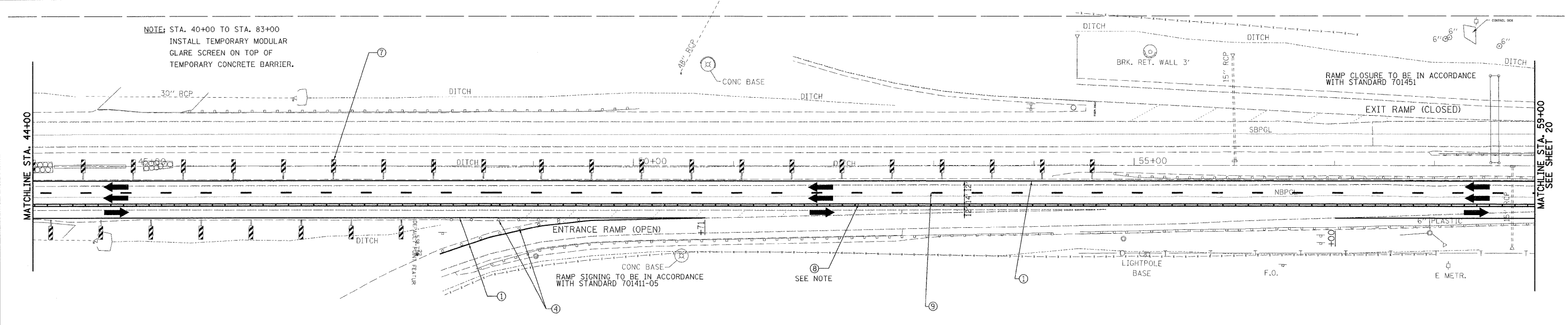
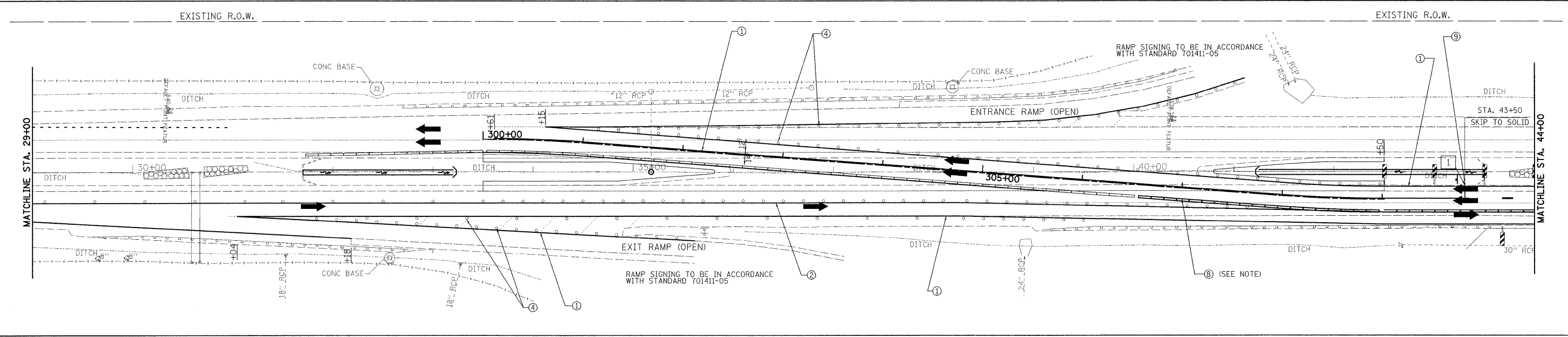

NOTE: STA. 40+00 TO STA. 83+00
INSTALL TEMPORARY MODULAR
GLARE SCREEN ON TOP OF
TEMPORARY CONCRETE BARRIER.



200 West Front Street
Wheaton, IL 60187

DESIGNED - KSD
DRAWN - KSD
CHECKED - CMJ
DATE - 03-04-09

REVISED -
REVISED -
REVISED -
REVISED -

STATE OF ILLINOIS
DEPARTMENT OF TRANSPORTATION

I-55 OVER THE KANKAKEE RIVER
TRAFFIC CONTROL PLAN STAGE III

SCALE: 1" = 50' SHEET NO. 1 OF 2 SHEETS STA. 29+00.00 TO STA. 59+00.00

F.A.I. RTE. 55	SECTION 88 (B&B-1) BR	COUNTY WILL	TOTAL SHEETS 72	SHEET NO. 15
CONTRACT NO. 62930				
FED. ROAD DIST. NO. 1 ILLINOIS FED. AID PROJECT				