

F.A.U. NO.	SECTION	COUNTY	TOTAL SHEETS	SHEET NO.
4724 3569	06-00073-00-LS	COOK	24	10
STA.	TO STA.			
FED. ROAD DIST. NO.	ILLINOIS	FED. AID PROJECT		
CONTRACT NO. 63133				

LEGEND		EXISTING	PROPOSED
[A]	STRUCTURE TO BE ADJUSTED	⊗	⊗
[C]	STRUCTURE TO BE CLEANED	○	○
[F]	FILLING EXISTING STRUCTURE	○	○
[A]	STRUCTURE TO BE ADJUSTED WITH NEW FRAME & LID	○	○
[R]	STRUCTURE TO BE RECONSTRUCTED	○	○
[M]	STRUCTURE TO BE MOVED	○	○
[EM]	STRUCTURE TO BE REMOVED	○	○
[A]	FRAME & LID TO BE ADJUSTED SPECIAL	○	○
////	SEWER TO BE ABANDONED OR REMOVED		
[ASP]	STRUCTURE TO BE ADJUSTED SPECIAL	⊗	⊗
[RSP]	STRUCTURE TO BE RECONSTRUCTED SPECIAL	⊗	⊗
[ASB]	STRUCTURE TO BE ABANDONED	⊗	⊗
[ESP]	FILLING EXISTING STRUCTURE SPECIAL	⊗	⊗
[R]	STRUCTURE TO BE RECONSTRUCTED WITH NEW FRAME & LID	⊗	⊗
[EM]	FILLING EXISTING STRUCTURE AND MAINTAIN FLOW	⊗	⊗
⊗	VALVE VAULT	⊗	⊗
○	MANHOLE	○	○
○	CATCH BASIN	○	○
□	INLET	□	□
○	FIRE HYDRANT	○	○
—	STORM SEWER	—	—
—	SANITARY SEWER	—	—

NOTES:
 1) ALL CURB ELEVATIONS ARE EDGE OF PAVEMENT (E/P) GRADES UNLESS OTHERWISE NOTED.
 2) ALL RIM ELEVATIONS OF DRAINAGE STRUCTURE ARE EDGE OF PAVEMENT (E/P) ELEVATIONS UNLESS OTHERWISE NOTED.

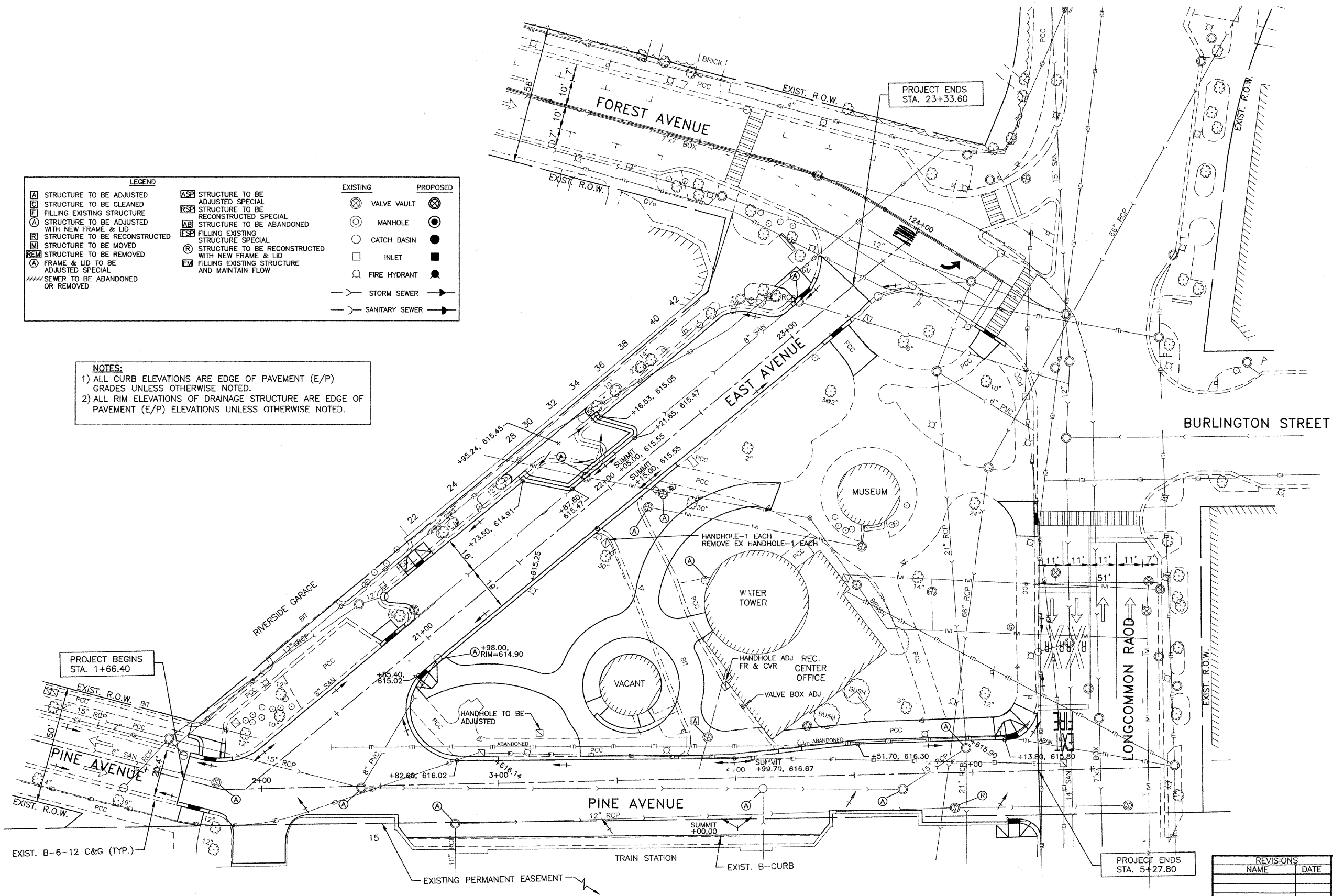

REVISIONS	
NAME	DATE

ILLINOIS DEPARTMENT OF TRANSPORTATION
 FAU ROUTES 1472 & 3569
 VILLAGE OF RIVERSIDE
 RAILWAY/WATER TOWER CAMPUS RESTORATION PROJECT

UTILITY AND GRADING PLAN

SCALE: 1"=20'
 DATE: 12/01/08

DRAWN BY: SMP
 CHECKED BY: BDH