

NOR STATE BANK

**7TH STREET**

FOR CONTINUATION - SEE SHEET NO. 25

HARBOR POINT PLAZA

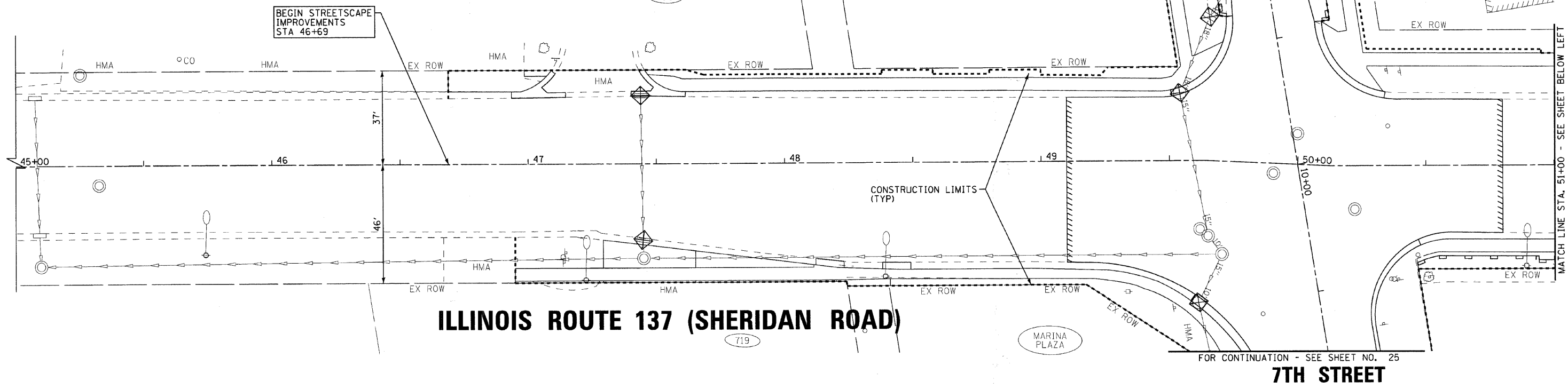

**ILLINOIS ROUTE 137 (SHERIDAN ROAD)**

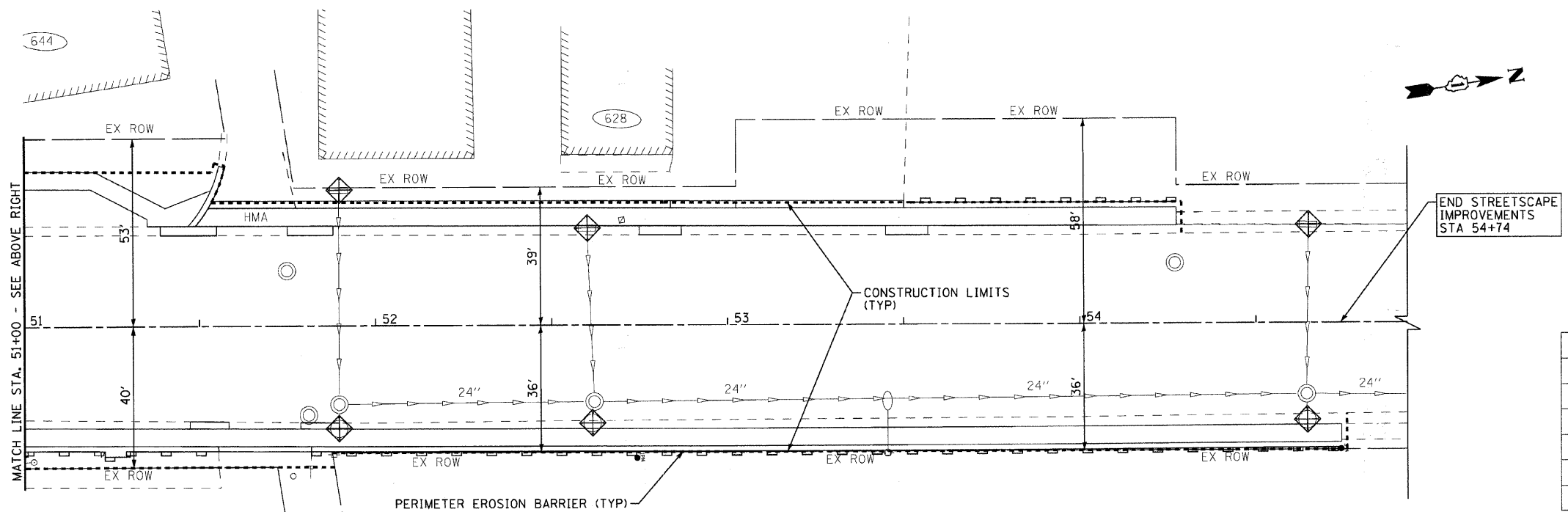

**ILLINOIS ROUTE 137 (SHERIDAN ROAD)**

**LEGEND**

- PERIMETER EROSION BARRIER
- TEMPORARY DITCH CHECKS
- INLET FILTERS
- TREE TRUNK PROTECTION
- TREE ROOT PRUNING

**SCHEDULE OF EROSION CONTROL QUANTITIES**

TEMPORARY DITCH CHECKS	FOOT	0
PERIMETER EROSION BARRIER (INCLUDES MAINTENANCE)	FOOT	495
INLET FILTERS	EACH	8
TREE TRUNK PROTECTION	EACH	0
TREE ROOT PRUNING	EACH	0
TEMPORARY EROSION CONTROL SEEDING	POUND	7
MULCH, METHOD 1	ACRE	0.06

SCALE BAR:  
  
 THIS PLAN SHEET DEPICTS IMPROVEMENTS AT 1" = 20' ON A 22" X 34" SHEET

COPYRIGHT © 2009 BY BAXTER & WOODMAN, INC.  
 STATE OF ILLINOIS - PROFESSIONAL DESIGN FIRM  
 LICENSE NO. 184-00181 - EXPIRES 4/30/2011  
 1/18/2009 8:56:00 AM



DESIGNED - MWP	REVISED - IDOT REVIEW 2/19/09
DRAWN - CJC	REVISED - IDOT REVIEW 4/22/09
CHECKED - MDW	REVISED - IDOT REVIEW 11/17/09
DATE - 8-1-08	REVISED -

**VILLAGE OF WINTHROP HARBOR, ILLINOIS  
 ILLINOIS ROUTE 137 (SHERIDAN ROAD) AND 7th STREET  
 STREETSCAPE IMPROVEMENTS**

**EROSION CONTROL PLAN  
 ILLINOIS ROUTE 137 (SHERIDAN ROAD)**

F.A.P. RTE.	SECTION	COUNTY	TOTAL SHEETS	SHEET NO.
•	06-00036-00-LS	LAKE	70	24
FED. ROAD DIST. NO. 1		CONTRACT NO. 63167		
JOB NO. C-91-197-10		ILLINOIS FED. AID PROJECT ARA-00018101		

SCALE: 1" = 20'      STA. 45+00 TO STA. 55+00