

SECTION 36, TOWNSHIP 37, RANGE 13
SECTION 31, TOWNSHIP 37, RANGE 14

STATE OF ILLINOIS DEPARTMENT OF TRANSPORTATION DIVISION OF HIGHWAYS

PLANS FOR PROPOSED FEDERAL AID HIGHWAY

**WESTERN AVENUE (FAP 0370) & VERMONT STREET (FAU 1594)
WESTERN AVENUE (FAP 0370) & YORK STREET
INTERSECTION ENHANCEMENTS**

**PROJECT NO.: ARA-9003 (338)
L.A. SECTION NO.: 09-00183-00-SP
JOB NO.: C-91-654-09
CITY of BLUE ISLAND
COOK COUNTY**

F. A. P. NO.	SECTION	COUNTY	TOTAL SHEETS	SHEET NO.
0370	09-00183-00-SP	COOK	16	1
STA.	TO STA.			
FED. ROAD DIST. NO. 1	ILLINOIS	FED. AID PROJECT ARA-9003 (338)		

CONTRACT #63313

INDEX OF SHEETS

1. COVER SHEET
2. SUMMARY OF QUANTITIES & GENERAL NOTES
3. TYPICAL CROSS SECTIONS
4. DETOUR PLAN
- 5.-6. REMOVAL PLAN
- 7.-8. PLAN & PROFILE SHEETS
- 9.-11. PAVEMENT MARKING AND SIGNAGE PLAN
- 12.-16. DISTRICT ONE STANDARD DETAILS

HIGHWAY STANDARDS

- | | |
|-----------|--|
| 000001-05 | STANDARD SYMBOLS, ABBREVIATIONS AND PATTERNS |
| 420001-07 | PAVEMENT JOINTS |
| 420111-02 | PCC PAVEMENT ROUNDOUTS |
| 420601-05 | 24' PCC PAVEMENT |
| 420701-02 | PAVEMENT FABRIC |
| 424001-05 | CURB RAMPS FOR SIDEWALKS |
| 606001-04 | CONCRETE CURB TYPE B AND COMBINATION CONCRETE CURB AND GUTTER |
| 701006-03 | OFF-RD OPERATIONS, 2L, 2W, 15' TO 24" FROM PAVEMENT EDGE |
| 701501-05 | URBAN LANE CLOSURE, 2L, 2W, UNDIVIDED |
| 701601-06 | URBAN LANE CLOSURE, MULTILANE, 1W OR 2W WITH NONTRAVERSABLE MEDIAN |
| 701701-06 | URBAN LANE CLOSURE, MULTILANE INTERSECTION |
| 701801-04 | LANE CLOSURE MULTILANE 1W OR 2W CROSSWALK OR SIDEWALK CLOSURE |
| 701901-01 | TRAFFIC CONTROL DEVICES |
| 720001-01 | SIGN PANEL MOUNTING DETAILS |
| 720006-02 | SIGN PANEL ERECTION DETAILS |
| 728001-01 | TELESCOPING STEEL SIGN SUPPORT |
| 780001-02 | TYPICAL PAVEMENT MARKINGS |

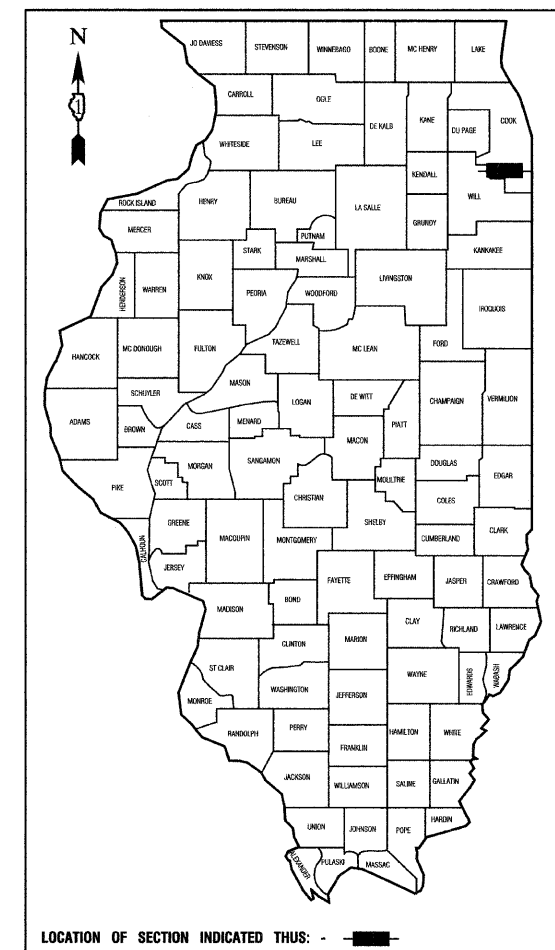

WESTERN AVENUE
ADT = 8,400 (2009)
DESIGN SPEED = 25 MPH
SPEED LIMIT = 25 MPH

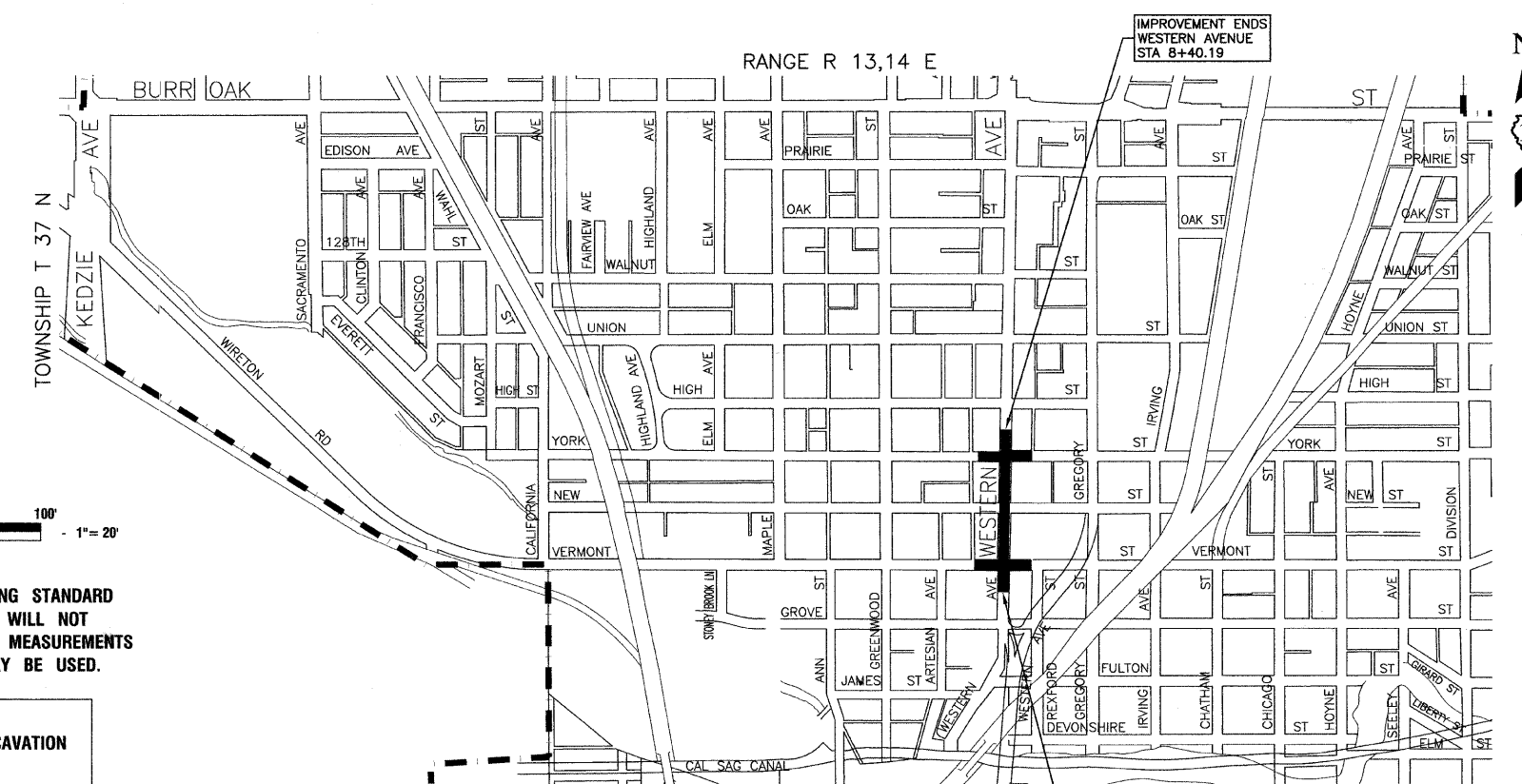
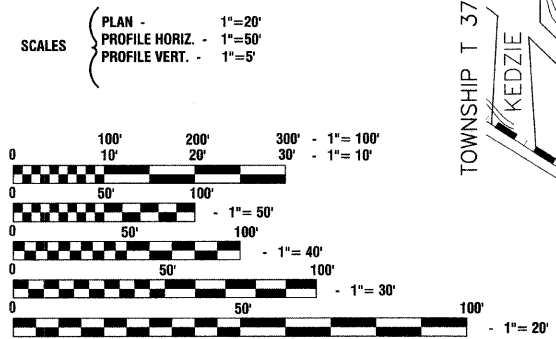

LOCATION MAP
GROSS LENGTH=750 FEET=0.14 MILES
NET LENGTH=750 FEET=0.14 MILES

IMPROVEMENT BEGINS
WESTERN AVENUE
STA 0+91.81

IMPROVEMENT ENDS
WESTERN AVENUE
STA 8+40.19

I.D.O.T. FEDERAL AID DESIGN ENGINEER: MELCHOR MANGOBA 847-705-4408
CONSULTANTS: ROBINSON ENGINEERING, LTD. 708-331-6700

FULL SIZE PLANS HAVE BEEN PREPARED USING STANDARD ENGINEERING SCALES, REDUCED SIZED PLANS WILL NOT CONFORM TO STANDARD SCALES, IN MAKING MEASUREMENTS ON REDUCED PLANS, THE ABOVE SCALES MAY BE USED.

J. U. L. I. E.
JOINT UTILITY LOCATION INFORMATION FOR EXCAVATION
1-800-892-0123 or 811

CONTRACT NO. 63313

STATE OF ILLINOIS DEPARTMENT OF TRANSPORTATION
DIVISION OF HIGHWAYS

Approved: [Signature]
10/13/09
Mayor, City of Blue Island

Passed: OCTOBER 26, 2009
[Signature]
District 1 Engineer of Local Roads & Streets

Released for Bid Based on Limited Review: OCTOBER 26, 2009
[Signature]
Deputy Director of Highways, Region 1 Engineer

PRINTED BY THE AUTHORITY OF THE STATE OF ILLINOIS

PREPARED BY OR UNDER THE DIRECT SUPERVISION OF:
[Signature]
10/13/09

