

12+1=13

F. A. R. NO.	SECTION	COUNTY	TOTAL SHEETS	SHEET NO.
1003 1001	09-00030-00-RS	COOK	12	1
STA.		TO STA.		
FED. ROAD DIST. NO. 1	CLASSES	FED. AID PROJECT ARA-9003(422)		

CONTRACT #63324

STATE OF ILLINOIS
DEPARTMENT OF TRANSPORTATION
DIVISION OF HIGHWAYS

**PLANS FOR PROPOSED
FEDERAL AID HIGHWAY**

FAU 1003 (127TH STREET) - 80TH AVENUE TO 123RD STREET
FAU 1001 (121ST STREET) - SOUTHWEST HIGHWAY TO 80TH AVENUE

LOCAL AGENCY PRESERVATION PROGRAM

SECTION NO.: 09-00030-00-RS

PROJECT NO.: ARA-9003(422)

JOB NO. C-91-826-09

LEAD LOCAL AGENCY : VILLAGE of PALOS PARK

CITY of PALOS HEIGHTS

PALOS TOWNSHIP

COOK COUNTY

INDEX OF SHEETS

- COVER SHEET, INDEX OF SHEETS, LOCATION MAP, & STATE STANDARDS
- SUMMARY OF QUANTITIES, & GENERAL NOTES
- 5. TYPICAL CROSS SECTIONS
- PAVEMENT PLAN 127TH STREET
- PAVEMENT PLAN 121ST STREET
- STRIPING PLAN 127TH STREET
- STRIPING PLAN 121ST STREET
- 10.-12A. IDOT DISTRICT 1 STANDARD DETAILS

HIGHWAY STANDARDS

- 000001-05 STANDARD SYMBOLS, ABBREVIATIONS AND PATTERNS
- 442201-03 CLASS C AND D PATCHES
- 606001-04 CONCRETE CURB TYPE B AND COMBINATION CONCRETE CURB AND GUTTER
- 701501-05 URBAN LANE CLOSURE, 2L, 2W, UNDIVIDED
- 701801-04 LANE CLOSURE MULTILANE 1W OR 2W CROSSWALK OR SIDEWALK CLOSURE
- 701901-01 TRAFFIC CONTROL DEVICES
- 780001-02 TYPICAL PAVEMENT MARKINGS

127TH STREET
ADT=3,000 (2008)
=3,000 (2030)
DESIGN SPEED=25 MPH
SPEED LIMIT=20 MPH

121ST STREET
ADT=2,000 (2008)
=2,000 (2030)
DESIGN SPEED=25 MPH
SPEED LIMIT=20 MPH

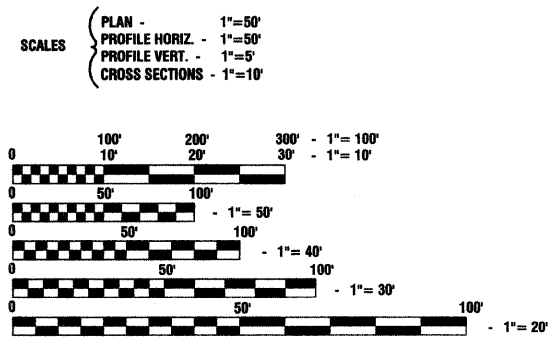

FULL SIZE PLANS HAVE BEEN PREPARED USING STANDARD ENGINEERING SCALES, REDUCED SIZED PLANS WILL NOT CONFORM TO STANDARD SCALES, IN MAKING MEASUREMENTS ON REDUCED PLANS, THE ABOVE SCALES MAY BE USED.

J. U. L. I. E.
JOINT UTILITY LOCATION INFORMATION FOR EXCAVATION
1-800-892-0123 or 811

CONTRACT NO. 63324

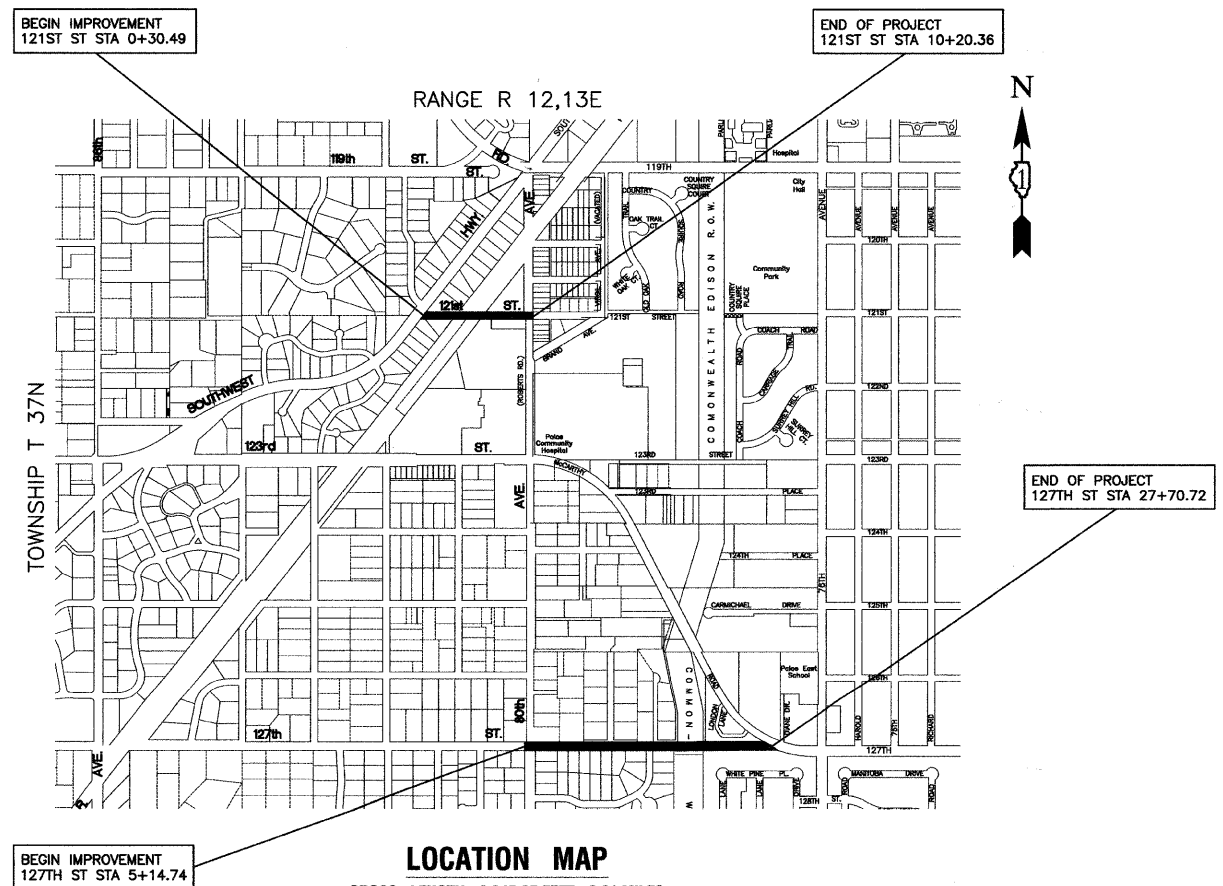

LOCATION MAP
GROSS LENGTH=3,245.85 FEET=0.61 MILES
NET LENGTH=3,245.85 FEET=0.61 MILES

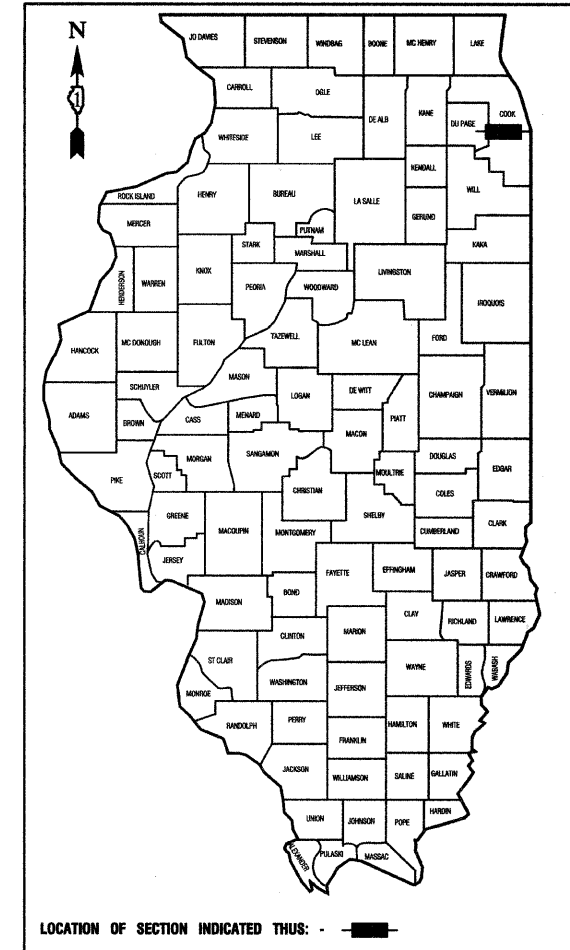

STATE OF ILLINOIS DEPARTMENT OF TRANSPORTATION
DIVISION OF HIGHWAYS

Approved: Joseph Mahony
Mayor
President, Village of Palos Park

Passed: OCTOBER 26, 2009
Christina Healy
District 1 Engineer of Local Roads & Streets

Released for Bid Based on Limited Review: OCTOBER 26, 2009
Diana M. O'Keefe
Deputy Director of Highways, Region 1 Engineer

PRINTED BY THE AUTHORITY OF THE STATE OF ILLINOIS

PREPARED BY OR UNDER THE DIRECT SUPERVISION OF:
Kevin S. Pius
10-1-09

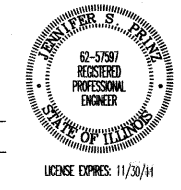

FIELD ENGINEER: MELCHOR MANGOBA (847) 705-4408
CONSULTANTS: ROBINSON ENGINEERING, LTD. 708-331-6700

SUMMARY OF QUANTITIES					PAVEMENT		CONSTRUCTION TYPE CODE	
S.I.	CODE NO.	PAY ITEM	UNIT	QUANTITY	1000			
	20101700	SUPPLEMENTAL WATERING	UNIT	1	1			
	21400100	GRADING AND SHAPING DITCHES	FOOT	2000	2000			
	25000110	SEEDING, CLASS 1A	ACRE	.25	.25			
	25000400	NITROGEN FERTILIZER NUTRIENT	POUND	23	23			
	25000500	PHOSPHORUS FERTILIZER NUTRIENT	POUND	23	23			
	25000600	POTASSIUM FERTILIZER NUTRIENT	POUND	23	23			
	35800200	AGGREGATE BASE REPAIR	TON	43	43			
	40300700	PREPARATION OF BASE	SQ YD	185	185			
	40600100	BITUMINOUS MATERIALS (PRIME COAT)	GALLON	1767	1767			
	40600300	AGGREGATE (PRIME COAT)	TON	23	23			
	40600982	HOT-MIX ASPHALT SURFACE REMOVAL - BUTT JOINT	SQ YD	536	536			
	40603310	HOT-MIX ASPHALT SURFACE COURSE, MIX "C", N50	TON	743	743			
	42300300	PORTLAND CEMENT CONCRETE DRIVEWAY PAVEMENT, 7 INCH	SQ YD	52	52			
	44000157	HOT-MIX ASPHALT SURFACE REMOVAL, 2"	SQ YD	8596	8596			
	44000158	HOT-MIX ASPHALT SURFACE REMOVAL, 2 1/4"	SQ YD	238	238			
	44000200	DRIVEWAY PAVEMENT REMOVAL	SQ YD	354	354			
	44001700	COMBINATION CONCRETE CURB AND GUTTER REMOVAL AND REPLACEMENT	FOOT	24	24			
	44201725	CLASS D PATCHES, TYPE I, 7 INCH	SQ YD	8	8			
	44201729	CLASS D PATCHES, TYPE II, 7 INCH	SQ YD	74	74			
	44201733	CLASS D PATCHES, TYPE III, 7 INCH	SQ YD	39	39			
	44201735	CLASS D PATCHES, TYPE IV, 7 INCH	SQ YD	253	253			
	48102100	AGGREGATE WEDGE SHOULDER, TYPE B	TON	107	107			
	54213657	PRECAST REINFORCED CONCRETE FLARED END SECTIONS 12"	EACH	2	2			
	542A0217	PIPE CULVERTS, CLASS A, TYPE 1 12"	FOOT	66	66			
	55100100	STORM SEWER REMOVAL, 4"	FOOT	25	25			
	55100500	STORM SEWER REMOVAL, 12"	FOOT	42	42			
	60255500	MANHOLES TO BE ADJUSTED	EACH	1	1			
	60266600	VALVE BOXES TO BE ADJUSTED	EACH	4	4			
	67100100	MOBILIZATION	L SUM	1	1			
	70102620	TRAFFIC CONTROL AND PROTECTION, STANDARD 701501	L SUM	1	1			
	70102640	TRAFFIC CONTROL AND PROTECTION, STANDARD 701801	L SUM	1	1			
*	78000200	THERMOPLASTIC PAVEMENT MARKING - LINE 4"	FOOT	1455	1455			
*	78000400	THERMOPLASTIC PAVEMENT MARKING - LINE 6"	FOOT	205	205			
*	78000600	THERMOPLASTIC PAVEMENT MARKING - LINE 12"	FOOT	80	80			
*	78000650	THERMOPLASTIC PAVEMENT MARKING - LINE 24"	FOOT	27	27			
	X0301245	SHOULDER REMOVAL	SQ YD	911	911			
	X4067107	POLYMERIZED LEVELING BINDER (MACHINE METHOD), IL-4.75, N50	TON	496	496			
	XX006806	HOT-MIX ASPHALT DRIVEWAY PAVEMENT	SQ YD	303	303			
	Z0048665	RAILROAD PROTECTIVE LIABILITY INSURANCE	L SUM	1	1			
	XX008230	HOT-MIX ASPHALT DRIVEWAY PAVEMENT (SPECIAL)	SQ YD	39	39			
	XX008231	AGGREGATE DRIVEWAY REMOVAL AND REPLACEMENT	SQ YD	115	115			

GENERAL NOTES:

- BEFORE STARTING ANY EXCAVATION, THE CONTRACTOR SHALL CALL "J.U.L.I.E." AT (800) 892-0123 AND (312) 744-7000 FOR FIELD LOCATIONS OF BURIED ELECTRIC, TELEPHONE AND GAS UTILITIES. (48 HOUR NOTIFICATION IS REQUIRED).
- UTILITIES INDICATED ON THE PLANS ARE PROVIDED FOR THE CONTRACTOR'S USE AND ARE BASED UPON INFORMATION AVAILABLE AT THE TIME OF THE ADVERTISEMENT FOR BIDS. THE OWNER AND ENGINEER DO NOT GUARANTEE THE ACCURACY OF UTILITIES INFORMATION.
- IT SHALL BE THE CONTRACTOR'S RESPONSIBILITY TO VERIFY ALL DIMENSIONS AND CONDITIONS EXISTING IN THE FIELD PRIOR TO CONSTRUCTION AND ORDERING OF MATERIALS.
- SCHEDULES INCLUDED IN THE PLANS HAVE BEEN PREPARED FROM FIELD NOTES. EXACT LOCATIONS FOR PATCHING SHALL BE DETERMINED IN THE FIELD BY THE ENGINEER.
- ANY REFERENCE TO STANDARDS THROUGHOUT THE PLANS OR SPECIAL PROVISIONS SHALL BE INTERPRETED TO BE THE LATEST STANDARDS OF THE ILLINOIS DEPARTMENT OF TRANSPORTATION.
- THE THICKNESS OF HMA MIXTURE STATED IN THE SPECIFICATIONS IS THE NOMINAL THICKNESS. DEVIATIONS FROM THE NOMINAL THICKNESS WILL BE PERMITTED WHEN SUCH DEVIATIONS OCCUR DUE TO IRREGULARITIES IN THE EXISTING SURFACE OR BASE ON WHICH THE HMA SURFACE IS PLACED.
- ACCESS TO DRIVEWAYS SHALL BE MAINTAINED AT ALL TIMES BY LIMITING CURB AND GUTTER REPAIR TO ONE-HALF THE DRIVEWAY WIDTH AT ONE TIME AS WELL AS TEMPORARY AGGREGATE. THIS TEMPORARY AGGREGATE SHALL BE INCLUDED IN THE COST OF THE CONTRACT.

* - INDICATES SPECIALTY ITEMS

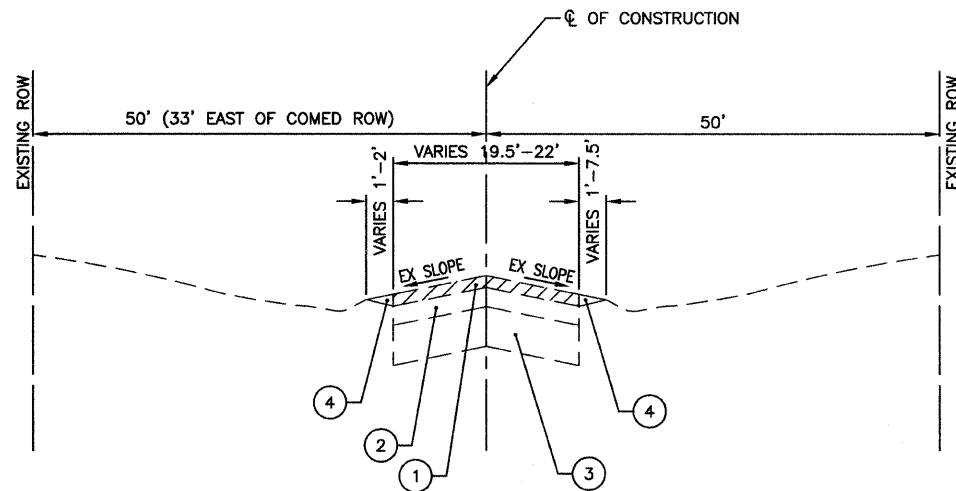

EXISTING TYPICAL SECTION
127TH STREET
STA 5+14.74 TO STA 27+70.72

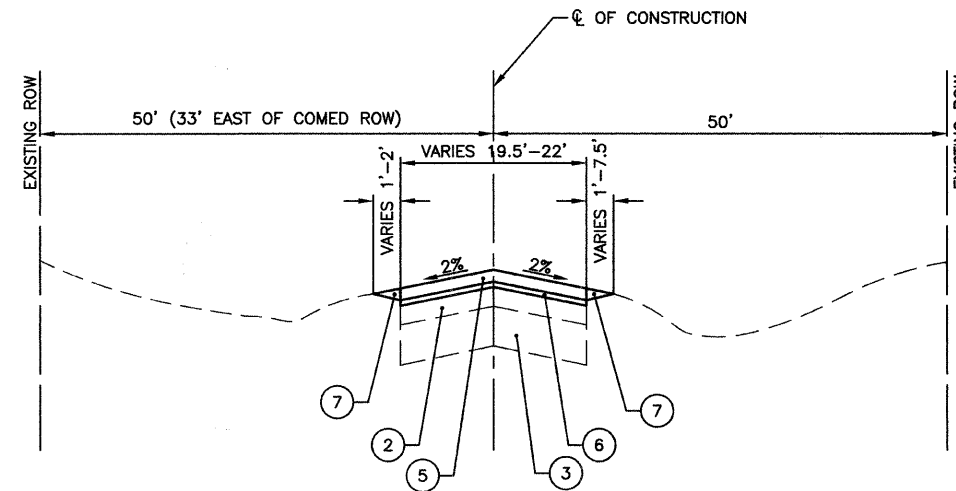

PROPOSED TYPICAL SECTION
127TH STREET
STA 5+14.74 TO STA 27+70.72

LEGEND

- ① HOT-MIX ASPHALT SURFACE REMOVAL, 2"
- ② EXISTING HOT-MIX ASPHALT PAVEMENT TO REMAIN, ±4"
- ③ EXISTING AGGREGATE BASE TO REMAIN
- ④ EXISTING STONE SHOULDER
- ⑤ HOT-MIX ASPHALT SURFACE COURSE, MIX "C", N50, 1.5"
- ⑥ POLYMERIZED LEVELING BINDER (MACHINE METHOD), IL-4.75, N50, 0.75"
- ⑦ AGGREGATE WEDGE SHOULDER, TYPE B
- ⑧ EXISTING PCC SIDEWALK
- ⑨ EXISTING CURB & GUTTER

TYPICAL SECTION NOTES

CLASS D PATCHES, TYPES II, III, AND IV TO BE DETERMINED IN FIELD BY RESIDENT ENGINEER.
CONTRACTOR SHALL MILL BEFORE PATCHING.
CONTRACTOR SHALL NOTE THAT PETROMAT WAS SHOWN TO BE IN EXISTENCE IN THE PAVEMENT CROSS SECTION.

HOT-MIX ASPHALT MIXTURE REQUIREMENTS

MIXTURE TYPE	AIR VOIDS
RESURFACING	
HOT MIX ASPHALT SURFACE COURSE, MIX "C", N50(IL-9.5mm); 1.5"	4% @ 50 Gyr.
POLYMERIZED LEVELING BINDER (MACHINE METHOD), IL-4.75, N50, 0.75"	4% @ 50 Gyr.
DRIVEWAYS	
HOT MIX ASPHALT SURFACE COURSE, MIX "C", N50(IL-9.5mm); 2"	4% @ 50 Gyr.
HOT MIX ASPHALT BASE COURSE, (HMA BINDER IL-19.0mm); 2.5"	4% @ 50 Gyr.
PATCHING	
CLASS D PATCHES, TYPE II, III, IV (HMA BINDER IL-19.0mm); 7"	4% @ 70 Gyr.

NOTE:
THE UNIT WEIGHT USED TO CALCULATE ALL HMA SURFACE MIXTURE QUANTITIES IS 112 LBS/SQ YD/IN.
THE "AC TYPE" FOR POLYMERIZED HMA MIXES SHALL BE "SBS/SBR PG 70-22" AND FOR NON-POLYMERIZED HMA THE "AC TYPE" SHALL BE "PG 64-22" UNLESS MODIFIED BY DISTRICT ONE SPECIAL PROVISIONS FOR "PERCENT OF RAP" SEE DISTRICT ONE SPECIAL PROVISIONS.

FILE NAME = 08359-TYPX-01 - IDOT P01	USER NAME =	DESIGNED -- JSP	REVISED --
		CHECKED -- JSP	REVISED --
	PLOT SCALE =	DRAWN -- PS	REVISED --
	PLOT DATE = 10-15-09	CHECKED -- AG	REVISED --

STATE OF ILLINOIS
DEPARTMENT OF TRANSPORTATION

127TH STREET & 121ST STREET RESURFACING		F.A.U. RTE.	SECTION	COUNTY	TOTAL SHEETS	SHEET NO.
127TH STREET		1003/1001	09-00030-00-RS	COOK	12	3
TYPICAL CROSS SECTIONS		CONTRACT NO. 63324		FED. ROAD DIST. NO. 1 ILLINOIS FED. AID PROJECT ARA-9003(422)		
SCALE: NONE	SHEET NO. 3 OF 12 SHEETS	STA.	TO STA.			

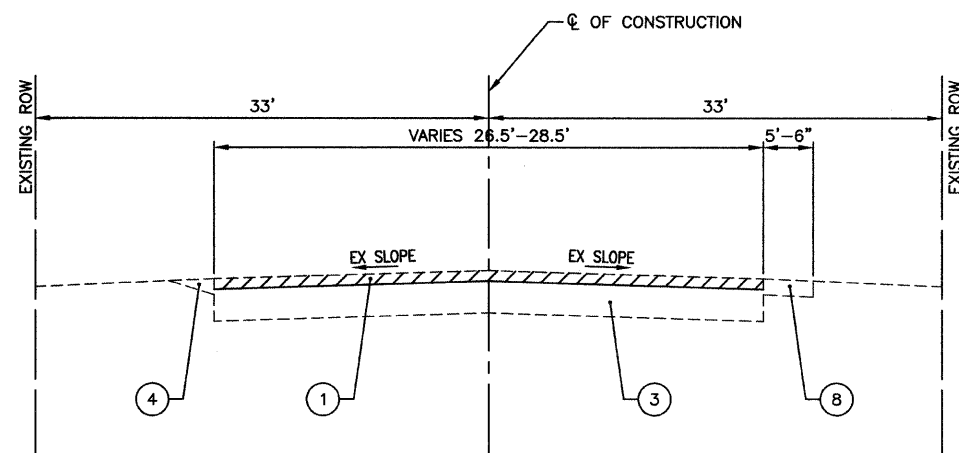

EXISTING TYPICAL SECTION

121ST STREET
STA 0+30.49 TO METRA TRACKS

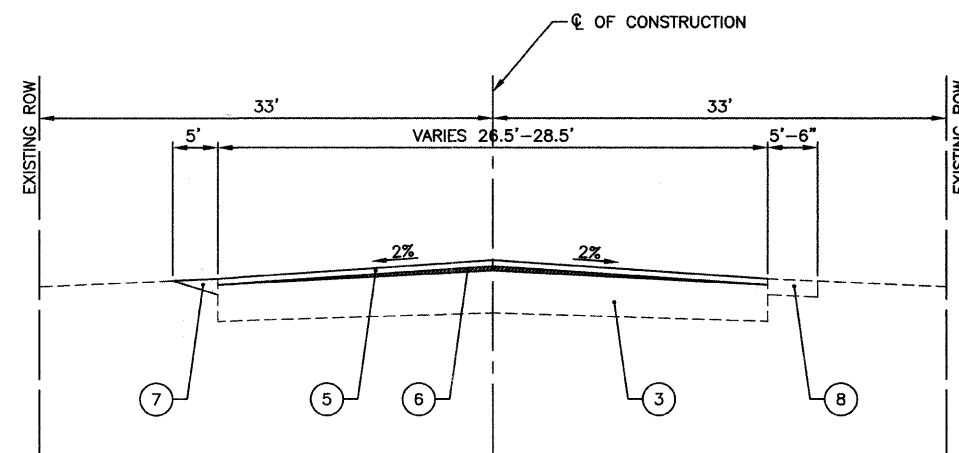

PROPOSED TYPICAL SECTION

121ST STREET
STA 0+30.49 TO METRA TRACKS

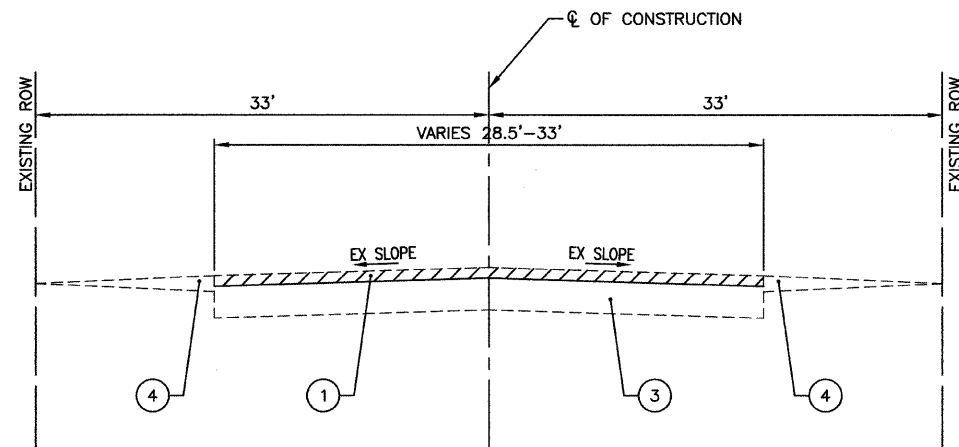

EXISTING TYPICAL SECTION

121ST STREET
METRA TRACKS TO STA 10+20.36

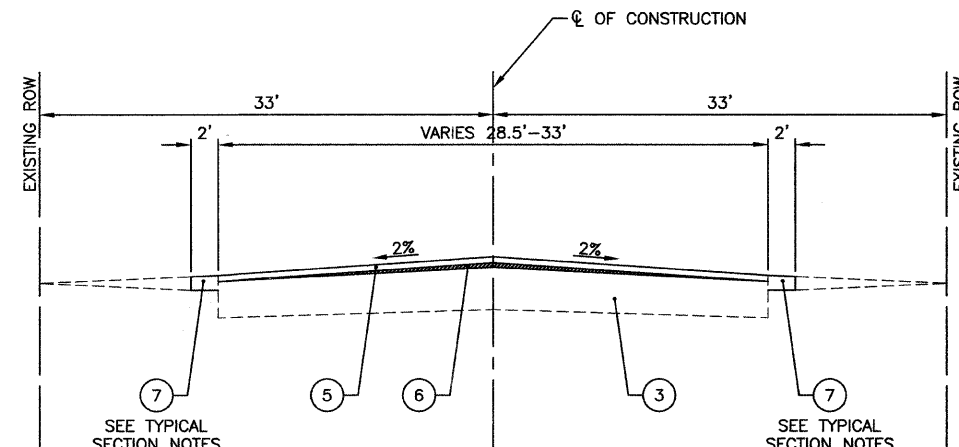

PROPOSED TYPICAL SECTION

121ST STREET
METRA TRACKS TO STA 10+20.36

LEGEND

- ① HOT-MIX ASPHALT SURFACE REMOVAL, 2"
- ② EXISTING HOT-MIX ASPHALT PAVEMENT TO REMAIN, ±4"
- ③ EXISTING AGGREGATE BASE TO REMAIN
- ④ EXISTING STONE SHOULDER
- ⑤ HOT-MIX ASPHALT SURFACE COURSE, MIX "C", N50, 1.5"
- ⑥ POLYMERIZED LEVELING BINDER (MACHINE METHOD), IL-4.75, N50, 0.75"
- ⑦ AGGREGATE WEDGE SHOULDER, TYPE B
- ⑧ EXISTING PCC SIDEWALK
- ⑨ EXISTING CURB & GUTTER

TYPICAL SECTION NOTES

CLASS D PATCHES, TYPES II, III, AND IV TO BE DETERMINED IN FIELD BY RESIDENT ENGINEER.

PAY WIDTH FOR AGGREGATE WEDGE SHOULDER, TYPE B ON 121ST STREET EAST OF METRA TRACKS SHALL BE 2 FEET.

FILE NAME = 0959_01-TYPX-01 - IDOT P01	USER NAME =	DESIGNED -- JSP	REVISED --
		CHECKED -- JSP	REVISED --
	PLOT SCALE =	DRAWN -- PS	REVISED --
	PLOT DATE = 10-15-09	CHECKED -- AG	REVISED --

STATE OF ILLINOIS
DEPARTMENT OF TRANSPORTATION

127TH STREET & 121ST STREET RESURFACING		F.A.U. NO.	SECTION	COUNTY	TOTAL SHEETS	SHEET NO.
121ST STREET		1003/1001	09-00030-00-RS	COOK	12	4
TYPICAL CROSS SECTIONS		CONTRACT NO. 63324				
SCALE: NONE	SHEET NO. 4 OF 12 SHEETS	STA.	TO STA.	FED. ROAD DIST. NO. 1 ILLINOIS FED. AID PROJECT ARA-9003(422)		

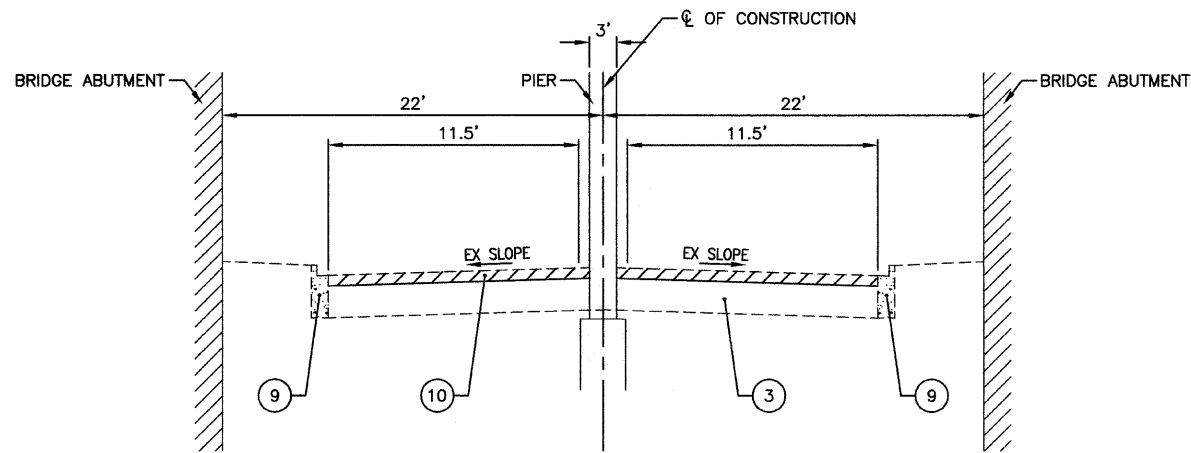

14'-6" EXISTING VERTICAL CLEARANCE

EXISTING TYPICAL SECTION

121ST STREET
METRA TRACKS

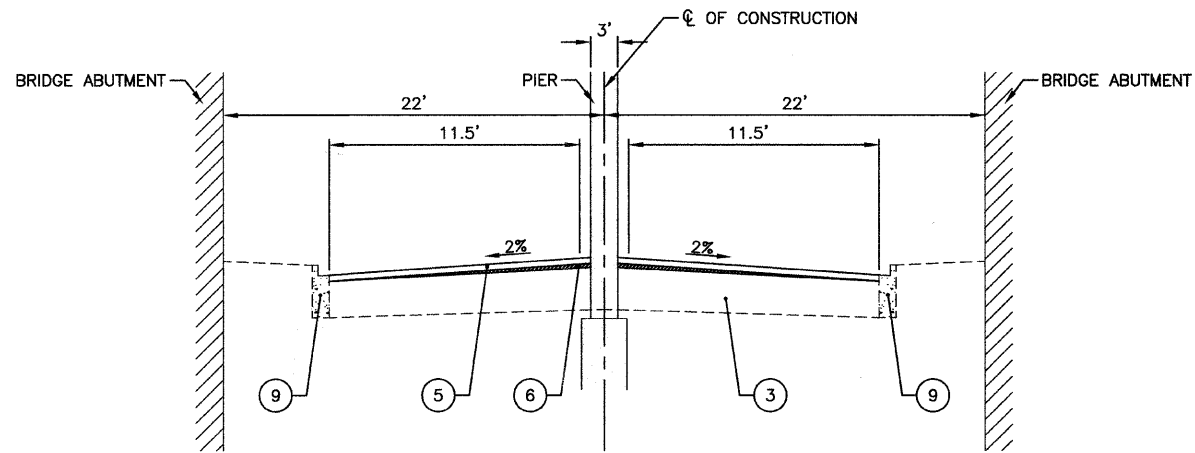

14'-6" PROPOSED VERTICAL CLEARANCE

PROPOSED TYPICAL SECTION

121ST STREET
METRA TRACKS

LEGEND

- ① HOT-MIX ASPHALT SURFACE REMOVAL, 2"
- ② EXISTING HOT-MIX ASPHALT PAVEMENT TO REMAIN, ±4"
- ③ EXISTING AGGREGATE BASE TO REMAIN
- ④ EXISTING STONE SHOULDER
- ⑤ HOT-MIX ASPHALT SURFACE COURSE, MIX "C", N50, 1.5"
- ⑥ POLYMERIZED LEVELING BINDER (MACHINE METHOD), IL-4.75, N50, 0.75"
- ⑦ AGGREGATE WEDGE SHOULDER, TYPE B
- ⑧ EXISTING PCC SIDEWALK
- ⑨ EXISTING CURB & GUTTER
- ⑩ HOT-MIX ASPHALT SURFACE REMOVAL, 2.25"

TYPICAL SECTION NOTES

CLASS D PATCHES, TYPES II, III, AND IV TO BE DETERMINED IN FIELD BY RESIDENT ENGINEER.

PAY WIDTH FOR AGGREGATE WEDGE SHOULDER, TYPE B ON 121ST STREET EAST OF METRA TRACKS SHALL BE 2 FEET.

CONTRACTOR SHALL MILL 2.25" BENEATH METRA TRACKS IN ORDER TO MAINTAIN EXISTING VERTICAL CLEARANCE OF 14'-6" AFTER CONSTRUCTION COMPLETION.

FILE NAME = 09359_01-TYPX-01 - IDOT P02

USER NAME =	DESIGNED -- JSP	REVISED --
	CHECKED -- JSP	REVISED --
PLOT SCALE =	DRAWN -- PS	REVISED --
PLOT DATE = 10-15-09	CHECKED -- AG	REVISED --

STATE OF ILLINOIS
DEPARTMENT OF TRANSPORTATION

127TH STREET & 121ST STREET RESURFACING		F.A.U. RTE.	SECTION	COUNTY	TOTAL SHEETS	SHEET NO.
121ST STREET		1003/1001	09-00030-00-RS	COOK	12	5
TYPICAL CROSS SECTIONS		CONTRACT NO. 63324		FED. ROAD DIST. NO. 1 ILLINOIS FED. AID PROJECT ARA-9003(422)		
SCALE: NONE	SHEET NO. 5 OF 12 SHEETS	STA.	TO STA.			

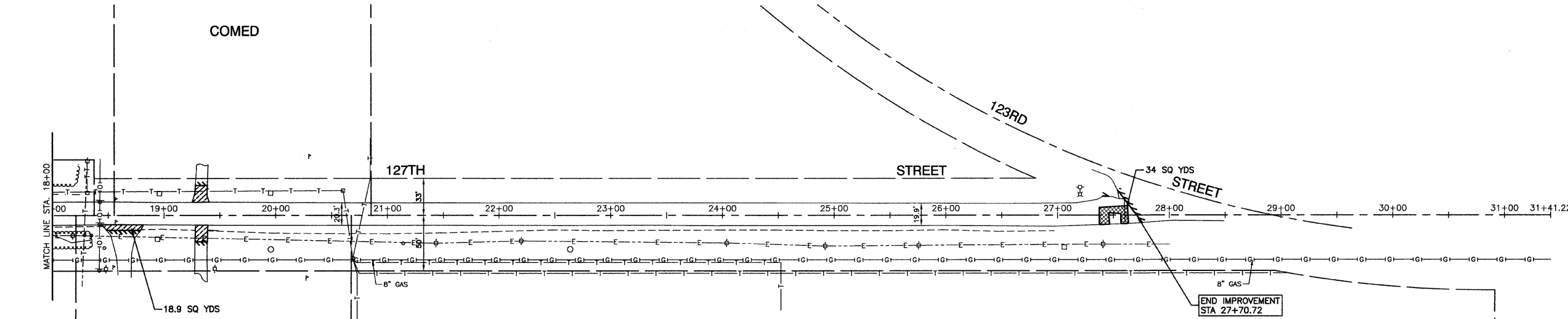
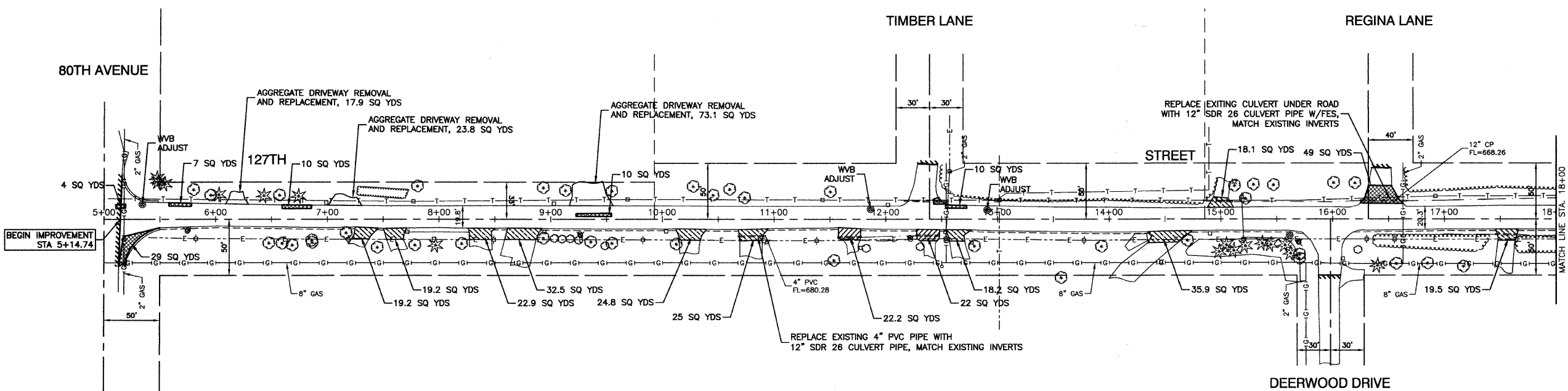
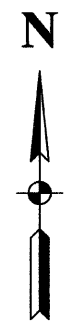

- NOTE:**
- LIMIT OF CONSTRUCTION ON ALL SIDE STREETS IS THE RADIUS RETURN PLUS 10' BUTT JOINT OR ROW AS NOTED.
 - ACCESS TO ALL DRIVEWAYS SHALL BE MAINTAINED UPON COMPLETION OF EACH WORKDAY. RESIDENTS SHALL BE NOTIFIED 24 HOURS IN ADVANCE OF WHEN DRIVEWAY REPLACEMENT WILL TAKE PLACE.
 - ALL HMA AND PCC DRIVEWAYS SHALL BE REPLACED WITH THE SAME MATERIAL. THE CONTRACTOR SHALL NOTE EXISTING NON-STANDARD CONCRETE AND ASPHALT WORK AND REPLACE IN KIND.

LEGEND

	CLASS D PATCHES
	HOT-MIX ASPHALT DRIVEWAY REMOVAL AND REPLACEMENT
	CONCRETE DRIVEWAY REMOVAL AND REPLACEMENT
	HOT-MIX ASPHALT SURFACE REMOVAL - BUTT JOINT
	AGGREGATE SHOULDER REMOVAL AND REPLACEMENT
	CONCRETE CURB, CONCRETE CURB AND GUTTER REMOVAL AND REPLACEMENT
"A"	STRUCTURE TO BE ADJUSTED
"R"	STRUCTURE TO BE RECONSTRUCTED
⊙	EXISTING MANHOLE
○	EXISTING CATCH BASIN

FILE NAME = 06359-PLAN-01 - P01	USER NAME =	DESIGNED -- JSP	REVISED --	STATE OF ILLINOIS DEPARTMENT OF TRANSPORTATION	127TH STREET & 121ST STREET RESURFACING 127TH STREET - 80TH AVENUE TO 123RD STREET PLAN SHEET		F.A.U. RTE. 1003/1001	SECTION 09-00030-00-RS	COUNTY COOK	TOTAL SHEETS 12	SHEET NO. 6	
	PLOT SCALE = 1"=50'	CHECKED -- PKB	REVISED --		SCALE: 1"=50'	SHEET NO. 6 OF 12 SHEETS	STA. 5+14.74 TO STA. 31+41.22	FED. ROAD DIST. NO. 1	ILLINOIS	FED. AID PROJECT ARA-9003(422)	CONTRACT NO. 63324	
	PLOT DATE = 10-15-09	DRAWN -- KWM	REVISED --									
		CHECKED -- AG	REVISED --									

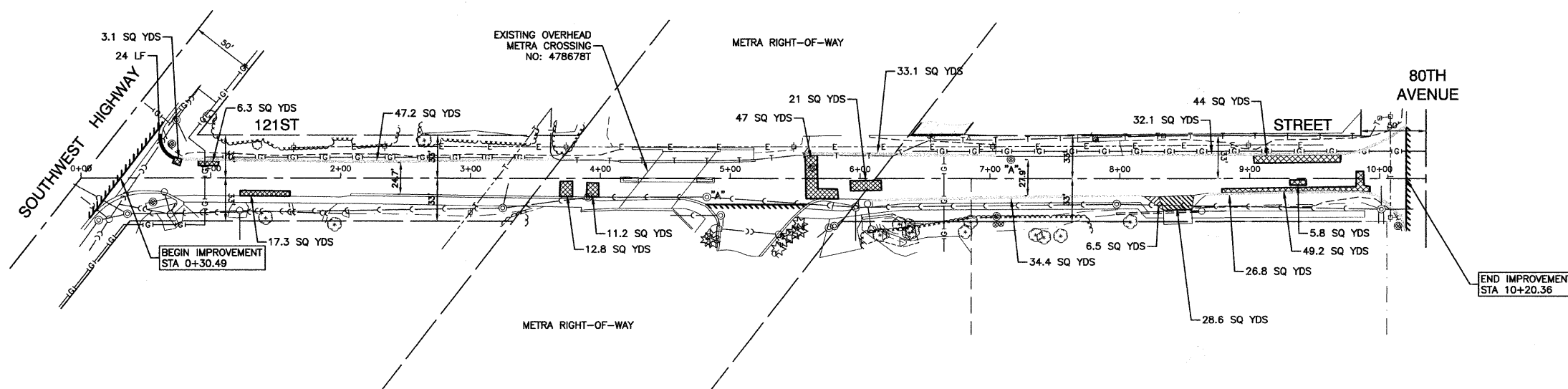

NOTE:

1. LIMIT OF CONSTRUCTION ON ALL SIDE STREETS IS THE RADIUS RETURN PLUS 10' BUTT JOINT OR ROW AS NOTED.
2. ACCESS TO ALL DRIVEWAYS SHALL BE MAINTAINED UPON COMPLETION OF EACH WORKDAY. RESIDENTS SHALL BE NOTIFIED 24 HOURS IN ADVANCE OF WHEN DRIVEWAY REPLACEMENT WILL TAKE PLACE.
3. ALL HMA AND PCC DRIVEWAYS SHALL BE REPLACED WITH THE SAME MATERIAL. THE CONTRACTOR SHALL NOTE EXISTING NON-STANDARD CONCRETE AND ASPHALT WORK AND REPLACE IN KIND.
4. CONTRACTOR SHALL PERFORM 2.25" OF SURFACE REMOVAL BENEATH METRA CROSSING TO MAINTAIN EXISTING VERTICAL CLEARANCE. SEE TYPICAL SECTIONS.

LEGEND

- CLASS D PATCHES
- HOT-MIX ASPHALT DRIVEWAY REMOVAL AND REPLACEMENT
- CONCRETE DRIVEWAY REMOVAL AND REPLACEMENT
- HOT-MIX ASPHALT SURFACE REMOVAL - BUTT JOINT
- AGGREGATE SHOULDER REMOVAL AND REPLACEMENT
- CONCRETE CURB, CONCRETE CURB AND GUTTER REMOVAL AND REPLACEMENT
- "A" STRUCTURE TO BE ADJUSTED
- "R" STRUCTURE TO BE RECONSTRUCTED
- ⊙ EXISTING MANHOLE
- EXISTING CATCH BASIN

FILE NAME = 09359_01-PLAN-01 - P01	USER NAME =	DESIGNED -- JSP	REVISED --	STATE OF ILLINOIS DEPARTMENT OF TRANSPORTATION	127TH STREET & 121ST STREET RESURFACING 121ST STREET - SOUTHWEST HIGHWAY TO 80TH AVENUE PLAN SHEET	F.A.U. RTE. 1003/1001	SECTION 09-00030-00-RS	COUNTY COOK	TOTAL SHEETS 12	SHEET NO. 7	
	PLOT SCALE = 1"=50'	DRAWN -- KWM	REVISED --		SCALE: 1"=50'	SHEET NO. 7 OF 12 SHEETS	STA. 0+30.49 TO STA. 10+20.36		CONTRACT NO. 63324		
	PLOT DATE = 10-15-09	CHECKED -- AG	REVISED --		FED. ROAD DIST. NO. 1 ILLINOIS		FED. AID PROJECT ARA-9003(422)				

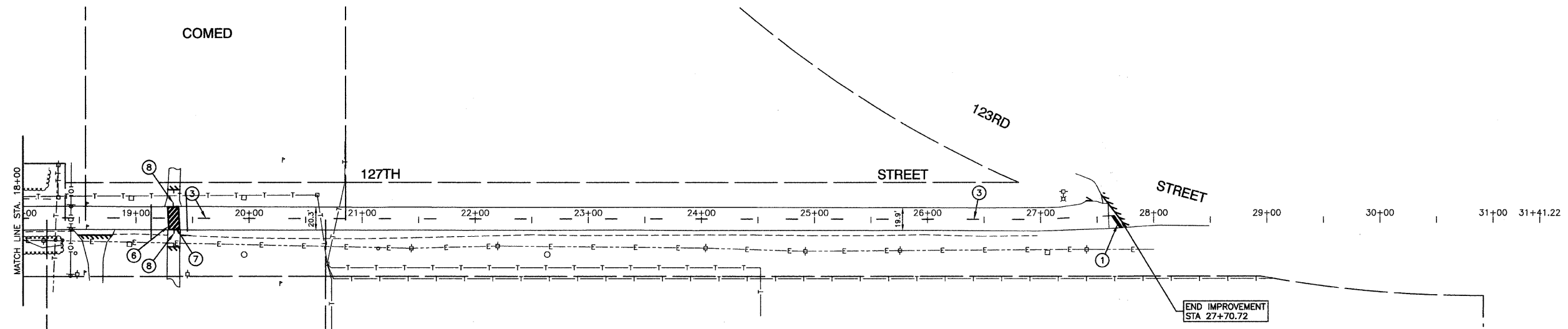
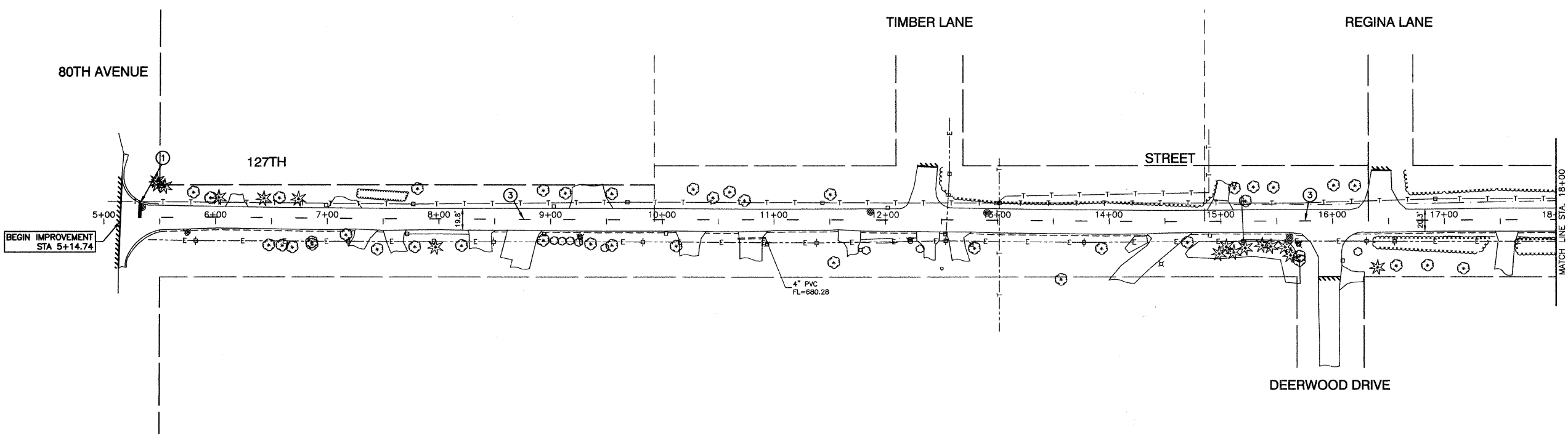

PAVEMENT MARKING LEGEND

- ① 24" WHITE STOP BAR
- ② 4" DOUBLE YELLOW CENTERLINE (11" C/C)
- ③ 4" WHITE SKIP - DASH LINE (10' LINE - 30' SPACE)
- ④ 4" YELLOW MEDIAN OUTLINE
- ⑤ 12" YELLOW DIAGONAL LINE (20' C/C)
- ⑥ 6" WHITE OUTLINE
- ⑦ 12" WHITE DIAGONAL LINE (3' C/C)
- ⑧ 4" YELLOW SKIP - DASH LINE (3' LINE - 9' SPACE)

NOTE
SEE IDOT STANDARD TC-13 FOR PAVEMENT MARKING DETAILS.
ALL PAVEMENT MARKING IS THERMOPLASTIC.

FILE NAME = 09359-PLAN-01 - 501	USER NAME =	DESIGNED - JSP	REVISED -	STATE OF ILLINOIS DEPARTMENT OF TRANSPORTATION	127TH STREET & 121ST STREET RESURFACING 127TH STREET - 80TH AVENUE TO 123RD STREET STRIPING PLAN		F.A.U. RTE.	SECTION	COUNTY	TOTAL SHEETS	SHEET NO.
	PLOT SCALE = 1"=50'	CHECKED - PKB	REVISED -				1003/1001	09-00030-00-RS	COOK	12	8
PLOT DATE = 10-15-09	DRAWN - KWM	REVISED -			SCALE: 1"=50'	SHEET NO. 8 OF 12 SHEETS	STA. 5+14.74 TO STA. 31+41.22	CONTRACT NO. 63324			
	CHECKED - AG	REVISED -					FED. ROAD DIST. NO. 1	ILLINOIS	FED. AID PROJECT ARA-9003(422)		

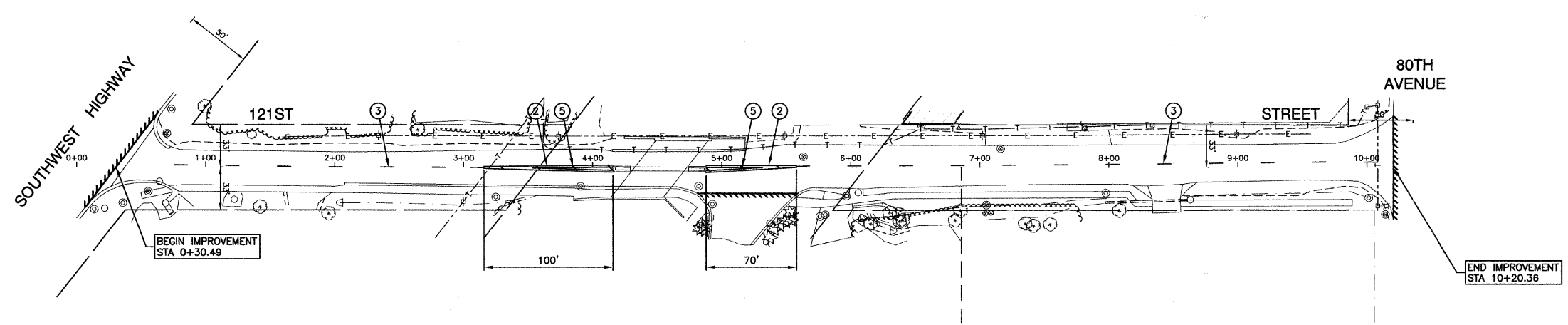

NOTE
 SEE IDOT STANDARD TC-13 FOR PAVEMENT MARKING DETAILS.
 ALL PAVEMENT MARKING IS THERMOPLASTIC.

PAVEMENT MARKING LEGEND

- ① 24" WHITE STOP BAR
- ② 4" DOUBLE YELLOW CENTERLINE (11" C/C)
- ③ 4" WHITE SKIP - DASH LINE (10' LINE - 30' SPACE)
- ④ 4" YELLOW MEDIAN OUTLINE
- ⑤ 12" YELLOW DIAGONAL LINE (20' C/C)

FILE NAME = 06359_01-PLAN-01 - 501	USER NAME =	DESIGNED - JSP	REVISED -	STATE OF ILLINOIS DEPARTMENT OF TRANSPORTATION	127TH STREET & 121ST STREET RESURFACING 121ST STREET - SOUTHWEST HIGHWAY TO 80TH AVENUE STRIPING PLAN		F.A.U. RTE.	SECTION	COUNTY	TOTAL SHEETS	SHEET NO.
	PLOT SCALE = 1"=50'	CHECKED - PKB	REVISED -				1003/1001	09-00030-00-RS	COOK	12	9
	PLOT DATE = 10-15-09	DRAWN - KWM	REVISED -				CONTRACT NO. 63324				
		CHECKED - AG	REVISED -				SCALE: 1"=50' SHEET NO. 9 OF 12 SHEETS STA. 0+30.49 TO STA. 10+20.36 FED. ROAD DIST. NO. 1 ILLINOIS FED. AID PROJECT ARA-9003(422)				

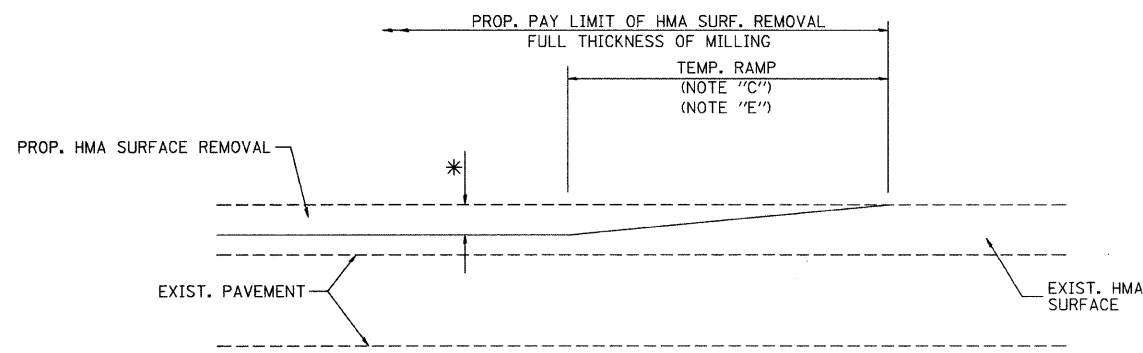

MILLED TEMPORARY RAMP
(FOR BUTT JOINT AND HMA TAPER SEE DETAIL BELOW)

OPTION 1

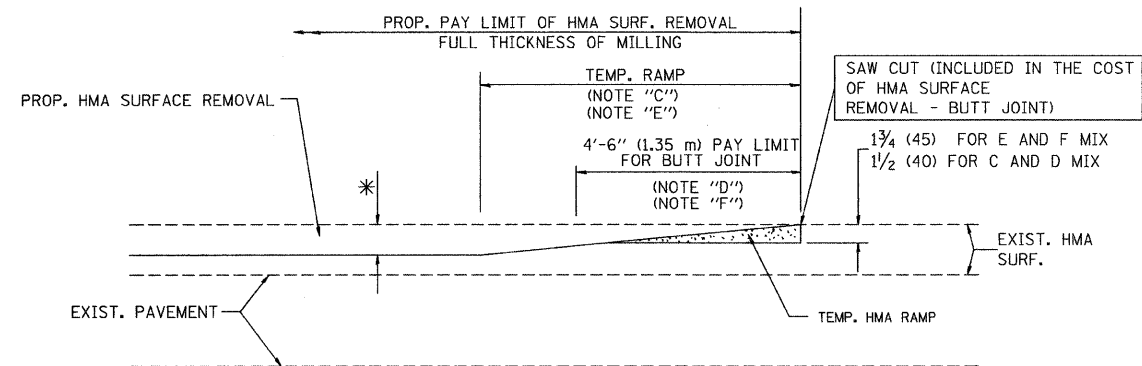

HMA CONSTRUCTED TEMPORARY RAMP
(FOR BUTT JOINT AND HMA TAPER SEE DETAIL BELOW)

OPTION 2
TYPICAL TEMPORARY RAMP

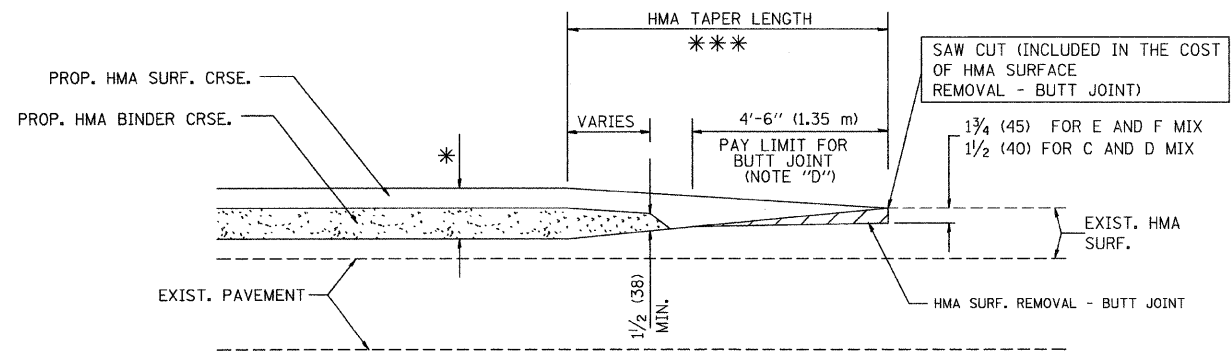

BUTT JOINT AND HMA TAPER
TYPICAL BUTT JOINT AND HMA TAPER
FOR MILLING AND RESURFACING

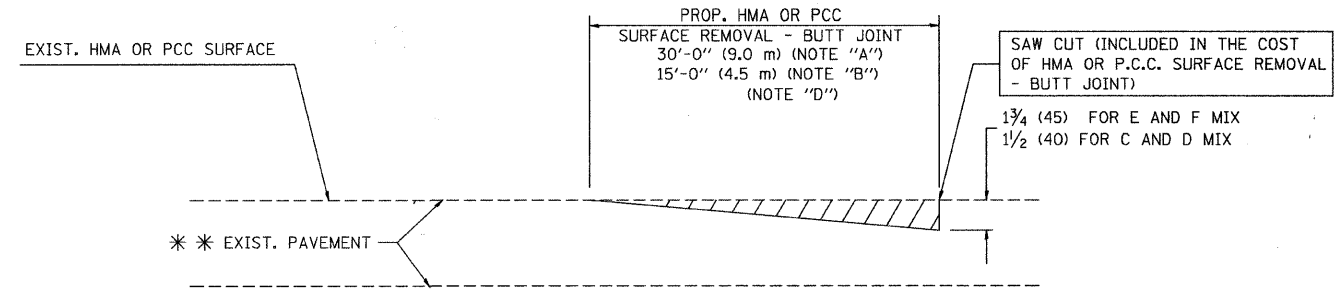

BUTT JOINT DETAIL

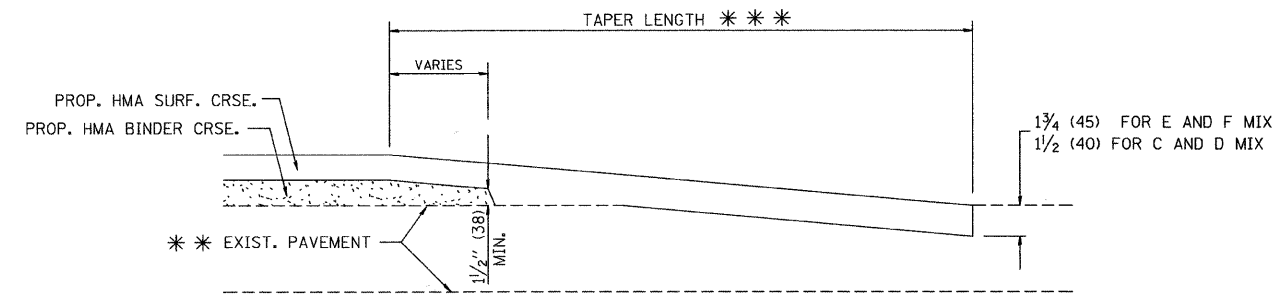

HMA TAPER DETAIL

TYPICAL BUTT JOINT AND HMA TAPER
FOR RESURFACING ONLY

*** PC CONCRETE, HMA OR HMA RESURFACED PAVEMENT.

NOTES

- A: MAINLINE ROADWAYS AND MAJOR SIDE ROADS.
 - B: MINOR SIDE ROADS.
 - C: THE TEMP. RAMP SHALL BE CONSTRUCTED IMMEDIATELY UPON REMOVAL OF THE EXISTING HMA SURFACE.
 - D: THE BUTT JOINT SHALL BE CONSTRUCTED IMMEDIATELY PRIOR TO PLACING THE PROPOSED HMA COURSES.
 - E: TAPER THE TEMP. RAMP AT A RATE OF 3'-0" (900 mm) PER 1 INCH (25 mm) OF MILLING THICKNESS.
 - F: INSTALLATION AND REMOVAL OF THE 4'-6" (1.35 m) TEMP. RAMP IS INCLUDED IN COST OF HMA SURFACE REMOVAL - BUTT JOINT
 - G: SEE ARTICLE 406.08 AND 406.14 OF THE STANDARD SPECIFICATIONS FOR "HMA AND/OR PCC SURFACE REMOVAL, BUTT JOINT".
- * SEE TYPICAL SECTIONS FOR MILLING THICKNESS.
- *** 20'-0" (6.1 m) PER 1 (25) RESURFACING (NOTE "A")
10'-0" (3.0 m) PER 1 (25) RESURFACING (NOTE "B")

BASIS OF PAYMENT:

THE BUTT JOINT WILL BE PAID FOR AT THE CONTRACT UNIT PRICE PER SQUARE YARD (SQUARE METER) FOR "HOT-MIX ASPHALT SURFACE REMOVAL - BUTT JOINT" OR FOR "PORTLAND CEMENT CONCRETE SURFACE REMOVAL - BUTT JOINT".

ALL DIMENSIONS ARE IN INCHES (MILLIMETERS) UNLESS OTHERWISE SHOWN.

FILE NAME = 06359-DT13-04 - BD-32	USER NAME = gegltenobt	DESIGNED - M. DE YONG	REVISED - R. SHAH 10-25-94	STATE OF ILLINOIS DEPARTMENT OF TRANSPORTATION	BUTT JOINT AND HMA TAPER DETAILS		F.A.U. RTE. 1003/1001	SECTION 09-00030-00-RS	COUNTY COOK	TOTAL SHEETS 12	SHEET NO. 10	
		CHECKED -	REVISED - A. ABBAS 03-21-97		SCALE:	SHEET NO. 10 OF 12 SHEETS	STA. TO STA.	BD406-05 BD32		CONTRACT NO. 63324		
		DRAWN -	REVISED - M. GOMEZ 04-06-01		FED. ROAD DIST. NO. 1 ILLINOIS FED. AID PROJECT ARA-9003(422)							
		CHECKED - 06-13-90	REVISED - R. BORO 01-01-07									

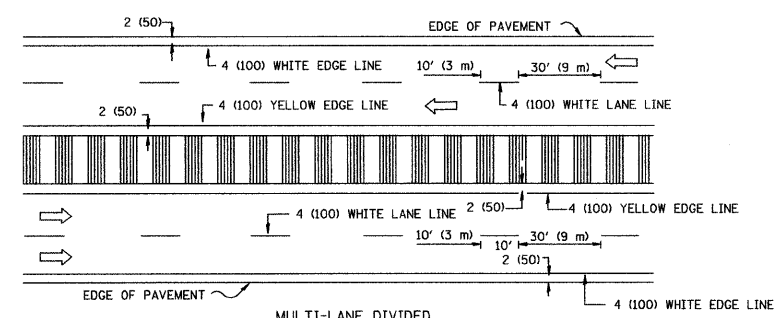
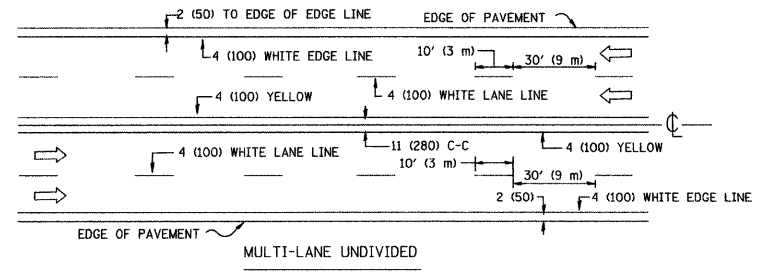
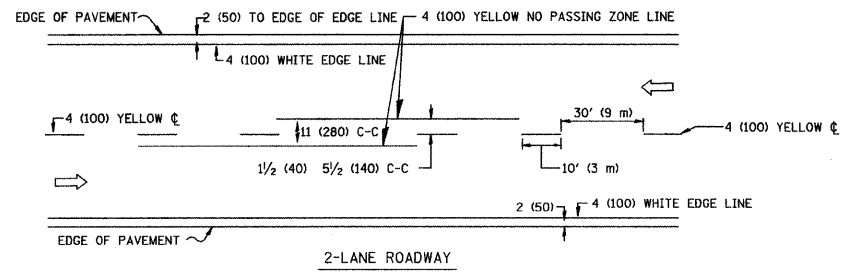

NOTE: MEDIANS WITH BARRIER CURB DO NOT REQUIRE AN EDGE LINE

TYPICAL LANE AND EDGE LINE MARKING

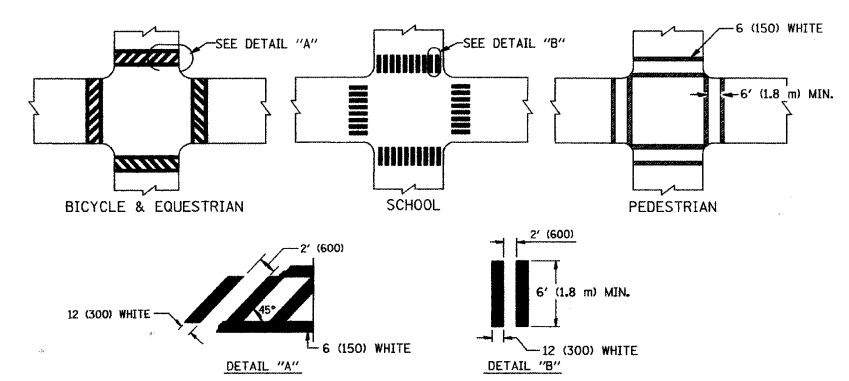

TYPICAL CROSSWALK MARKING

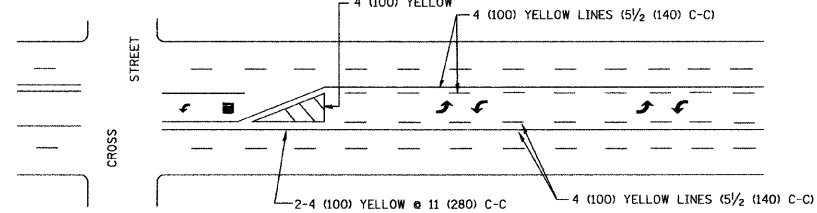
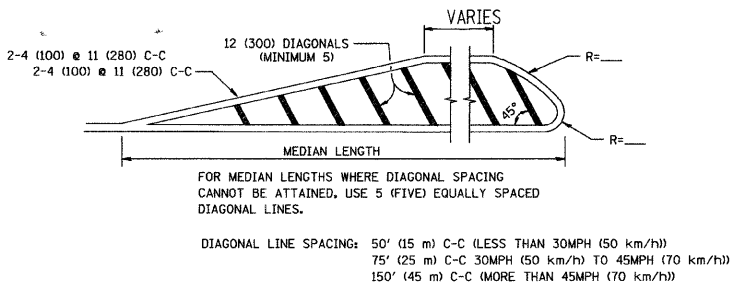
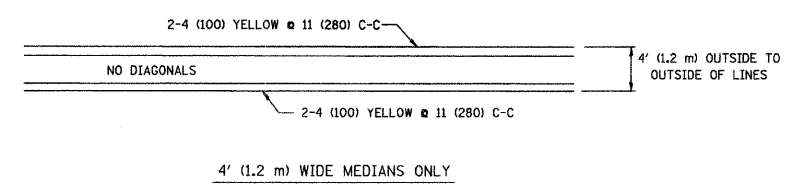

TYPICAL PAINTED MEDIAN MARKING

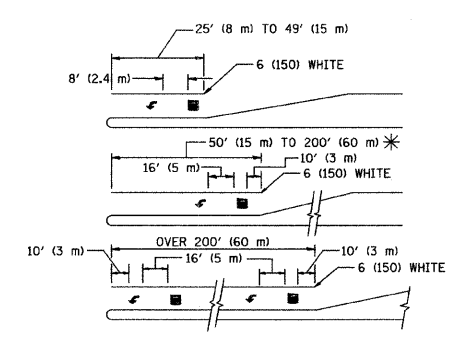

TYPICAL LEFT (OR RIGHT) TURN LANE

TYPICAL TURN LANE MARKING

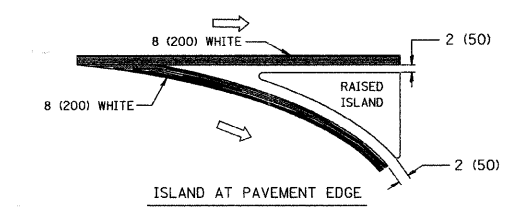
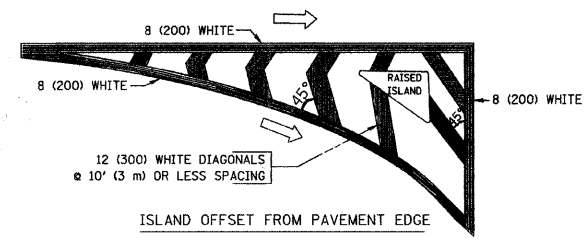

TYPICAL ISLAND MARKING

TYPE OF MARKING	WIDTH OF LINE	PATTERN	COLOR	SPACING / REMARKS
CENTERLINE ON 2 LANE PAVEMENT	4 (100)	SKIP-DASH	YELLOW	10' (3 m) LINE WITH 30' (9 m) SPACE
CENTERLINE ON MULTI-LANE UNDIVIDED PAVEMENT	2 @ 4 (100)	SOLID	YELLOW	11 (280) C-C
NO PASSING ZONE LINES: FOR ONE DIRECTION FOR BOTH DIRECTIONS	4 (100) 2 @ 4 (100)	SOLID SOLID	YELLOW YELLOW	5/2 (140) C-C FROM SKIP-DASH CENTERLINE 11 (280) C-C OMIT SKIP-DASH CENTERLINE BETWEEN
LANE LINES	4 (100) 5 (125) ON FREEWAYS	SKIP-DASH SKIP-DASH	WHITE WHITE	10' (3 m) LINE WITH 30' (9 m) SPACE
DOTTED LINES (EXTENSIONS OF CENTER, LANE OR TURN LANE MARKINGS)	SAME AS LINE BEING EXTENDED	SKIP-DASH	SAME AS LINE BEING EXTENDED	2' (600) LINE WITH 6' (1.8 m) SPACE
EDGE LINES	4 (100)	SOLID	YELLOW-LEFT WHITE-RIGHT	OUTLINE MOUNTABLE MEDIANS IN YELLOW; EDGE LINES ARE NOT USED NEXT TO BARRIER CURB
TURN LANE MARKINGS	6 (150) LINE; FULL SIZE LETTERS & SYMBOLS (8' (2.4m))	SOLID	WHITE	SEE TYPICAL TURN LANE MARKING DETAIL
TWO WAY LEFT TURN MARKING	2 @ 4 (100) EACH DIRECTION 8' (2.4m) LEFT ARROW	SKIP-DASH AND SOLID IN PAIRS	YELLOW WHITE	10' (3 m) LINE WITH 30' (9 m) SPACE FOR SKIP-DASH; 5/2 (140) C-C BETWEEN SOLID LINE AND SKIP-DASH LINE SEE TYPICAL TWO-WAY LEFT TURN MARKING DETAIL
CROSSWALK LINES (PEDESTRIAN) A. DIAGONALS (BIKE & EQUESTRIAN) B. LONGITUDINAL BARS (SCHOOL)	2 @ 6 (150) 12 (300) @ 45° 12 (300) @ 90°	SOLID SOLID SOLID	WHITE WHITE WHITE	NOT LESS THAN 6' (1.8 m) APART 2' (600) APART 2' (600) APART SEE TYPICAL CROSSWALK MARKING DETAILS.
STOP LINES	24 (600)	SOLID	WHITE	PLACE 4' (1.2 m) IN ADVANCE OF AND PARALLEL TO CROSSWALK, IF PRESENT. OTHERWISE, PLACE AT DESIRED STOPPING POINT. PARALLEL TO CROSSROAD CENTERLINE, WHERE POSSIBLE
PAINTED MEDIANS	2 @ 4 (100) WITH 12 (300) DIAGONALS @ 45° NO DIAGONALS USED FOR 4' (1.2 m) WIDE MEDIANS	SOLID	YELLOW: TWO WAY TRAFFIC WHITE: ONE WAY TRAFFIC	11 (280) C-C FOR THE DOUBLE LINE SEE TYPICAL PAINTED MEDIAN MARKING.
GORE MARKING AND CHANNELIZING LINES	8 (200) WITH 12 (300) DIAGONALS @ 45°	SOLID	WHITE	DIAGONALS: 15' (4.5 m) C-C (LESS THAN 30MPH (50 km/h)) 20' (6 m) C-C (30MPH (50 km/h) TO 45MPH (70 km/h)) 30' (9 m) C-C (OVER 45MPH (70 km/h))
RAILROAD CROSSING	24 (600) TRANSVERSE LINES; "RR" IS 6' (1.8 m) LETTERS; 16 (400) LINE FOR "X"	SOLID	WHITE	SEE STATE STANDARD 780001 AREA OF: "R"=3.6 SQ. FT. (0.33 m ²) EACH "X"=54.0 SQ. FT. (5.0 m ²)
SHOULDER DIAGONALS	12 (300) @ 45°	SOLID	WHITE - RIGHT YELLOW - LEFT	50' (15 m) C-C (LESS THAN 30MPH (50 km/h)) 75' (25 m) C-C (30 MPH (50 km/h) TO 45MPH (70 km/h)) 150' (45 m) C-C (OVER 45MPH (70 km/h))

FOR FURTHER DETAILS ON PAVEMENT MARKING REFER TO STANDARD SPECIFICATIONS FOR ROAD AND BRIDGE CONSTRUCTION AND STATE STANDARD 780001.

All dimensions are in inches (millimeters) unless otherwise shown.

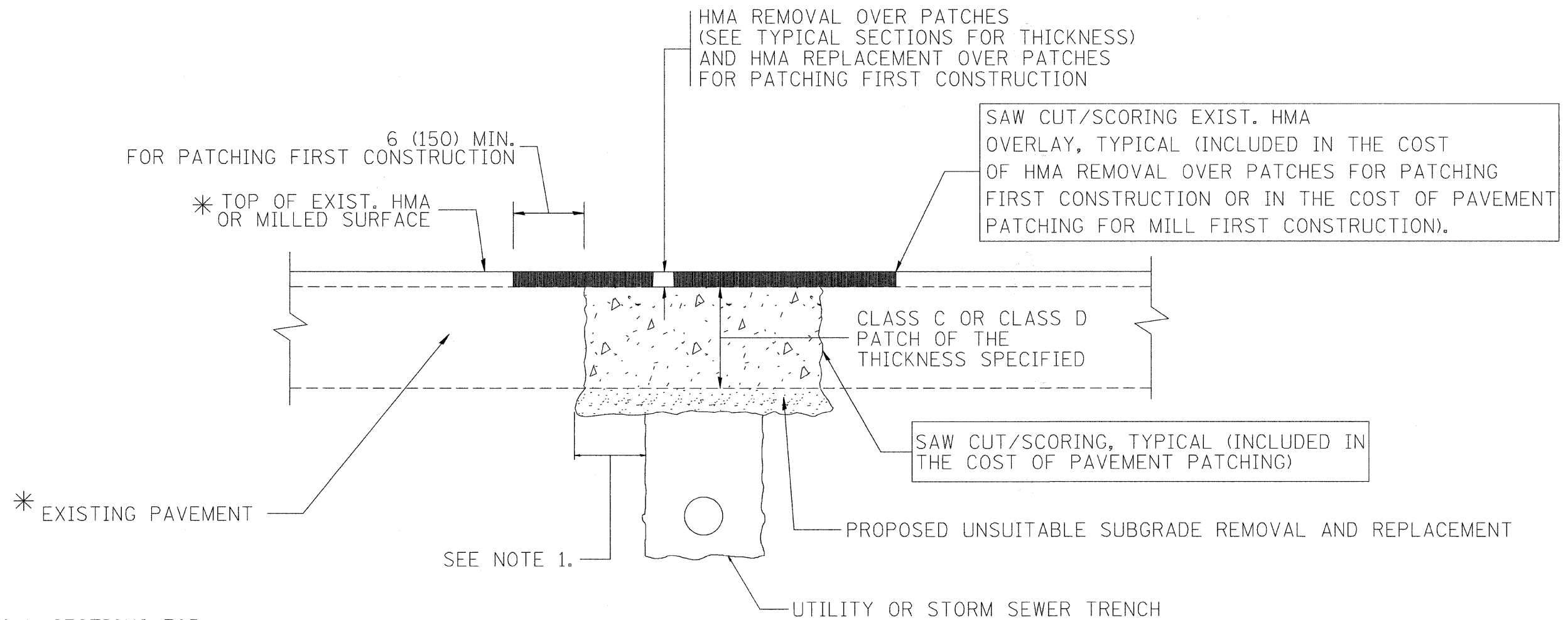

* SEE TYPICAL SECTIONS FOR THICKNESS AND MATERIALS

NOTES:

1. THE WIDTH OF THE FULL DEPTH PATCH OVER A TRENCH SHALL BE 12 (300) WIDER ON EACH SIDE OF THE TRENCH.
2. FOR METHOD OF MEASUREMENT AND BASIS OF PAYMENT, SEE RECURRING SPECIAL PROVISION "PATCHING WITH HOT-MIX ASPHALT OVERLAY REMOVAL".

SEQUENCE OF CONSTRUCTION (PATCHING FIRST)

1. REMOVE THE EXISTING HMA MATERIAL OVER THE AREA TO BE PATCHED.
2. REMOVE AND REPLACE WITH CLASS C OR D PATCH.
3. REPLACE HMA MATERIAL OVER THE AREA TO BE PATCHED.

SEQUENCE OF CONSTRUCTION (MILLING FIRST)

1. MILL HMA FIRST IF THERE IS AT LEAST 4 1/2 INCHES OR MORE OF HMA MATERIAL ON TOP OF THE EXISTING PAVEMENT OR IF THE PAVEMENT IS FULL DEPTH HMA. A MINIMUM OF 2 INCHES OF HMA MATERIAL SHALL BE IN PLACE AFTER MILLING.
2. REMOVE AND REPLACE WITH FULL DEPTH CLASS D PATCHES TO TOP OF MILLED SURFACE.

ALL DIMENSIONS ARE IN INCHES (MILLIMETERS) UNLESS OTHERWISE SHOWN.

FILE NAME = 06359-07LS-06 - BD-22	USER NAME = beuerdl	DESIGNED -- R. SHAH	REVISED -- A. ABBAS 04-27-98	STATE OF ILLINOIS DEPARTMENT OF TRANSPORTATION	PAVEMENT PATCHING FOR HMA SURFACED PAVEMENT	F.A.U. RTE. 1003/1001	SECTION 09-00030-00-RS	COUNTY COOK	TOTAL SHEETS 12	SHEET NO. 12	
PLOT SCALE = 50.000' / IN.	DRAWN --	REVISED -- R. BORO 01-01-07	REVISED -- R. BORO 09-04-07			BD400-04 (BD-22)		CONTRACT NO. 63324			
PLOT DATE = 10/27/2008	CHECKED -- 10-25-94	REVISED -- K. ENG 10-27-08	SCALE:			SHEET NO. 12 OF 12 SHEETS	STA. N/A	TO STA. N/A	FED. ROAD DIST. NO. 1	ILLINOIS	FED. AID PROJECT ARA-9003(422)

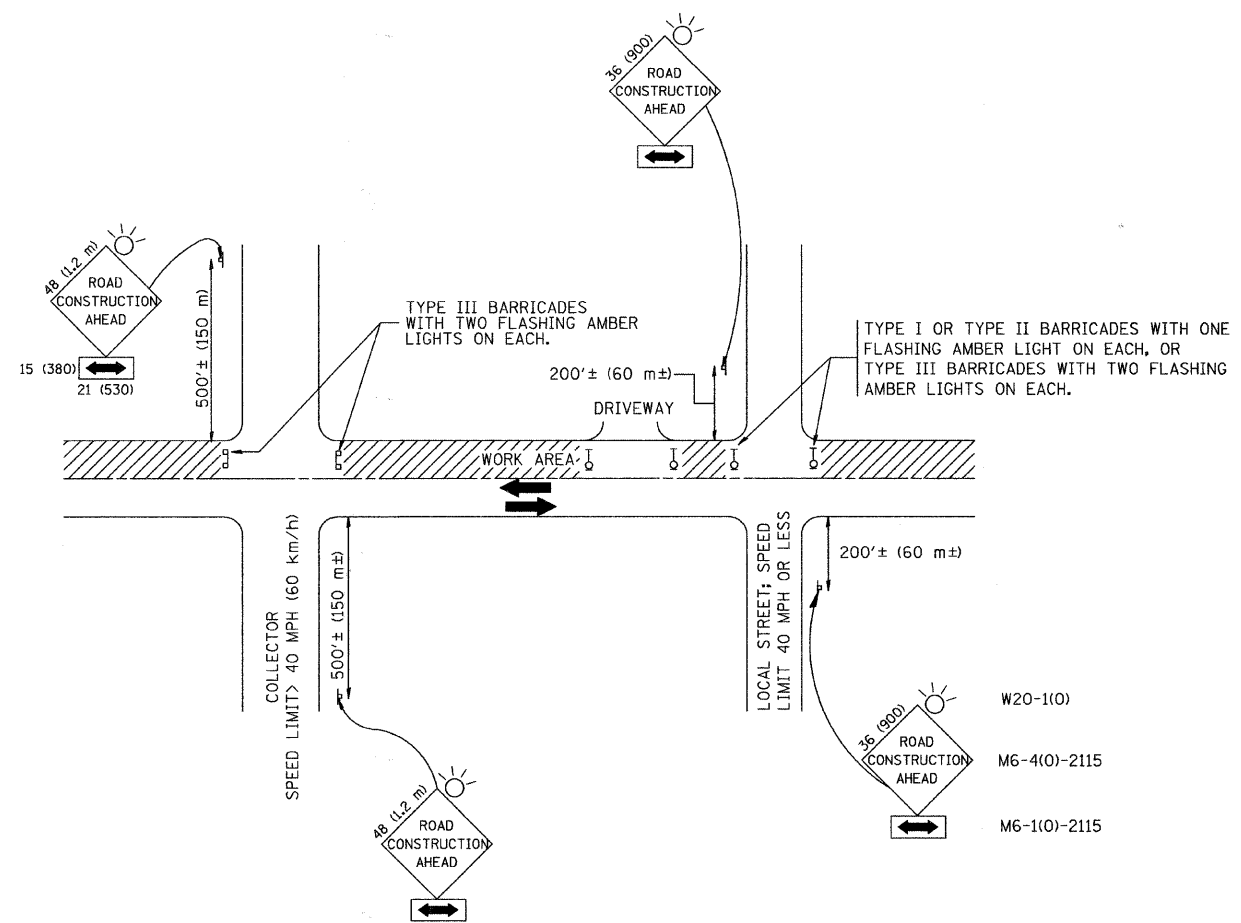

TRAFFIC CONTROL AND PROTECTION FOR SIDE ROADS, INTERSECTIONS, AND DRIVEWAYS

NOTES:

- A. FOR NO LANE RESTRICTION ON THE SIDE ROAD OR DRIVEWAYS
 1. SIDE ROAD WITH A SPEED LIMIT OF 40 MPH (60 km/h) OR LESS AS SHOWN ON THE DRAWING AND AS DIRECTED BY THE ENGINEER:
 - a) ONE **ROAD CONSTRUCTION AHEAD** SIGN 36 x 36 (900x900) WITH A FLASHER AND FLAG MOUNTED ON IT APPROXIMATELY 200' (60 m) IN ADVANCE OF THE MAIN ROUTE.
 - b) THE CLOSED PORTION OF THE MAIN ROUTE SHALL BE PROTECTED BY BLOCKING WITH TYPE I, TYPE II OR TYPE III BARRICADES, 1/3 OF THE CROSS SECTION OF THE CLOSED PORTION.
 2. SIDE ROAD WITH A SPEED LIMIT GREATER THAN 40 MPH (60 km/h) AS SHOWN ON THE DRAWING AND AS DIRECTED BY THE ENGINEER:
 - a) ONE **ROAD CONSTRUCTION AHEAD** SIGN 48 x 48 (1.2 m x 1.2 m) WITH A FLASHER MOUNTED ON IT APPROXIMATELY 500' (150 m) IN ADVANCE OF THE MAIN ROUTE.
 - b) THE CLOSED PORTION OF THE MAIN ROUTE SHALL BE PROTECTED BY BLOCKING WITH TYPE III BARRICADES, 1/2 OF THE CROSS SECTION OF THE CLOSED PORTION.
 3. WHEN THE SIDE ROAD LIES BETWEEN THE BEGINNING OF THE MAINLINE SIGNING AND THE WORK ZONE, A SINGLE HEADED ARROW (M6-1) SHALL BE USED IN LIEU OF THE DOUBLE HEADED ARROW (M6-4).
- B. FOR A LANE CLOSURE ON A SIDE ROAD OR DRIVEWAY:

USE APPLICABLE PORTIONS OF THE TYPICAL APPLICATION OF TRAFFIC CONTROL DEVICES (STD. 701501, STD. 701606 OR THE APPROPRIATE STANDARD). THE SPACING OF SIGNS AND BARRICADES SHALL BE ADJUSTED FOR FIELD CONDITIONS AS DIRECTED BY THE ENGINEER. THE DIRECTIONAL ARROW SHALL BE COVERED OR REMOVED WHEN NO LONGER CONSISTENT WITH THE SIDE ROAD LANE CLOSURE.
- C. ADVANCE WARNING SIGNS ARE TO BE OMITTED ON DRIVEWAY UNLESS OTHERWISE NOTED.
- D. THE TRAFFIC CONTROL AND PROTECTION FOR SIDE ROADS, INTERSECTIONS, AND DRIVEWAYS SHALL BE INCIDENTAL TO THE COST OF SPECIFIED TRAFFIC CONTROL STANDARDS OR ITEMS.

All dimensions are in millimeters (inches) unless otherwise shown.

FILE NAME = 09359-DTIS-03 - TC-10	USER NAME = geglennobt	DESIGNED = LHA	REVISED = J. OBERLE 10-18-95	STATE OF ILLINOIS DEPARTMENT OF TRANSPORTATION	TRAFFIC CONTROL AND PROTECTION FOR SIDE ROADS, INTERSECTIONS, AND DRIVEWAYS	F.A.U. RTE.	SECTION	COUNTY	TOTAL SHEETS	SHEET NO.
	PLOT SCALE = 50,000' / IN.	CHECKED =	REVISED = A. HOUSEH 03-06-96			1003/1001	09-00030-00-RS	COOK	12	12A
	PLOT DATE = 1/4/2008	DRAWN =	REVISED = A. HOUSEH 10-15-96			TC-10		CONTRACT NO. 63324		
	CHECKED = 06-89	REVISED = T. RAMMACHER 01-06-00		SCALE:	SHEET NO. 12A OF 12 SHEETS	STA.	TO STA.	FED. ROAD DIST. NO. 1	ILLINOIS	FED. AID PROJECT ARA-9003(422)