

FAP RTE.	SECTION	COUNTY	TOTAL SHEETS	SHEET NO.
34B	09-00058-00-SW	COOK	13	8
F.H.W.A. REG.	ILLINOIS	PROJECT:	ARA-9003(392)	
CONTRACT NO. 63330				

BEGIN IMPROVEMENT STA. 0+20 LT.

END IMPROVEMENT STA. 8+45 LT.

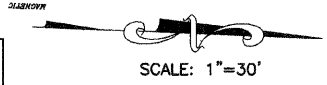
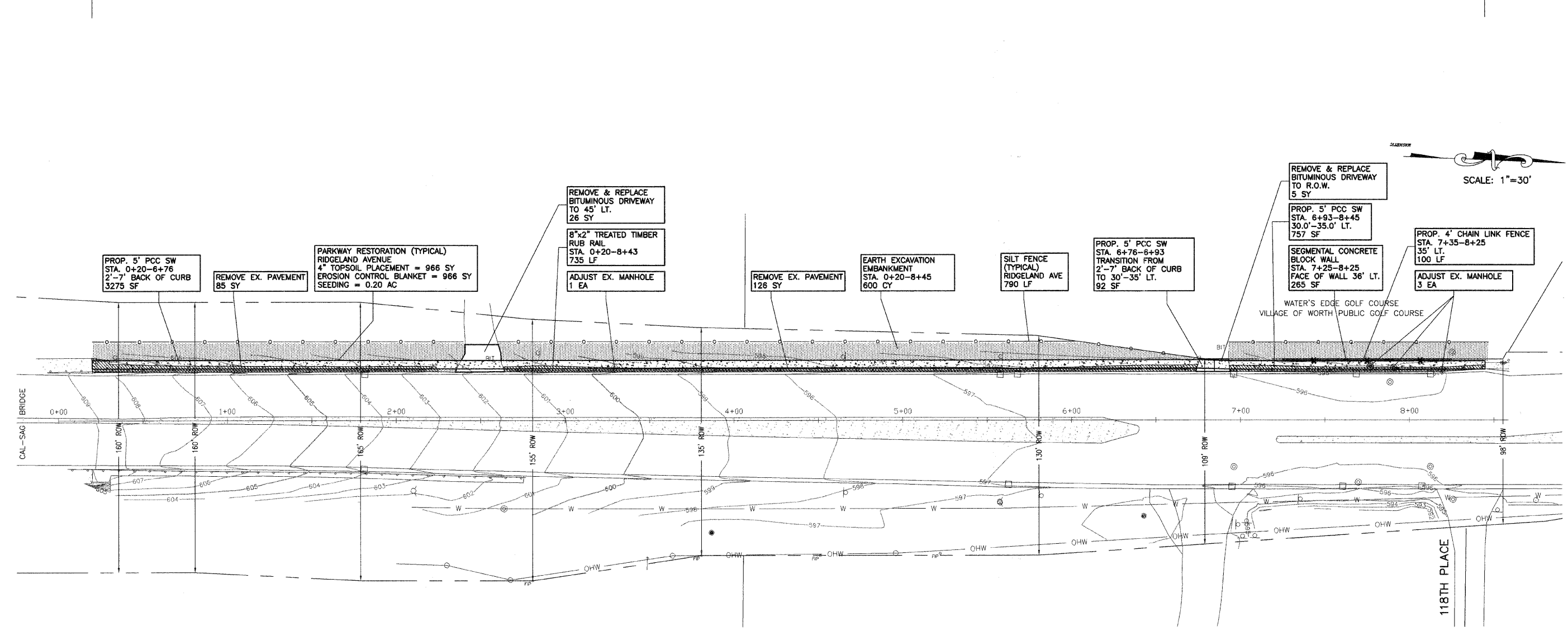

RIDGELAND AVENUE

PROPOSED SIDEWALK GRADES

STATION	PROP. WALK ELEVATIONS		PROP. WALL ELEVATIONS		PROP. WALK GRADES
	LEFT	RIGHT	T/W	F/G	
1+00	606.15	606.25			-2.80%
2+00	603.35	603.45			-2.70%
3+00	600.65	600.75			-1.90%
4+00	598.75	598.85			-1.35%
5+00	597.40	597.50			-0.67%
6+00	596.73	596.83			-0.45%
7+00	596.28	596.38			-0.28%
7+25	596.21	596.31	596.15	595.58	-0.32%
7+50	596.13	596.23	596.15	593.65	0.02%
8+00	596.15	596.25	596.15	593.65	0.40%
8+25	596.25	596.35	596.15	596.00	

SIDEWALK CROSS-GRADES AT DRIVEWAYS

STATION	DRIVE GRADE	WALK GRADE
2+50 L	-8.7%	-2% & -5%
6+85 L	-2.4%	-2%

NOTE: WHERE WALK GRADE IS 2% & 5%, THE FIRST THREE FEET ARE AT 2% AND THE LAST TWO FEET ARE AT 5%.

PLOT DATE: NOV 05 2009
 FILENAME: H:\09-WO-3000\PLANS-ENG\REV-1\09-WO-3000-SITE PLAN 09-10-14.dwg

MORRIS ENGINEERING, INC.
 5100 S. LINCOLN SUITE 100 Lisle, ILLINOIS 60532
 PHONE: (630)271-0770 WEBSITE: ECIVIL.COM
 LOCATION: H:\09-WO-3000\PLANS-ENG\REV-1\09-WO-3000-SITE PLAN 09-10-14.dwg
 MORRIS JOB NO.: 09-WO-3000

REVISIONS	
NAME	DATE

ILLINOIS DEPARTMENT OF TRANSPORTATION
 VILLAGE OF WORTH
 SIDEWALK IMPROVEMENTS
 RIDGELAND AVENUE

SCALE: VERT. 1"=30'
 HORIZ. 1"=30'
 DATE 10-06-2009

DRAWN BY CJS
 DESIGNED BY AS
 CHECKED BY NEX