

CP# 15050  
Type: CP  
N: 25828.4034  
E: 10070.4413  
Elev.: 666.93

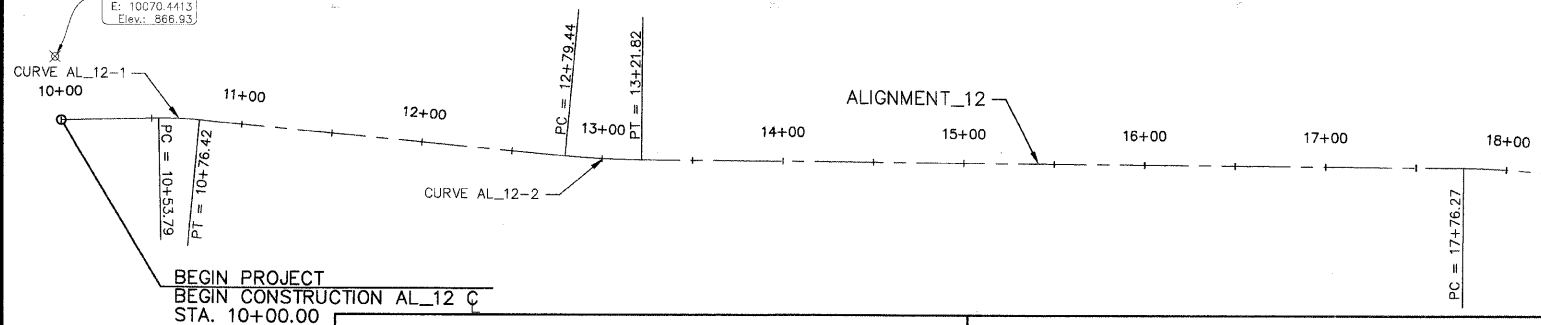

HORIZONTAL ALIGNMENT STATION AND CURVE REPORT.  
ALIGNMENT: ALIGNMENT\_12  
DESC: CARY-GROVE PARK TRAIL

DESC.	STATION	SPIRAL/CURVE DATA	NORTHING	EASTING
PI	10+00	LENGTH: 65.12 COURSE: 25793.7698 N 88-50-31 E	10073.8950	
PI	10+65.12	LENGTH: 235.55 COURSE: 25795.0859 S 84-40-37 E	10139.0002	
TANGENT DATA				
	10+00	25793.7698	10073.8950	
	10+53.79	25794.8571	10127.6787	
AL_12-1 CIRCULAR CURVE DATA				
PC	10+53.79	25794.8571	10127.6787	
CC	10+76.42	25594.8979	10131.7210	
PT	10+76.42	25794.0354	10150.2753	
DELTA: 06-28-52 TYPE: RIGHT				
RADIUS: 200.00 DEGREE: 28-38-52				
LENGTH: 22.82 TANGENT: 11.32				
MID-ORD: 0.32 EXTERNAL: 0.32				
CHORD: 22.61 COURSE: S 87-55-03 E				
ES: 0.32				
PI	13+00.64	877.36 COURSE: 25773.2340 S 89-31-58 E	10373.5304	
DELTA: 4-51-22				
TANGENT DATA				
	10+76.42	25794.0354	10150.2753	
	12+79.44	25775.2008	10352.4209	
AL_12-2 CIRCULAR CURVE DATA				
PC	12+79.44	25775.2008	10352.4209	
CC	13+21.82	26273.0445	10398.8067	
PT	13+21.82	25773.0611	10394.7306	
DELTA: 04-51-22 TYPE: LEFT				
RADIUS: 500.00 DEGREE: 11-27-33				
LENGTH: 42.38 TANGENT: 21.20				
MID-ORD: 0.45 EXTERNAL: 0.45				
CHORD: 42.36 COURSE: S 87-06-18 E				
ES: 0.45				
PI	21+77.98	470.02 COURSE: 25766.0817 S 00-42-41 W	11250.8628	
DELTA: 90-14-40				
TANGENT DATA				
	13+21.82	25773.0611	10394.7306	
	17+76.27	25769.3564	10849.1661	
AL_12-3 CIRCULAR CURVE DATA				
PC	17+76.27	25769.3564	10849.1661	
CC	24+06.29	25369.3697	10845.9053	
PT	24+06.29	25364.4026	11245.8744	
DELTA: 90-14-40 TYPE: RIGHT				
RADIUS: 400.00 DEGREE: 14-19-26				
LENGTH: 630.02 TANGENT: 401.71				
MID-ORD: 117.76 EXTERNAL: 166.90				
CHORD: 566.89 COURSE: S 44-24-39 E				
ES: 166.90				
PI	24+74.60	246.83 COURSE: 25296.1008 S 03-39-17 E	11245.0262	
DELTA: 4-21-58				
TANGENT DATA				
	24+06.29	25364.4026	11245.8744	
	24+44.10	25326.5950	11245.4049	
AL_12-4 CIRCULAR CURVE DATA				
PC	24+44.10	25326.5950	11245.4049	
CC	25+05.07	25318.6608	12045.3432	
PT	25+05.07	25265.6663	11246.9701	
DELTA: 04-21-58 TYPE: LEFT				
RADIUS: 800.00 DEGREE: 07-09-43				
LENGTH: 60.96 TANGENT: 30.50				
MID-ORD: 0.58 EXTERNAL: 0.58				
CHORD: 60.95 COURSE: S 01-28-18 E				
ES: 0.58				

PI	27+21.40	124.71 COURSE: 25049.7760 S 07-03-44 W	11260.7597	
DELTA: 10-43-01				
TANGENT DATA				
	25+05.07	25265.6663	11246.9701	
	26+93.26	25077.8577	11258.9661	
AL_12-5 CIRCULAR CURVE DATA				
PC	26+93.26	25077.8577	11258.9661	
CC	27+49.37	25058.7348	10959.5762	
PT	27+49.37	25021.8505	11257.3001	
DELTA: 10-43-01 TYPE: RIGHT				
RADIUS: 300.00 DEGREE: 19-05-55				
LENGTH: 56.11 TANGENT: 28.14				
MID-ORD: 1.31 EXTERNAL: 1.32				
CHORD: 56.03 COURSE: S 01-42-14 W				
ES: 1.32				
PI	28+45.95	73.11 COURSE: 24926.0081 S 06-08-09 W	11245.4264	
DELTA: 0-55-35				
TANGENT DATA				
	27+49.37	25021.8505	11257.3001	
	28+29.78	24942.0538	11247.4143	
AL_12-6 CIRCULAR CURVE DATA				
PC	28+29.78	24942.0538	11247.4143	
CC	28+62.11	24696.1583	13232.2406	
PT	28+62.11	24909.9324	11243.6982	
DELTA: 00-55-35 TYPE: LEFT				
RADIUS: 2000.00 DEGREE: 02-51-53				
LENGTH: 32.34 TANGENT: 16.17				
MID-ORD: 0.07 EXTERNAL: 0.07				
CHORD: 32.34 COURSE: S 06-35-57 W				
ES: 0.07				
PI	29+19.05	134.77 COURSE: 24853.3183 S 01-15-46 W	11237.6121	
DELTA: 4-52-24				
TANGENT DATA				
	28+62.11	24909.9324	11243.6982	
	28+67.99	24904.0889	11243.0700	

**CARY-GROVE PARK**

POT 23+20.12 AL\_12 C  
POT 50+00.00 FHGC C  
A=97°00'00"

POT 25+38.79 AL\_12 C  
POT 200+00.00 AL\_08 C  
A=94°00'00"

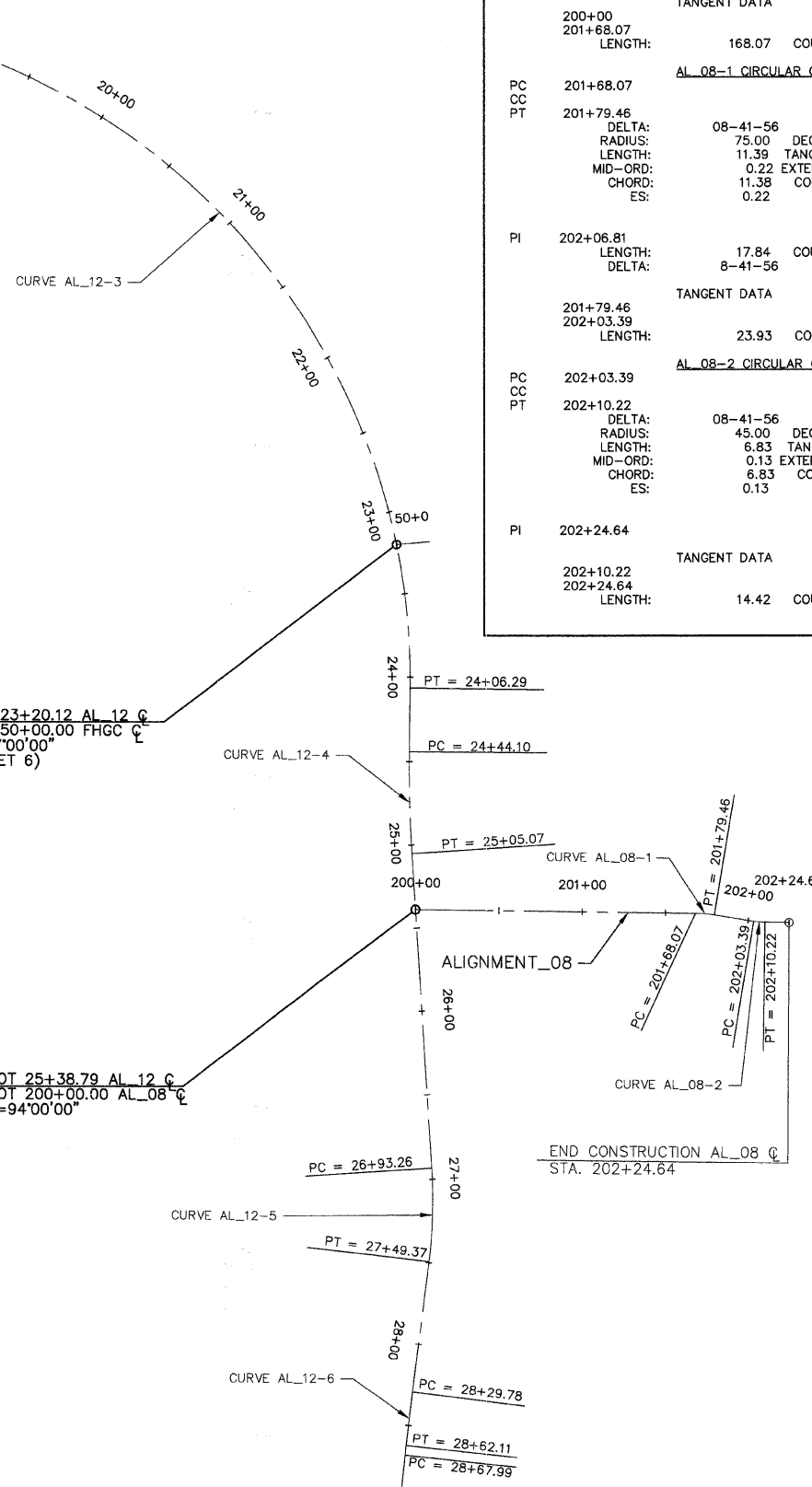

HORIZONTAL ALIGNMENT STATION AND CURVE REPORT.  
ALIGNMENT: ALIGNMENT\_08  
DESC: MINK TRAIL CONNECTION

DESC.	STATION	SPIRAL/CURVE DATA	NORTHING	EASTING
PI	200+00	LENGTH: 173.77 COURSE: 25232.0152 S 89-17-19 E	11249.1195	
PI	201+73.77	LENGTH: 33.06 COURSE: 25229.8573 S 80-35-23 E	11422.8795	
DELTA: 8-41-56				
TANGENT DATA				
	200+00	25232.0152	11249.1195	
	201+68.07	25229.9282	11417.1755	
AL_08-1 CIRCULAR CURVE DATA				
PC	201+68.07	25229.9282	11417.1755	
CC	201+79.46	25154.9339	11416.2442	
PT	201+79.46	25228.9246	11428.5071	
DELTA: 08-41-56 TYPE: RIGHT				
RADIUS: 75.00 DEGREE: 76-23-40				
LENGTH: 11.39 TANGENT: 5.70				
MID-ORD: 0.22 EXTERNAL: 0.22				
CHORD: 11.38 COURSE: S 84-56-21 E				
ES: 0.22				
PI	202+06.81	17.84 COURSE: 25224.4519 S 89-17-19 E	11455.4942	
DELTA: 8-41-56				
TANGENT DATA				
	201+79.46	25228.9246	11428.5071	
	202+03.39	25225.0115	11452.1176	
AL_08-2 CIRCULAR CURVE DATA				
PC	202+03.39	25225.0115	11452.1176	
CC	202+10.22	25269.4059	11459.4754	
PT	202+10.22	25224.4094	11458.9166	
DELTA: 08-41-56 TYPE: LEFT				
RADIUS: 45.00 DEGREE: 127-19-26				
LENGTH: 6.83 TANGENT: 3.42				
MID-ORD: 0.13 EXTERNAL: 0.13				
CHORD: 6.83 COURSE: S 84-56-21 E				
ES: 0.13				
PI	202+24.64	25224.2304	11473.3316	
TANGENT DATA				
	202+10.22	25224.4094	11458.9166	
	202+24.64	25224.2304	11473.3316	
LENGTH: 14.42 COURSE: S 89-17-19 E				

**ALIGNMENT DATA LEGEND**

- TRAIL CENTER LINE
- CC COMPOUND CURVE
- PC POINT OF CURVATURE
- PI POINT OF INTERSECTION
- PT POINT OF TANGENCY
- POT POINT OF TERMINATION

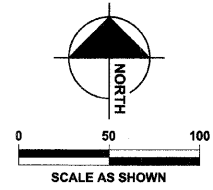

**MATCHLINE - SEE SHEET 5**

This document, together with the concepts and designs presented herein, is intended only for the specific purpose and client for which it was prepared. Reuse of this document for any other project without the express written consent of the engineer is prohibited. The engineer and his firm shall not be responsible for any errors or omissions in this document or for any consequences arising therefrom. Date: 10/02/2009 1:30pm by: comm/ah

DESIGNED	JWH	REVISED
DRAWN	LES	REVISED
CHECKED	JMM	REVISED
DATE	10/02/2009	REVISED

**STATE OF ILLINOIS  
DEPARTMENT OF TRANSPORTATION**

**CARY PARK DISTRICT  
CARY COMMUNITY TRAIL**

**ALIGNMENT DATA**

STA. 10+00 TO STA. 29+00  
STA. 200+00 TO STA. 202+24.64

SECTION	COUNTY	TOTAL SHEETS	SHEET NO.
06-P4001-00-BR	MCHENRY	64	4
FED. ROAD DIST. NO. 1	ILLINOIS	CONTRACT NO. 63333	