

SIGNING NOTES:

1. ALL PROPOSED SIGNING AND PAVEMENT MARKING SHALL BE IN ACCORDANCE WITH THE MOST CURRENT EDITION OF EACH OF THE FOLLOWING DOCUMENTS AND ANY REVISION THERETO:
 - A. MANUAL ON UNIFORM TRAFFIC CONTROL DEVICES
 - B. ILLINOIS DEPARTMENT OF TRANSPORTATION STANDARD SPECIFICATIONS FOR ROAD AND BRIDGE CONSTRUCTION
2. PROPOSED SIGN LOCATIONS ARE APPROXIMATE AND SHALL BE MODIFIED IN THE FIELD TO AVOID CONFLICT WITH UNDERGROUND UTILITIES OR OTHER OBSTRUCTIONS AND TO COMPLY WITH THE STANDARDS REFERENCED IN NOTE 1 ABOVE. SIGNS SHALL BE INSTALLED ONLY AFTER APPROVAL OF FINAL LOCATIONS BY CARY PARK DISTRICT.
3. CROSSWALK LONGITUDINAL LINES TO BE 6" WIDE. CROSSWALK DIAGONAL LINES TO BE 12" WIDE WITH 2' SPACING BETWEEN LINES. STOP BARS SHALL BE PLACED A MINIMUM OF 4' BEHIND CROSSWALKS.
4. SIGNS LISTED AND LABELED IN THE SIGN LEGEND ARE UNIQUE TO THE ALIGNMENTS SHOWN ON THIS SHEET.
5. PLACE SIGN A MINIMUM OF 3 FEET AND MAXIMUM OF 6 FEET FROM EDGE OF TRAIL.

SIGNING LEGEND

- (X) PLACE NEW SIGN
- [] DETECTABLE WARNINGS

PAVEMENT MARKING LEGEND

- ① THERMOPLASTIC PAVEMENT MARKING, 4" (100 mm) WHITE
- ② THERMOPLASTIC PAVEMENT MARKING, 24" (600 mm) WHITE
- ③ THERMOPLASTIC PAVEMENT MARKING, 6" (150 mm) WHITE
- ④ THERMOPLASTIC PAVEMENT MARKING, 12" (300 mm) WHITE

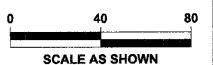

MATCHLINE - SEE SHEET 49

MATCHLINE - SEE THIS SHEET

CARY-GROVE PARK

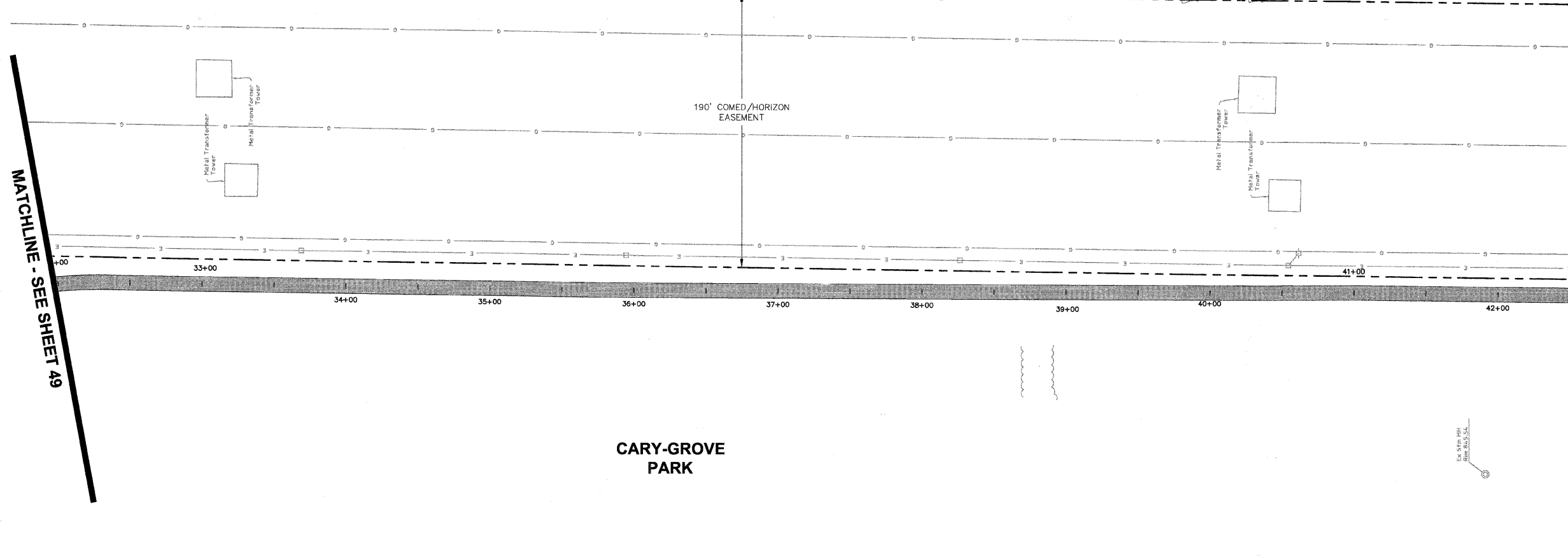

MATCHLINE - SEE THIS SHEET

CARY-GROVE PARK

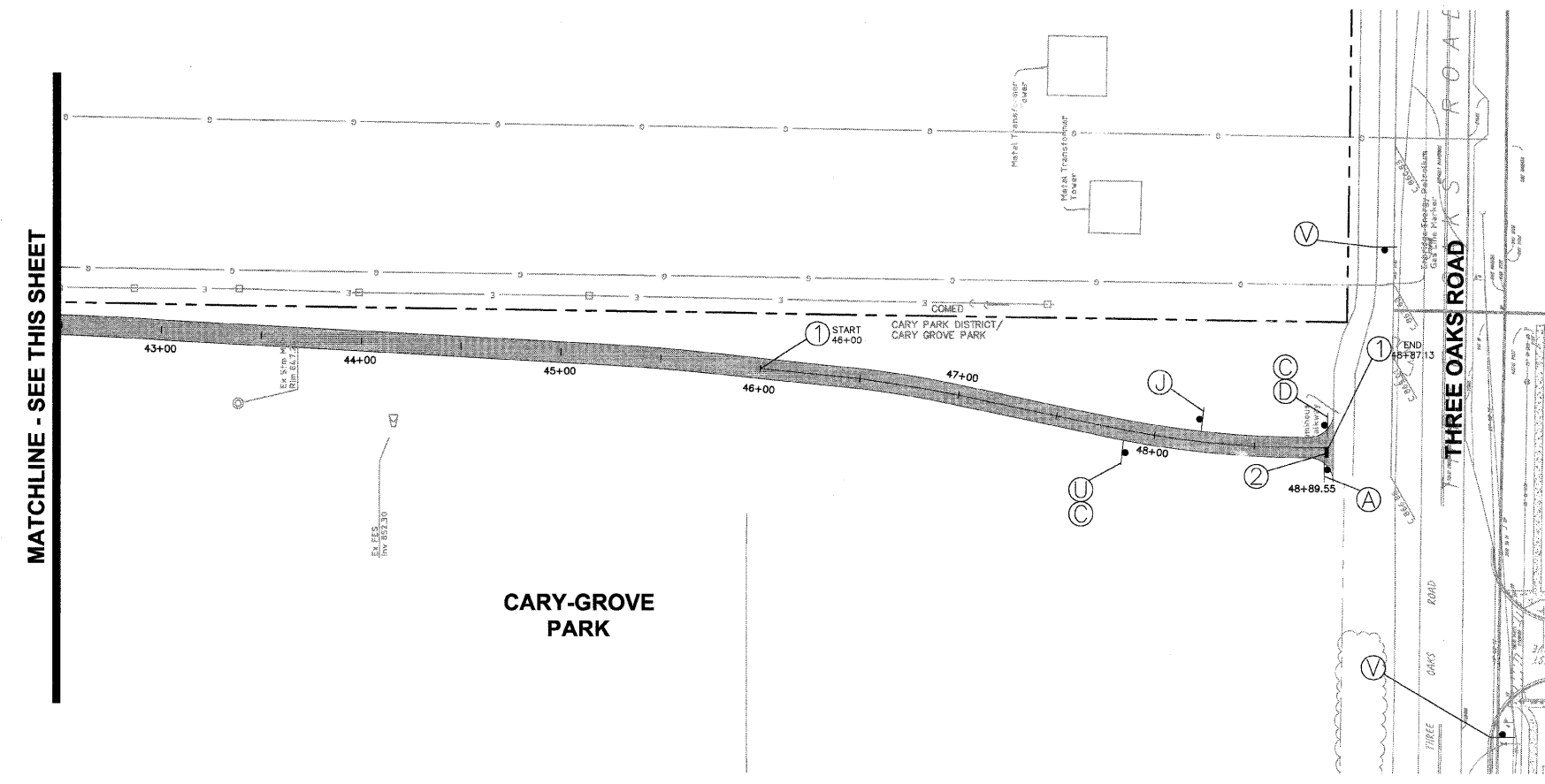

SIGN LEGEND

SIGN LETTER	(A)	(C)	(D)	(J)	(U)
SIGN					
NO.	R1-1	D11-1	M4-11	D1-1c	M4-12
SIGN DIM.	18" x 18"	24" x 18"	12" x 4"	24" x 18"	12" x 4"

SIGN LETTER	(V)
SIGN	
NO.	W21-1104
SIGN DIM.	18" x 18"

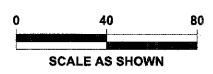

This document, together with the concepts and design presented herein, is an instrument of service, to be used only for the specific purpose and client for which it was prepared. Return drawings to: K. O. LEE, Inc., 1000 N. Lincoln Ave., Suite 100, Chicago, IL 60610. Date: 10/02/2009. No other use or reproduction is permitted without the written consent of K. O. LEE, Inc.

DESIGNED	- JWH	REVISED	
DRAWN	- LES	REVISED	
CHECKED	- JMM	REVISED	
DATE	- 10/02/2009	REVISED	

**STATE OF ILLINOIS
DEPARTMENT OF TRANSPORTATION**

**CARY PARK DISTRICT
CARY COMMUNITY TRAIL**

**SIGNAGE AND STRIPING PLAN
STA. 32+00 TO STA. 42+50
STA. 42+50 TO 48+89.55**

SECTION	COUNTY	TOTAL SHEETS	SHEET NO.
06-P4001-00-BR	MCHENRY	64	50
FED. ROAD DIST. NO. 1	ILLINOIS	CONTRACT NO. 63333	