

**GRADING LEGEND:**

- XXX--- PROPOSED SPOT ELEVATIONS
- 100--- PROPOSED CONTOUR
- FLOW ARROW
- 100--- EXISTING CONTOUR
- EXISTING STORM SEWER
- PIPE OUTLET/CULVERT
- 4" PERFORATED EDGE DRAIN
- 12" PVC STORM PIPE
- EDGE DRAIN CLEANOUT
- ▨ IDOT CLASS 1 SEEDING\*
- ▨ IDOT CLASS 1B SEEDING\*
- ▨ IDOT CLASS 4A SEEDING\*
- ▨ EXCELSIOR/WOOD BLANKET
- INLET PROTECTION
- S--- SILT FENCE
- RIP RAP
- TREE PROTECTION
- PROPERTY LINE
- LIMITS OF DISTURBANCE (8.96 ACRES)

NOTE: STRAW MULCH STABILIZATION TO BE PLACED OVER SEEDING WHERE THERE IS NO EXCELSIOR BLANKET  
\* SEE SHEET 2 FOR SEEDING CHARTS

**BENCHMARKS:**

**SOURCE BENCHMARK**  
DESCRIPTION: MANHOLE #46 FROM THE ASBUILT RECORD DRAWINGS BY MANHARD CONSULTING LTD DATED 3-6-07 FOR THE FOXFORD HILLS SUBDIVISION-PHASE 1 IN THE VILLAGE OF CARY, ILLINOIS.  
LOCATION: 120' NORTHEAST OF THE OAKMAN DIVE AND PARKSTONE DRIVE INTERSECTION ON OAKMAN DRIVE.  
ELEVATION: 861.45

**SITE BENCHMARK**  
HE CP #1  
DESCRIPTION: "PK" NAIL IN EDGE OF PAVEMENT LOCATION: 592' WEST OF INTERSECTION OF RAWSON BRIDGE ROAD AND MINK TRAIL, 45' SOUTHWEST OF TREE, 27' SOUTHEAST OF IRON ROD, AND 10' SOUTH OF CONCRETE SIDEWALK  
ELEVATION: 860.97

**SITE BENCHMARK**  
HE CP #8  
DESCRIPTION: RAIL ROAD SPIKE LOCATION: NORTHWEST CORNER OF INTERSECTION OF CRYSTAL LAKE ROAD AND RAWSON BRIDGE ROAD, 22' SOUTHEAST OF FENCE CORNER, 18' SOUTHWEST OF POWER POLE, AND 11' NORTHWEST OF PAVEMENT.  
ELEVATION: 823.23

**GRADING NOTES:**

1. PRIOR TO INSTALLATION OF STORM DRAINS OR ANY OTHER UTILITIES, THE CONTRACTOR SHALL EXCAVATE, VERIFY, AND CALCULATE ALL POINTS OF CONNECTION AND ALL UTILITY CROSSINGS AND INFORM THE OWNER AND THE ENGINEER OF ANY CONFLICTS OR REQUIRED DEVIATIONS FROM THE PLAN. NOTIFICATION SHALL BE MADE A MINIMUM OF 72 HOURS PRIOR TO CONSTRUCTION. THE ENGINEER AND ITS CLIENTS SHALL BE HELD HARMLESS IN THE EVENT THE CONTRACTOR FAILS TO MAKE SUCH NOTIFICATION.
2. ALL UNPAVED SLOPES AND AREAS DISTURBED BY CONSTRUCTION SHALL BE GRADED SMOOTH AND FOUR INCHES OF TOPSOIL APPLIED. IF ADEQUATE TOPSOIL IS NOT AVAILABLE ON SITE, THE CONTRACTOR SHALL PROVIDE TOPSOIL, APPROVED BY THE OWNER, AS NEEDED. THE AREA SHALL THEN BE SEEDED/SODDED, FERTILIZED, MULCHED, WATERED, AND MAINTAINED UNTIL HARDY GRASS GROWTH IS ESTABLISHED IN ALL AREAS. ANY RELOCATED TREES SHALL BE MAINTAINED UNTIL SUCH POINT AS TREE IS RE-ESTABLISHED. ANY AREAS DISTURBED FOR ANY REASON PRIOR TO FINAL ACCEPTANCE OF THE PROJECT SHALL BE CORRECTED BY THE CONTRACTOR AT NO ADDITIONAL COST TO THE OWNER.
3. THE CONTRACTOR IS SPECIFICALLY CAUTIONED THAT THE LOCATION AND/OR ELEVATION OF EXISTING UTILITIES AS SHOWN ON THESE PLANS IS BASED ON RECORDS OF THE VARIOUS UTILITY COMPANIES, AND WHERE POSSIBLE, MEASUREMENTS TAKEN IN THE FIELD. THE INFORMATION IS NOT TO BE RELIED ON AS BEING EXACT OR COMPLETE. THE CONTRACTOR MUST CALL THE APPROPRIATE UTILITY COMPANY AT LEAST 72 HOURS BEFORE ANY EXCAVATION TO REQUEST EXACT FIELD LOCATION OF UTILITIES.
4. CONTRACTOR IS SPECIFICALLY CAUTIONED THAT THE EXISTING GRADES SHOWN ON THESE PLANS ARE BASED OFF A TOPOGRAPHIC SURVEY BY HAEGER ENGINEERING DATED 02/07/2008, A TOPOGRAPHIC SURVEY AND FUTURE GRADING IMPROVEMENT PLAN PERFORMED BY HITCHCOCK ENGINEERING DATED 10/04/2004 AND A FOXFORD HILLS SUBDIVISION AS BUILT SURVEY BY MANHARD DATED 03/28/07.
5. CONTRACTOR TO FIELD VERIFY ELEVATIONS OF PROPOSED DRAINAGE STRUCTURES AND ADJACENT PAVEMENT PRIOR TO STARTING CONSTRUCTION.
6. REFER TO GEOTECHNICAL REPORT FOR SPECIFIC SITE SOIL CONDITIONS AND CONSIDERATIONS.
7. CONTRACTOR SHALL COMPLY COMPLETELY WITH THE LATEST STANDARDS OF OSHA DIRECTIVES OR ANY OTHER AGENCY HAVING JURISDICTION FOR EXCAVATION AND TRENCHING PROCEDURES. THE CONTRACTOR SHALL USE SUPPORT SYSTEMS, SLOPING, BENCHING, AND OTHER MEANS OF PROTECTION. THIS IS TO INCLUDE, BUT NOT LIMITED TO ACCESS AND EGRESS FROM ALL EXCAVATION AND TRENCHING. CONTRACTOR IS RESPONSIBLE FOR COMPLYING WITH PERFORMANCE CRITERIA AS REQUIRED BY OSHA.
8. WHERE APPLICABLE, CONTRACTOR SHALL TAKE ALL APPROPRIATE MEASURES TO KEEP SEDIMENT FROM ENTERING ADJACENT RESIDENTIAL PROPERTIES.
9. CONTRACTOR SHALL TAKE ALL APPROPRIATE MEASURES TO AVOID DISTURBING AREA OUTSIDE OF EXISTING CARY PARK DISTRICT PROPERTY, EASEMENTS, AND APPROVED CONSTRUCTION EASEMENTS WITH ADJACENT STAKE HOLDERS.
10. CONTRACTOR SHALL RESTORE ANY DISTURBED AREAS OUTSIDE OF CONSTRUCTION LIMITS TO PRE-EXISTING CONDITIONS AT NO ADDITIONAL COST TO THE OWNER.
11. ALL GRADING AND DRAINAGE IMPROVEMENTS WILL BE PERFORMED IN ACCORDANCE WITH MCHENRY COUNTY STORMWATER ORDINANCE AND IDOT STANDARD SPECIFICATIONS FOR ROAD AND BRIDGE CONSTRUCTION.
12. ALL EROSION AND SEDIMENT CONTROL MEASURES WILL BE IN ACCORDANCE WITH THE APPROVED SWPPP, MCHENRY COUNTY, AND THE MCHENRY COUNTY SOIL CONSERVATION DISTRICT.
13. DRAIN TILE SYSTEMS DISTURBED DURING DEVELOPMENT MUST BE RECONNECTED BY THOSE RESPONSIBLE FOR THEIR DISTURBANCE UNLESS THE APPROVED ENGINEERING PLANS INDICATE HOW THE DRAIN TILE SYSTEM IS TO BE CONNECTED TO THE PROPOSED STORMWATER MANAGEMENT SYSTEM. ALL ABANDONED DRAIN TILES SHALL BE REMOVED IN THEIR ENTIRETY.
14. PLEASE REFER TO STANDARDS AND DETAILS LOCATED ON SHEET 54-55 FOR CONSTRUCTION DETAILS.
15. SEE PLAN AND PROFILES ON PAGES 10-20 AND CROSS SECTIONS ON PAGES 21-43 FOR SPECIFIC SLOPES, DITCH INSTALLATION AND TRANSITIONS
16. PRIOR TO INSTALLING SOIL STABILIZATION MEASURES, CONTRACTOR SHALL COORDINATE WITH CARY PARK DISTRICT TO VERIFY STABILIZATION TYPE (STRAW MULCH OR EXCELSIOR BLANKET) TO BE USED.
17. NOTES ON BRIDGING STABILIZATION METHODOLOGY:
  - REMOVE/SCRAPE 1-2" EXISTING GROUND
  - PLACE GEOTEXTILE FABRIC AS DIRECTED BY CARY PARK DISTRICT
  - INSTALL STONE IN APPROVED LIFTS TO BRING SECTION UP TO PROPOSED SUBGRADE ELEVATION.
  - INSTALL PAVEMENT SECTION UP TO FINAL GRADE. SEE PLAN/PROFILE FOR ELEVATIONS
 CONTRACTOR IS TO COORDINATE WITH CARY PARK DISTRICT PRIOR TO INSTALLATION OF THESE MATERIALS.
18. SOIL DISTURBANCE SHALL BE CONDUCTED IN SUCH A MANNER AS TO MINIMIZE EROSION. AREAS OF THE DEVELOPMENT SITE THAT ARE NOT TO BE GRADED SHALL BE PROTECTED FROM CONSTRUCTION TRAFFIC OR OTHER DISTURBANCE UNTIL FINAL SEEDING IS PERFORMED.
19. PROPERTIES AND CHANNELS ADJOINING THE DEVELOPMENT SITE SHALL BE PROTECTED FROM EROSION AND SEDIMENTATION.
20. SOIL EROSION AND SEDIMENT CONTROL FEATURES SHALL BE CONSTRUCTED PRIOR TO THE COMMENCEMENT OF HYDROLOGIC DISTURBANCE OF UPLAND AREAS.
21. DISTURBED AREAS SHALL BE STABILIZED WITH TEMPORARY OR PERMANENT MEASURES WITHIN SEVEN (7) CALENDAR DAYS FOLLOWING THE END OF ACTIVE HYDROLOGIC DISTURBANCE.
22. ALL STORM SEWERS THAT ARE OR WILL BE FUNCTIONING DURING CONSTRUCTION SHALL BE PROTECTED BY AN APPROPRIATE SEDIMENT CONTROL MEASURE.
23. IF DEWATERING SERVICES ARE USED, ADJOINING PROPERTIES AND DISCHARGE LOCATIONS SHALL BE PROTECTED FROM EROSION. DISCHARGES SHALL BE ROUTED THROUGH AN EFFECTIVE SEDIMENT CONTROL MEASURE (E.G., SEDIMENT TRAP, SEDIMENT BASIN, OR OTHER APPROPRIATE MEASURES).
24. ALL TEMPORARY SOIL EROSION AND SEDIMENT CONTROL MEASURES SHALL BE REMOVED WITHIN THIRTY (3) DAYS AFTER FINAL SITE STABILIZATION IS ACHIEVED OR AFTER THE TEMPORARY MEASURES ARE NO LONGER NEEDED. TRAPPED SEDIMENT AND OTHER DISTURBED SOIL AREAS SHALL BE PERMANENTLY STABILIZED.
25. A STABILIZED MAT OF AGGREGATE UNDERLAIN WITH FILTER CLOTH (OR OTHER APPROPRIATE MEASURES) SHALL BE LOCATED AT ANY POINT WHERE TRAFFIC WILL BE ENTERING OR LEAVING A CONSTRUCTION SITE OF A MAJOR DEVELOPMENT TO OR FROM A PUBLIC RIGHT-OF-WAY, STREET, ALLEY OR PARKING AREA. ANY SEDIMENT OR SOIL REACHING AN IMPROVED PUBLIC RIGHT-OF-WAY, STREET, ALLEY OR PARKING AREA SHALL BE REMOVED BY SCRAPING OR STREET CLEANING AS ACCUMULATIONS WARRANT AND TRANSPORTED TO A CONTROLLED SEDIMENT DISPOSAL AREA.
26. SOIL STOCKPILES SHALL NOT BE LOCATED IN A FLOOD-PRONE AREA OR A DESIGNATED BUFFER PROTECTING WATERS OF THE UNITED STATES OR ISOLATED WATERS OF MCHENRY COUNTY.
27. THE CONTRACTOR SHALL PROVIDE ADEQUATE RECEPTACLES FOR THE DEPOSITION OF ALL CONSTRUCTION MATERIAL DEBRIS GENERATED DURING THE DEVELOPMENT PROCESS. THE CONTRACTOR SHALL NOT CAUSE OR PERMIT THE DUMPING, DEPOSITING, DROPPING, THROWING, DISCARDING OR LEAVING OF CONSTRUCTION MATERIAL DEBRIS UPON OR INTO ANY DEVELOPMENT SITE, CHANNEL, WATERS OF THE U.S. OR ISOLATED WATERS OF MCHENRY COUNTY. THE CONTRACTOR SHALL MAINTAIN THE DEVELOPMENT SITE FREE OF CONSTRUCTION MATERIAL DEBRIS.
28. ALL TEMPORARY AND PERMANENT EROSION AND SEDIMENT CONTROL MEASURES SHALL BE MAINTAINED IN AN EFFECTIVE WORKING CONDITION.
29. PRIOR TO SILT FENCE AND TREE PROTECTION INSTALLATION, 72 HOURS NOTICE TO CARY PARK DISTRICT IS REQUIRED FOR APPROVAL AND INSPECTION OF MATERIALS.

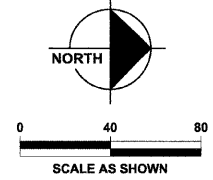
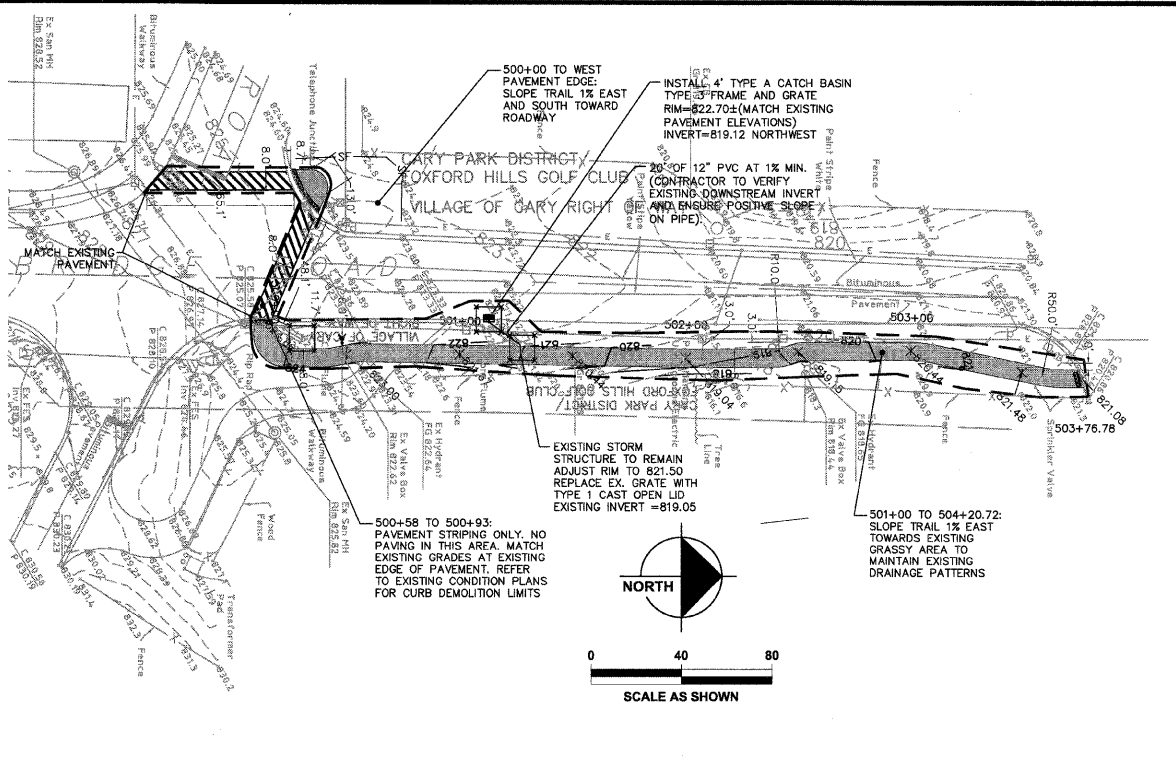

DESIGNED	- JWH	REVISED	
DRAWN	- LES	REVISED	
CHECKED	- JMM	REVISED	
DATE	- 10/02/2009	REVISED	

**STATE OF ILLINOIS  
DEPARTMENT OF TRANSPORTATION**

**CARY PARK DISTRICT  
CARY COMMUNITY TRAIL**

**EROSION CONTROL AND GRADING PLAN  
STA. 80+82.94 TO STA. 92+76.57  
STA. 111+00 TO 111+82.06  
STA. 100+00 TO 102+21.12  
STA. 500+00 TO 504+20.72**

SECTION	COUNTY	TOTAL SHEETS	SHEET NO.
06-P4001-00-BR	MCHENRY	64	58
FED. ROAD DIST. NO. 1	ILLINOIS	CONTRACT NO. 63333	

