

**STATE OF ILLINOIS**  
**DEPARTMENT OF TRANSPORTATION**  
**DIVISION OF HIGHWAYS**  
**PLANS FOR PROPOSED**  
**FEDERAL-AID HIGHWAY**  
**F.A.U. ROUTE 2734 (PFINGSTEN ROAD)**  
**WHITE PINE DRIVE TO KEYSTONE ROAD**  
**SECTION 09-00150-00-RS**  
**PROJECT NO. ARA-9003(308)**  
**VILLAGE OF NORTHBROOK**  
**COOK COUNTY**  
**C-91-587-09**

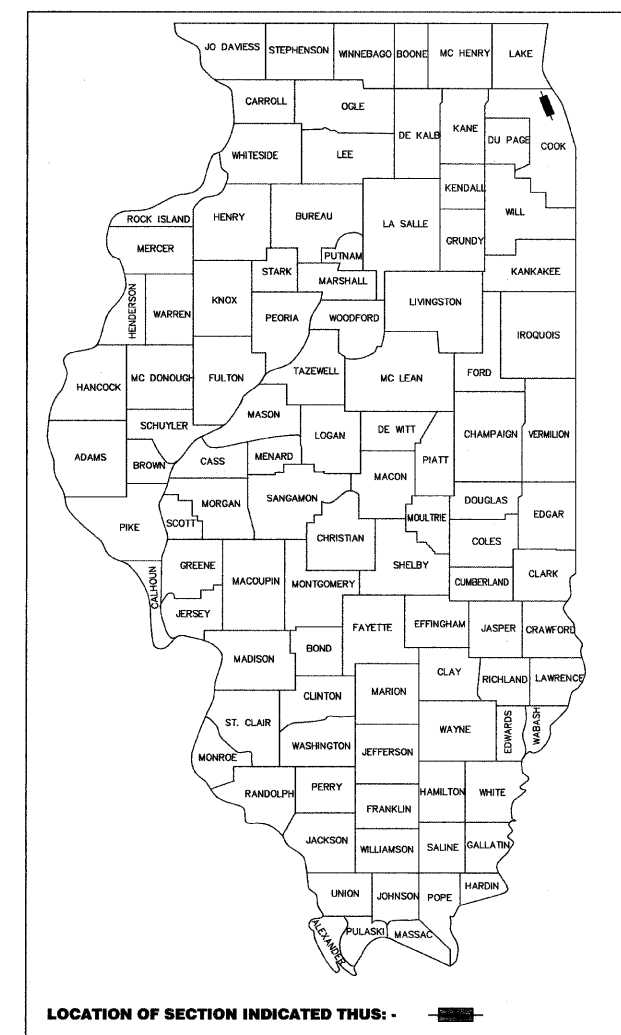

- INDEX OF SHEETS**
- 1 COVER SHEET
  - 2 GENERAL NOTES, DETAIL AND SUMMARY OF QUANTITIES
  - 3 TYPICAL SECTIONS
  - 4-7 ROADWAY PLAN SHEETS
  - 8-11 PAVEMENT MARKING PLAN SHEETS
  - 12 DRIVEWAY DETAILS DISTANCE BETWEEN ROW AND CURB OR EDGE < 4.5M (15')
  - 13 DRIVEWAY DETAILS DISTANCE BETWEEN ROW AND FACE OF CURB OR EDGE < 4.5M (15')
  - 14 DETAILS FOR FRAMES AND LIDS ADJUSTMENT WITH MILLING
  - 15 CURB OR CURB AND GUTTER REMOVAL AND REPLACEMENT
  - 16 BUTT JOINT AND BITUMINOUS TAPER DETAILS
  - 17 TRAFFIC CONTROL AND PROTECTION FOR SIDE ROADS, INTERSECTIONS AND DRIVEWAYS
  - 18 RAISED REFLECTIVE PAVEMENT MARKERS (SNOW PLOW RESISTANT)
  - 19 DISTRICT ONE TYPICAL PAVEMENT MARKINGS
  - 20 PAVEMENT MARKING LETTERS AND SYMBOLS FOR TRAFFIC STAGING
  - 21 TEMPORARY INFORMATION SIGNING
  - 22 DETECTOR LOOP INSTALLATION DETAIL FOR ROADWAY RESURFACING
  - 23 PAVEMENT PATCHING AND HMA SURFACED PAVEMENT
- HIGHWAY STANDARDS**
- 000001-05 STANDARD SYMBOLS, ABBREVIATIONS AND PATTERNS
  - 424001-05 CURB RAMPS FOR SIDEWALKS
  - 442201-03 CLASS C AND D PATCHES
  - 604076-04 FRAMES AND GRATES TYPE 21
  - 606001-04 CONCRETE CURB TYPE B AND COMBINATION CONCRETE CURB AND GUTTER
  - 606301-04 PC CONCRETE ISLANDS AND MEDIANS
  - 701606-06 URBAN LANE CLOSURE, MULTILANE, 2W WITH MOUNTABLE MEDIAN
  - 701701-06 URBAN LANE CLOSURE, MULTILANE INTERSECTION
  - 701801-04 LANE CLOSURE MULTILANE 1W OR 2W CROSSWALK OR SIDEWALK CLOSURE
  - 701901-01 TRAFFIC CONTROL DEVICES
  - 780001-02 TYPICAL PAVEMENT MARKINGS
  - 781001-03 TYPICAL APPLICATION RAISED REFLECTIVE PAVEMENT MARKERS
  - 886001-01 DETECTOR LOOP INSTALLATIONS

**TRAFFIC DATA:**  
**ADT 15,000 VPD (2006)**

**POSTED SPEED LIMIT - 40 MPH**  
**DESIGN SPEED LIMIT - 45 MPH**  
**CLASSIFICATION: ATERIAL**

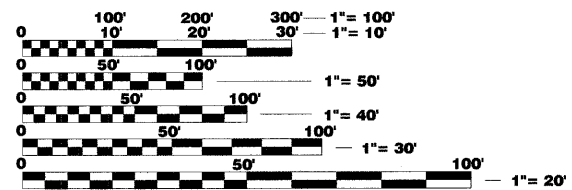

**FULL SIZE PLANS HAVE BEEN PREPARED USING STANDARD ENGINEERING SCALES. REDUCED SIZED PLANS WILL NOT CONFORM TO STANDARD SCALES. IN MAKING MEASUREMENTS ON REDUCED PLANS, THE ABOVE SCALES MAY BE USED.**

**J.U.L.I.E.**  
**JOINT UTILITY LOCATION INFORMATION FOR EXCAVATION**  
**1-800-892-0123**

**CONTRACT NO. 63362**

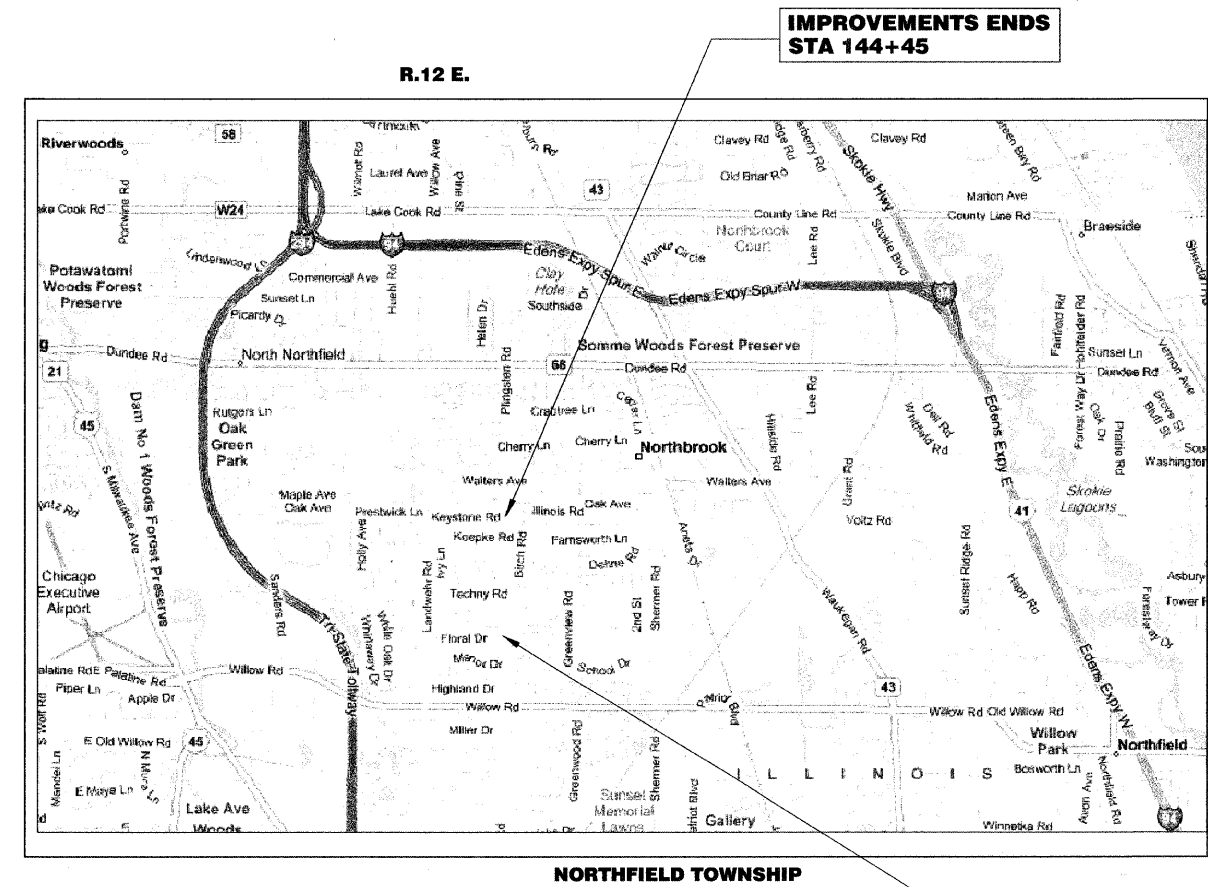

**IMPROVEMENTS ENDS**  
**STA 144+45**



**IMPROVEMENTS BEGINS**  
**STA 106+45**

**GROSS LENGTH OF PROJECT: 3,800 L.F. = 0.725 MILES**  
**NET LENGTH OF PROJECT: 3,800 L.F. = 0.725 MILES**

**STATE OF ILLINOIS**  
**DEPARTMENT OF TRANSPORTATION**  
**DIVISION OF HIGHWAYS**

APPROVED October 22, 2009

*Paul K. Kendzior*  
**VILLAGE ENGINEER**

PASSED OCTOBER 26 2009

*Cheryl Henderson*  
**DISTRICT ONE ENGINEER OF LOCAL ROADS AND STREETS**

RELEASING FOR BID  
 BASED ON LIMITED REVIEW OCTOBER 26, 2009

*Diane M. O'Keefe*  
**DEPUTY DIRECTOR OF HIGHWAYS, REGION ONE ENGINEER**

PROFESSIONAL ENGINEER'S SIGN & SEAL

**PAUL K. KENDZIOR**  
 REGISTERED PROFESSIONAL ENGINEER  
 STATE OF ILLINOIS

EXPIRES: PR. 1/30/11

**PRINTED BY THE AUTHORITY OF THE STATE OF ILLINOIS**

ASSOCIATE FIELD ENGINEER: KEVIN STALLWORTH 847-705-4169