

NOTE

1) ALL SIGNS DESIGNATED AS "NEW" SHALL BE PROVIDED BY THE VILLAGE. THE VILLAGE SHALL ALSO PROVIDE THE REQUIRED SIGN POSTS. THE CONTRACTOR SHALL INSTALL THE SIGN POSTS AT THE LOCATIONS NOTED AND INSTALL THE SIGN PANELS ON THE SIGN SUPPORTS. THE CONTRACTOR SHALL BE RESPONSIBLE FOR CONTACTING THE VILLAGE AT LEAST 48 HOURS PRIOR TO THE TIME OF INSTALLATION TO COORDINATE PICK-UP OF THE SIGN PANELS AND SUPPORTS FROM THE VILLAGE'S PUBLIC WORKS FACILITY. THIS WORK SHALL BE PAID FOR AS "INSTALL EXISTING SIGN PANEL".

2) WHEN A SIGN THAT IS SHOWN TO REMAIN CONFLICTS WITH THE CONTRACTOR'S CONSTRUCTION OPERATIONS, THE CONTRACTOR SHALL RELOCATE THE SIGN PANEL ASSEMBLY AND POST TO A TEMPORARY LOCATION APPROVED BY THE ENGINEER. THE SIGN PANEL ASSEMBLY AND POST SHALL BE RELOCATED TO THE PERMANENT LOCATION AS SOON AS CONSTRUCTION OPERATIONS PERMIT. THIS WORK SHALL BE INCLUDED IN THE COST OF THE VARIOUS TRAFFIC CONTROL AND PROTECTION ITEMS.

3) SIGNS DESIGNATED AS "REL" SHALL BE RELOCATED BY THE CONTRACTOR. THE ENGINEER SHALL DETERMINE IF THE EXISTING POST CAN BE RE-USED IN THE PERMANENT LOCATION. IF A REPLACEMENT POST IS REQUIRED, THE VILLAGE SHALL PROVIDE THE POSTS. THE CONTRACTOR SHALL BE RESPONSIBLE FOR CONTACTING THE VILLAGE AT LEAST 48 HOURS PRIOR TO THE TIME OF INSTALLATION TO COORDINATE PICK-UP OF THE POSTS FROM THE VILLAGE'S PUBLIC WORKS FACILITY.

- LEGEND**
- PROPOSED LIGHT POLE
 - EXISTING SIGN
 - PROPOSED SIGN
 - PROPOSED SIGNAL POST
 - NEW SIGN PANEL TO BE FURNISHED BY OTHERS (SEE NOTE)
 - REL RELOCATE SIGN PANEL ASSEMBLY, TYPE A OR B
 - REMAIN SIGN PANEL TO REMAIN IN SAME LOCATION
 - REM REMOVE SIGN PANEL ASSEMBLY, TYPE A OR B

DATE	
BY	
REVIEWED	
PLANNED	
ALIGNED	
CHECKED	
NO. CAD FILE NAME	

DATE	
BY	
REVIEWED	
PLANNED	
ALIGNED	
CHECKED	
NO. STRUCTURE NOTATIONS CHKD	

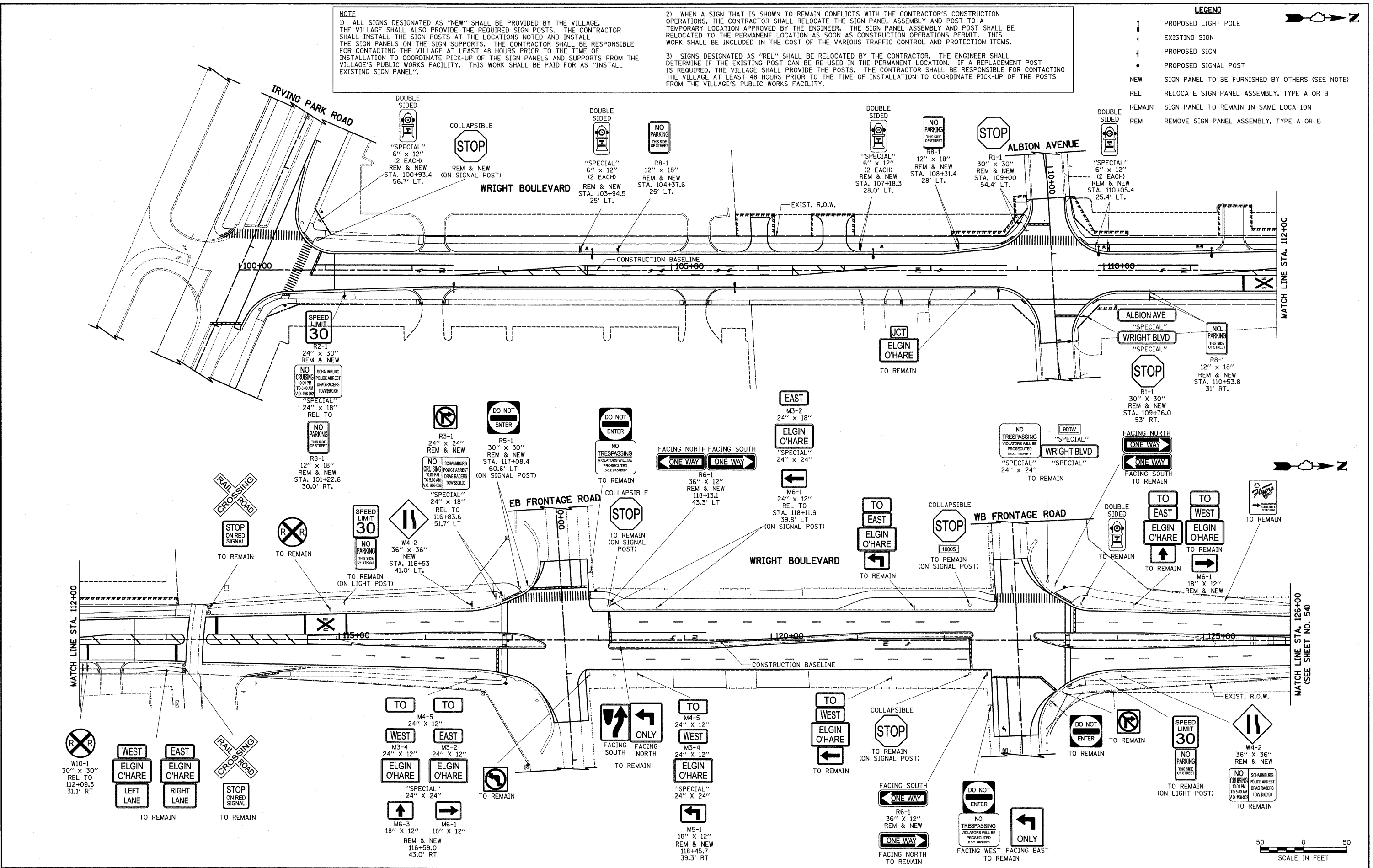

FILE NAME = ...cad\sheets\2215_SIGNING.dgn	USER NAME = krk	DESIGNED - JAT	REVISED -	STATE OF ILLINOIS DEPARTMENT OF TRANSPORTATION	WRIGHT BOULEVARD SIGNING PLAN		F.A.U. R.T.E. 1351	SECTION 06-00090-00-PV	COUNTY COOK	TOTAL SHEETS 137	SHEET NO. 67	
PLOT SCALE = 50.0000' / IN.	CHECKED - DJK	DATE - 10-16-09	REVISED -		SHEET NO. 1 OF 2 SHEETS	STA. 100+00 TO STA. 126+00	CONTRACT NO. 63378		ILLINOIS FED. AID PROJECT ARA-M-8003 (809)			