

STAGE 1

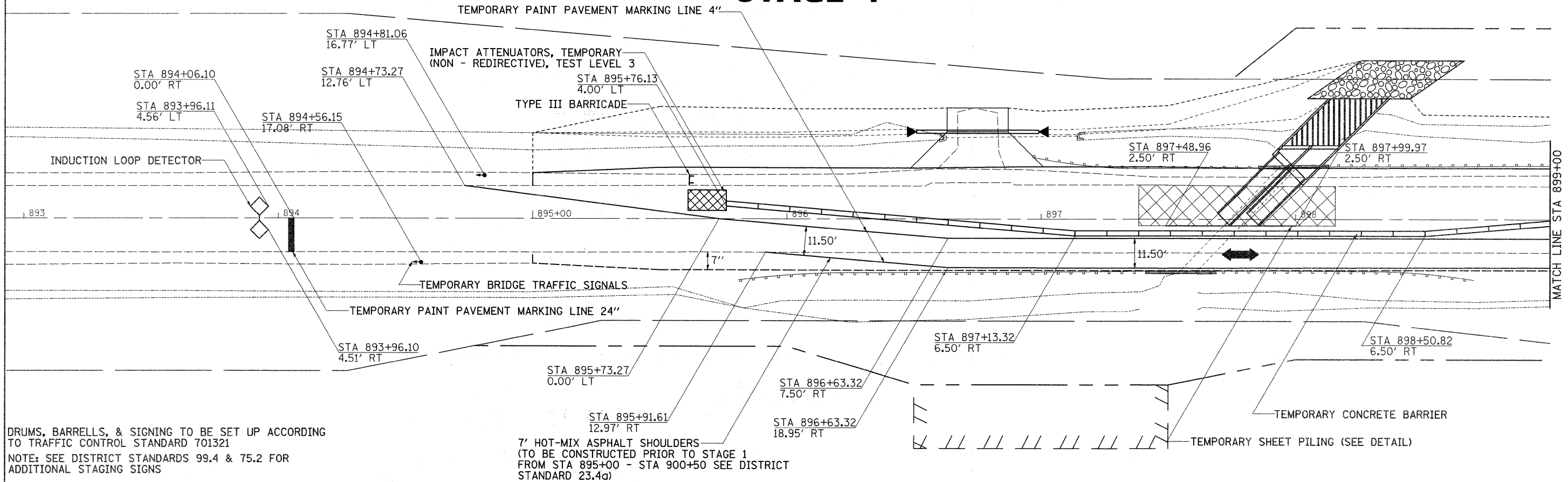

DRUMS, BARRELS, & SIGNING TO BE SET UP ACCORDING TO TRAFFIC CONTROL STANDARD 701321
 NOTE: SEE DISTRICT STANDARDS 99.4 & 75.2 FOR ADDITIONAL STAGING SIGNS

7' HOT-MIX ASPHALT SHOULDERS (TO BE CONSTRUCTED PRIOR TO STAGE 1 FROM STA 895+00 - STA 900+50 SEE DISTRICT STANDARD 23.4a)

STAGE 1

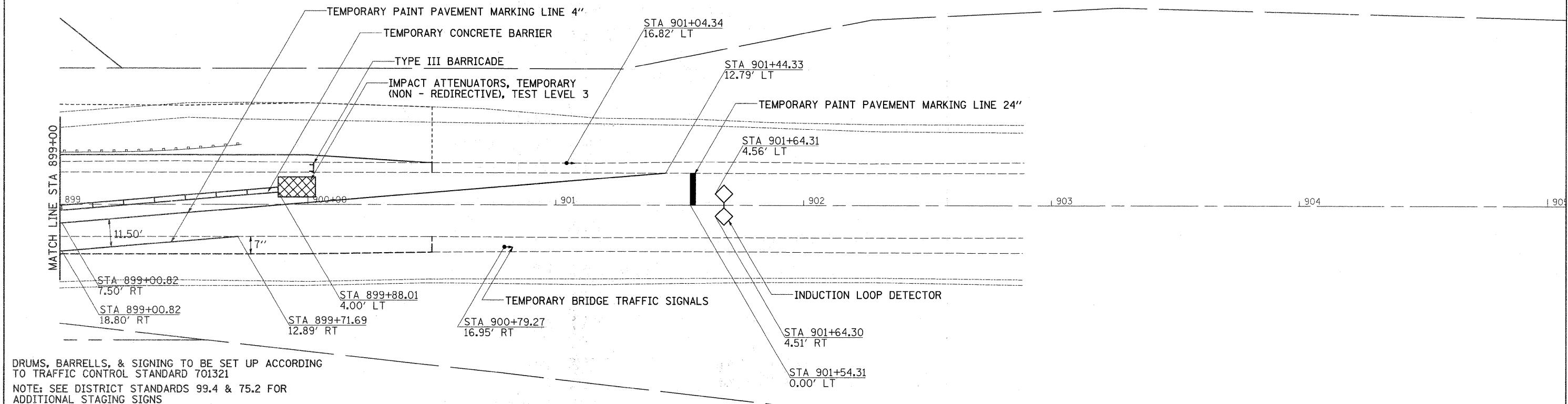

DRUMS, BARRELS, & SIGNING TO BE SET UP ACCORDING TO TRAFFIC CONTROL STANDARD 701321
 NOTE: SEE DISTRICT STANDARDS 99.4 & 75.2 FOR ADDITIONAL STAGING SIGNS

FILE NAME =	USER NAME = goffjl	DESIGNED -	REVISED -
c:\pwork\PIWIDOT\G0FFJL\dms37299\d01107stg.dgn		DRAWN -	REVISED -
PLOT SCALE = 20.0000' / IN.		CHECKED -	REVISED -
PLOT DATE = Mon Sep 21 07:55:15 2009		DATE -	REVISED -

STATE OF ILLINOIS
 DEPARTMENT OF TRANSPORTATION

STAGING DETAILS

SCALE: SHEET NO. 1 OF 2 SHEETS STA. TO STA.

F.A.P. RTE.	SECTION	COUNTY	TOTAL SHEETS	SHEET NO.
650	104T-2	JO DAVIESS	53	21
FED. ROAD DIST. NO.			ILLINOIS FED. AID PROJECT	
			CONTRACT NO. 64C79	