

STATE OF ILLINOIS  
DEPARTMENT OF TRANSPORTATION

SECTION	COUNTY	TOTAL SHEETS	SHEET NO.
15BR-3	LIVINGSTON	59	37

B.M. #45 on S.E. Wingwall 12' Rt. Sta. 407+6700  
Elev. -610.76  
Existing Structure: Sta. 407+80 (Exst. Plans)  
Sta. 407+66 (New Survey) built in 1922 as S.B.T.  
Rt 17 Sec. 15 Existing R.C. Thru Girder on  
closed Abuts. to be removed by bridge  
contractor before new construction starts.  
Traffic to be detoured. Struct. N° 053-0042.

GENERAL NOTES

See Proposal for Boring Data.  
The Contractor shall drive two concrete test piles in a permanent location at the West Abutment and Pier 2 as directed by the Engineer before ordering the remainder of piles.  
The top surface of the beams shall be finished in accordance with Article 505.06 of the Standard Specification except that the surface shall not be roughened by brooming. The finished surface shall be free of depressions or high spots with sharp corners.  
The parapet shall be constructed of Class X Concrete, except the aggregates shall conform to the requirements of handrail concrete.  
Protective Coat shall not be applied to surfaces to which Waterproofing Membrane System is applied.  
Reinforcement Bars shall conform to the requirements of AASHTO M31 or M53 Grade 60.

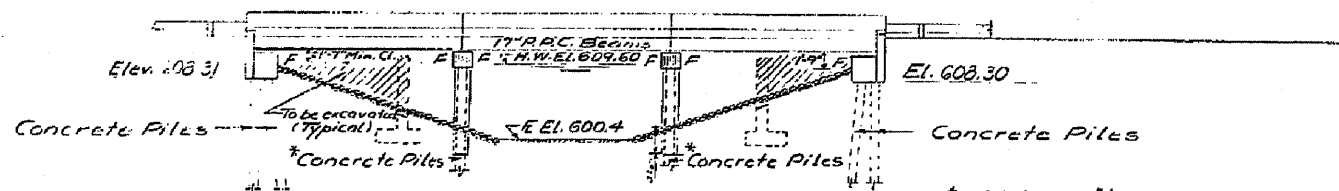

\* Set piles in 14" prepared holes drilled to Elev. 594.00 in accordance with Article 513.09 (c) of the Standard Specifications. (Cast incidental). Pre-curing is necessary because of high Qu Till (3,975F) just below F.L. Pier Piles will have ±11.5' of embedment below F.L.

ELEVATION

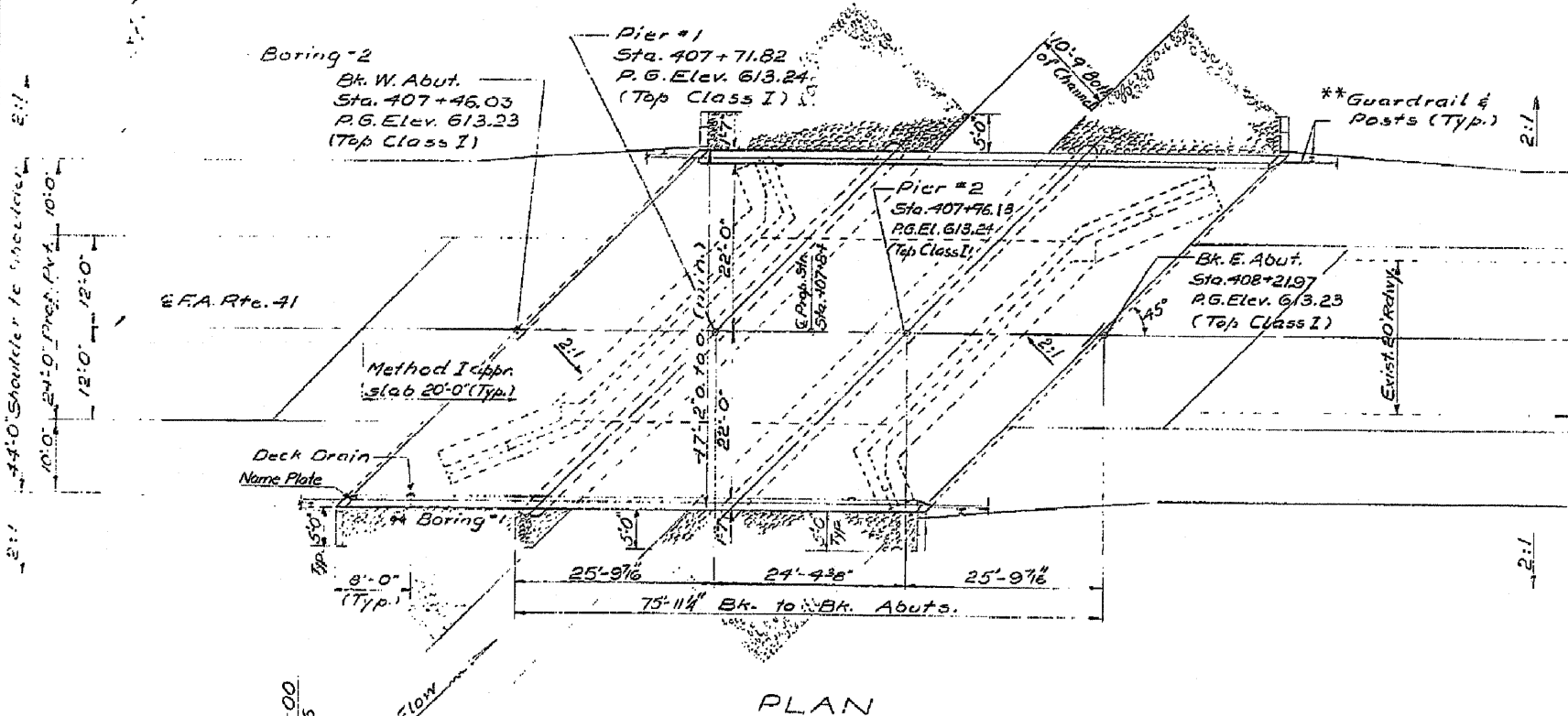

PLAN

TOTAL BILL OF MATERIAL

Item	Unit	Super	Sub	Total
Structure Excavation	Cu. Yd.		230	230
Bituminous Concrete Surface Course, Class I	Ton	23		23
Protective Coat	Sq. Yd.	60		60
Removal of Existing Structures	Each	1		1
Class X Concrete	Cu. Yd.	16.4	175.5	191.9
Precast Prestressed Concrete Deck Beams (17" Depth)	Sq. Ft.	3420		3420
Portland Cement Mortar Fairing Course	Lin. Ft.	1019		1019
Reinforcement Bars	Pound	2380	14,060	16,440
Concrete Piles	Lin. Ft.		852	852
Test Piles (Concrete)	Each		2	2
Name Plates	Each	1		1
Stone Rip Rap	Sq. Yd.		430	430
Waterproofing Membrane System	Sq. Yd.	357		357

\*\* End Terminal shall be Standard E341.

STATION 407+84.00  
BUILT BY  
STATE OF ILLINOIS  
F.A. RT. 41 SEC. 15 BR-3  
F.A. PROJ.  
LOADING HS20  
\*\*\* STR. NO.

NAME PLATE

Std. 213  
\*\*\* Structure number to be supplied by District

WATERWAY INFORMATION

Drainage Area 7.4 Sq. Miles  
Character: level, clay, cultivated  
Existing opening 209'±  
Required opening 238'±  
Proposed opening (below 50yr. HWE) 238'±

PRESTRESSED UNITS

$f_c = 5,000$  psi  
 $f_{ci} = 4,000$  psi  
 $f_s = 270,000$  psi (2# Strands)  
 $f_{si} = 189,000$  psi (2# Strands)

FIELD UNITS

$f_c = 3,500$  psi  
 $f_y = 60,000$  psi (Reinf.)

Loading HS20-44

Design Specifications: 1977 AASHTO, 1978 Interim Specifications.  
Allow 25#1 Sq. Ft. for future W.S.

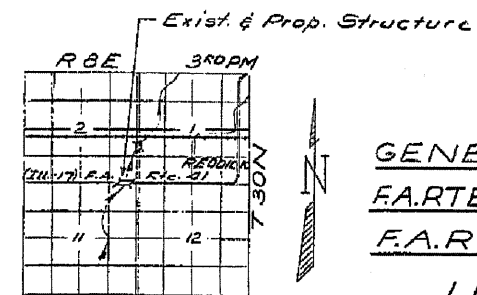

LOCATION SKETCH

GENERAL PLAN & ELEVATION  
F.A.RTE.41 OVER DRAINAGE DITCH  
F.A.RTE.41 SECTION 15BR-3

LIVINGSTON CO.  
STA. 407+84.00

PROPOSED PROFILE F.A.RTE 41  
(6' & Rdwy)

DESIGNED	J.R.S.
CHECKED	J.R.S.
DRAWN	J.R.S.
CHECKED	J.R.S.

EXAMINED	[Signature]
PASSED	[Signature]
APPROVED	[Signature]

H.W. Elev. (50) = 609.60  
 $Q(50) = 9.50$  c.f.s.  
Created Head = 0.4'  
H.W. Elev. (100) = 609.70  
 $Q(100) = 10.85$  c.f.s.  
Created Head = 0.4'

FILE NAME =	USER NAME = duncenbd	DESIGNED -	REVISED -	STATE OF ILLINOIS	FOR INFORMATION ONLY	F.A.P. RTE.	SECTION	COUNTY	TOTAL SHEETS	SHEET NO.
cr:\pw\work\p\wdot\duncenbd\dms32420\d3833-sht-details.dgn		DRAWN -	REVISED -	DEPARTMENT OF TRANSPORTATION	SCALE: SHEET NO. OF SHEETS STA. TO STA.	41	(15BR-3)-1	LIVINGSTON	45	34
PLOT SCALE = 50.0000' / IN.		CHECKED -	REVISED -							CONTRACT NO. 66833
PLOT DATE = Oct 08, 2009 - 02:44:45 PM		DATE -	REVISED -							ILLINOIS FED. AID PROJECT