

DATE	
BY	
REVISIONS	
PLANNING	
DESIGN	
CONSTRUCTION	
AS-BUILT	
NO. _____	
DATE	
BY	
REVISIONS	
PLANNING	
DESIGN	
CONSTRUCTION	
AS-BUILT	
NO. _____	

DATE	
BY	
REVISIONS	
PLANNING	
DESIGN	
CONSTRUCTION	
AS-BUILT	
NO. _____	
DATE	
BY	
REVISIONS	
PLANNING	
DESIGN	
CONSTRUCTION	
AS-BUILT	
NO. _____	

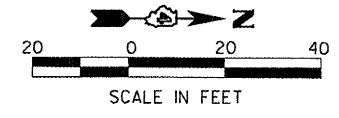
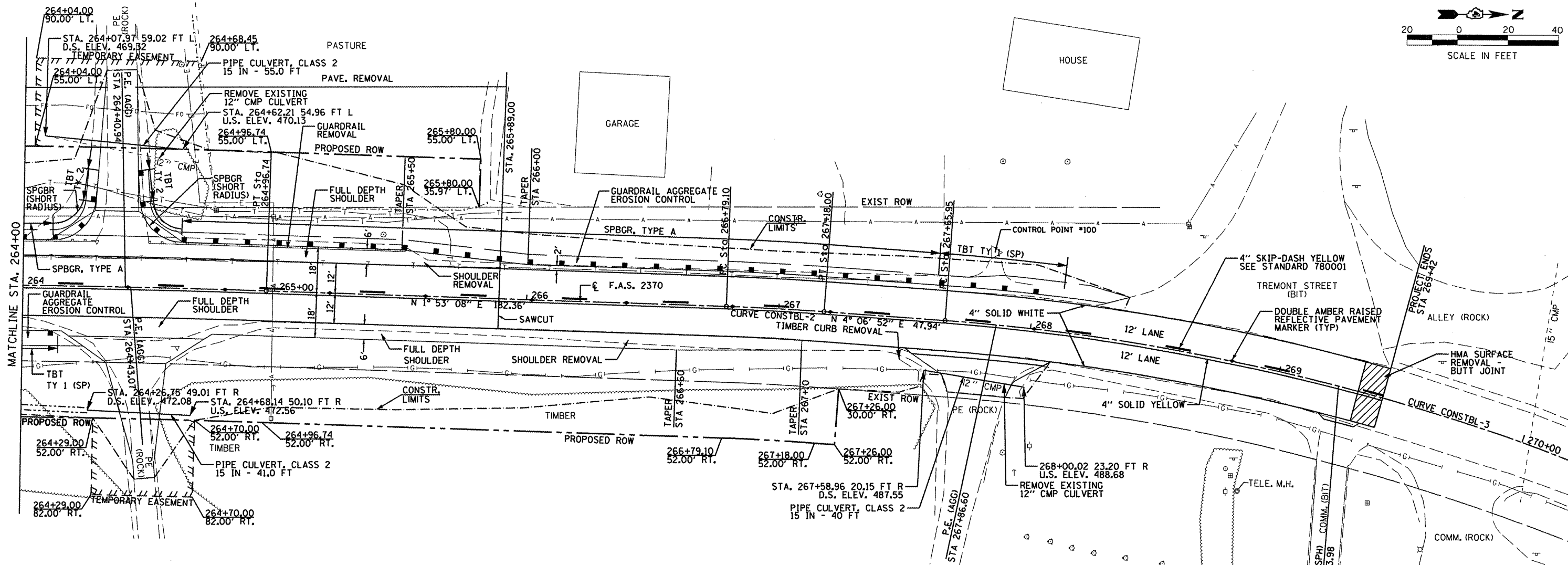

- NOTES:
- SEE TYPICAL SECTION SHEET AND DISTRICT CADD STD. 630101-D4 FOR EROSION CONTROL AGGREGATE DETAILS AT GUARDRAIL LOCATIONS.
  - SEE TYPICAL SECTION SHEETS FOR FULL DEPTH SHOULDER PAVEMENT DETAIL.

**EFK Moen, LLC**  
Civil Engineering Design

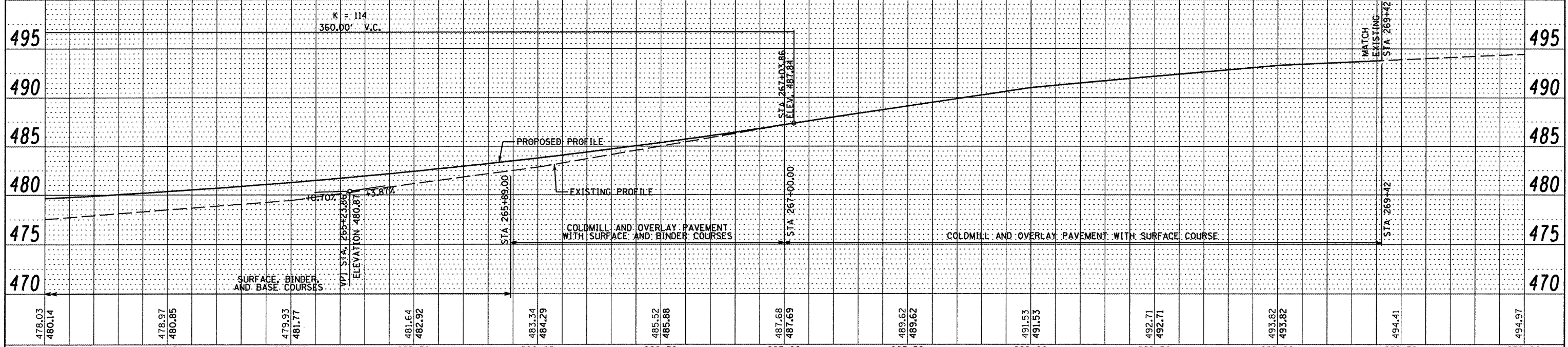

FILE NAME	USER NAME = JD	DESIGNED -	REVISED -	<b>STATE OF ILLINOIS DEPARTMENT OF TRANSPORTATION</b>	<b>PLAN AND PROFILE</b>	F.A.S. RTE.	SECTION	COUNTY	TOTAL SHEETS	SHEET NO.
#FILE#	DRAWN - JD	REVISED -	2370			29BR-1	WOODFORD	76	11	
PLOT SCALE = #SCALE#	CHECKED - SD	REVISED -	CONTRACT NO. 68466							
PLOT DATE = #DATE#	DATE - 10/1/09	REVISED -	ILLINOIS FED. AID PROJECT							