

SEC. 11, T 19 N, R 12 W, 2ND PM

- (A) FRAME AND LID TO BE ADJUSTED
- (A) VALVE BOX FRAME TO BE ADJUSTED

- P.C.C. SURFACE REM., BUTT JOINT
- H.M.A. SURFACE REM., BUTT JOINT
- COLD MILLING (SPECIAL)

NOTES:
 1. DRAINAGE SHALL BE MAINTAINED THROUGH ALL ENTRANCES.
 2. OMIT ALL NEW PCC ENTRANCE GUTTERS FROM MILLING AND RESURFACING
 3. SEE SPECIAL PROVISIONS FOR REQUIREMENTS OF OPENING MANHOLES AND WATER VALVE BOXES AFTER RESURFACING IS COMPLETE

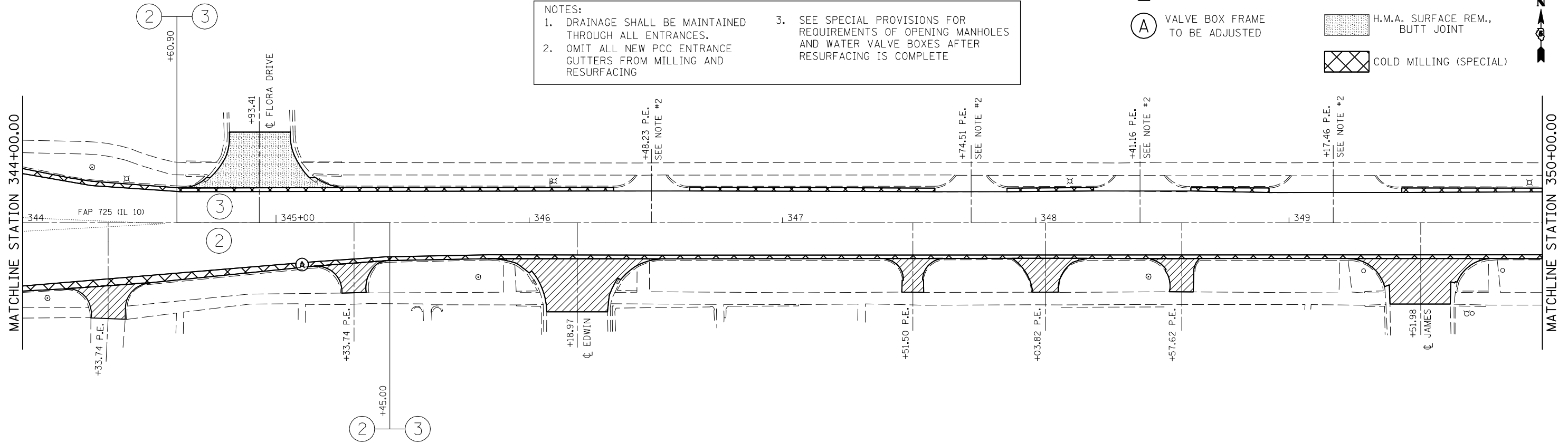

SEC. 14, T 19 N, R 12 W, 2ND PM
 SEC. 11, T 19 N, R 12 W, 2ND PM

- P.C.C. SURFACE REM., BUTT JOINT
- H.M.A. SURFACE REM., BUTT JOINT
- COLD MILLING (SPECIAL)

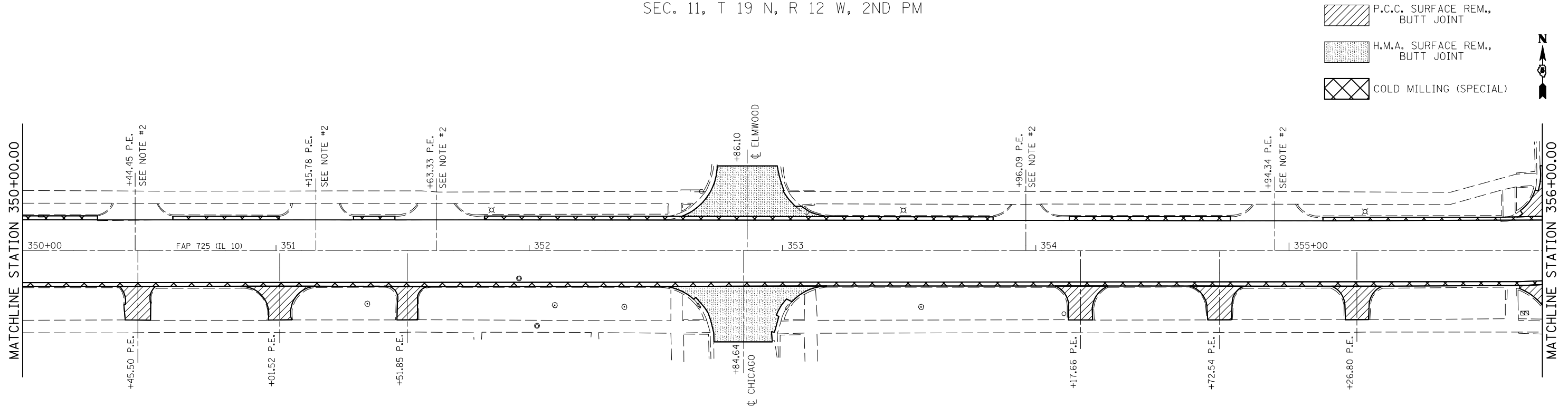

NOTES:
 1. DRAINAGE SHALL BE MAINTAINED THROUGH ALL ENTRANCES.
 2. OMIT ALL NEW PCC ENTRANCE GUTTERS FROM MILLING AND RESURFACING
 3. SEE SPECIAL PROVISIONS FOR REQUIREMENTS OF OPENING MANHOLES AND WATER VALVE BOXES AFTER RESURFACING IS COMPLETE

SEC. 14, T 19 N, R 12 W, 2ND PM

FILE NAME =	USER NAME = hoganbj	DESIGNED -	REVISED -
ct:\pwwork\p\WIDOT\HOGANBJ\d0142445\0570782-sht-plan.dgn		DRAWN -	REVISED -
		CHECKED -	REVISED -
		DATE -	REVISED -

STATE OF ILLINOIS
 DEPARTMENT OF TRANSPORTATION

SCALE: 1" = 20'		SHEET NO. 3 OF 4 SHEETS		STA.	TO STA.
-----------------	--	-------------------------	--	------	---------

F.A.P. RTE.	SECTION	COUNTY	TOTAL SHEETS	SHEET NO.
725	(32R,ZIRS-4	CHAMPAIGN	35	19
CONTRACT NO. 70782				
ILLINOIS FED. AID PROJECT				