

STA. 806+00 TO STA. 810+00
 CONSTRUCT HMA BASE COURSE 10" &
 TEMPORARY EARTHWORK TO DRAIN.
 OMIT FINAL EARTHWORK, SEEDING & RIPRAP

STA. 810+00 TO STA. 812+00
 CONSTRUCT HMA BASE COURSE 10",
 FINAL EARTHWORK, SEED & RIPRAP

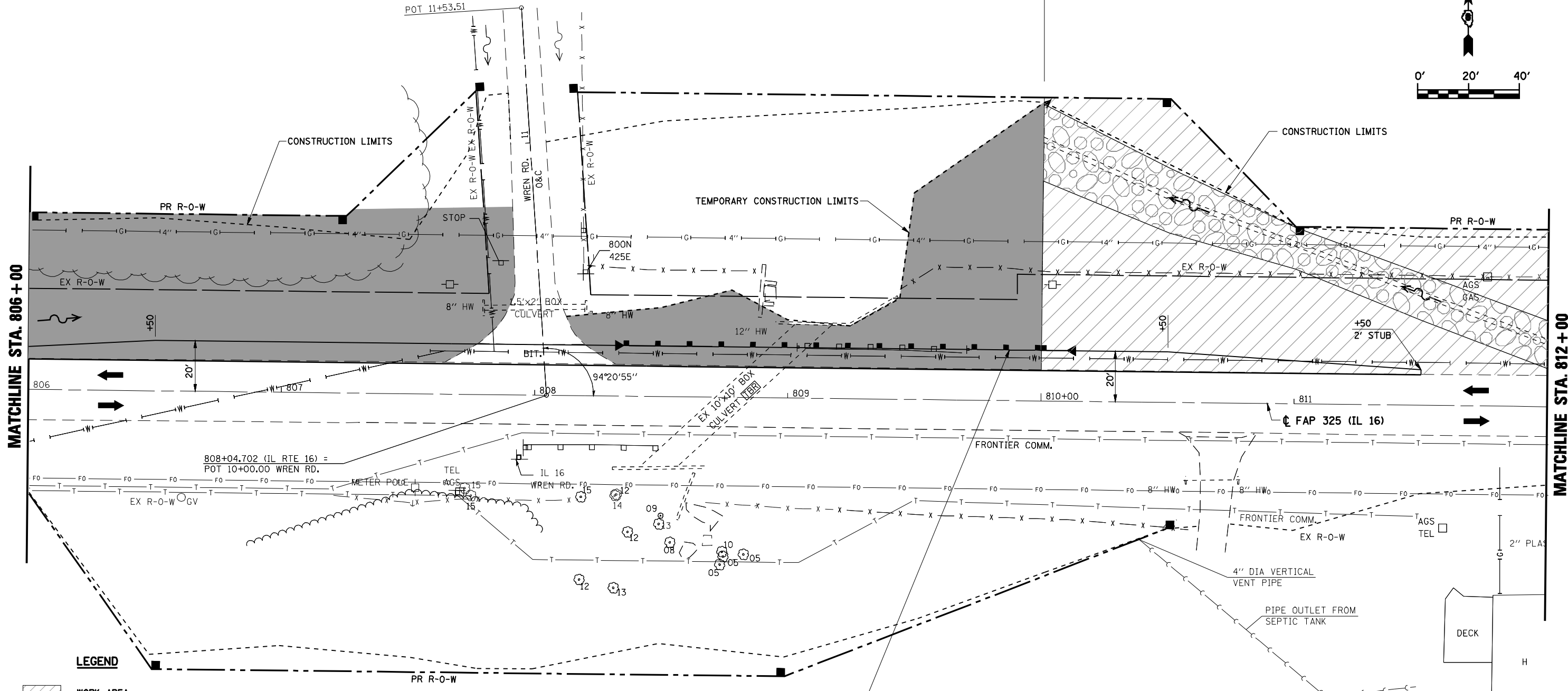
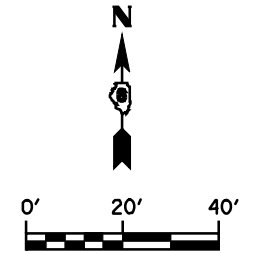

LEGEND

- WORK AREA
- SIGN
- TYPE III BARRICADE
- DRUM WITH STEADY BURNING LIGHT
- TRAFFIC SIGNAL
- TYPE C BIDIRECTIONAL REFLECTOR
- TEMPORARY CONCRETE BARRIER
- IMPACT ATTENUATOR
- STEADY BURNING LIGHTS AND DOUBLE VERTICAL PANELS
- TRAFFIC FLOW

TEMPORARY GUARDRAIL 20' LT
 TRAFFIC BARRIER TERMINAL TYPE 1 (SPECIAL) TANGENT STA. 808+35 TO STA. 808+85
 STEEL PLATE BEAM GUARDRAIL, TYPE A, 6 FOOT POSTS STA. 808+85 TO STA. 809+60
 TRAFFIC BARRIER TERMINAL TYPE 1 (SPECIAL) TANGENT STA. 809+60 TO STA. 810+10
 REMOVE EXISTING GUARDRAIL LT STA. 809+06 TO STA. 809+69

NOTE:
 SEE "STORM WATER POLLUTION
 PREVENTION PLANS" FOR TEMPORARY
 EROSION CONTROL.

FILE NAME =	USER NAME = laughlinr1	DESIGNED -	REVISED -	STATE OF ILLINOIS DEPARTMENT OF TRANSPORTATION	MAINTENANCE OF TRAFFIC STAGE 1A STA. 806 + 00 TO STA. 812 + 00	F.A.P. RTE.	SECTION	COUNTY	TOTAL SHEETS	SHEET NO.	
es:\pw\work\PWIDOT\LAUGHLINRL\0169540\811\STAGING1A.dgn		DRAWN -	REVISED -			325	114 (B-1)	MACOUPIN	57	14	
PLOT SCALE = 40.0000' / IN.		CHECKED -	REVISED -			CONTRACT NO. 72646					
PLOT DATE = Oct-21-2009 11:08:39AM		DATE -	REVISED -			ILLINOIS FED. AID PROJECT					