

STA. 806+00 TO STA. 808+70  
 CLOSE WREN RD. USING STD BLR 21.  
 CONSTRUCT WREN RD, PIPE CULVERT,  
 END SECTIONS, FINAL EARTHWORK, SEED AND RIPRAP.

STA. 808+70 TO STA. 810+00  
 REMOVE & REPLACE BOX CULVERT,  
 PAVEMENT & HMA BASE COURSE 10".  
 CONSTRUCT FINAL EARTHWORK, SEED & RIPRAP.  
 (SEE CULVERT DETAILS)

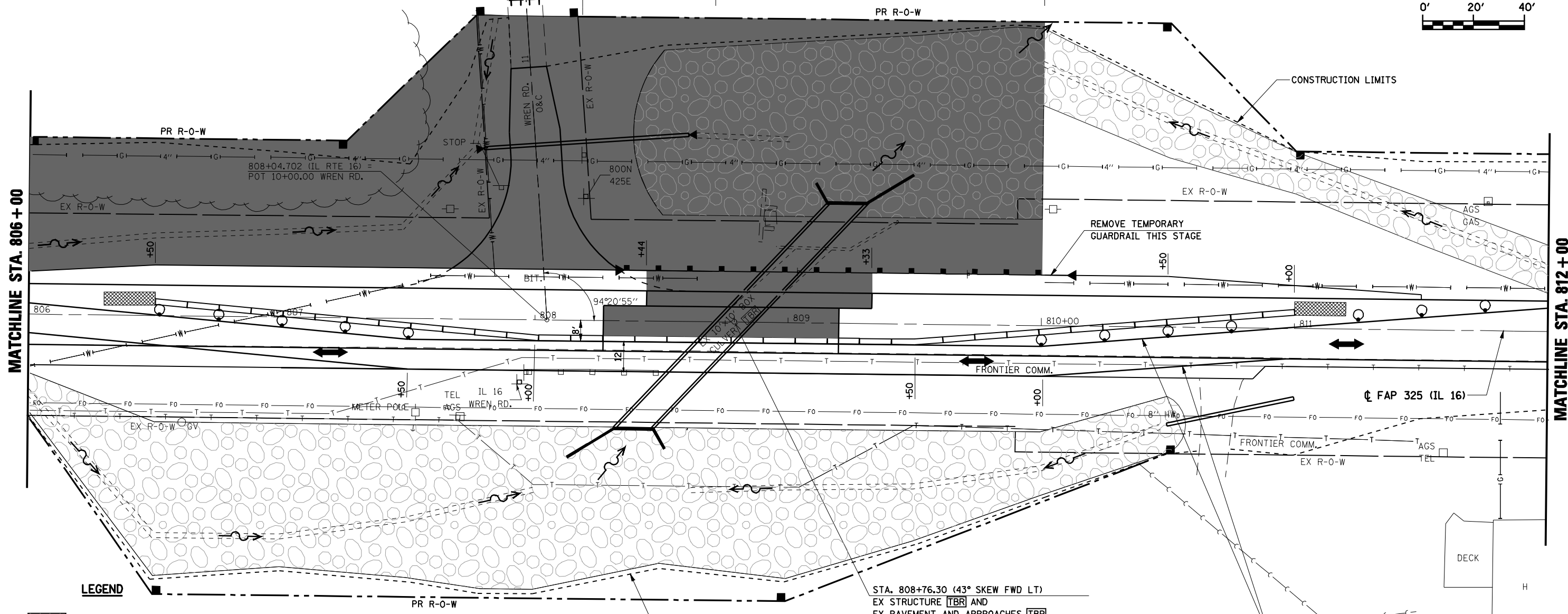
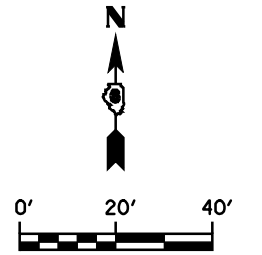

**LEGEND**

- WORK AREA
- SIGN
- TYPE III BARRICADE
- DRUM WITH STEADY BURNING LIGHT
- TRAFFIC SIGNAL
- TYPE C BIDIRECTIONAL REFLECTOR
- TEMPORARY CONCRETE BARRIER
- IMPACT ATTENUATOR
- STEADY BURNING LIGHTS AND DOUBLE VERTICAL PANELS
- TRAFFIC FLOW

STA. 808+76.30 (43° SKEW FWD LT)  
 EX STRUCTURE [TBR] AND  
 EX PAVEMENT AND APPROACHES [TBR]  
 PR 10' X 10' RC BOX CULVERT (SEE DETAILS)  
 PR GRANULAR BACKFILL  
 PR HMA BASE COURSE 10"

**NOTE:**  
 SEE "STORM WATER POLLUTION  
 PREVENTION PLANS" FOR TEMPORARY  
 EROSION CONTROL.

FILE NAME =	USER NAME = laughlinr1	DESIGNED -	REVISED -	<b>STATE OF ILLINOIS DEPARTMENT OF TRANSPORTATION</b>	<b>MAINTENANCE OF TRAFFIC STAGE 3</b>	F.A.P. RTE.	SECTION	COUNTY	TOTAL SHEETS	SHEET NO.	
et\pwork\PWIDOT\LAUGHLINRL\0169540\B01STAGING3.dgn		DRAWN - TRF	REVISED -			325	114 (B-1)	MACOUPIN	57	23	
PLOT SCALE = 40.0000' / IN.		CHECKED - RG	REVISED -			CONTRACT NO. 72646					
PLOT DATE = Oct-21-2009 11:11:01AM		DATE - 7/31/09	REVISED -			ILLINOIS FED. AID PROJECT					
				SCALE: 1"=20'	SHEET NO. OF SHEETS	STA. 806+00 TO STA. 812+00					