

**LEGEND**

- ① PR HMA SURFACE COURSE, MIX "D", N50 (1 1/2")
- ② PR LEVELING BINDER (MACHINE METHOD), N50
- ③ PR HMA BASE COURSE, 10"
- ④ PR 2' EARTH SHOULDER

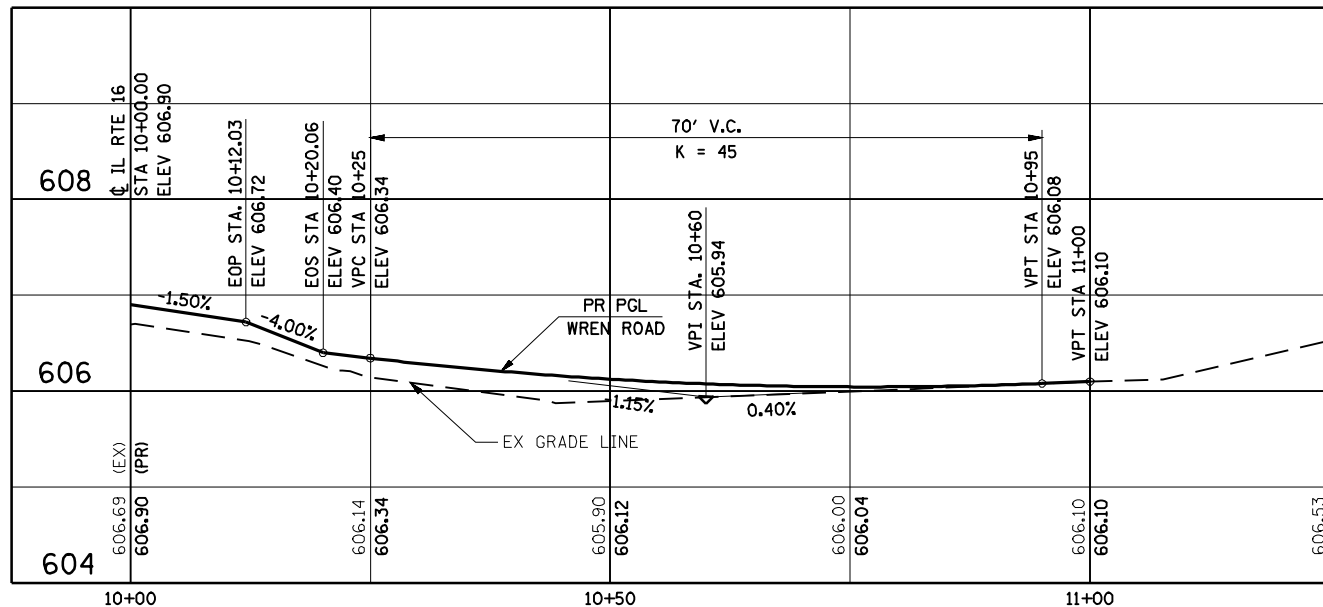

SLOPE TRANSITIONS				
STA.	LT		RT	
	DIRECTION	SLOPE	DIRECTION	SLOPE
10+20.06	↘		↘	0.40%
10+22.08	↘	0.47%		
10+57.62			↘	1.50%
10+66.74	↘	1.50%		
10+75	↘	1.50%	↘	1.50%
11+00	↘	3.50%*	↘	3.90%*

\* MATCH EXISTING

