

EXIST. CURVE 50  
 P.I. STA. 369+93.81  
 $\Delta = 53^{\circ}45'01''$   
 $D = 2^{\circ}00'02''$   
 $R = 2863.99'$   
 $T = 1451.43'$   
 $L = 2686.77'$   
 $E = 346.79'$   
 $S.E. = 4.44\%$   
 $T.P. = 25'$   
 P.C. STA. 355+42.39  
 P.T. STA. 382+29.16

SE TRANS:  
 SE = 4.44%  
 LT 355+10.000 TO 355+78.057 (-1.50% TO 4.44%)  
 RT 355+10.000 TO 355+78.057 (-1.50% TO -4.44%)  
 LT 381+93.493 TO 383+36.642 (4.44% TO -1.50%)  
 RT 381+93.493 TO 382+64.345 (-4.44% TO -1.50%)

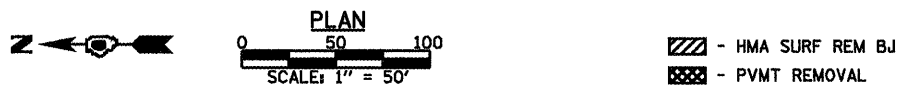
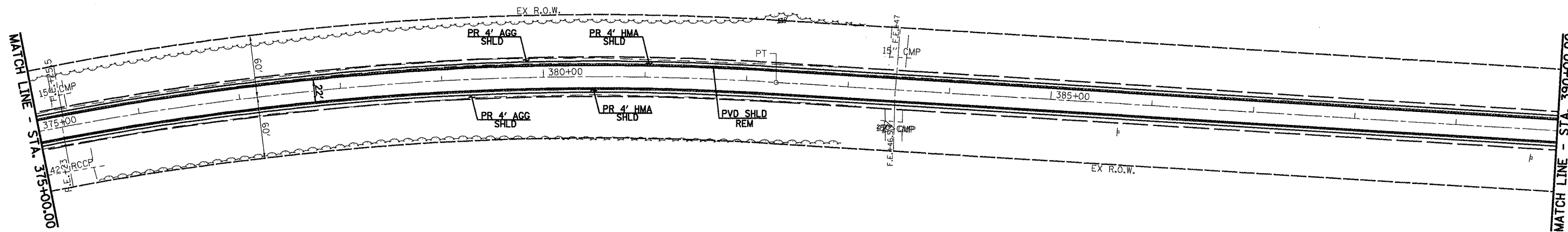

- HMA SURF REM BJ  
 - PVMT REMOVAL

EXIST. CURVE 51  
 PI STA. =411+11.06  
 $\Delta = 53^{\circ}37'36''$  (LT)  
 $D = 2^{\circ}24'15''$   
 $R = 2,383.22'$   
 $T = 1,204.55'$   
 $L = 2,230.60'$   
 $E = 287.11'$   
 $S.E. = 3.5\%$   
 $T.R. = 35'$   
 P.C. STA. =399+06.51  
 P.T. STA. =421+37.11

SE TRANS:  
 SE = 3.5%  
 LT 398+53.86 TO 399+35.76 (-1.5% TO -3.5%)  
 RT 398+18.76 TO 399+35.76 (-1.5% TO +3.5%)  
 LT 421+07.86 TO 421+58.17 (-3.5% TO -1.5%)  
 RT 421+07.86 TO 422+28.37 (+3.5% TO -1.5%)

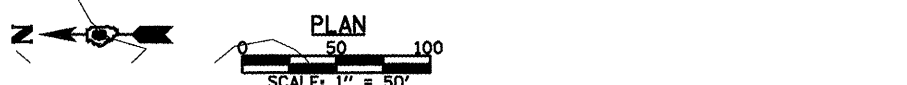
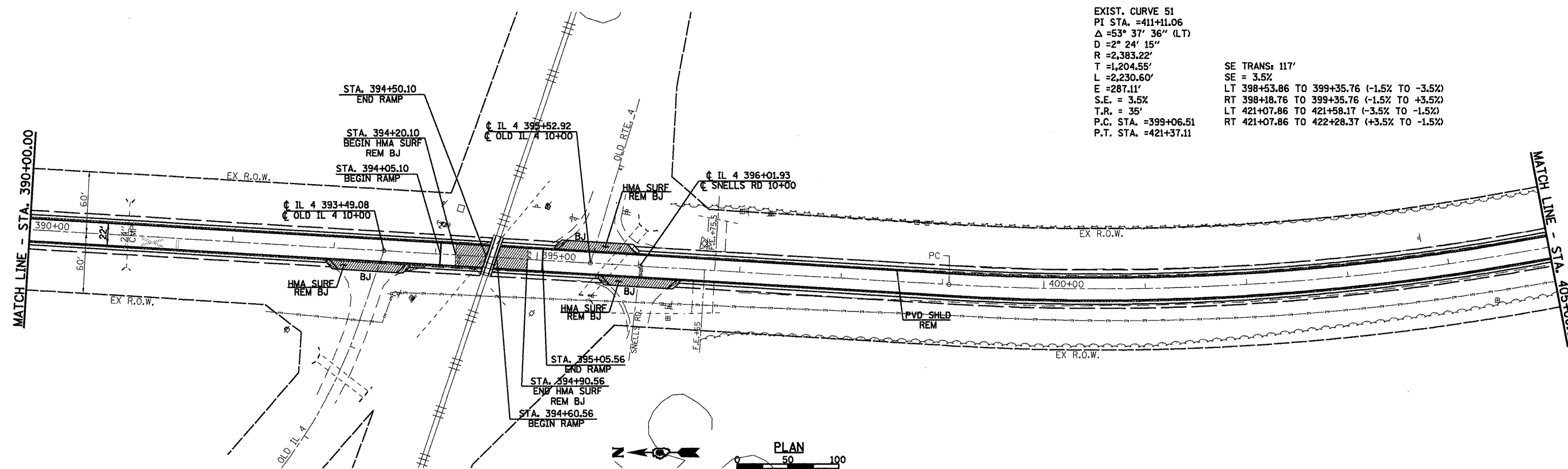

FILE NAME =	USER NAME = medonievj	DESIGNED -	REVISED -		<b>Allen Henderson &amp; Associates, Inc.</b> Civil and Structural Engineers Springfield, IL. 62703 Phone: (217)544-8033 IL Design Firm No. 184-001907	<b>ROADWAY PLAN</b>		F.A.P. RTE.	SECTION	COUNTY	TOTAL SHEETS	SHEET NO.
SAPROJ ENGR 1 (Negangard)\Dust Squad\VP	662 (IL 4) Henderson pdlfa\CAOD Sheets\0674	DRAWN PLAN2rdgn	REVISED -					662	DIW-3,RS-11,CR)	MACOUPIN	102	33
PLOT SCALE = 1/8" = 1' IN.	CHECKED -	REVISED -	REVISED -			CONTRACT NO. 72765						
PLOT DATE = Aug-17-2009 04:05:50PM	DATE -	REVISED -	REVISED -			FED. ROAD DIST. NO. ILLINOIS FED. AID PROJECT						

SCALE: 1" = 50' SHEET NO. 1 OF 2 SHEETS STA. 375+00.00 TO STA. 405+00.00