

DATE	
BY	
FINAL SURVEY	SURVEYED
NOTE BOOK NO.	PLOTTED
	TEMPLATE
	AREAS CHECKED

DATE	
BY	
ORIGINAL SURVEY	SURVEYED
NOTE BOOK NO.	PLOTTED
	TEMPLATE
	AREAS CHECKED

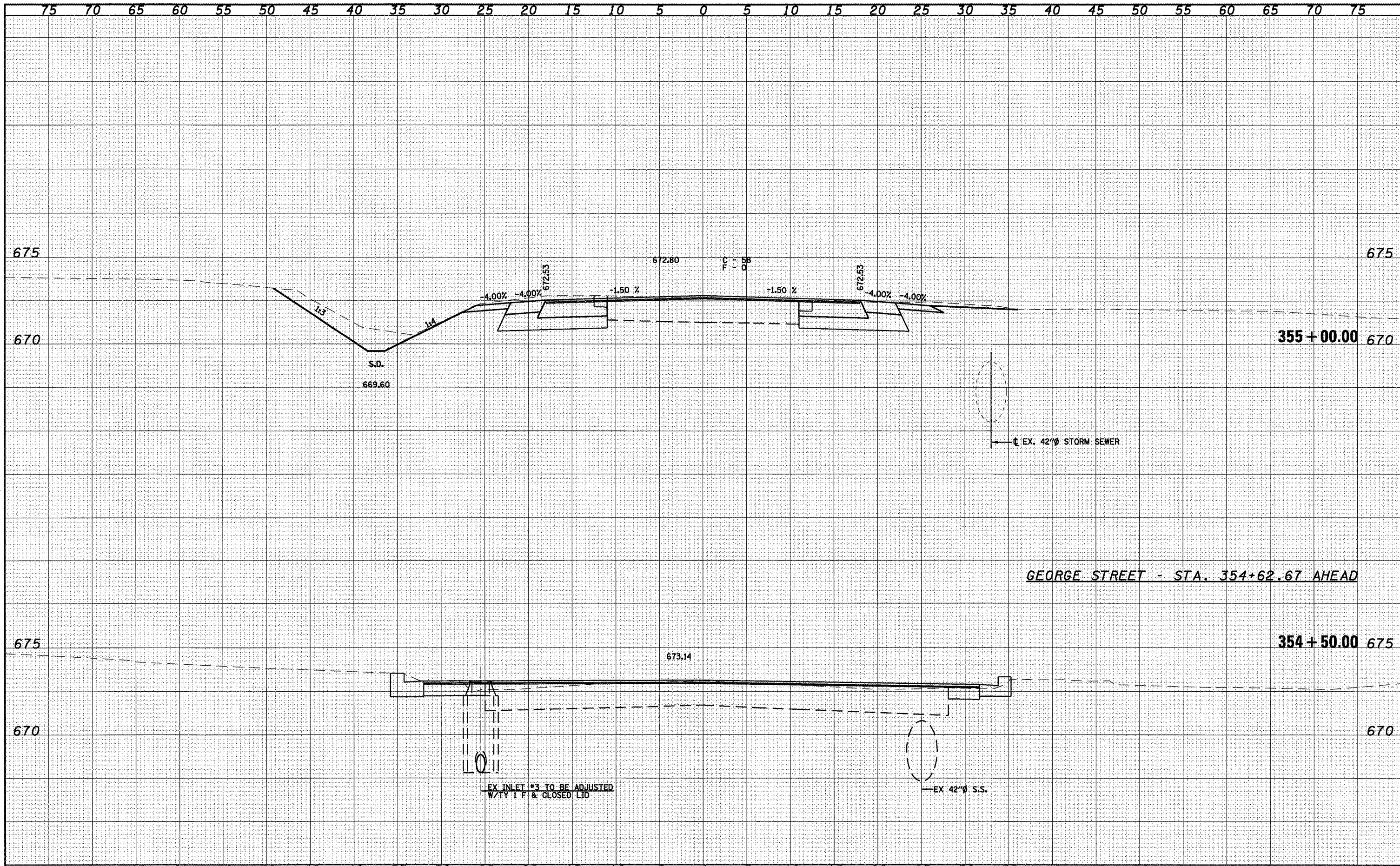

FILE NAME =	USER NAME = medomavj	DESIGNED -	REVISED -		<b>Allen Henderson &amp; Associates, Inc.</b> Civil and Structural Engineers Springfield, IL. 62703 Phone: (217)544-8033 IL. Design Firm No. 184-001907	<b>CROSS SECTIONS</b>		F.A.P. RTE.	SECTION	COUNTY	TOTAL SHEETS	SHEET NO.
	PLOT SCALE = 10.0000' / IN.	DRAWN -	REVISED -			662	DIW-3,RS-11,CR)	MACOUPIN	102	73		
	PLOT DATE = Aug-17-2009 04:07:29PM	CHECKED -	REVISED -			CONTRACT NO. 72765						
		DATE -	REVISED -			FED. ROAD DIST. NO. ILLINOIS FED. AID PROJECT						

S:\PROJ ENGR 1 (Noqanq-d\Draws\Quad\FAP 662 (L. 4) Henderson pdf\VCADD Sheets\0672765-sh1-2009.dgn