

DATE	
BY	
NO.	
AREAS CHECKED	
TEMPLATE	
NOTE BOOK	
SURVEYED	
PLOTTED	
FINAL	
SHEET	

DATE	
BY	
NO.	
AREAS CHECKED	
TEMPLATE	
NOTE BOOK	
SURVEYED	
PLOTTED	
ORIGINAL	
SHEET	

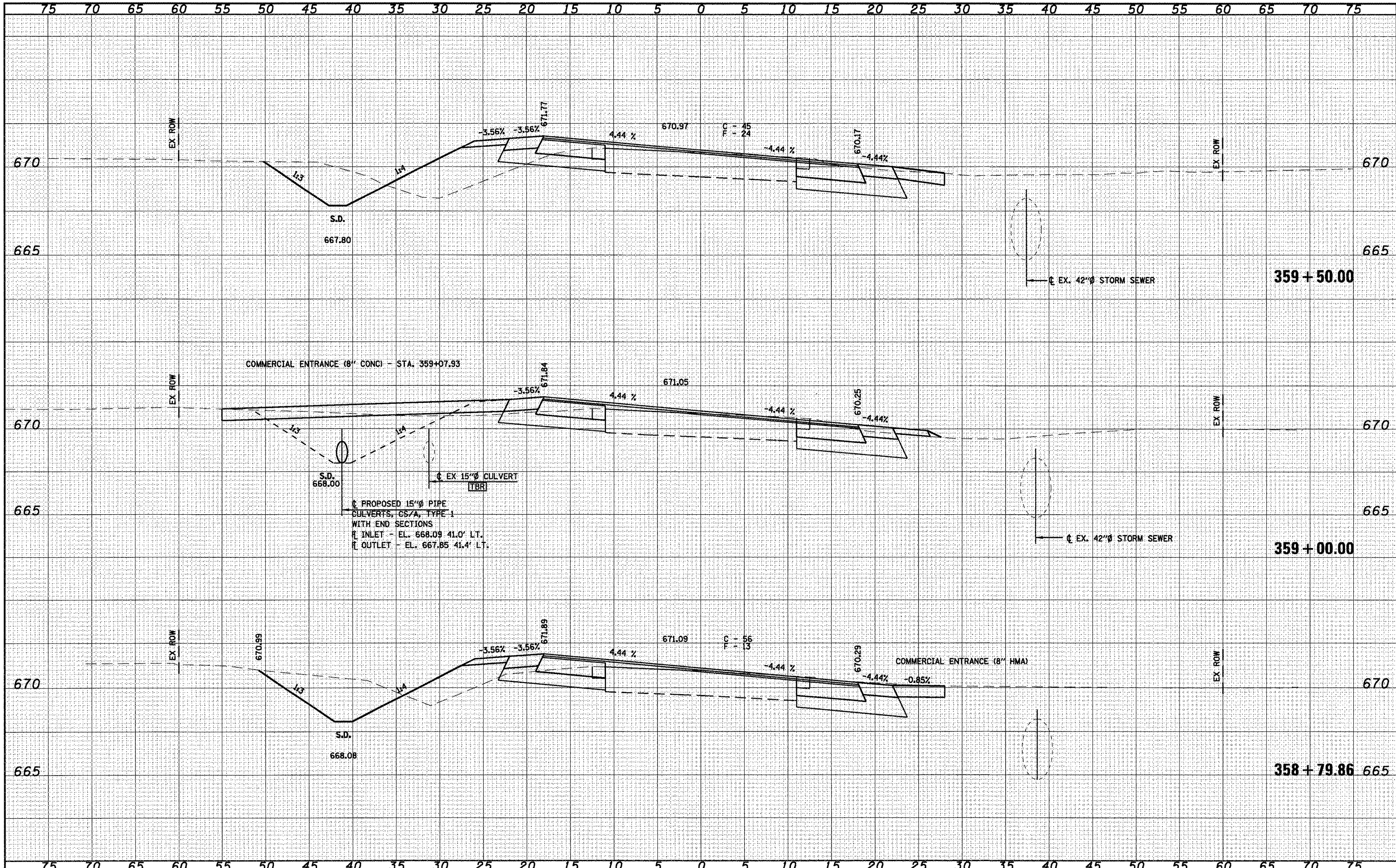

PROPOSED 15" PIPE  
 CULVERTS, CS/A, TYPE 1  
 WITH END SECTIONS  
 INLET - EL. 668.09 41.0' LT.  
 OUTLET - EL. 667.85 41.4' LT.

FILE NAME	
USER NAME	medonievj
DESIGNED	-
DRAWN	-
CHECKED	-
DATE	-

REVISIONS	
NO.	DESCRIPTION
1	
2	
3	
4	

DESIGNED	-
DRAWN	-
CHECKED	-
DATE	-



**Allen Henderson & Associates, Inc.**  
 Civil and Structural Engineers Springfield, IL  
 62703 Phone: (217)544-8033 IL Design Firm  
 No. 184-001907

SCALE	
SHEET NO.	5 OF 19 SHEETS
STA.	358+79.86 TO STA. 359+50.00

F.A.P. RTE.	SECTION	COUNTY	TOTAL SHEETS	SHEET NO.
662	DIW-3,RS-1,CRJ	MACOUPIN	102	77
CONTRACT NO.			72765	
FED. ROAD DIST. NO. ILLINOIS FED. AID PROJECT				

S:\PROJ ENGR 1\logonca-d\Dist Squad\FAP 662 (L 4)Henderson pdfs\CADD Sheets\0672765-sh1-xeol.dgn