

SEE REMOVAL PLAN SHEETS FOR ADDITIONAL INFORMATION

EXIST. CURVE 604  
 PI STA. = 23+26.30  
 $\Delta = 23^\circ 56' 04''$  (LT)  
 $D = 12^\circ 00' 33''$   
 $R = 477.09'$   
 $T = 101.12'$   
 $L = 199.30'$   
 $E = 10.60'$   
 $PR e = 2.0\%$   
 $PR T.R. = 31.0'$   
 $PR S.E. RUN = 25.0'$   
 $P.C. STA. = 22+25.18$   
 $P.T. STA. = 24+24.48$

NE 1/4, SEC 17, T1S, R3W, 4th PM

NW 1/4, SEC 16, T1S, R3W, 4th PM

MT STERLING IMPLEMENT COMPANY  
 6167105 TE-1, TE-2, TE-3

DATE	
BY	
REVIEWED	
PLANNED	
NOTE BOOK NO.	
CHECKED	
CADD FILE NAME	

DATE	
BY	
REVIEWED	
PLANNED	
NOTE BOOK NO.	
CHECKED	
CADD FILE NAME	

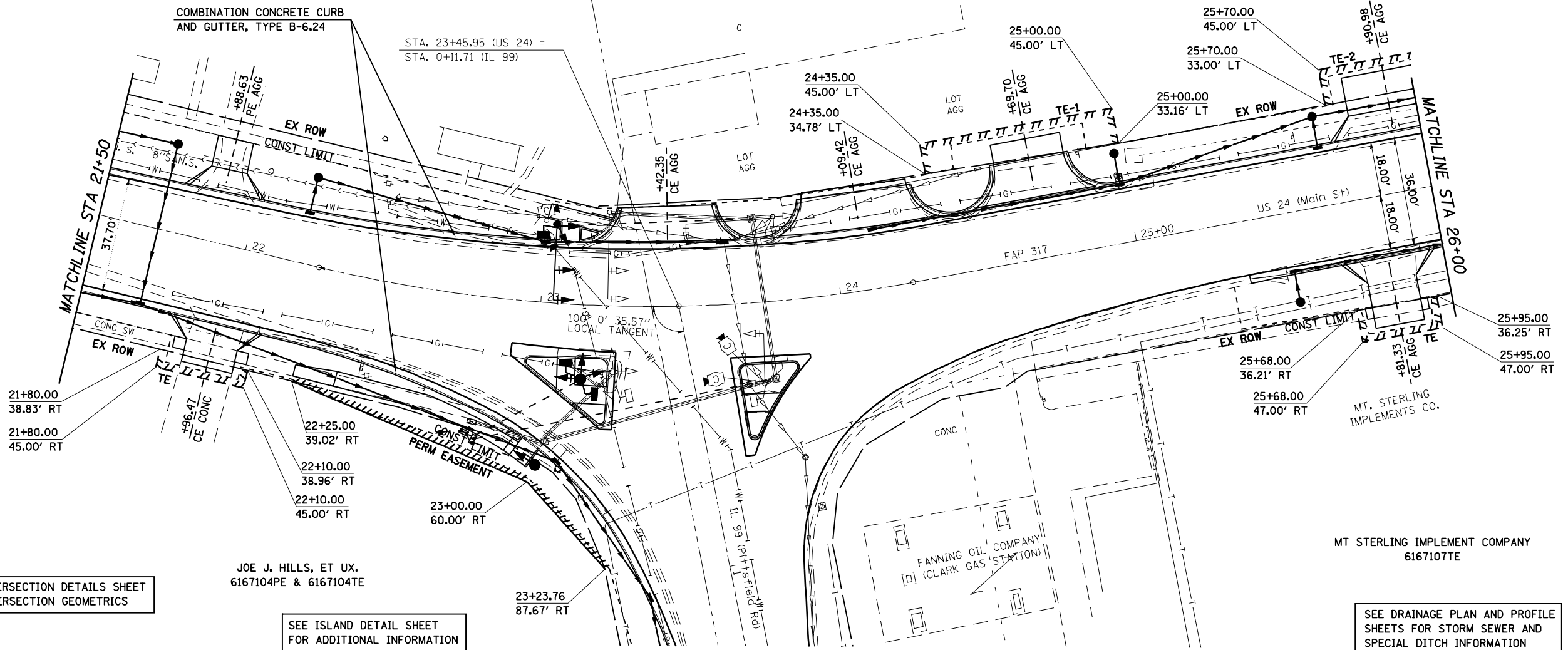

SEE INTERSECTION DETAILS SHEET FOR INTERSECTION GEOMETRICS

SEE ISLAND DETAIL SHEET FOR ADDITIONAL INFORMATION

SEE DRAINAGE PLAN AND PROFILE SHEETS FOR STORM SEWER AND SPECIAL DITCH INFORMATION

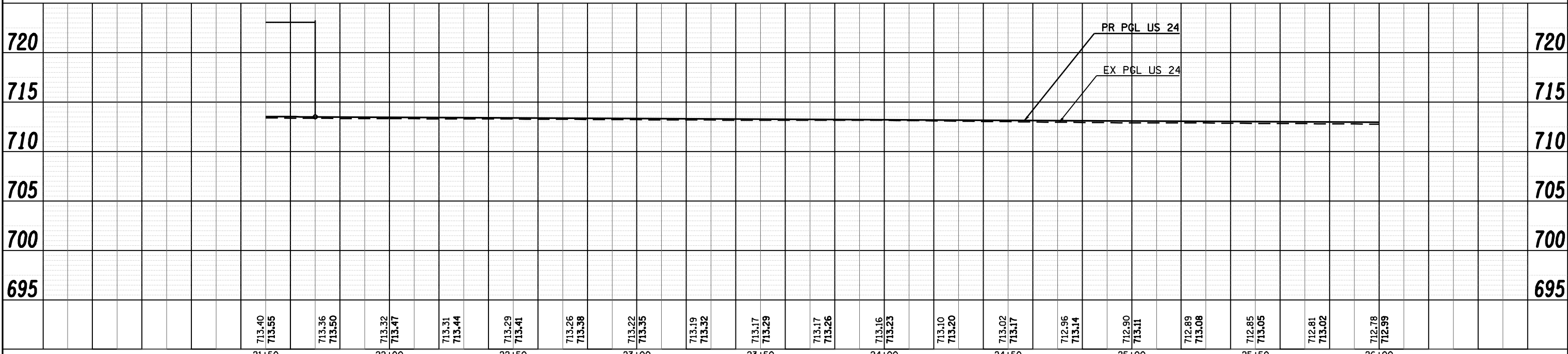

FILE NAME =	USER NAME = laughlinr1	DESIGNED -	REVISIONS -	<b>STATE OF ILLINOIS DEPARTMENT OF TRANSPORTATION</b>	<b>PLAN AND PROFILE SHEET</b>	F.A.P. RTE.	SECTION	COUNTY	TOTAL SHEETS	SHEET NO.
ct:\pwork\PWIDOT\LAUGHLINR1\dms20175\d672b60-shr-plnprf.dgn		DRAWN -	REVISIONS -			7(W-1,RS-8,JI) 9RS-4	BROWN	177	56	
PLOT SCALE = 40.0000' / IN.		CHECKED -	REVISIONS -			CONTRACT NO. 72B60				
PLOT DATE = Oct-07-2009 09:12:01AM		DATE -	REVISIONS -			FED. ROAD DIST. NO.	ILLINOIS FED. AID PROJECT			

\* FAP 317 (15 24) & 550 (11 99)