

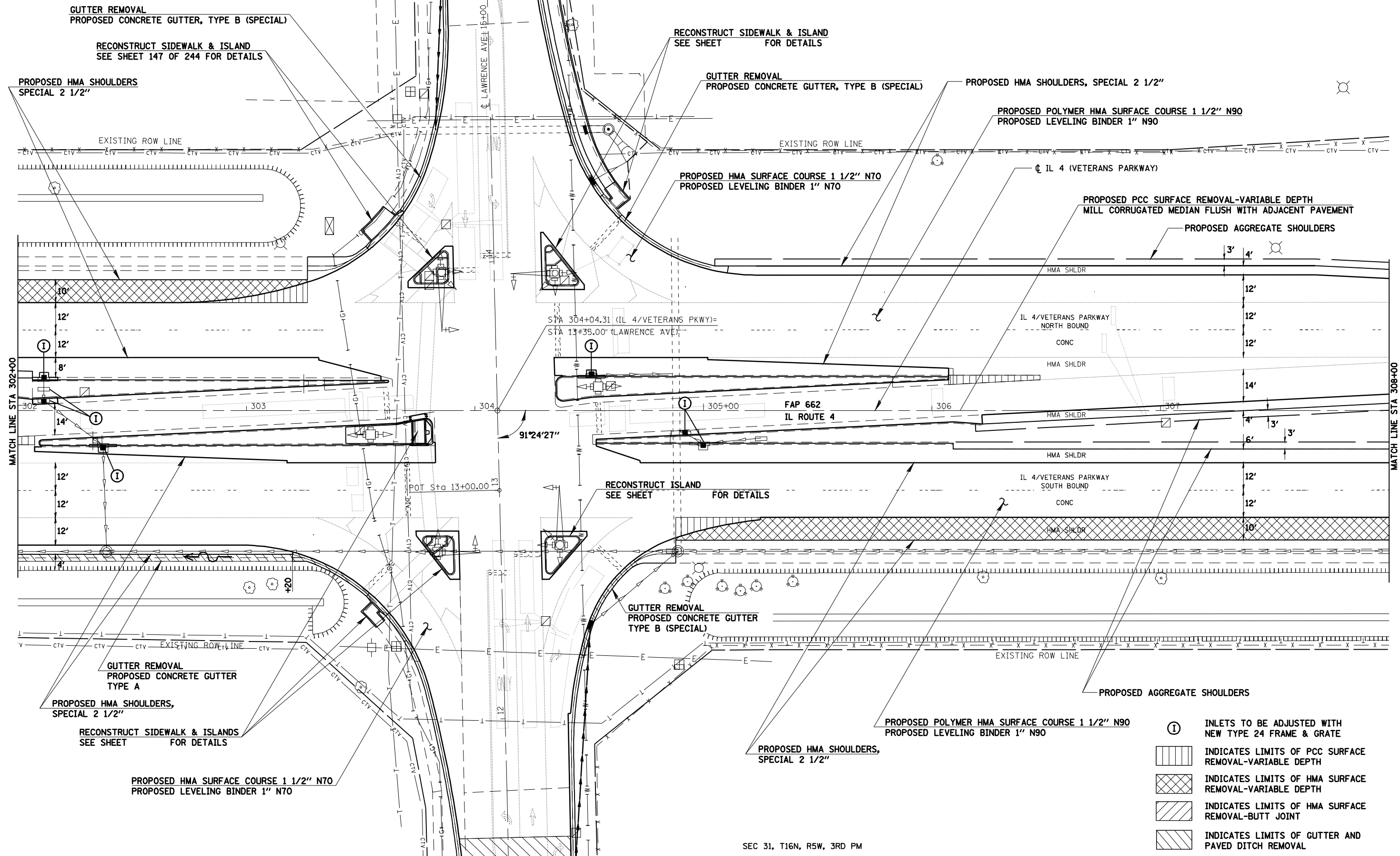

SEC 31, T16N, R5W, 3RD PM

CONSTRUCT CONCRETE GUTTER, TYPE B (SPECIAL)
TO MATCH PROPOSED RESURFACING



MATCH LINE STA 302+00

MATCH LINE STA 308+00

- ① INLETS TO BE ADJUSTED WITH NEW TYPE 24 FRAME & GRATE
- [Hatched Box] INDICATES LIMITS OF PCC SURFACE REMOVAL-VARIABLE DEPTH
- [Cross-hatched Box] INDICATES LIMITS OF HMA SURFACE REMOVAL-VARIABLE DEPTH
- [Diagonal Hatched Box] INDICATES LIMITS OF HMA SURFACE REMOVAL-BUTT JOINT
- [Diagonal Hatched Box] INDICATES LIMITS OF GUTTER AND PAVED DITCH REMOVAL



JOB = 2200.4
 FILE NAME = d672B99-sht-plan1.dgn
 PLOT SCALE = 48,0000 "/> IN.
 PLOT DATE = Oct-29-2009 11:38:16AM

DESIGNED - NAK
 DRAWN - AJH
 CHECKED - NAK
 DATE - 10/15/2009

REVISED -
 REVISED -
 REVISED -
 REVISED -

STATE OF ILLINOIS
 DEPARTMENT OF TRANSPORTATION

SCALE: SHEET NO. OF SHEETS STA. TO STA.

IL 4 (VETERANS PARKWAY)

| F.A.S. RTE. | SECTION | COUNTY | TOTAL SHEETS | SHEET NO. |
|---|-----------------------|----------|--------------|-----------|
| 662 | (2-1-2, 2-2) RS, TS-6 | SANGAMON | 244 | 64 |
| CONTRACT NO. 72B99 | | | | |
| FED. ROAD DIST. NO. [ILLINOIS] FED. AID PROJECT | | | | |