

SEC 31, T16N, R5W, 3RD PM

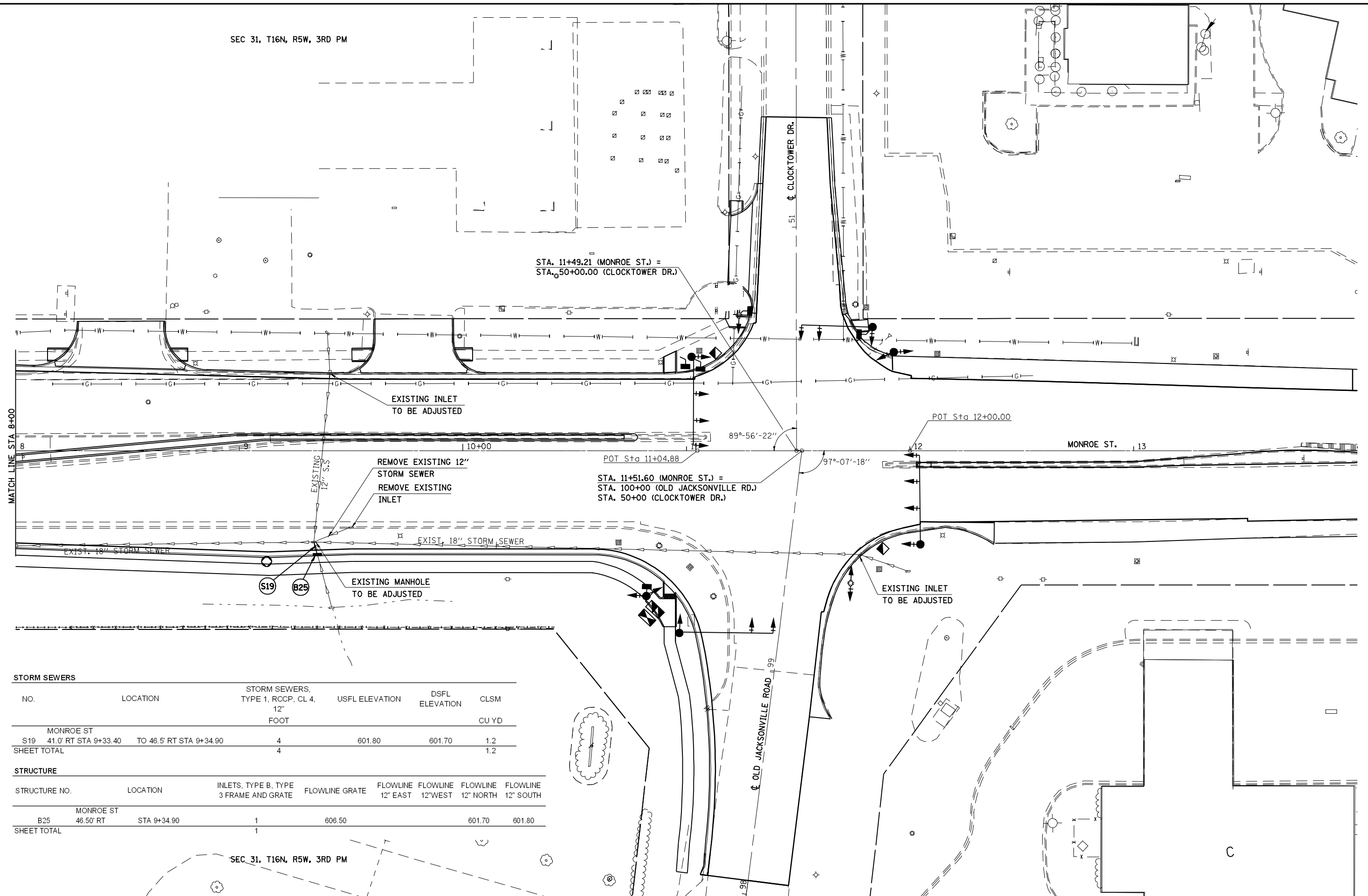

STORM SEWERS

| NO. | LOCATION | STORM SEWERS, TYPE 1, RCCP, CL 4, 12" FOOT | USFL ELEVATION | DSFL ELEVATION | CLSM CU YD |
|-------------|---|---|----------------|-------------------|---------------|
| S19 | MONROE ST 41.0' RT STA 9+33.40 TO 46.5' RT STA 9+34.90 | 4 | 601.80 | 601.70 | 1.2 |
| SHEET TOTAL | | 4 | | | 1.2 |

STRUCTURE

| STRUCTURE NO. | LOCATION | INLETS, TYPE B, TYPE 3 FRAME AND GRATE | FLOWLINE GRATE | FLOWLINE 12" EAST | FLOWLINE 12" WEST | FLOWLINE 12" NORTH | FLOWLINE 12" SOUTH |
|---------------|------------------------------------|---|----------------|----------------------|----------------------|-----------------------|-----------------------|
| B25 | MONROE ST 46.50' RT STA 9+34.90 | 1 | 606.50 | | | 601.70 | 601.80 |
| SHEET TOTAL | | 1 | | | | | |

SEC 31, T16N, R5W, 3RD PM



JOB = 2200.4
 FILE NAME = *FILES*
 PLOT SCALE = *SCALE*
 PLOT DATE = *DATE*

DESIGNED - NAK
 DRAWN - AJH
 CHECKED - NAK
 DATE - 10/15/2009

REVISED -
 REVISED -
 REVISED -
 REVISED -

**STATE OF ILLINOIS
 DEPARTMENT OF TRANSPORTATION**

MONROE ST - DRAINAGE

SCALE: SHEET NO. OF SHEETS STA. TO STA.

| F.A.S. RTE. | SECTION | COUNTY | TOTAL SHEETS | SHEET NO. |
|---|-----------------------|----------|-----------------|--------------|
| 662 | (2-1-2, 2-2) RS, TS-6 | SANGAMON | 244 | 109 |
| CONTRACT NO. 72B99 | | | | |
| FED. ROAD DIST. NO. [ILLINOIS] FED. AID PROJECT | | | | |