

**TRAFFIC SIGNAL QUANTITIES**

LOCATION: VETERANS & WASHINGTON

| QUANTITY | UNIT | ITEM  |
|----------|------|---|
| 1        | EACH | MAINTENANCE OF EXISTING TRAFFIC SIGNAL INSTALLATION   |
| 771.0    | FOOT | ELECTRIC CABLE IN CONDUIT, COMMUNICATION, NO. 18, 3/C |
| 771.0    | FOOT | REMOVE ELECTRIC CABLE FROM CONDUIT                    |
| 1        | EACH | REMOVE EXISTING TRAFFIC SIGNAL EQUIPMENT              |
| 1        | EACH | VIDEO VEHICLE DETECTION SYSTEM                        |
| 499.0    | FOOT | ELECTRIC CABLE IN CONDUIT, GROUND, #6 1/C (GREEN)     |
| 6        | EACH | REBUILD EXISTING HANDHOLE                             |

REMOVE ELECTRIC CABLE FROM CONDUIT SHALL CONSIST OF REMOVING ALL EXISTING COAXIAL CABLES TO THE EXISTING VIDEO VEHICLE DETECTORS

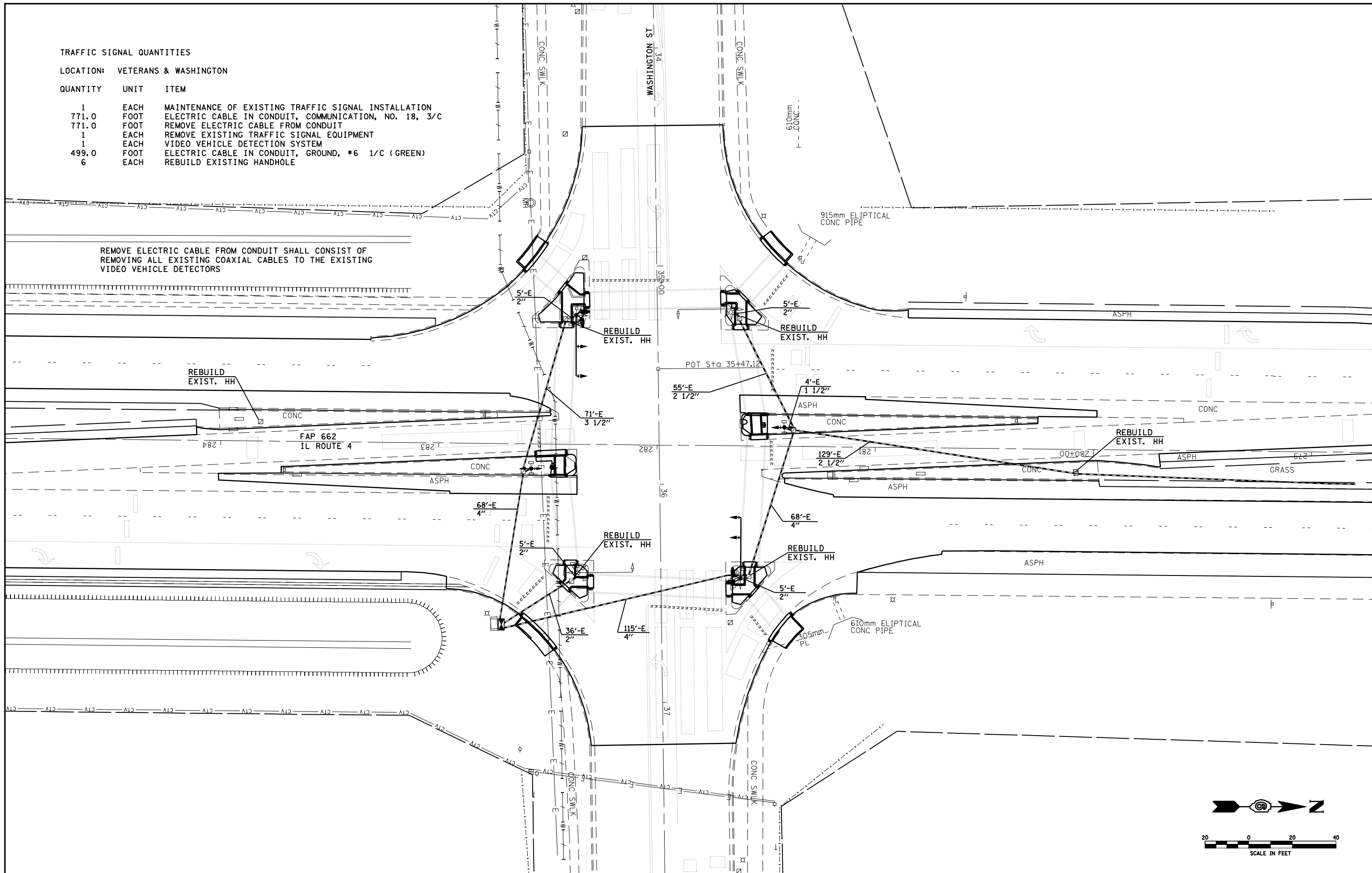

|  |                                    |            |           |   |  |           |           |             |                    |                     |                           |           |
|--|------------------------------------|------------|-----------|---|--|-----------|-----------|-------------|--------------------|---------------------|---------------------------|-----------|
| FILE NAME =  | USER NAME = laughlinr1             | DESIGNED - | REVISED - | <b>STATE OF ILLINOIS<br/>DEPARTMENT OF TRANSPORTATION</b> | <b>TRAFFIC SIGNALS - WASHINGTON ST</b> |           |           | F.A.P. RTE. | SECTION            | COUNTY              | TOTAL SHEETS              | SHEET NO. |
| et:\pw\work\PWIDOT\LAUGHLINRL\0170829\0672899-TS.dgn |                                    | DRAWN -    | REVISED - |   |  |           |           | 662         | (2-1-2,2-2)RS,TS-6 | SANGAMON            | 244                       | 171       |
|  | PLOT SCALE = 40.0000' / IN.        | CHECKED -  | REVISED - |   | CONTRACT NO. 72B99                     |           |           |             |                    |                     |                           |           |
|  | PLOT DATE = Oct-29-2009 11:56:13AM | DATE -     | REVISED - |   | SCALE:                                 | SHEET NO. | OF SHEETS | STA.        | TO STA.            | FED. ROAD DIST. NO. | ILLINOIS FED. AID PROJECT |           |