

**TRAFFIC SIGNAL QUANTITIES**

LOCATION: VETERANS & LAWRENCE

QUANTITY	UNIT	ITEM
1	EACH	MAINTENANCE OF EXISTING TRAFFIC SIGNAL INSTALLATION
831.0	FOOT	ELECTRIC CABLE IN CONDUIT, COMMUNICATION, NO. 18, 3/C
1	EACH	REMOVE EXISTING TRAFFIC SIGNAL EQUIPMENT
1	EACH	VIDEO VEHICLE DETECTION SYSTEM
2	EACH	CAMERA MOUNTING ASSEMBLY
433.0	FOOT	ELECTRIC CABLE IN CONDUIT, GROUND, #6 1/C (GREEN)
5	EACH	REBUILD EXISTING HANDHOLE

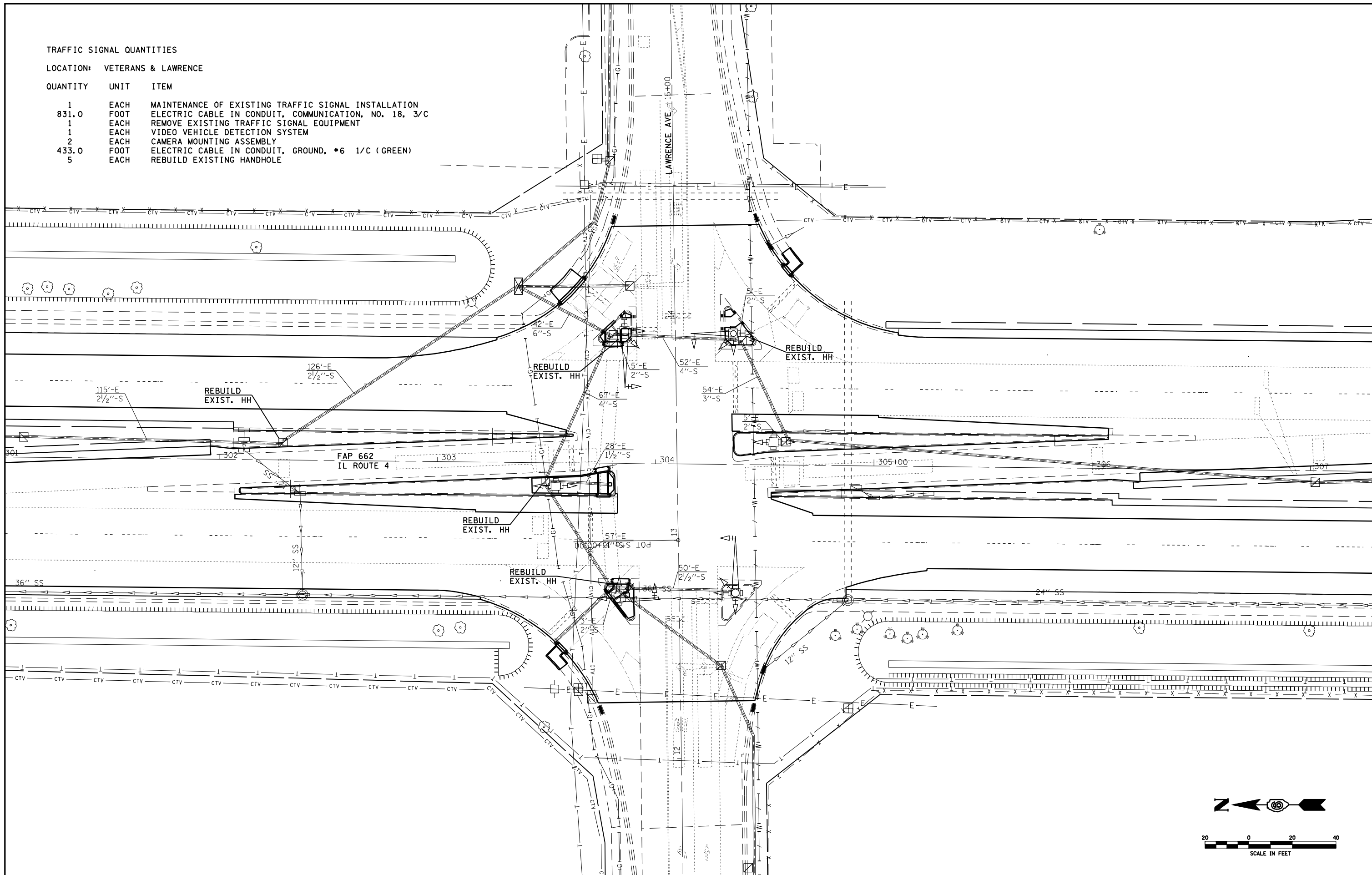

FILE NAME =	USER NAME = laughlinr1	DESIGNED -	REVISED -
et:\pwork\pwidot\LAUGHLINRL\0170829\0672899-TS.dgn		DRAWN -	REVISED -
	PLOT SCALE = 40.0000' / IN.	CHECKED -	REVISED -
	PLOT DATE = Oct-29-2009 11:56:40AM	DATE -	REVISED -

**STATE OF ILLINOIS  
DEPARTMENT OF TRANSPORTATION**

<b>TRAFFIC SIGNALS - LAWRENCE AVE</b>				
SCALE:	SHEET NO.	OF SHEETS	STA.	TO STA.

F.A.P. RTE.	SECTION	COUNTY	TOTAL SHEETS	SHEET NO.
662	(2-1-2,2-2)RS,TS-6	SANGAMON	244	174
FED. ROAD DIST. NO.			ILLINOIS FED. AID PROJECT	
			CONTRACT NO. 72B99	