

DATE	
BY	
FINAL SURVEY	
SURVEYED	
PLOTTED	
TEMPLATE	
NOTE BOOK	
AREAS CHECKED	
NO.	

DATE	
BY	
ORIGINAL SURVEY	
SURVEYED	
PLOTTED	
TEMPLATE	
NOTE BOOK	
AREAS CHECKED	
NO.	

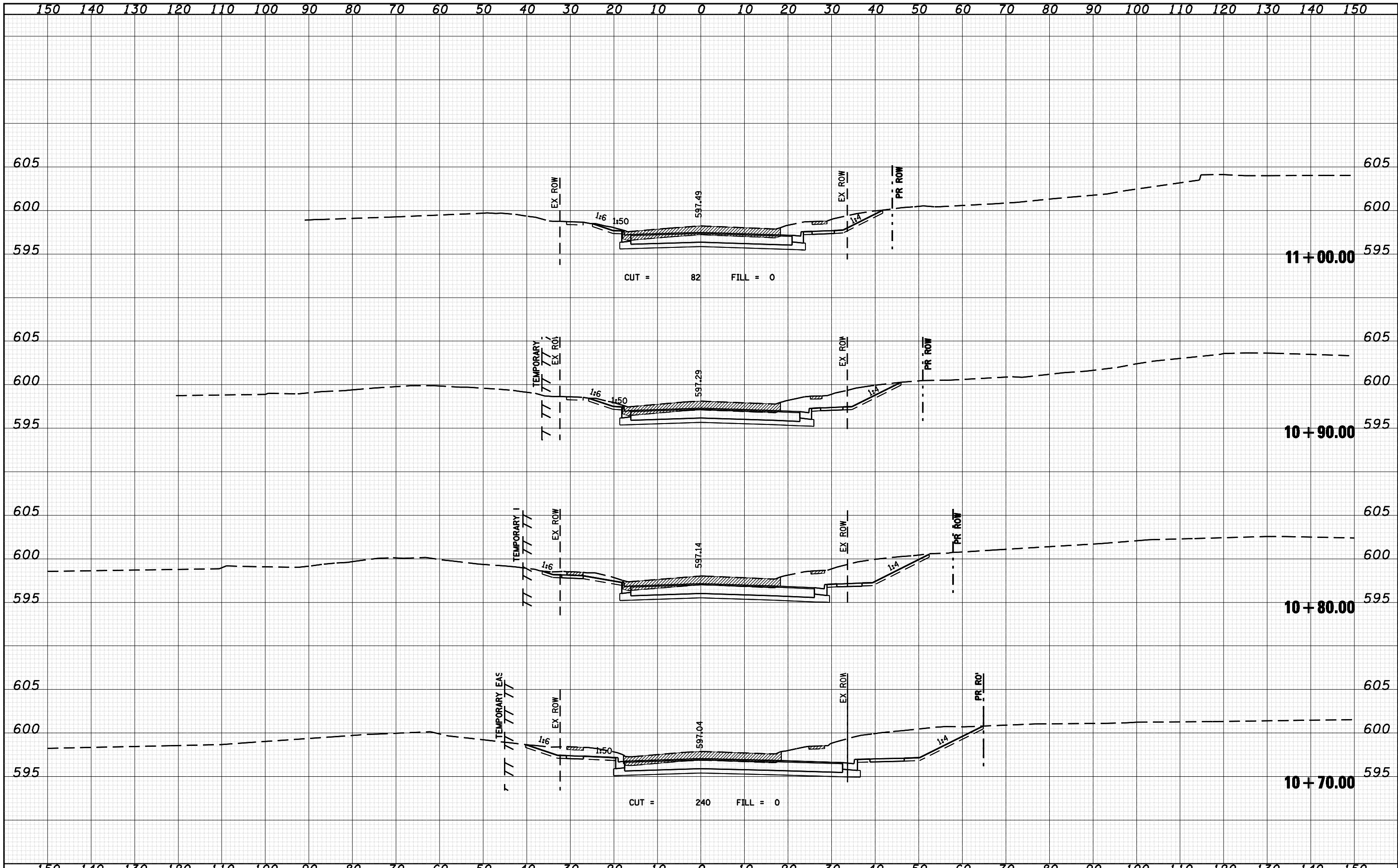

CEC Cummins Engineering Corporation
Civil and Structural Engineering

JOB = 2200.4	DESIGNED - NAK	REVISIED -
FILE NAME = D672899-xshht-s111.dgn	DRAWN - A.J.H	REVISIED -
PLOT SCALE = 20.0000' / IN.	CHECKED -	REVISIED -
PLOT DATE = Oct-29-2009 12:00:13PM	DATE - 10/09/2009	REVISIED -

**STATE OF ILLINOIS
DEPARTMENT OF TRANSPORTATION**

CROSS SECTIONS - RICKARD RD			
SCALE:	SHEET NO.	OF SHEETS	STA 10+70.00 TO STA 11+00.00

F.A.P. RTE.	SECTION	COUNTY	TOTAL SHEETS	SHEET NO.
662	(2-1-2, 2-2) RS, T-6	SANGAMON	244	237
CONTRACT NO. 72899				