

STATE OF ILLINOIS  
DEPARTMENT OF TRANSPORTATION  
DIVISION OF HIGHWAYS

**PROPOSED  
HIGHWAY PLANS**

FAI 55 (I-55)  
SECTION 84-1-2 RS-4; 150RS-1  
PROJECT: ACIM-055-4(170)106  
HMA RESURFACING  
SANGAMON COUNTY

F.A.I. RTE.	SECTION	COUNTY	TOTAL SHEETS	SHEET NO.
I-55	84-1-2RS4;150RS1	SANGAMON	65	1
		ILLINOIS	CONTRACT NO. 72C38	

FOR INDEX OF SHEETS, SEE SHEET NO. 2

D-96-015-09

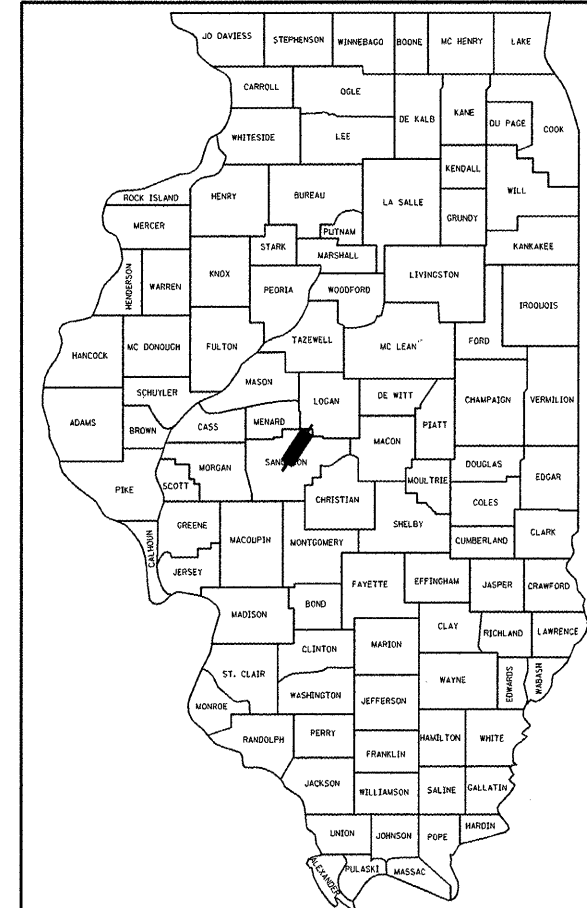

LOCATION OF SECTION INDICATED THIS: -

STATE OF ILLINOIS  
DEPARTMENT OF TRANSPORTATION  
DIVISION OF HIGHWAYS

SUBMITTED October 28, 2009  
*Reg Z Drubka*  
DEPUTY DIRECTOR OF HIGHWAYS, REGION ENGINEER

December 4, 2009  
*Charles J. Ingersoll*  
ENGINEER OF DESIGN AND ENVIRONMENT

December 4, 2009  
*Christine M. Reed*  
DIRECTOR OF HIGHWAYS, CHIEF ENGINEER

**PRINTED BY THE AUTHORITY  
OF THE STATE OF ILLINOIS**

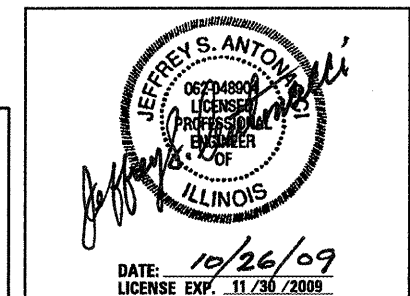

**HE**  
**HOELSCHER ENGINEERING**  
11 Executive Drive Suite 12  
Fairview Heights, Illinois 62208  
(618) 624-0610  
(618) 624-0611 (fax)  
2501 Chatham Road, Suite 120  
Springfield, Illinois 62704  
(217) 698-8610  
(217) 698-8608 (fax)  
115 North Neil Street, Suite 105  
Champaign, Illinois 61820  
(217) 351-8610  
(217) 351-8611 (fax)

C-96-015-09

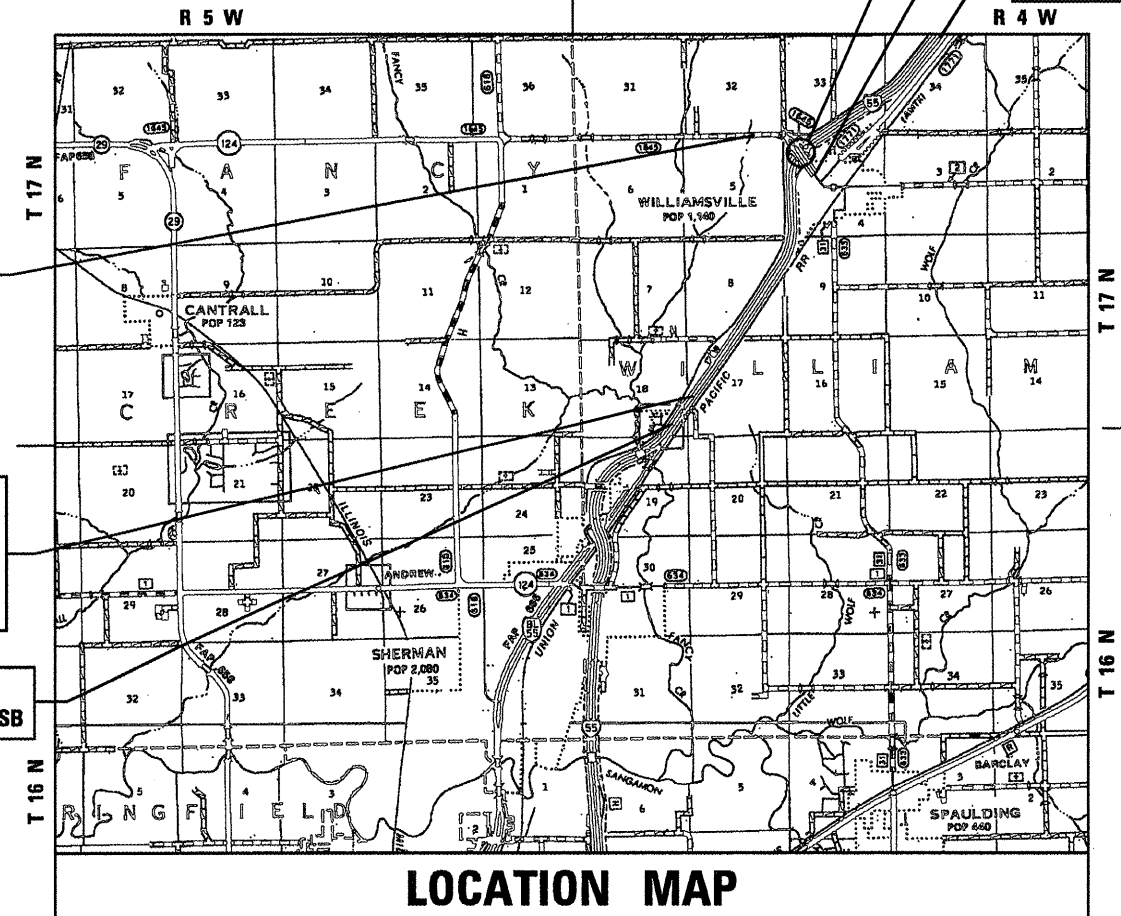

**LOCATION MAP**

BEGIN IMPROVEMENT FAS 1645  
(IL 123/DINIUS RD)  
STA. 18 + 98.00

STATION EQUATION  
STA. 250 + 00.00  
(BK INCREASING TO SOUTH) =  
STA. 176 + 84.49  
(AH INCREASING TO NORTH)

BEGIN IMPROVEMENT  
I-55 STA. 285 + 00.00 SB

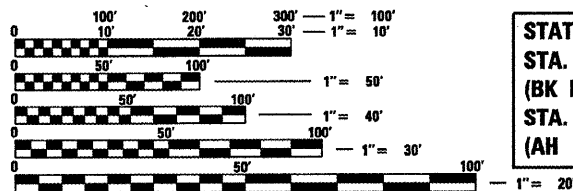

FULL SIZE PLANS HAVE BEEN PREPARED USING STANDARD ENGINEERING SCALES. REDUCED SIZED PLANS WILL NOT CONFORM TO STANDARD SCALES. IN MAKING MEASUREMENTS ON REDUCED PLANS, THE ABOVE SCALES MAY BE USED.

J.U.L.I.E.  
JOINT UTILITY LOCATION INFORMATION FOR EXCAVATION  
1-800-892-0123  
OR 811

PROJECT ENGINEER: JOHN NEGANGARD (217) 782-6990  
PROJECT MANAGER: VINCE MADONIA (217) 785-9046

CONTRACT NO. 72C38

FAI 55  
FUNCTION CLASS = INTERSTATE  
A.D.T. (2009) 32,800  
SU (2009) 1,980  
MU (2009) 7,160  
PV (2009) 23,660

FAS 1645 (IL 123)  
FUNCTION CLASS = NON-URBAN MAJOR COLLECTOR  
A.D.T. (209) 5,200

NET LENGTH OF FAI 55 = 27,346.37 FT = 5.179 MILES  
NET LENGTH OF FAS 1645 (IL 123/DINIUS RD) = 4,498.33 FT = 0.852 MILES  
TOTAL LENGTH OF PROJECT = 31,844.70 FT = 6.031 MILES