

LEGEND	QUANTITY
	THIS SHEET ONLY
① PREFORMED PLASTIC PAVEMENT MARKING, TYPE B, INLAID - LINE 5" (WHITE)	104'
② PREFORMED PLASTIC PAVEMENT MARKING, TYPE B, INLAID - LINE 6" (WHITE)	367'
③ PREFORMED PLASTIC PAVEMENT MARKING, TYPE B, INLAID - LINE 6" (WHITE), 6' SKIP-2' DASH	22'
④ PREFORMED PLASTIC PAVEMENT MARKING, TYPE B, INLAID - LINE 24" (WHITE)	31.0
⑤ PREFORMED PLASTIC PAVEMENT MARKING, TYPE B, INLAID - LETTERS & SYMBOLS (WHITE)	93.6 S. F.
⑥ THERMOPLASTIC PAVEMENT MARKING - LINE 5" (YELLOW)	257'
⑦ THERMOPLASTIC PAVEMENT MARKING - LINE 5" (YELLOW), LINES AT 13" CENTERS	610'
⑧ THERMOPLASTIC PAVEMENT MARKING - LINE 6" (WHITE)	267'
⑨ THERMOPLASTIC PAVEMENT MARKING - LINE 8" (WHITE)	56'
⑩ THERMOPLASTIC PAVEMENT MARKING - LINE 12" (WHITE)	67'
▷ RAISED REFLECTIVE PAVEMENT MARKER (ONE-WAY CRYSTAL)	26 EACH
◆ RAISED REFLECTIVE PAVEMENT MARKER (TWO-WAY AMBER)	30 EACH

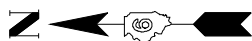

EXIST. CURVE95  
 PI STA. =11+12.34  
 $\Delta$  =4° 55' 54" (LT)  
 D =9° 50' 15"  
 R =582.42'  
 T =25.08'  
 L =50.13'  
 E =0.54'  
 e = ----  
 T.R. = ----  
 S.E. RUN = ----  
 P.C. STA. =10+87.25  
 P.T. STA. =11+37.39

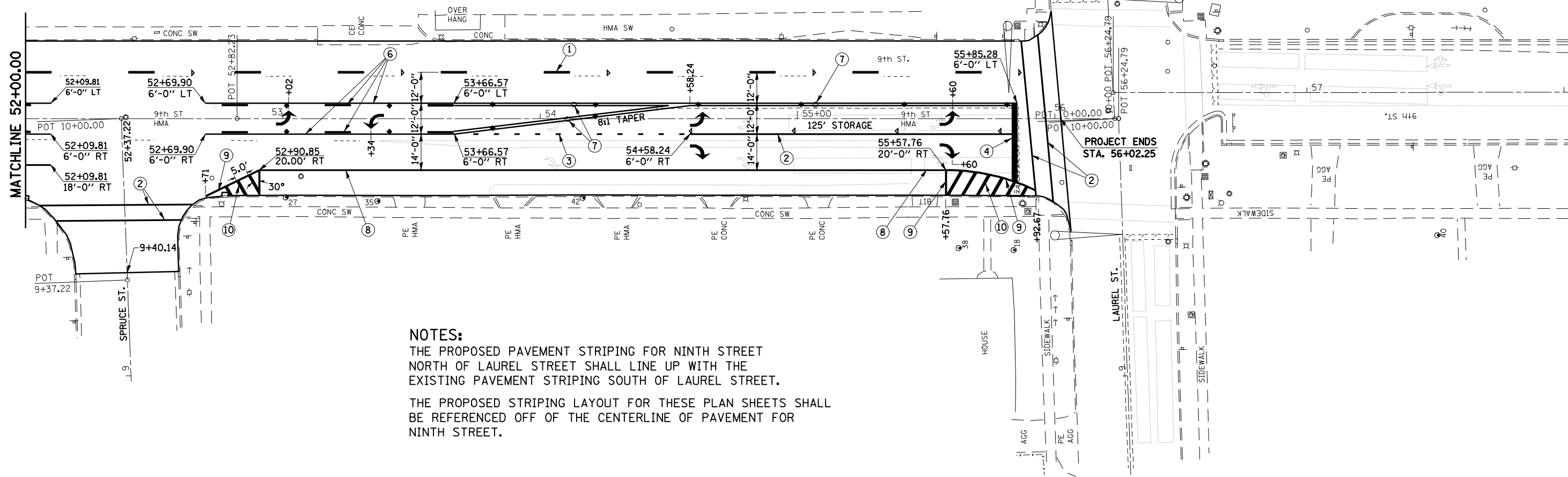

**NOTES:**  
 THE PROPOSED PAVEMENT STRIPING FOR NINTH STREET NORTH OF LAUREL STREET SHALL LINE UP WITH THE EXISTING PAVEMENT STRIPING SOUTH OF LAUREL STREET.  
 THE PROPOSED STRIPING LAYOUT FOR THESE PLAN SHEETS SHALL BE REFERENCED OFF OF THE CENTERLINE OF PAVEMENT FOR NINTH STREET.