

EXIST. CURVE 11
 PI STA. = 948+37.55
 Δ = 35° 56' 57" (RT)
 D = 4° 38' 53"
 R = 1,232.69'
 T = 399.92'
 L = 773.43'
 E = 63.25'
 e = -----
 T.R. = -----
 S.E. RUN = -----
 P.C. STA. = 944+37.62
 P.T. STA. = 952+11.05
 S.E. = 0.08
 S.E. TRANSITION
 STA. 943+21.63 - 944+95.63
 STA. 951+53.05 - 953+27.05

STA. 943+37.62
 BEGIN IMPROVEMENT
 POT Sta 943+00.00
 EQUATION:
 STA 942+91.74 BK =
 STA 943+00.00 AH

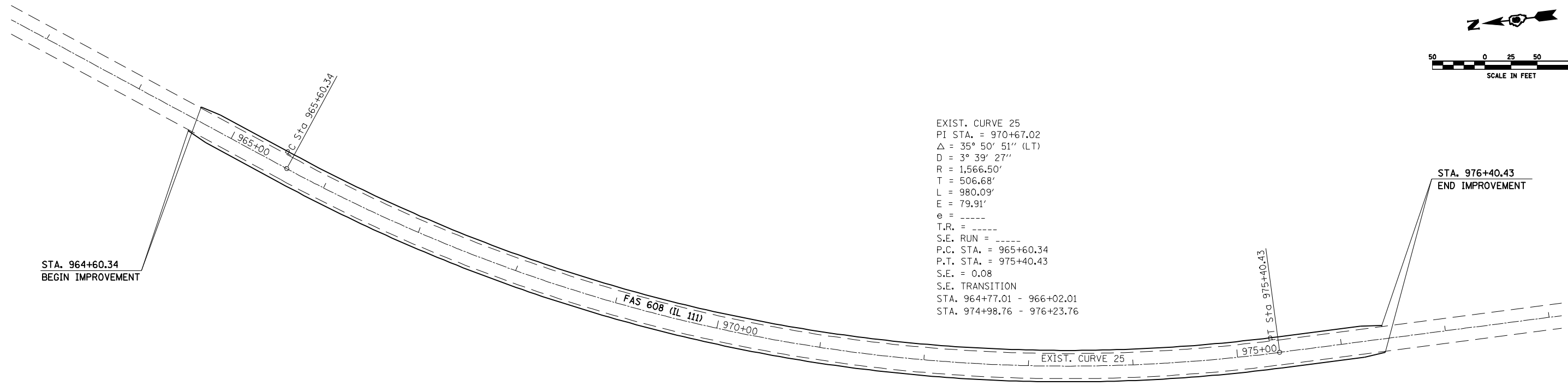
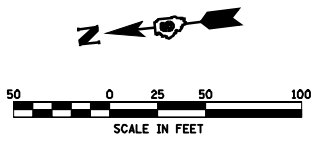

EXIST. CURVE 25
 PI STA. = 970+67.02
 Δ = 35° 50' 51" (LT)
 D = 3° 39' 27"
 R = 1,566.50'
 T = 506.68'
 L = 980.09'
 E = 79.91'
 e = -----
 T.R. = -----
 S.E. RUN = -----
 P.C. STA. = 965+60.34
 P.T. STA. = 975+40.43
 S.E. = 0.08
 S.E. TRANSITION
 STA. 964+77.01 - 966+02.01
 STA. 974+98.76 - 976+23.76

STA. 964+60.34
 BEGIN IMPROVEMENT

STA. 976+40.43
 END IMPROVEMENT

FILE NAME =	USER NAME = laughlinr1	DESIGNED -	REVISED -	STATE OF ILLINOIS DEPARTMENT OF TRANSPORTATION	FAS 608 (IL 111) PLAN SHEET				F.A.S. RTE.	SECTION	COUNTY	TOTAL SHEETS	SHEET NO.
es:\pwwork\pwwid\LAUGHLINRL\0136657\0672C97-SHT-plan21.dgn		DRAWN -	REVISED -		608	122, 125, 126, INT-SHLD	MACOUPIN	15	8				
PLOT SCALE = 100.0000' / IN.		CHECKED -	REVISED -		CONTRACT NO. 72C97				ILLINOIS FED. AID PROJECT				
PLOT DATE = Oct-13-2009 10:41:55AM		DATE -	REVISED -		SCALE:	SHEET NO.	OF SHEETS	STA.	TO STA.				