

EXIST. CURVE 324
 PI STA. = 1492+83.79
 $\Delta = 29^\circ 53' 04''$ (LT)
 $D = 2^\circ 59' 54''$
 $R = 1,910.92'$
 $T = 509.96'$
 $L = 996.70'$
 $E = 66.88'$
 $e = \text{-----}$
 $T.R. = \text{-----}$
 $S.E. \text{ RUN} = \text{-----}$
 P.C. STA. = 1487+73.83
 P.T. STA. = 1497+70.53
 $S.E. = 0.08$
 S.E. TRANSITION
 STA. 1486+83.83 - 1488+18.83
 STA. 1497+25.53 - 1498+60.53

STA. 1486+73.83
 BEGIN IMPROVEMENT

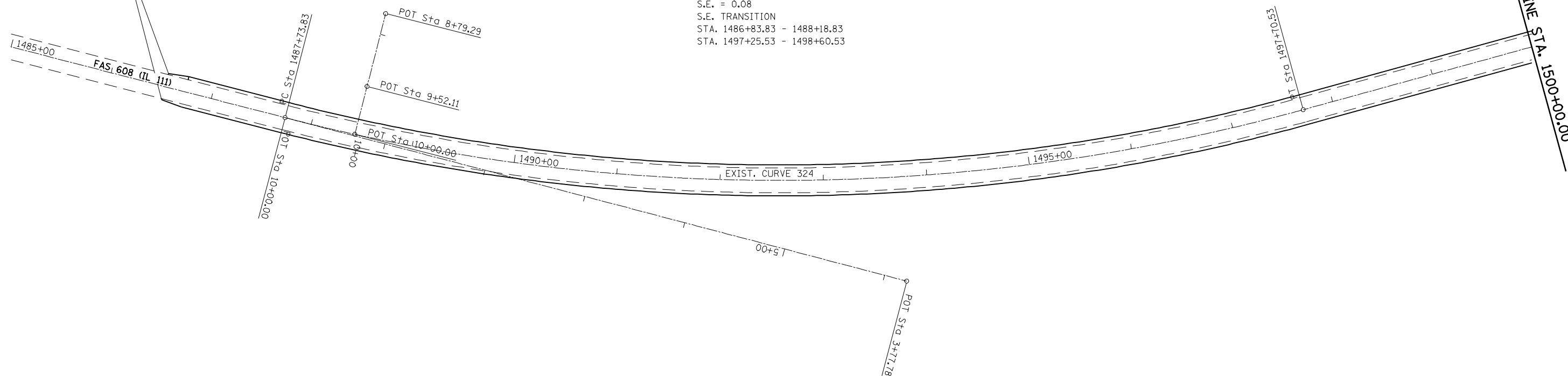

FILE NAME =	USER NAME = laughlinr1	DESIGNED -	REVISED -
e:\pwork\pwidot\LAUGHLINRL\0136657\072C97-SHT-plan1.dgn		DRAWN -	REVISED -
PLOT SCALE = 100.0000' / IN.		CHECKED -	REVISED -
PLOT DATE = Oct-13-2009 10:42:08AM		DATE -	REVISED -

**STATE OF ILLINOIS
 DEPARTMENT OF TRANSPORTATION**

FAS 608 (IL 111)

SCALE: SHEET NO. OF SHEETS STA. TO STA.

F.A.S. RTE.	SECTION	COUNTY	TOTAL SHEETS	SHEET NO.
608	*	MACOUPIN	15	12
ILLINOIS FED. AID PROJECT			CONTRACT NO. 72C97	