

6th at Hazel Dell Rd. in Springfield

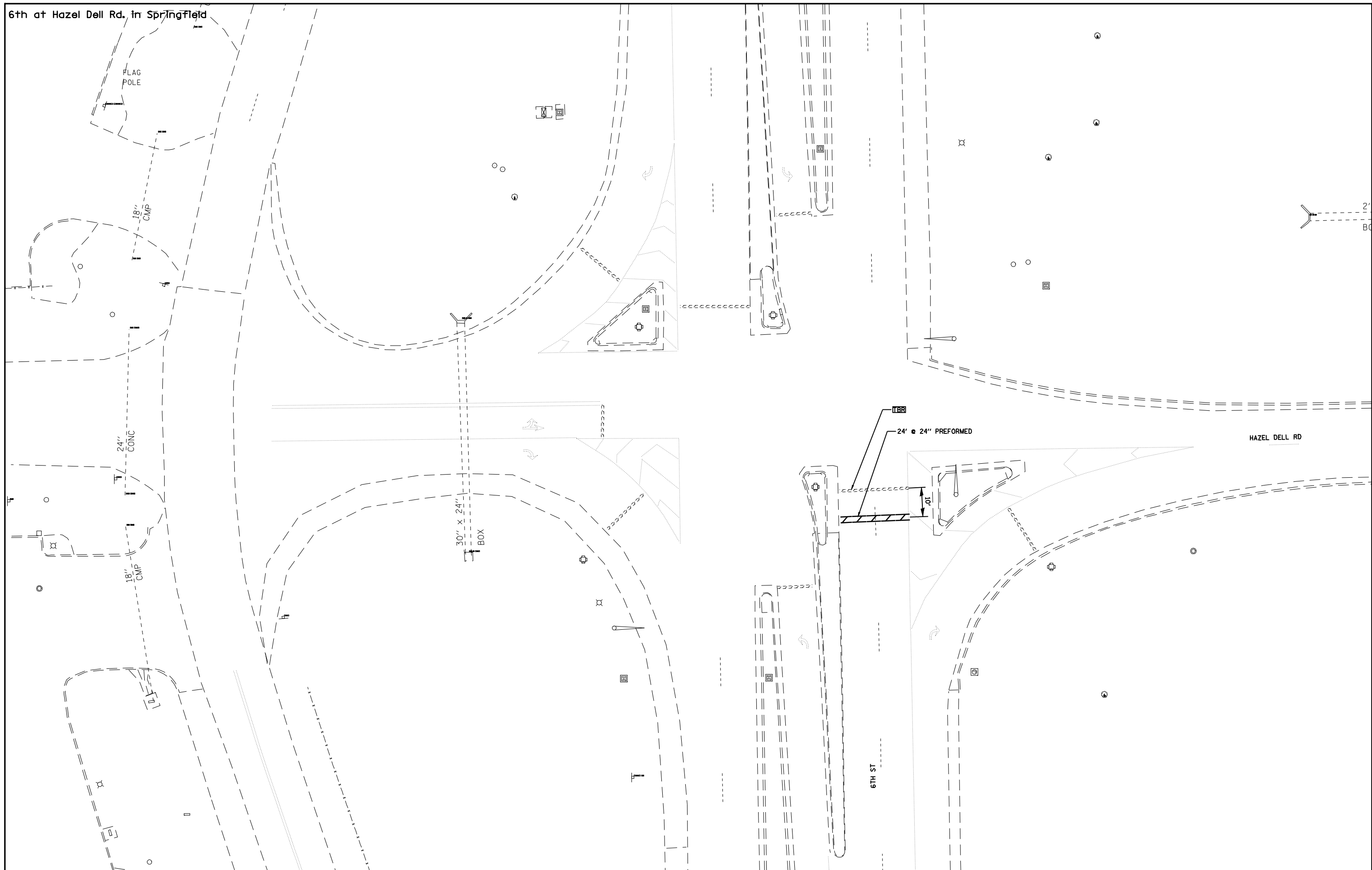

FILE NAME =
 USER NAME = laughlinr1
 PLOT SCALE = 30.0000' / IN.
 PLOT DATE = Oct-22-2009 09:22:12AM

DESIGNED -	REVISED -
DRAWN -	REVISED -
CHECKED -	REVISED -
DATE -	REVISED -

**STATE OF ILLINOIS
 DEPARTMENT OF TRANSPORTATION**

**PAVEMENT MARKING DETAILS
 SANGAMON COUNTY; LOCATION #13**

SCALE: SHEET NO. OF SHEETS STA. TO STA.

F.A. RTE.	SECTION	COUNTY	TOTAL SHEETS	SHEET NO.
VAR	D-6 PAVT MARKING 2010	VARIOUS	37	30
CONTRACT NO. 72C99			ILLINOIS FED. AID PROJECT	