

STAGE II PLAN

**SYMBOLS**

- ▲ TRAFFIC SIGNAL
- DRUM WITH STEADY BURNING LIGHT
- ▣ SAND MODULE IMPACT ATTENUATOR
- ▨ WORK AREA
- ▩ PAVED SHOULDER REMOVAL
- ▭ TEMPORARY CONCRETE BARRIER
- ▮ DOUBLE VERTICAL PANEL
- ⊥ TYPE III BARRICADE (WHEN NOT WORKING)
- ◇ DETECTOR LOOPS

**TRAFFIC CONTROL QUANTITIES (THIS SHEET)**

ITEM	UNIT	TOTAL
TRAFFIC CONTROL AND PROTECTION, STD 701321 (SPECIAL)	EACH	0.5
IMPACT ATTENUATORS, RELOCATE (NON-REDIRECTIVE), TEST LEVEL 3	EACH	2.0
RELOCATE TEMPORARY CONCRETE BARRIER	FOOT	612.5
TEMPORARY PAVEMENT MARKING - LINE 4"	FOOT	1,466.7
WORK ZONE PAVEMENT MARKING REMOVAL	SQ FT	488.4

- GENERAL NOTES**
1. THIS WORK SHALL SUPPLEMENT AND BE IN ACCORDANCE WITH TRAFFIC CONTROL STANDARD 701321.
  2. THE POSTED SPEED LIMIT THROUGH THE CONSTRUCTION SITE SHALL BE 40 MPH.
  3. TEMPORARY RUMBLE STRIPS SHALL NOT BE USED.
  4. THE COST OF DRUMS, BARRICADES, REFLECTORS, VERTICAL PANELS, SIGNING AND REMOVAL OF EXISTING PAVEMENT STRIPES WILL NOT BE PAID FOR SEPARATELY, AND SHALL BE INCLUDED IN THE COST OF TRAFFIC CONTROL AND PROTECTION, STANDARD 701321 (SPECIAL).
  5. ACCESS TO ENTRANCES SHALL BE MAINTAINED AT ALL TIMES.

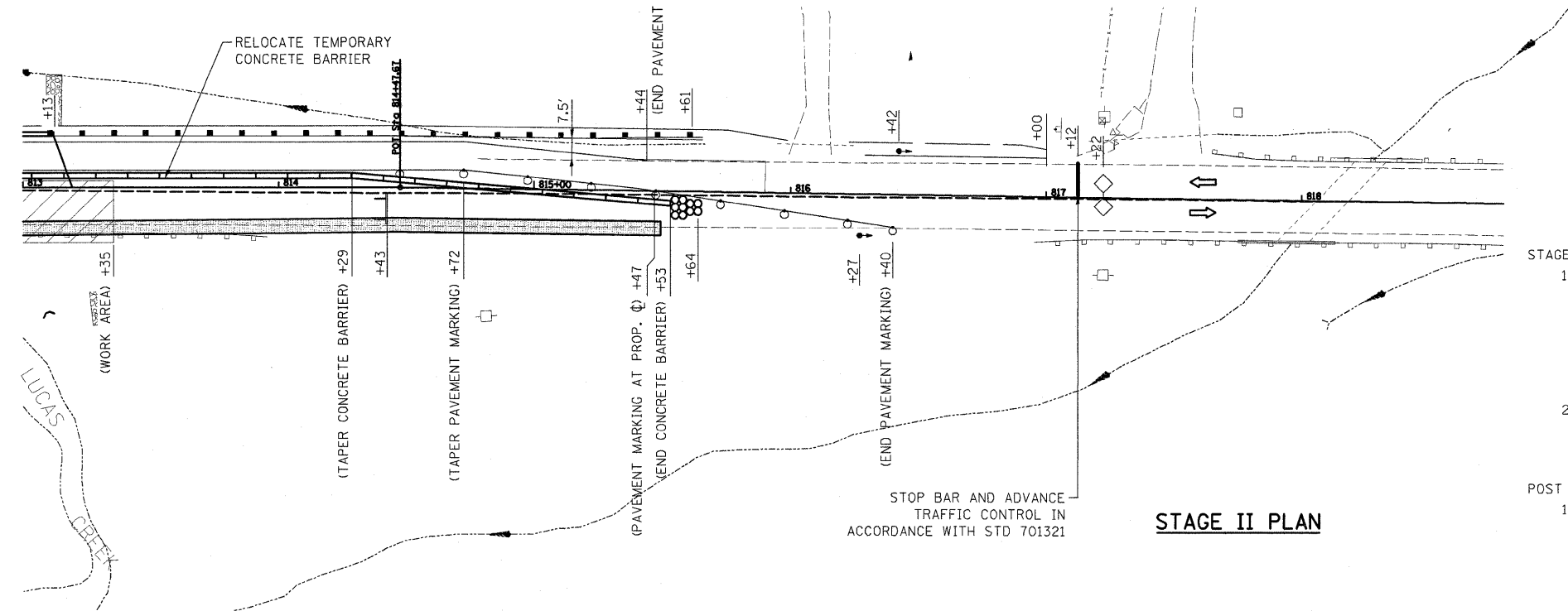
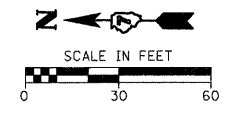
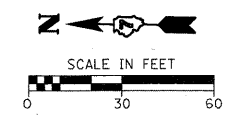

STAGE II PLAN

- STAGE II CONSTRUCTION:**
1. STAGE II CONSTRUCTION SHALL CONSIST OF STAGE II REMOVAL OF THE EXISTING STRUCTURE, STAGE II CONSTRUCTION OF THE REPLACEMENT STRUCTURE, REMOVAL OF PRE-STAGE I BASE COURSE WIDENING, PAVEMENT REMOVAL, GRADING, HMA BINDER COURSES TO WITHIN 1 1/2" OF FINAL SURFACE, SHOULDER, GUARDRAIL, RIPRAP, ETC. STAGE II STRUCTURE CONSTRUCTION SHALL BE DONE IN ACCORDANCE WITH STAGE CONSTRUCTION AS DETAILED IN THE BRIDGE PLANS. TEMPORARY CONCRETE BARRIERS ON NORTH AND SOUTH END WILL NEED TO BE REMOVED PRIOR TO THE LAST LIFT OF BINDER BEING PLACED. TRAFFIC CONTROL SHALL BE IN ACCORDANCE WITH THE APPLICABLE PORTIONS OF STANDARD 701321 AND AS DETAILED IN THE STAGE CONSTRUCTION PLANS.
  2. TEMPORARY RAMP SHALL BE PLACED AT BOTH ENDS OF THE BRIDGE APPROACH SLAB FOR POST-STAGE II TRAFFIC.
- POST STAGE CONSTRUCTION:**
1. POST-STAGE CONSTRUCTION SHALL CONSIST OF CONSTRUCTING BUTT JOINTS AT NORTH AND SOUTH LIMITS OF PROJECT, REMOVAL OF TEMPORARY CONCRETE BARRIERS, PLACING 1 1/2" HMA SURFACE. TRAFFIC CONTROL SHALL BE IN ACCORDANCE WITH THE APPLICABLE PORTIONS OF STANDARD 701306.

4915.195A\*3\LucasCreekStandalone\SC04\_45.DGN

FILE NAME = #FILE#	USER NAME = #USER#	DESIGNED - DJR	REVISED -	<b>STATE OF ILLINOIS DEPARTMENT OF TRANSPORTATION</b>	<b>STAGE II CONSTRUCTION AND TRAFFIC CONTROL</b>	F.A.P. RTE. 328	SECTION 4(BR-1)B	COUNTY CLAY	TOTAL SHEETS 42	SHEET NO. 15		
PLOT SCALE = #SCALE#		CHECKED - KOJ	REVISED -			SCALE: SHEET NO. 2 OF 2 SHEETS   STA. TO STA.		CONTRACT NO. 74310				
PLOT DATE = #DATE#		DATE -	REVISED -			ILLINOIS FED. AID PROJECT						
HENRY, MEISENHEIMER & GENDE, INC., 1075 LAKE ROAD, PO BOX 70, CARLYLE, IL 62231 PHONE (618) 594-3711 WWW.HMGENGINEERS.COM												