

S.M. USC #65 BR. Disc. in East End of Sd. Headwall of
 P.C. Box Culvert Sta. 61+92 S.A. RT. 1 Elev. 658.27

STATE OF ILLINOIS
 DEPARTMENT OF PUBLIC WORKS & BUILDINGS
 DIVISION OF HIGHWAYS

PROJECT NO.	SECTION	COUNTY	DATE	SHEET NO. 1
I-57	11B-3	Cumberland	12 10	11 SHEETS

GENERAL NOTES 74401

Class X Concrete shall be used throughout.
 Coarse aggregate which is to be used in end seats must be absolutely free of chert, flint, limonite, lignite and soft sandstone.
 The concrete floor slab shall be finished in accordance with Article 5119 of the Standard Specifications. Permanent forms will not be permitted in forming the concrete floor.
 Slope wall shall be reinforced with welded wire fabric 6"x6" mesh, #4 wires, weighing 58# per 100 sq ft.
 Rivets 1/2", open holes 1/2", unless noted.
 All Structural Steel shall conform to A.S.T.M. A-36 Specifications for Structural Steel.
 Anchor Bolts shall be set before riveting diaphragms over supports.
 All bolsters, rollers, bearing plates, shim plates, lead plates, pinches, and anchor bolts shall be fabricated and set in accordance with Article 5115 of the Standard Specifications and are included in quantity of Structural Steel, Est. Wt. 10,400.
 Except as otherwise provided all Structural Steel shall receive one shop coat of red lead paint and two field coats of aluminum paint. See Articles 55.1 to 55.5 inclusive of the Standard Specifications.
 All paint shall be furnished and applied by the Contractor.
 Concrete piles through embankment shall be driven in prepared holes in accordance with Article 60.9(a) of the Standard Specifications.
 The Contractor shall drive one concrete test pile at the West Abutment in a permanent location and one timber test pile in the vicinity of Pier 2 as directed by the Engineer before ordering the remaining piles.
 Backs of armor angles at the end of slab shall be given two shop coats of red lead paint.

All excavation required for the construction of the slope wall shall be incidental to the contract unit price for Slope Wall 4'

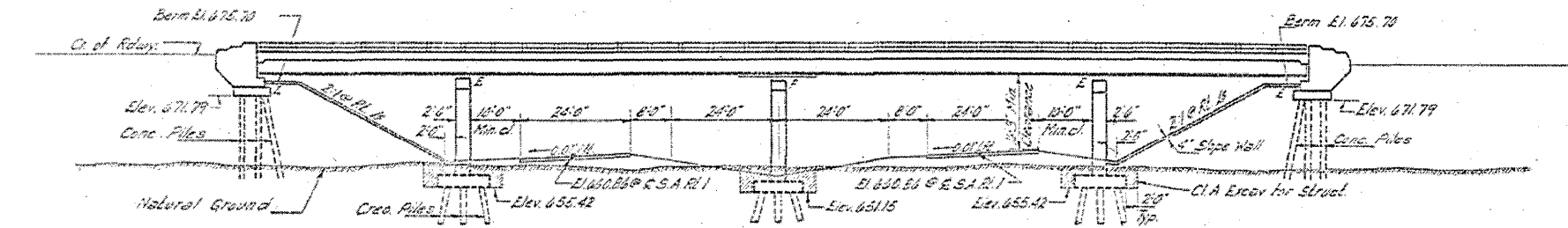

ELEVATION

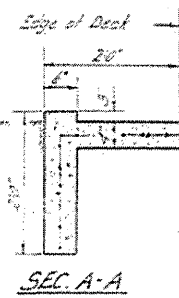

SEC. A-A

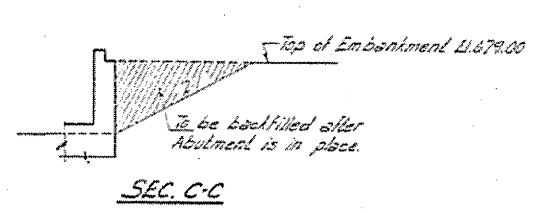

SEC. C-C

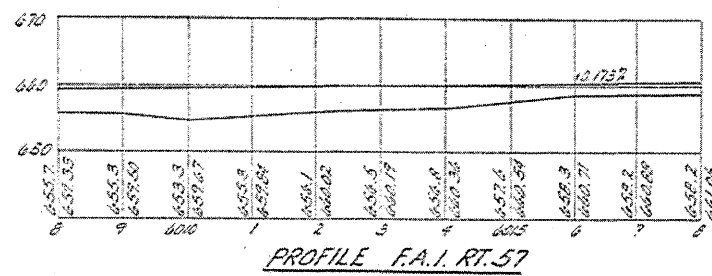

PROFILE F.A.I. RT. 57

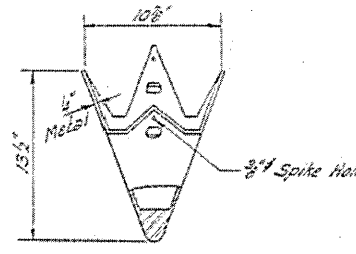

METAL SHOE for Crossed Piles

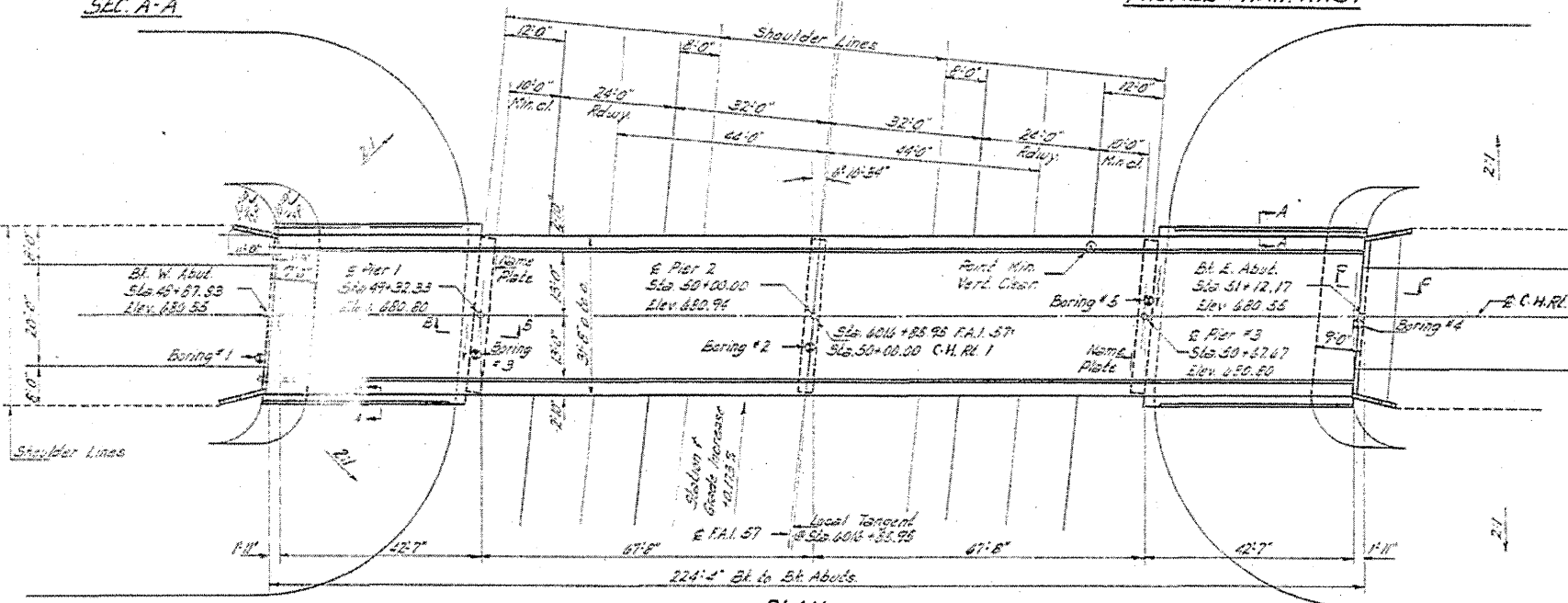

PLAN

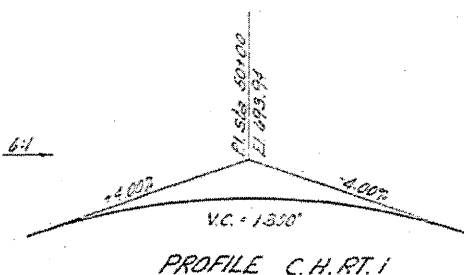

PROFILE C.H. RT. 1

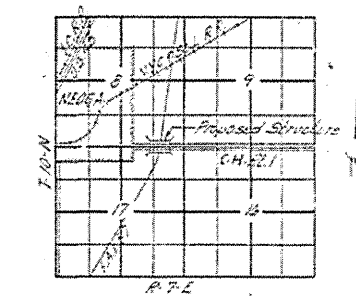

LOCATION SKETCH

STA. 6016 + 85.95
 BUILT BY
 STATE OF ILLINOIS
 F.A.I. RT. 57 SEC. 18-11B-3
 F.A. PROJ. I-57-4(10)
 LOADING HIS-512

NAME PLATE
 See Sld. 2113

CURVE DATA (F.A.I. 57)
 P.I. Sta. 6005 + 30.16
 L = 33° 02' 19"
 D = 1° 00' 00"
 R = 5729.65'
 T = 1699.30'
 L = 3303.86'
 E = 246.68'
 S.E. = 0.0111%
 attained in 100'

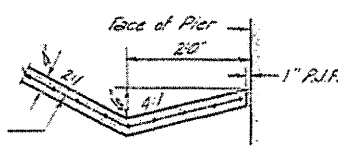

SEC. B-B

DESIGN STRESSES
 1c = 1400 p.s.i. Super T Sub
 1/2" = 75 p.s.i. Rebar
 1s = 20,000 p.s.i. Rebar
 1s = 20,000 p.s.i. Struc. (A-36)
 n = 10
 LOADING HIS-512-44
 2" = 1" face (Composite)
 4" = 1" face (Non-composite)

TOTAL BILL OF MATERIAL

Item	Super	Sub	Total
Class X Excav for Structure	Cu. Yds.	160	160
Class X Concrete	Cu. Yds.	192.1	216.7
Furnishing & Erecting Structural Steel	Lbs.	142,350	142,350
Furnishing & Erecting Metal Handrail	Lin. Ft.	444	444
Reinforcement Bars	Lbs.	41,850	15,740
Crossed Piles (Up to 20')	Lin. Ft.	876	876
Test Piles (Timber)	Each	1	1
Metal Shoes	Each	5	5
Concrete Piles	Lin. Ft.	629	629
Test Piles (Concrete)	Each	1	1
Name Plates	Each	2	2
Slope Wall (4')	Sq. Yds.	40	410
Protective Coat	Sq. Yds.	835	835

DESIGNED: T. M. Long
 CHECKED: Abraham B. Cook
 DRAWN: P. Lawler
 CHECKED: A. R. E.

EXAMINED: H. G. ...
 PASSED: ...
 APPROVED: R. L. ...

DEC 8 1921

GENERAL PLAN & ELEVATION
 PROJ. I-57-4 (26) 11B
 C.H. RT. 1 OVER
 F.A.I. RT. 57 SEC. 18-11B-3
 CUMBERLAND COUNTY
 STA. 6016 + 85.95

LOCATION 3