

BENCHMARKS

BM #100: 60 D NAIL IN POWERPOLE ±800' SOUTH OF SN 061-0002, EAST SIDE OF ROAD
ELEV. 491.11, STA. 697+38±, LT: ±61'

BM #101: 60 D NAIL IN POWERPOLE ±800' NORTH OF SN 061-0002, WEST SIDE OF ROAD
ELEV. 480.90, STA. 679+92±, RT: ±57'

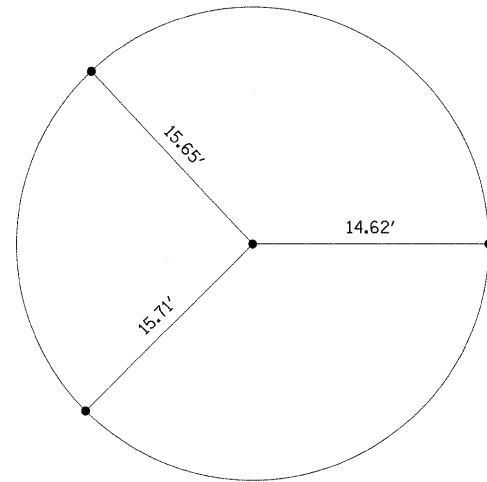

ALL TIES MAG NAILS IN E.O.P.

STA. 680+00
MAG NAIL (SET)

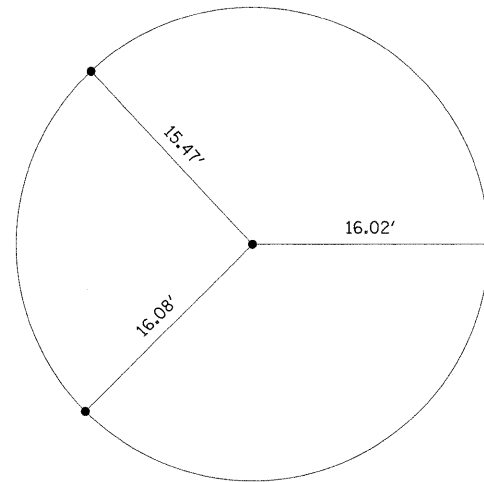

ALL TIES MAG NAILS IN E.O.P.

STA. 687+90
MAG NAIL (SET)

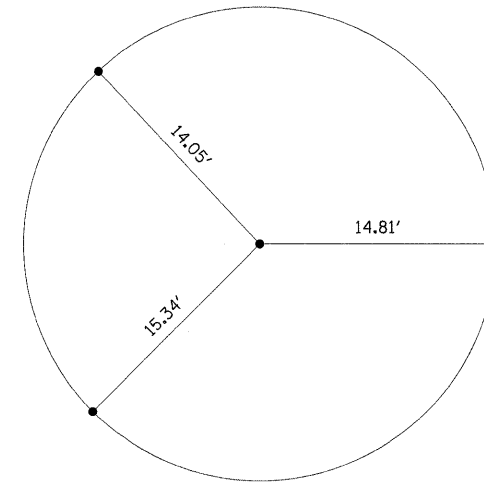

ALL TIES MAG NAILS IN E.O.P.

STA. 696+00
MAG NAIL (SET)

FILE NAME = c:\pwork\pwork\dot\harbaugh\dms52336\p	USER NAME = harbaughd	DESIGNED -	REVISED -	STATE OF ILLINOIS DEPARTMENT OF TRANSPORTATION	TIE POINTS AND BENCHMARKS				F.A.P. RTE.	SECTION	COUNTY	TOTAL SHEETS	SHEET NO.
	PLOT SCALE = 50.0000' / IN.	CHECKED -	REVISED -		322	25BR-1	MARION	63	9				
	PLOT DATE = 10/13/2009	DATE -	REVISED -		SCALE: SHEET NO. OF SHEETS STA. TO STA.				ILLINOIS FED. AID PROJECT		CONTRACT NO. 76A83		