

\\BCCONN-99-MOTIF.LDN...UBCCONN-93-BORDER.LDN...UBCCONN-93-SHT-TYPICAL.LDN...UBCCONN-93-LEGEND.LDN...  
 12-15-2009 9:56:03 BONDHUD C:\C:\WORKSPACE\BONDHUD\NHS-0944J-TRANS-07-2202-20668-081\CIVIL\CAD\191 ALL CONTRACTS\CONNSHEETS CONTRACT 03\BCCONN-09-SHT-TYPICAL.2.DGN

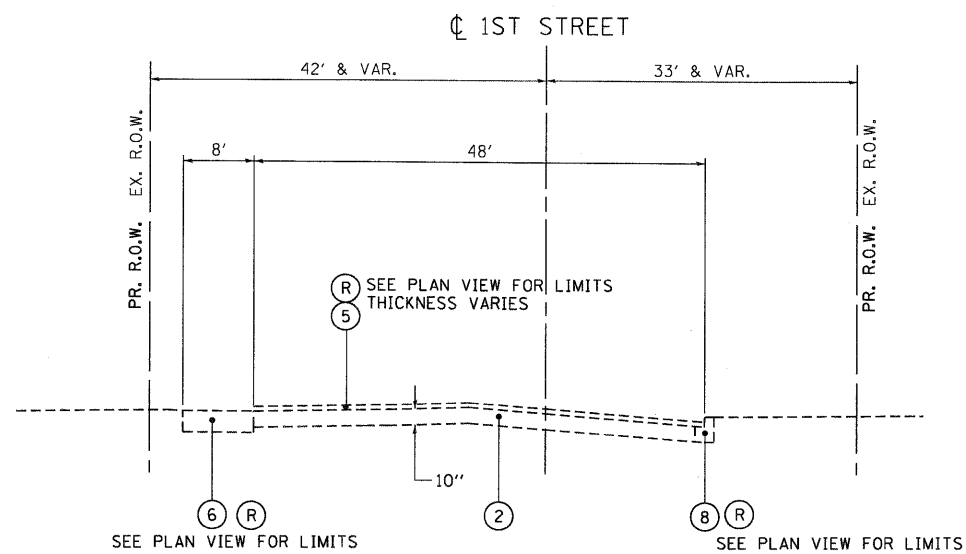

EXISTING TYPICAL SECTION 1ST STREET  
(LOOKING NORTHEAST)  
STA. 5+00.00 TO STA. 7+28.66

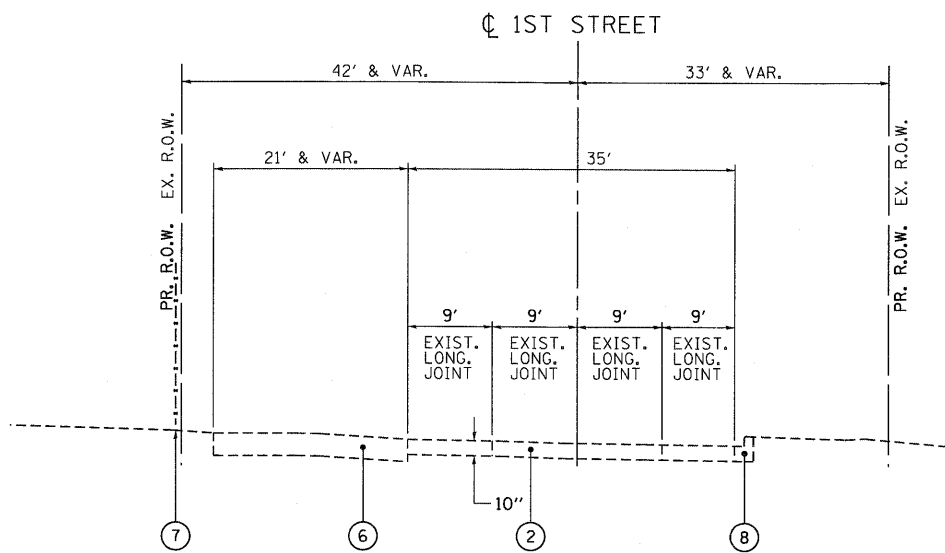

EXISTING TYPICAL SECTION 1ST STREET  
(LOOKING NORTHEAST)  
STA. 7+28.66 TO STA. 20+00.00

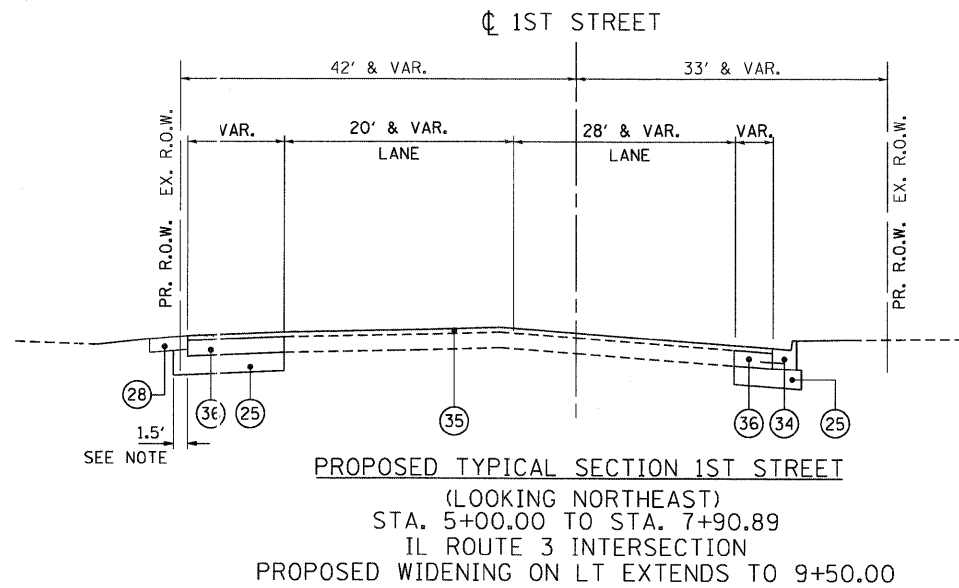

PROPOSED TYPICAL SECTION 1ST STREET  
(LOOKING NORTHEAST)  
STA. 5+00.00 TO STA. 7+90.89  
IL ROUTE 3 INTERSECTION  
PROPOSED WIDENING ON LT EXTENDS TO 9+50.00

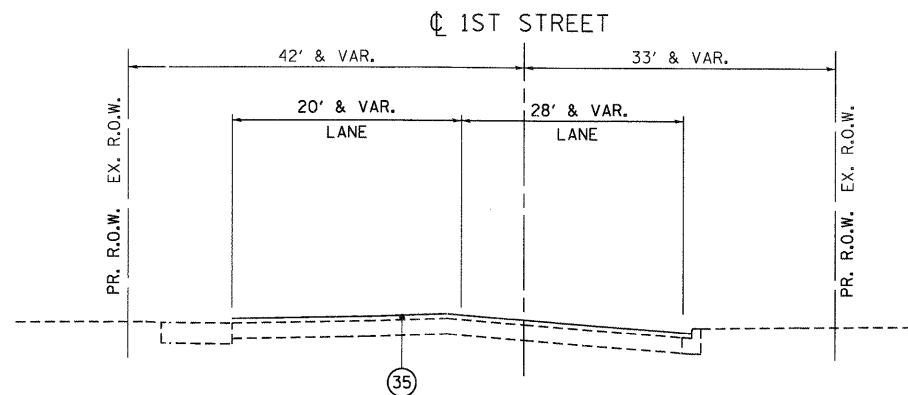

PROPOSED TYPICAL SECTION 1ST STREET  
(LOOKING NORTHEAST)  
IL ROUTE 3 INTERSECTION OVERLAY ONLY AREAS,  
NO WIDENING, SEE PLAN VIEW FOR LIMITS

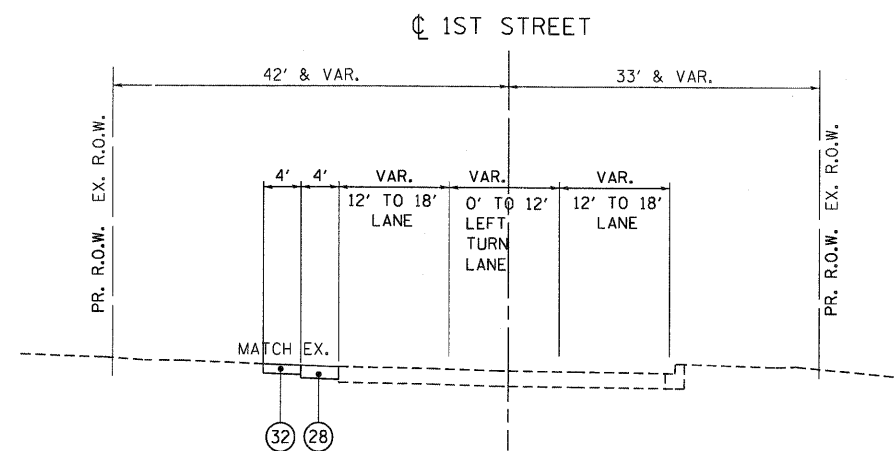

PROPOSED TYPICAL SECTION 1ST STREET  
(LOOKING NORTHEAST)  
STA. 7+90.89 TO STA. 20+00.00

- EXISTING LEGEND**
- (1) BITUMINOUS CONCRETE PAVEMENT
  - (2) P.C.C. PAVEMENT
  - (3) BRICK PAVEMENT
  - (4) GRAVEL SURFACE COURSE
  - (5) BITUMINOUS OVERLAY
  - (6) AGGREGATE SHOULDER
  - (7) CHAIN LINK FENCE
  - (8) CURB & GUTTER

- PROPOSED LEGEND**
- (22) PORTLAND CEMENT CONCRETE PAVEMENT 12" (JOINTED)
  - (23) POROUS GRANULAR EMBANKMENT, SUBGRADE
  - (24) COMBINATION CONCRETE CURB AND GUTTER, TYPE B-6.24
  - (25) AGGREGATE SUBGRADE 12"
  - (26) LONGITUDINAL SAWED JOINT WITH NO. 6 TIE BARS @ 30" CTS
  - (27) LONGITUDINAL CONSTRUCTION JOINT WITH NO. 6 TIE BARS @ 24" CTS
  - (28) HOT-MIX ASPHALT SHOULDERS, 8"
  - (29) PIPE UNDERDRAINS 4"
  - (30) GEOTECHNICAL FABRIC FOR GROUND STABILIZATION
  - (31) SEEDING, CLASS 2A/TOPSOIL FURNISH AND PLACE, 4"
  - (32) AGGREGATE SHOULDERS, TYPE A 6"
  - (33) SWALE
  - (34) COMBINATION CONCRETE CURB AND GUTTER, TYPE B-6.12
  - (35) HOT-MIX ASPHALT SURFACE COURSE, MIX "D" N70 2.5"
  - (36) PORTLAND CEMENT CONCRETE BASE COURSE 10"

(R) ITEM TO BE REMOVED  
SEE PLAN FOR LIMITS

NOTE: THE COST OF THE ADDITIONAL THICKNESS OF AGGREGATE SUBGRADE 12" REQUIRED BENEATH THE HMA SHOULDERS SHALL BE INCLUDED IN THE CONTRACT UNIT PRICE PER SQ YD FOR AGGREGATE SUBGRADE 12".

FILE NAME = #FILEL#	USER NAME = #USER#	DESIGNED - JB	REVISED -	<b>STATE OF ILLINOIS DEPARTMENT OF TRANSPORTATION</b>	<b>1ST STREET TYPICAL SECTIONS</b>			F.A.P. RTE. 9153	SECTION 82-1K	COUNTY ST. CLAIR	TOTAL SHEETS 107	SHEET NO. 8			
		DRAWN - JB	REVISED -					SCALE: N.T.S.	SHEET NO.	OF	SHEETS	STA.	TO STA.	CONTRACT NO. 76C40	
		CHECKED - ACL	REVISED -					FED. ROAD DIST. NO. ILLINOIS FED. AID PROJECT							
		DATE - 10/09/09	REVISED -												