

EXISTING TYPICAL SECTION FRONT STREET
 (LOOKING NORTHWEST)
 STA. 200+00.00 TO STA. 213+00.00
 REMOVED PAVEMENT TO BE REPLACED
 WITH EXCESS EARTH EXCAVATION.

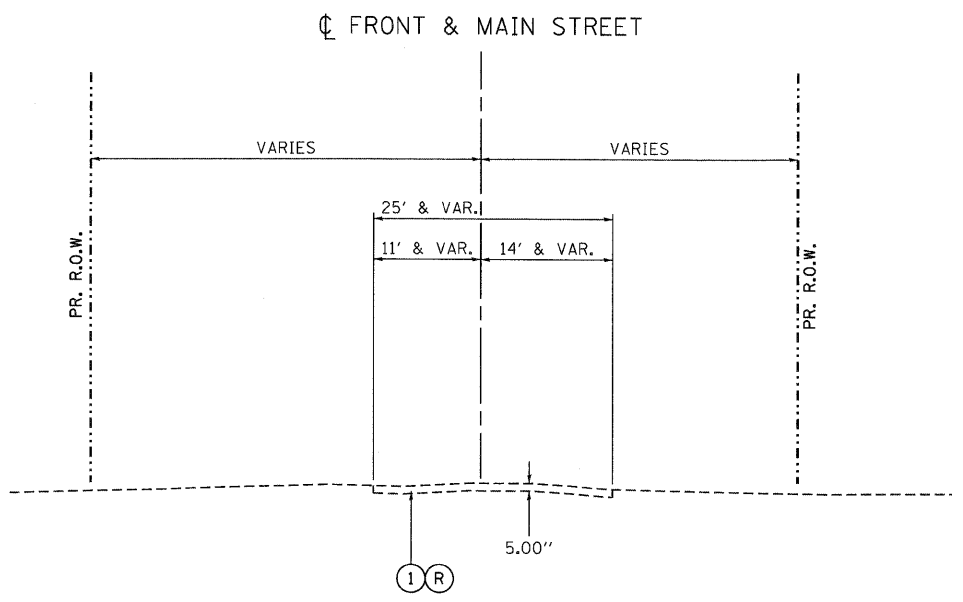

EXISTING TYPICAL SECTION MAIN STREET
 (LOOKING NORTHEAST)
 STA. 213+00.00 TO STA. 223+94.37
 REMOVAL OF MAIN STREET FROM
 STA. 213+00.00 TO STA. 216+73.92
 REMOVED PAVEMENT TO BE REPLACED
 WITH EXCESS EARTH EXCAVATION.

- EXISTING LEGEND**
- ① BITUMINOUS CONCRETE PAVEMENT
 - ② P.C.C. PAVEMENT
 - ③ BRICK PAVEMENT
 - ④ GRAVEL SURFACE COURSE
 - ⑤ BITUMINOUS OVERLAY
 - ⑥ AGGREGATE SHOULDER
 - ⑦ CHAIN LINK FENCE
 - ⑧ CURB & GUTTER

- PROPOSED LEGEND**
- ②② PORTLAND CEMENT CONCRETE PAVEMENT 12" (JOINTED)
 - ②③ POROUS GRANULAR EMBANKMENT, SUBGRADE
 - ②④ COMBINATION CONCRETE CURB AND GUTTER, TYPE B-6.24
 - ②⑤ AGGREGATE SUBGRADE 12"
 - ②⑥ LONGITUDINAL SAWED JOINT WITH NO. 6 TIE BARS @ 30" CTS
 - ②⑦ LONGITUDINAL CONSTRUCTION JOINT WITH NO. 6 TIE BARS @ 24" CTS
 - ②⑧ HOT-MIX ASPHALT SHOULDERS, 8"
 - ②⑨ PIPE UNDERDRAINS 4"
 - ③① GEOTECHNICAL FABRIC FOR GROUND STABILIZATION
 - ③② SEEDING, CLASS 2A/TOPSOIL FURNISH AND PLACE, 4"
 - ③③ AGGREGATE SHOULDERS, TYPE A 6"
 - ③④ SWALE
 - ③⑤ COMBINATION CONCRETE CURB AND GUTTER, TYPE B-6.12
 - ③⑥ HOT-MIX ASPHALT SURFACE COURSE, MIX "D" N70 2.5"
 - ③⑦ PORTLAND CEMENT CONCRETE BASE COURSE 10"

APPLICATION (SEE TYPICAL SECTIONS)	MIXTURE TYPE	AC TYPE	AIR VOIDS
MAIN ST. CUL-DE-SAC	HOT-MIX ASPHALT SURFACE COURSE, MIX "C", NSO (IL 9.5MM); 2"	PG 64-22	4% @ 50 GYR.
1ST STREET RESURFACING	HOT-MIX ASPHALT SURFACE COURSE, MIX "D", N70	PG 64-22	4% @ 70 GYR.
HMA SHOULDERS	HOT-MIX ASPHALT SHOULDERS, 8"	PG 58-22	2% @ 30 GYR.

NOTE
 THE UNIT WEIGHT USED TO CALCULATE ALL HOT-MIX ASPHALT SURFACE MIXTURES IS 112 .BS/SQ YD/IN

Ⓡ ITEM TO BE REMOVED
 SEE PLAN FOR LIMITS

U:\DCONN-99-MOTIF.LDGN...UBDCONN-93-BORDER.LDGN...UBDCONN-93-LEGEND.LDGN...UBDCONN-93-SHT-TYPICAL3.DGN
 BONDHUDD C:\C-WORKSPACE\BONDHUDD\N\F5-0844J-TRANS.07\2002\20868-001\CIVIL\04\99 ALL CONTRACTS\CONNSHEETS CONTRACT 03\UBDCONN-93-SHT-TYPICAL3.DGN

