

MATCH LINE STA. 185+50 SEE SHEET m2-3

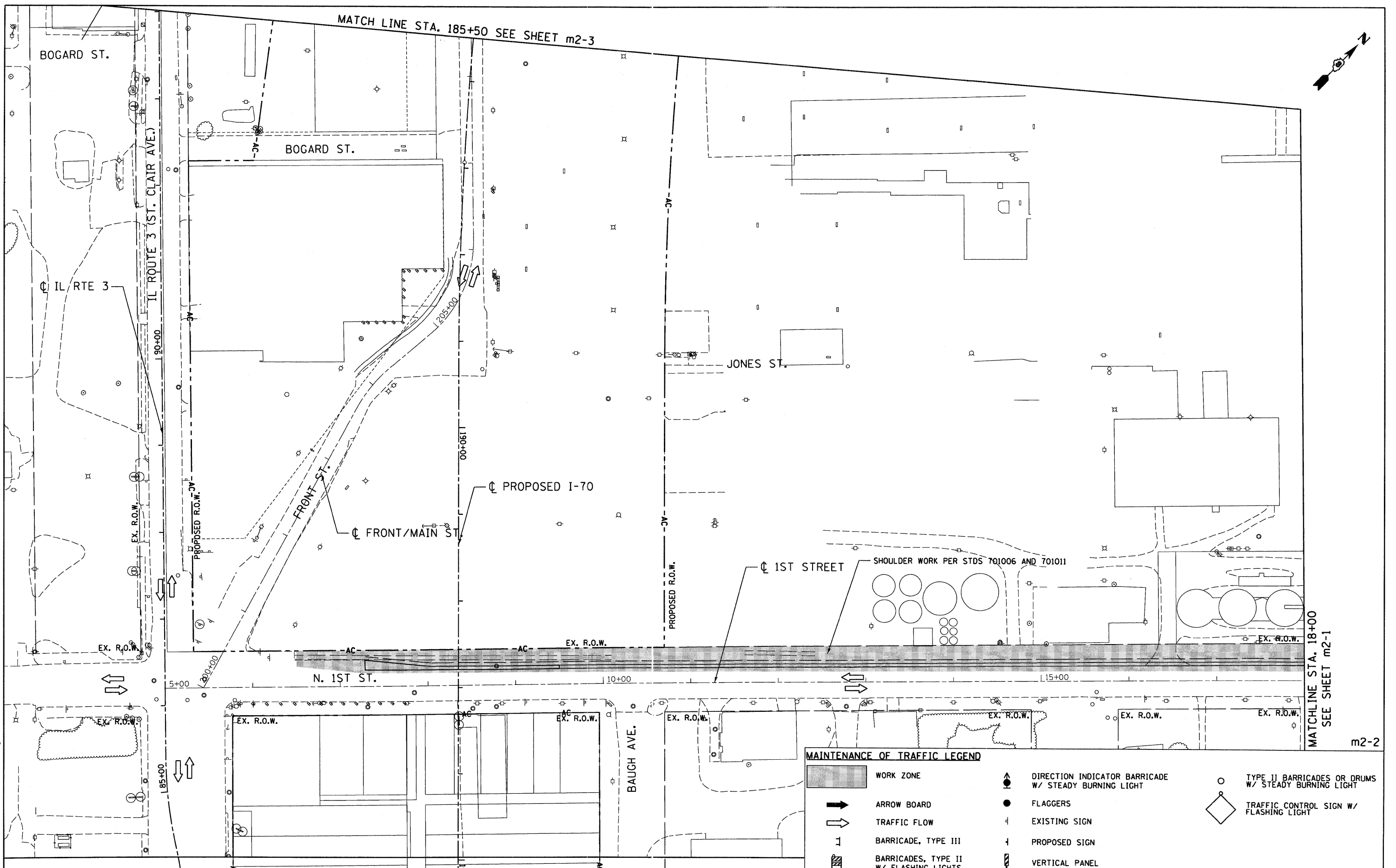
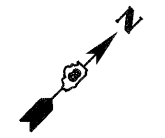

MATCHLINE STA. 18+00
SEE SHEET m2-1

m2-2

MAINTENANCE OF TRAFFIC LEGEND			
	WORK ZONE		DIRECTION INDICATOR BARRICADE W/ STEADY BURNING LIGHT
	ARROW BOARD		FLAGGERS
	TRAFFIC FLOW		EXISTING SIGN
	BARRICADE, TYPE III		PROPOSED SIGN
	BARRICADES, TYPE II W/ FLASHING LIGHTS		VERTICAL PANEL
			TYPE II BARRICADES OR DRUMS W/ STEADY BURNING LIGHT
			TRAFFIC CONTROL SIGN W/ FLASHING LIGHT

FILE NAME =	USER NAME = USER*	DESIGNED - AAB	REVISED -
#FILE#		DRAWN - MNR	REVISED -
ABNA ENGINEERING INC. PROFESSIONAL ENGINEERS EAST ST. LOUIS, ILLINOIS	PLDT SCALE = #SCALE#	CHECKED - DPD	REVISED -
	PLDT DATE = #DATE#	DATE - 10/09/09	REVISED -

**STATE OF ILLINOIS
DEPARTMENT OF TRANSPORTATION**
I-70 CONNECTION

MAINTENANCE OF TRAFFIC PLANS			
1ST STREET / FRONT STREET			
STAGE II			
SCALE: 1"=50'	SHEET NO. OF SHEETS	STA. TO STA.	

F.A.P. RTE. 9153	SECTION 82-1K	COUNTY ST. CLAIR	TOTAL SHEETS 107	SHEET NO. 35
FED. ROAD DIST. NO. ILLINOIS FED. AID PROJECT		CONTRACT NO. 76C40		