

.\\BCCONN-93-UTL.DGN, .\\BCCONN-93-TOPOI.DGN, .\\BCCONN-93-GEOMETRICS.DGN, .\\BCCONN-93-STAGING.DGN, .\\BCCONN-93-REMOVAL.SLDGN, .\\BCCONN-93-DRAINAGE.DGN, .\\BCCONN-93-LEGEN.DGN, .\\BCCONN-93-PK1.DGN, .\\BCCONN-93-MOTIF.DGN, .\\BCCONN-93-99-1618123
 BONDHUDD C:\C:\WORKSPACE\BONDHUDD\N\F5-2044.D-THENS.07-2202-28866-001\CIVIL\CD\93 ALL CONTRACTS\CONNSHEETS CONTRACT 03\BCCONN-93-SHT-ORNU\TL6-2818.DGN

MATCH LINE STA. 207+50
SEE SHEET 53

MATCH LINE STA. 192+20 SEE SHEET 52

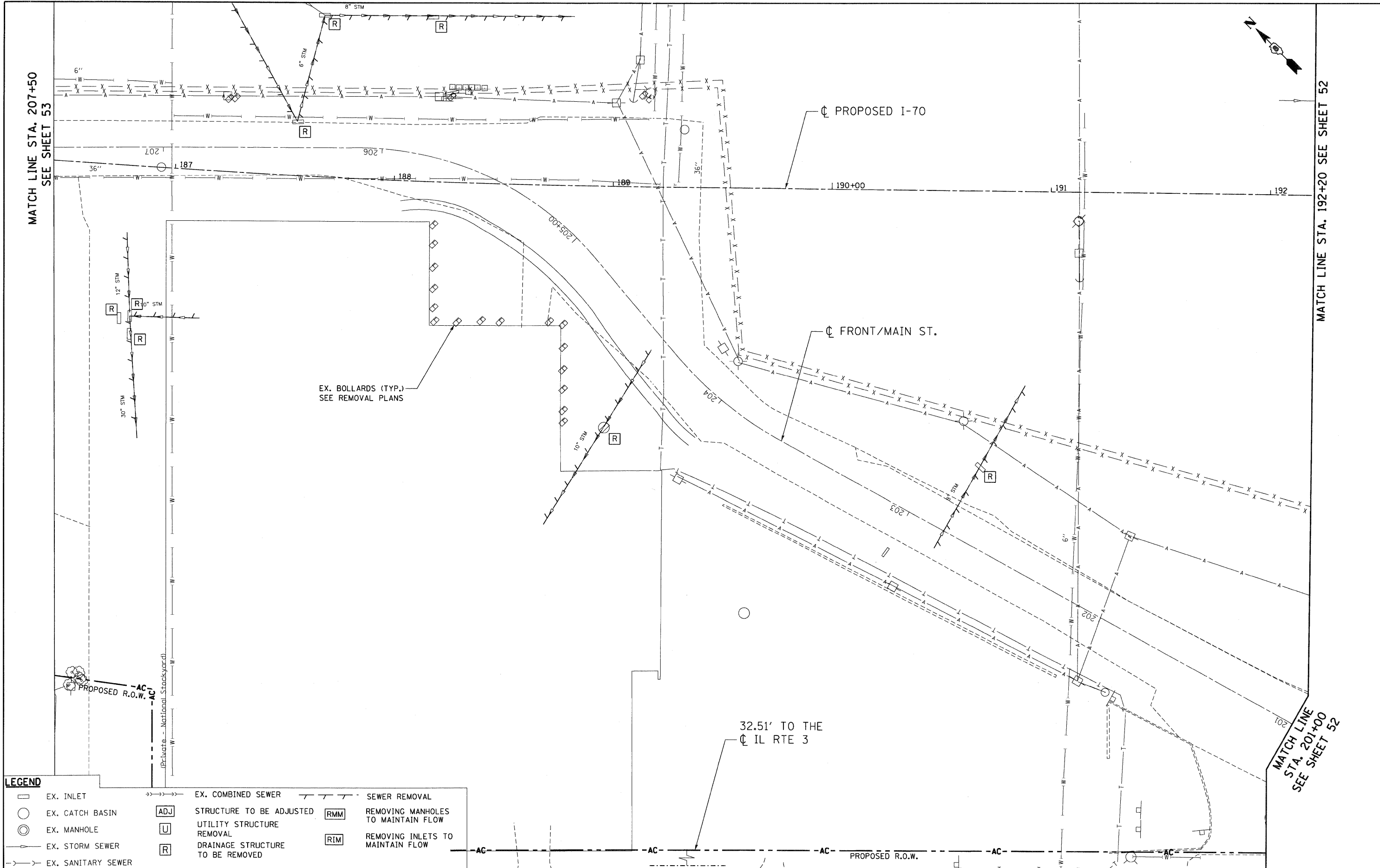

MATCH LINE
STA. 201+00
SEE SHEET 52

LEGEND		
□	EX. INLET	→→→ EX. COMBINED SEWER
○	EX. CATCH BASIN	--- SEWER REMOVAL
⊙	EX. MANHOLE	ADJ STRUCTURE TO BE ADJUSTED
→	EX. STORM SEWER	U UTILITY STRUCTURE REMOVAL
→	EX. SANITARY SEWER	R DRAINAGE STRUCTURE TO BE REMOVED
		RMM REMOVING MANHOLES TO MAINTAIN FLOW
		RIM REMOVING INLETS TO MAINTAIN FLOW



FILE NAME =	USER NAME = #USER#	DESIGNED - JB	REVISED -
#FILEL#		DRAWN - JFS	REVISED -
PLOT SCALE = #SCALE#		CHECKED - ACL	REVISED -
PLOT DATE = #DATE#		DATE - 10/09/09	REVISED -

STATE OF ILLINOIS
DEPARTMENT OF TRANSPORTATION
 I-70 CONNECTION

EXISTING DRAINAGE & UTILITIES
FRONT STREET
STA. 201+00.00 TO STA. 208+00.00

SCALE: 1"=20'
 SHEET NO. OF SHEETS STA. TO STA.

F.A.P. RTE. 9153	SECTION 82-1K	COUNTY ST. CLAIR	TOTAL SHEETS 107	SHEET NO. 54
FED. ROAD DIST. NO. ILLINOIS FED. AID PROJECT				

CONTRACT NO. 76C40