

PLAN	SURVEYED	BY	DATE
	PLOTTED		
	NOTE BOOK		
	NO. _____		
	FILE NAME		

PROFILE	SURVEYED	BY	DATE
	PLOTTED		
	NOTE BOOK		
	NO. _____		
	FILE NAME		

10-14-2009 161847 BONDHUIJ  
 C:\C:\WORKSPACE\BONDHUIJ\VA-FS-08\44.D-TRANS.07\282\2868-201\CIVIL\CAO\99 ALL CONTRACTS\CONNSHEETS CONTRACT 03\DRNUTL-1000.DGN

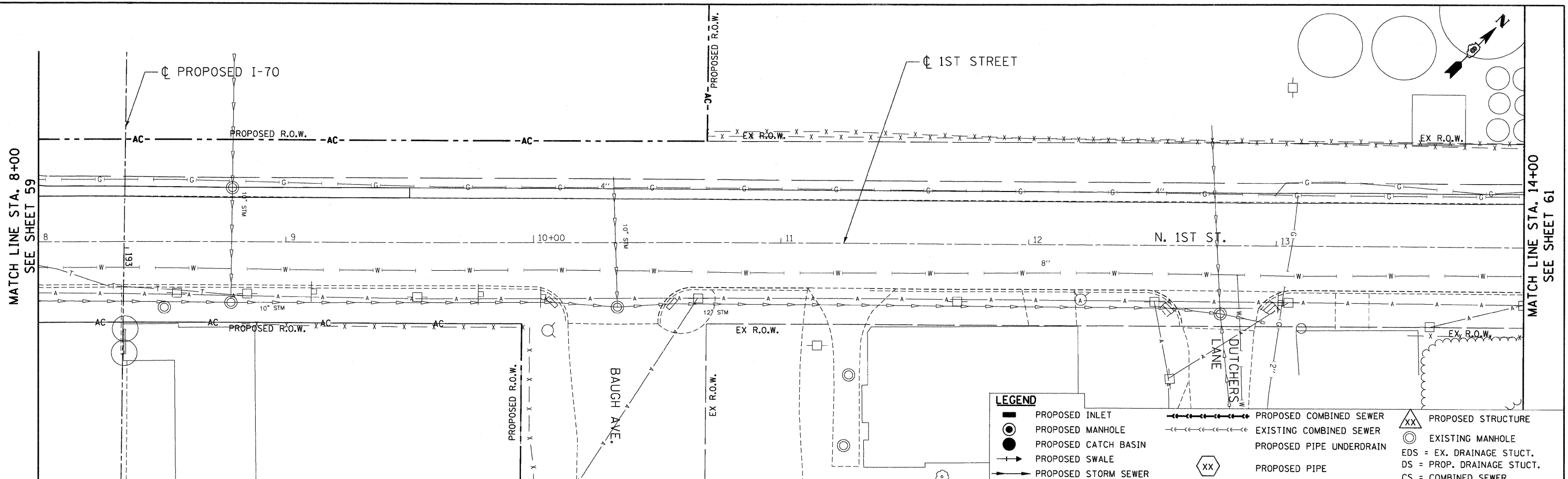

**LEGEND**

- PROPOSED INLET
- PROPOSED MANHOLE
- PROPOSED CATCH BASIN
- PROPOSED SWALE
- PROPOSED STORM SEWER
- PROPOSED COMBINED SEWER
- EXISTING COMBINED SEWER
- PROPOSED PIPE UNDERDRAIN
- PROPOSED PIPE
- PROPOSED STRUCTURE
- EXISTING MANHOLE
- EDS = EX. DRAINAGE STUCT.
- DS = PROP. DRAINAGE STUCT.
- CS = COMBINED SEWER

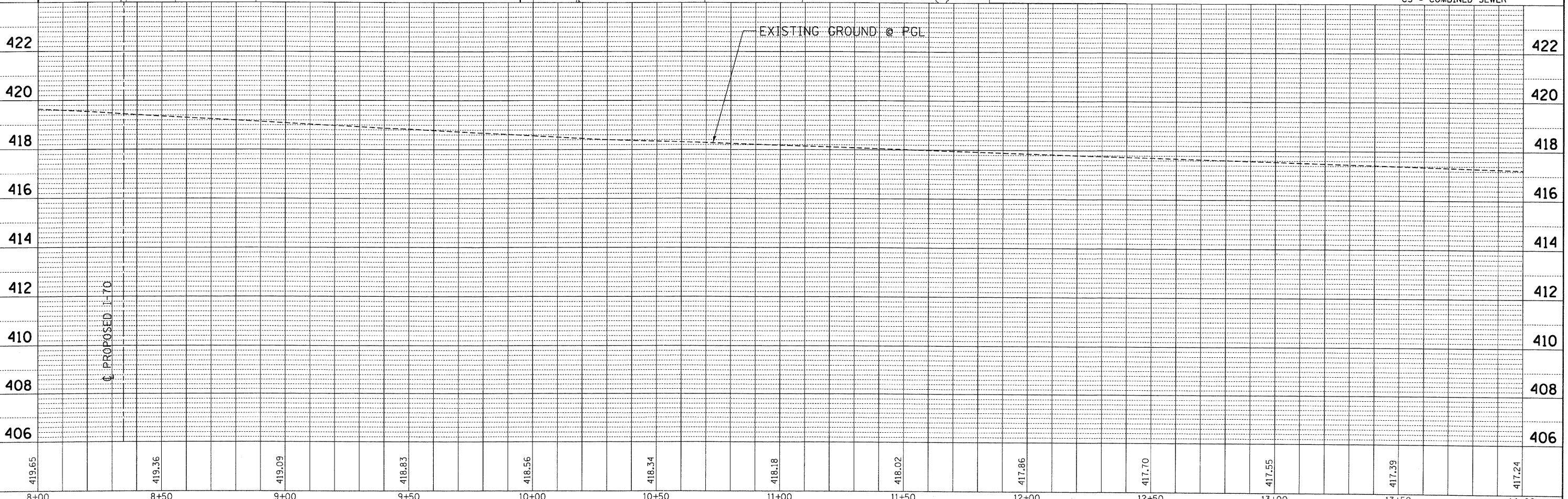

8+00	8+50	9+00	9+50	10+00	10+50	11+00	11+50	12+00	12+50	13+00	13+50	14+00
419.65	419.36	419.09	418.83	418.56	418.34	418.18	418.02	417.86	417.70	417.55	417.39	417.24

FILE NAME =  
 #FILE#

USER NAME = #USER#  
 DESIGNED - JB  
 DRAWN - JB  
 CHECKED - ACL  
 DATE - 10/09/09

REVISED -  
 REVISED -  
 REVISED -  
 REVISED -

STATE OF ILLINOIS  
 DEPARTMENT OF TRANSPORTATION  
 I-70 CONNECTION

PROPOSED DRAINAGE PLAN & PROFILE  
 1ST STREET  
 STA. 8 + 00.00 TO STA. 14 + 00.00

SCALE: HORIZ. 1"=20'  
 VERT. 1"=2'

F.A.P. RTE.	SECTION	COUNTY	TOTAL SHEETS	SHEET NO.
9153	82-1K	ST. CLAIR	107	60
FED. ROAD DIST. NO.		ILLINOIS FED. AID PROJECT		



TENG & ASSOCIATES, INC.  
 ENGINEERS/ARCHITECTS/PLANNERS  
 CHICAGO, ILLINOIS

CONTRACT NO. 76C40