

STATE OF ILLINOIS
DEPARTMENT OF TRANSPORTATION

INDEX OF SHEETS

1. General Plan & Elevation
2. General Data
3. Stage Construction Details
4. Temporary Concrete Barrier
5. Removal Details
6. Superstructure Repair Details
7. Preformed Joint Strip Seal
8. Abutment Bearing Details
9. Pier Bearing Details
10. West Abutment Details
11. East Abutment Details
12. Abutment Details
13. Pier 2 Details
14. Bar Splicer Assembly Details

SCOPE OF WORK

1. Replace expansion joints.
2. Wash bridge deck, parapets and abutment seats.
3. Seal deck, parapets, and abutment seats with "Concrete Sealer".
4. Remove and replace bearings at both abutments and Piers 1 and 3.
5. Construct concrete pedestals around existing bearings at Pier 2.
6. Place riprap at the northeast corner of the E. Appr. Pavement of the E.B. Roadway.

ELEVATION

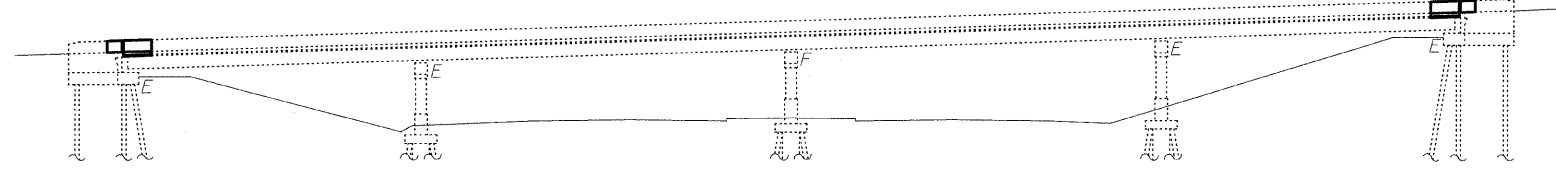

PLAN

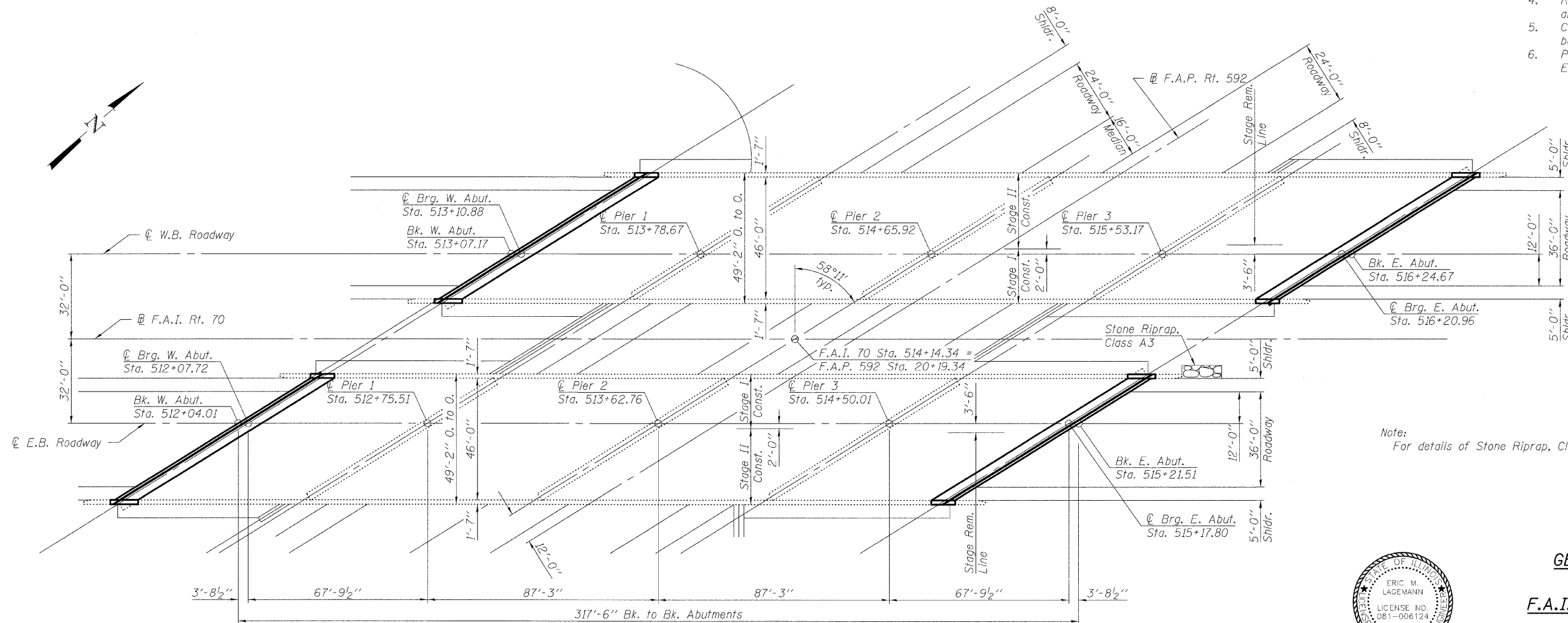

Note:
For details of Stone Riprap, Class A3, see sheet 2 of 14.



Eric Lagemann 9/15/09
Expires 11/30/2010

GENERAL PLAN & ELEVATION
I-70 OVER IL 157
F.A.I. RT. 70 - SECTION 60-(6,7)BR
MADISON COUNTY
STA. 514+14.34
STRUCTURE NO. 060-0012 (E.B.)
STRUCTURE NO. 060-0013 (W.B.)

DESIGNED	EML
CHECKED	JJD
DRAWN	EML
CHECKED	JJD

HORNER & SHIFRIN, INC.
ENGINEERS

SHEET NO. 1 14 SHEETS	F.A.I. RTE.	SECTION	COUNTY	TOTAL SHEETS	SHEET NO.
	70	60-(5,6,7)RS, 60-(6,7)BR	MADISON	185	115
			CONTRACT NO. 76C56		
FED. ROAD DIST. NO.		ILLINOIS	FED. AID PROJECT		